

Double Leg Ratchet Solid Top Pallet

SKU: DLR10-054

Standard Features:

- Solid top prevents loose product from falling through open grid
- Telescoping double legs provide twice the forklift damage protection of common single walled product
- Innovative ratchet fastening system: 3X stronger than welded or snap construction
- Edge rackable to 2,200 lbs.
- Anti-microbial additive options available
- Highly durable & easy to clean solid surface
- Unique lower deck design includes first ever pallet jack guide that prevents related damage
- 4-way entry for forklift and pallet jacks
- Ideal for Pharmaceutical, Medical, Industrial, Food and Beverage applications

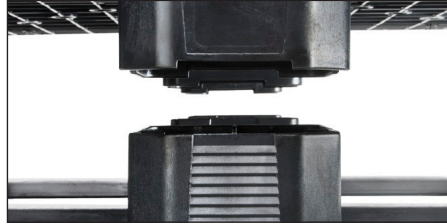

Double wall with ratchet fastening



Available in Open Top



Edge
Rackable

Add Ons Per Request:

Intermittent perimeter lip,
Molded-in or hot-stamped
logo/company ID, Rubber
grommets



SOURCE4
INDUSTRIES

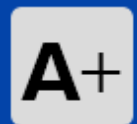

(866) 734-8848



sales@source4industries.com



source4industries.com



4436 Lawrence St
Las Vegas, NV 89081

Double Leg Ratchet Solid Top Pallet

SKU: DLR10-054

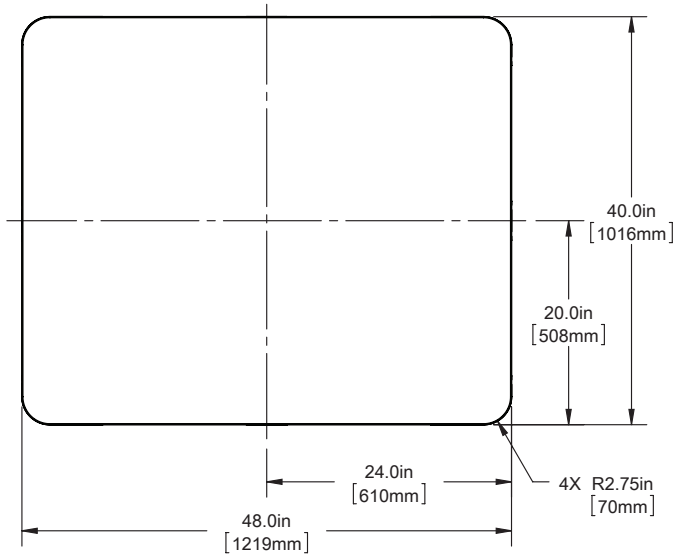

TOP VIEW

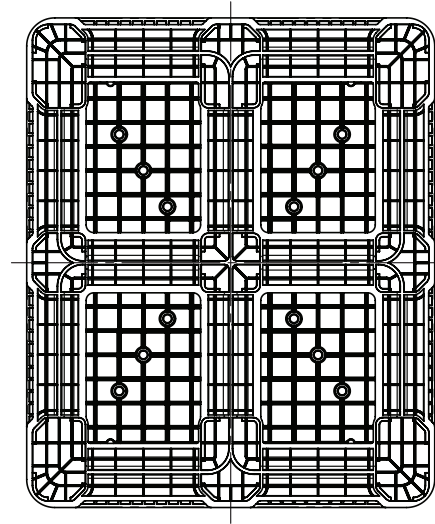

BOTTOM VIEW

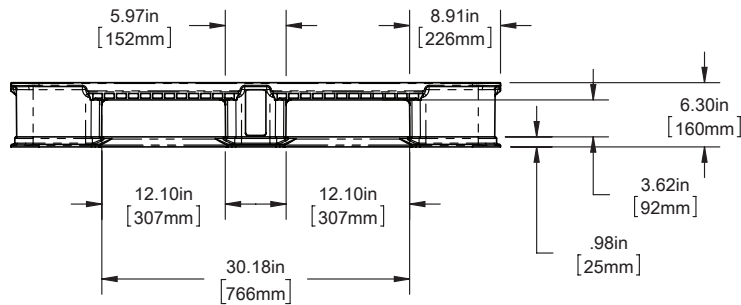

SIDE VIEW - 48"

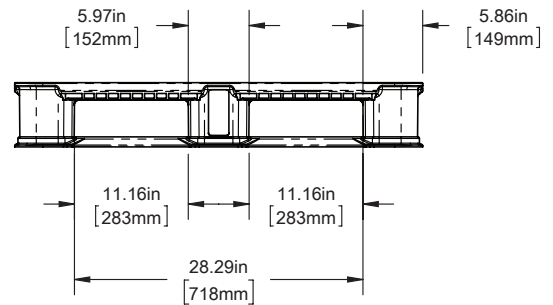

SIDE VIEW - 40"

40" X 48" Double Leg Ratchet Solid Top Pallet

DIMENSIONS				LOAD RATINGS (lbs.)				TRUCKLOAD CAPACITY	OCEAN CONTAINERS
Width	Length	Height	Weight	Static	Dynamic	Selected Edge Racking	Supported Racking	53'	40' HC
40 in.	48 in.	6.3 in.	48 lbs.	30,000	5,000	2,200 Unitized load at 72°F	5,000	QTY 510	QTY 340

SOURCE4
INDUSTRIES



ACCREDITED
BUSINESS

A+



(866) 734-8848



sales@source4industries.com



source4industries.com



4436 Lawrence St
Las Vegas, NV 89081