

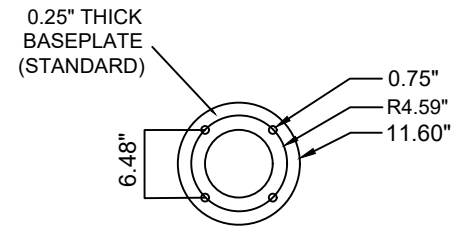

- SELECT DESIRED MATERIAL:  
(6" NOMINAL SIZE)
- BSS06000 SCH 10 STAINLESS STEEL
  - BSS06040 SCH 40 STAINLESS STEEL
  - BSS06080 SCH 80 STAINLESS STEEL
  - BCS06040 SCH 40 ASTM A-53 CARBON STEEL
  - BCS06080 SCH 80 ASTM A-53 CARBON STEEL
- SELECT DESIRED STAINLESS STEEL BOLLARD
- FINISH:**
- POLISHED #4 FINISH
  - AS SPECIFIED \_\_\_\_\_
- SELECT DESIRED CARBON STEEL BOLLARD
- FINISH:**
- POWDER COAT RAL # \_\_\_\_\_
  - AS SPECIFIED \_\_\_\_\_
- SELECT DESIRED STAINLESS STEEL BOLLARD
- MATERIAL:**
- TYPE 304
  - TYPE 316
- SELECT DESIRED BOLLARD CAP STYLE:
- DOME
  - FLAT
  - REVEAL
  - SLOPED

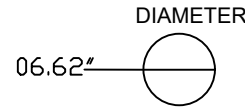

PLAN VIEW - BASE PLATE  
(USED ON STAINLESS STEEL BOLLARD)

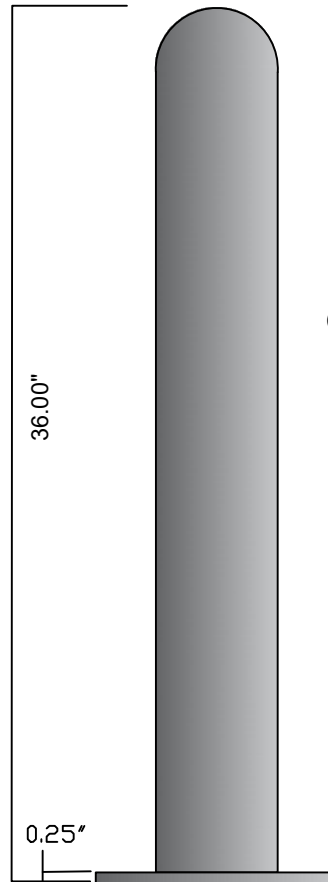
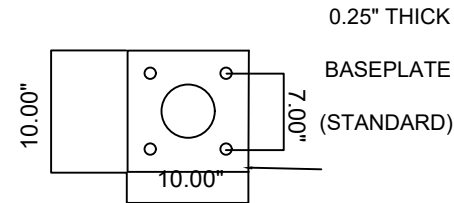

PLAN VIEW - BASE PLATE  
(USED ON CARBON STEEL BOLLARD)

REVISIONS			
LTR	DESCRIPTION	DATE	APPV
COMMENTS			
SPECIFICATIONS			
HEIGHT:	6.62"	SCH 10	
DIAMETER:	6.62"	SCH 40	
WALL THICKNESS:		SCH 80	

ALTERNATE INSTALL METHOD

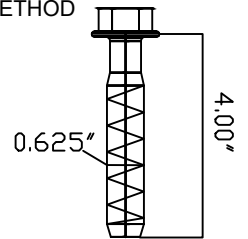

BASE PLATE REQUIRES  
(4) 0.625"X 4" ANCHOR BOLTS  
OR CINCH ANCHORS  
BY OTHERS

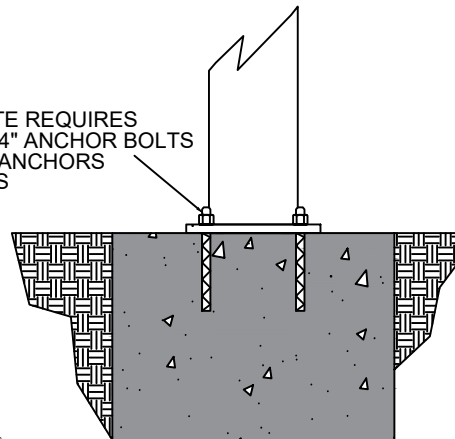

END VIEW - FOUNDATION

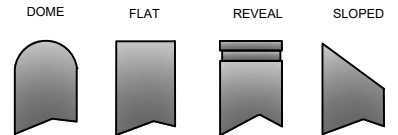

SERIES NUMBER:	B6000	CAGE CODE:	B6	REV:	6	DRAWING NUMBER:	B60
PRODUCT FAMILY:	FIXED BOLLARD	PRODUCT CLASS:	STANDARD OR CUSTOMER DEFINED	DRAWN BY:	AJA	DRAWING REV:	
PRODUCT LINE:	BOLLARD	PRODUCT SUB LIND:	BASEPLATE	CHECKED BY:		SHEET:	1 OF 1
				APPROVED BY:		RELEASE DATE:	

APPLICATION	
NEXT ASSY	USED ON

TITLE:  
BOLLARD, BASEPLATE

NOTES:  
1. INSTALLATION TO BE COMPLETED IN ACCORDANCE WITH MANUFACTURER'S SPECIFICATIONS.  
2. DO NOT SCALE DRAWING.  
3. THIS DRAWING IS INTENDED FOR USE BY ARCHITECTS, ENGINEERS, CONTRACTORS, CONSULTANTS AND DESIGN PROFESSIONALS FOR PLANNING PURPOSES ONLY. THIS DRAWING  
4. ALL INFORMATION CONTAINED HEREIN WAS CURRENT AT THE TIME OF DEVELOPMENT BUT MUST BE REVIEWED AND APPROVED BY THE PRODUCT MANUFACTURER TO BE CONSIDERED ACCURATE.