

Robo Pets T-Rex

**POWER
YOUR FUN**

For Ages 3+

⚠ WARNING:

CHOKING HAZARD-Small parts.
Not for Children under 3 years.

Box Contents

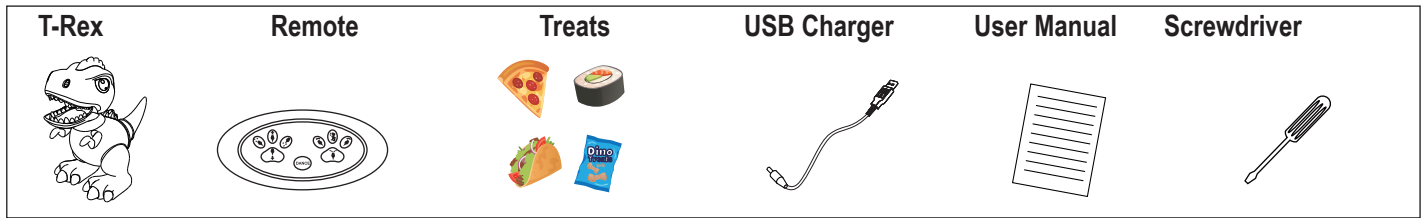

Safety Precautions

PARENTS: This toy is recommended for children. To ensure that your child's play is both safe and fun, please review the operating instructions with your children.

Keep hands, hair and loose clothing away from all moving parts when power switch is turned ON.

Warning: Changes or modifications to this unit not expressly approved by the party responsible for compliance could void the user's authority to operate the equipment.



The crossed-out dustbin symbol indicates that batteries, rechargeable batteries, button cells, battery packs etc, must not be put in the trash. Batteries are harmful to health and the environment. Please help to protect the environment from health risks. Tell your children to dispose of batteries properly by taking them to the local collecting points. This way batteries are recycled safely.



Waste Electrical and Electronic Equipment

When this appliance is out of use, please remove all batteries and dispose of them separately. Bring electrical appliances to the local collecting points for waste electrical and electronic equipment. Other components can be disposed of in domestic refuse.

Cautions:

- Adult supervision is required when recharging battery.
- Do not leave unattended while charging.
- Do not overcharge T-Rex.
- Different types of batteries or new and used batteries are not to be mixed.
- Only batteries of the same or equivalent type as recommended are to be used.
- Batteries are to be inserted with correct polarity.
- The supply terminals are not to be short-circuited.
- Do not mix old and new batteries.
- Do not mix alkaline, standard (carbon-zinc) or rechargeable (nickel-cadmium) batteries.

Care and Maintenance:

- Wipe the toy gently with a clean damp cloth.
- This toy is intended for indoor use only.
- Do not submerge the toy into water that can damage the electronic components.

Note:

- Parental guidance is recommended when installing or replacing batteries.
- Keep and retain this information for future reference.
- Keep strict accordance with the instruction manual while operating the toy.

REMOTE BATTERY SPECS:

- ⊖ ⊕ Rating : DC3V
- ⊖ ⊕ Batteries : 2 x 1.5V "AAA"/LR03/AM4 (not included)

T-REX BATTERY SPECS:

- Battery ratings : DC3.7V
- Batteries : 1 x 3.7V Li-ion Rechargeable Battery Pack (included)
- Capacity : 500 mAh

Part Identification

POWER BUTTON

Press for more than 3 seconds to turn on or turn off the T-Rex. Press to choose play mode or to stop action or revive the T-Rex from SLEEP MODE. Sleep mode will occur if T-Rex is inactive for 5 minutes. When the T-Rex goes into sleep mode it will snore and then turn off.

CHOOSE A PLAY MODE

Short press the comb and the eyes change color

- BLUE is gesture mode and interactive game mode
- GREEN is feed mode
- PURPLE is interactive game mode
- TEAL is remote mode

Choose which color you want, wait a moment until T-Rex gives a yip (Do not press any remote control button during this process.)

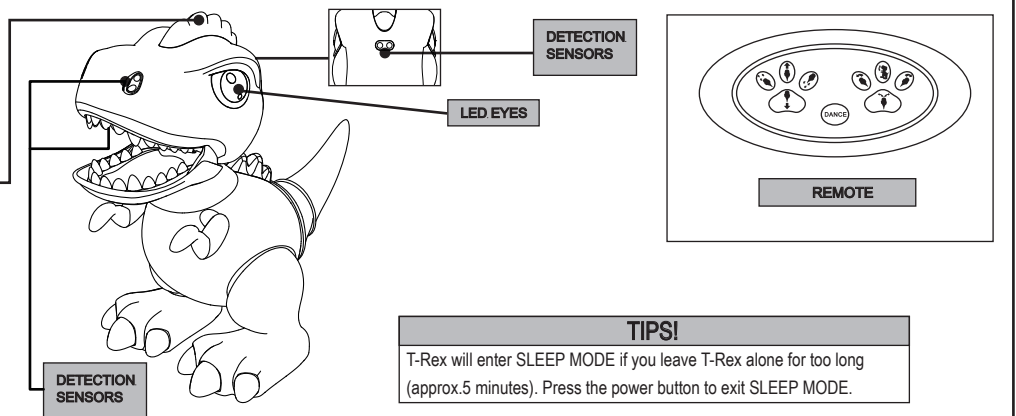

Battery Installation and Charging

Battery Installation for the Remote

1. Unscrew the battery compartment.
2. Install 2 x AAA size batteries (not included), following the correct polarity as shown in the battery compartment.
3. Replace the battery compartment cover.

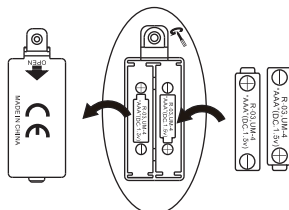

2 x AAA battery (not included)

TIP!

Enjoy optimum T-Rex performance when you use new batteries.

RC Toy Charging Instructions

1. Switch off T-Rex. Insert the charging plug into the socket found on the roof of T-Rex's mouth. Insert the USB plug into the USB socket. The charging indicator light will turn on while charging. Charging indicator light will turn off when charging is complete.
2. When the battery is low T-Rex will start chirping at you and the eyes will flash until you charge it.

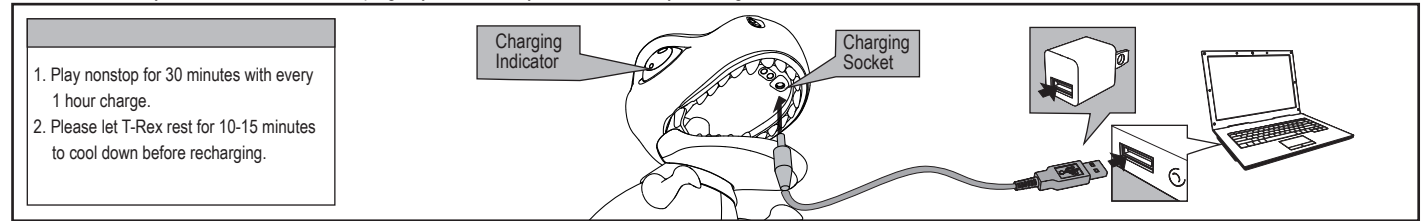

Remote Control Mode

Press any key on the remote to enter REMOTE CONTROL MODE.

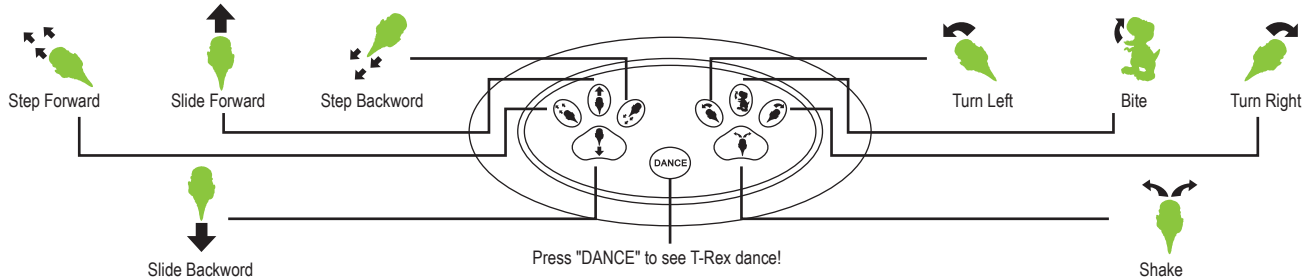

Gesture Mode

1. Press the ON button until T-Rex's eyes turn blue. Wait a few seconds until T-Rex gives a yip, indicating that it's now in GESTURE MODE. DO NOT press any remote control button in this mode.
2. Put your hand in front of T-Rex to give orders: move forward, backward, turn left, turn right, shake, and chomp. Wait for T-Rex to yip before giving the next gesture.

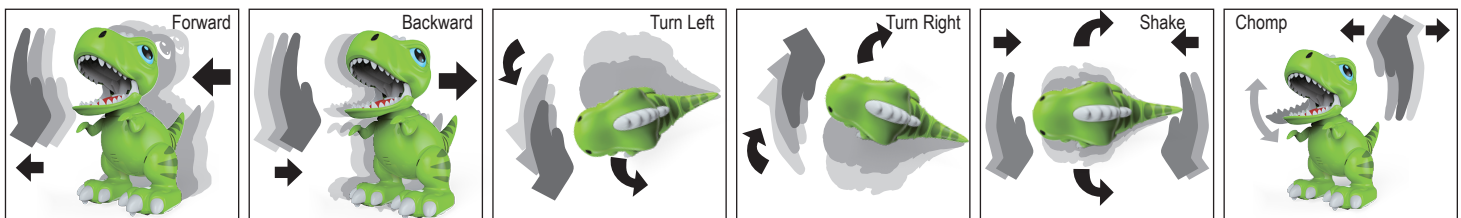

Feed Mode

Press the ON button until T-Rex's eyes turn green. Wait a few seconds until T-Rex gives a yip, indicating that it's now in FEED MODE. DO NOT press any remote control button in this mode.

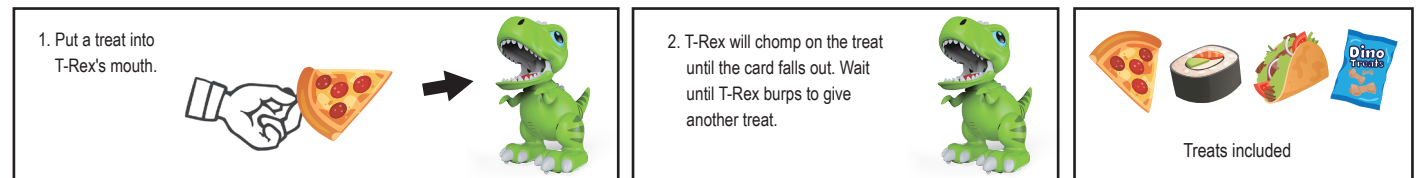

Interactive Game Mode

Play with T-Rex

1. Press the ON button until T-Rex's eyes turn purple. Wait a few seconds until T-Rex gives a roar, indicating that it's now in INTERACTIVE GAME MODE. DO NOT press any remote control button in this mode.
2. The aim of the game is to put your hand in T-Rex's mouth and try to pull it out before it chomps.
3. Pay attention to T-Rex's eyes. A few seconds after they turn Green, it will Chomp. Make sure your hand is touching the top row of teeth and leave your hand there until the eyes flash green. Remove your hand before it chomps to win (T-Rex's eyes will turn red). If the T-Rex chomps your hand, you lose.



Play with Another Person

1. Press the ON button till the eyes turn to Blue which is the GESTURE MODE.
2. If you move your hand near then far from the back of the T-Rex's head, its mouth will open and close.
3. Keeping your hand still at the back of T-Rex will keep the mouth constantly open. Once you move your hand away the mouth will close. If you move your hand away T-Rex will chomp.
4. Have your friend put their hand inside T-Rex's mouth. When you move your hand away if your friend is able to remove their hand before the T-Rex chomps on it, they win. If they are not quick enough and T-Rex chomps on their hand they lose.



Questions or Comments? Please include your order number when you contact us at support@powerurfun.com for fast, friendly service.

powerurfun.com

**POWER
YOUR FUN**

