

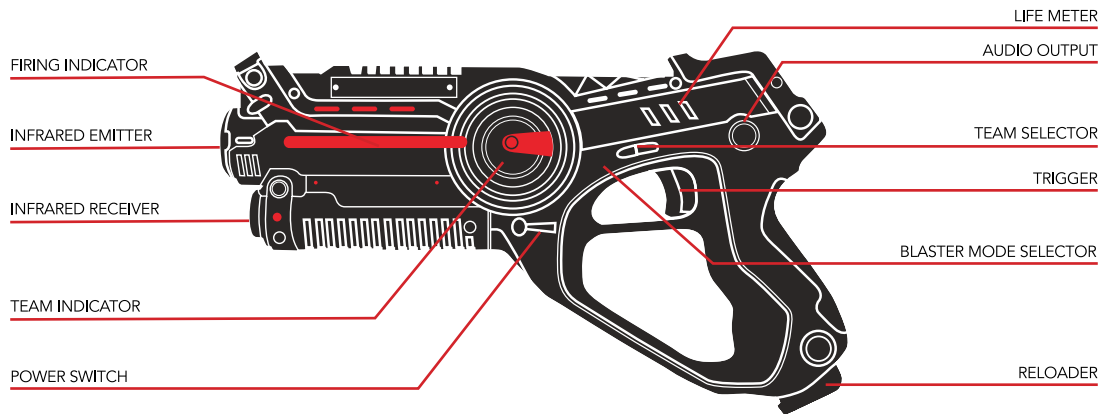

# LASER LAUNCHERS

## Laser Tag Drone Target Set

### BLASTER OVERVIEW



### BATTERY INSTALLATION

1. Carefully remove battery bay door by turning screws counter-clockwise until loosened (Picture 1).
2. Place (4) AA batteries into their correct positions. Be sure they match their corresponding polarity (Picture 2).
3. Replace battery bay door, align screws and turn clockwise until firmly secured (Picture 3).

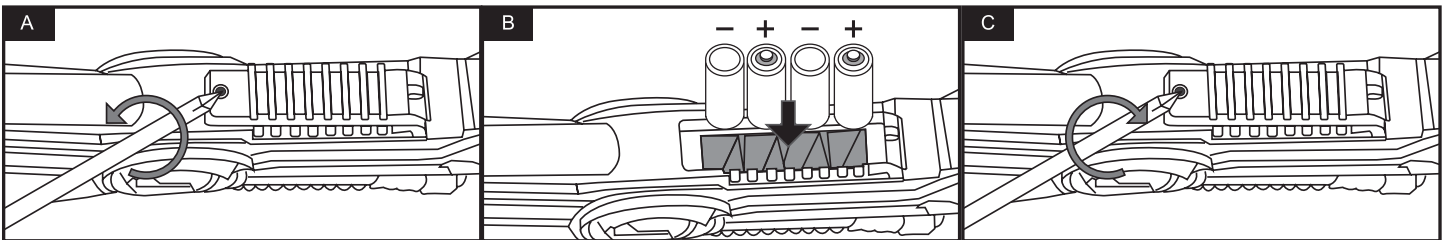

PICTURE 1

PICTURE 2

PICTURE 3

### IMPORTANT SAFETY INFORMATION

- Do not mix old and new batteries or standard (carbon-zinc) and alkaline batteries
- Do not leave batteries in product if left unattended/unused for an extended period of time
- Remove or change out batteries immediately after they expire
- Do not tamper with or short circuit the supply terminals as damage to the product or injury to self may occur
- The infrared technology used in this product may interfere with/be interfered with by other electronic devices. If this occurs, please move the product away from the vicinity of those electronics to continue use
- Avoid extended exposure to heat or direct sunlight
- Do not immerse this product in water as it may damage electronic components
- Do not alter item in any way

## OPERATING INSTRUCTIONS

- 1. Power On:** Flip the power switch ON. The Team Indicator and Life Meter will illuminate and a sound will emit, signaling you're ready to initiate the game. Once the indicators remain a solid hue, the Blaster will be ready for operation.
- 2. Select Your Team:** There are (4) available teams - White, Blue, Green and Red. Use the Team Selector button to cycle through them until reaching your desired color. Each team can accommodate an unlimited number of players and does not have to be balanced, allowing for multiple game configurations!
- 3. Know Your Weapon:** Each Blaster is equipped with an array of firing modes. Using the Blaster Mode Selector button, you can cycle between the Pistol, Shotgun, Submachine Gun and Missile Launcher firing modes. Be sure to utilize them all, as versatility and situational awareness are both key.
- 4. Take Aim and Use Accuracy:** A well-placed shot is crucial to an effective strike. When firing, try to aim for your opponent's Blaster. Yours will illuminate and emit a unique sound depending on your chosen firing mode. Be sure to keep track of your ammunition and don't get caught with an empty clip! Use the Reloader button at any time to replenish your ammo.
- 5. Protect Yourself and Find Cover:** Your Life Meter is limited and your Blaster will signal when you've taken damage by vibrating the grip and alerting you of imminent danger. Be careful - once your Life Meter has depleted, you're out of the game!
- 6. Spread Out:** Your Blaster supports up to 130 ft. of ranged combat, so take advantage of your terrain!

## LIFE METER



LIFE METER



TOTAL LIFE = 9 

FIRING MODE	SHOTS AVAILABLE	DAMAGE
Pistol	x12	
Shotgun	x6	
Submachine Gun	x6	
Missile Launcher	x1	

## DRONE SPINNER CHARGING INSTRUCTIONS

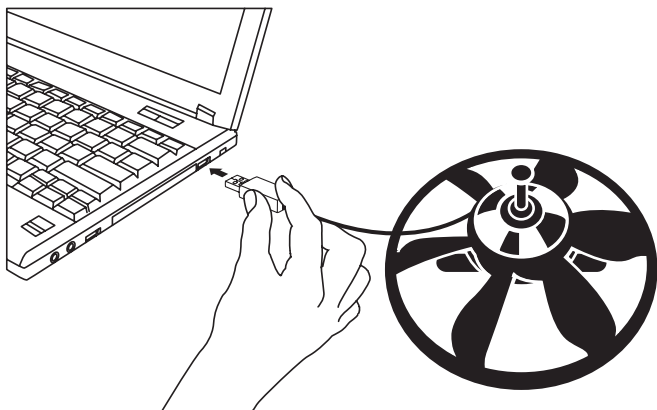

Computer



Phone Charger



Power Bank



Car Charger



### LI-PO BATTERY DISPOSAL & RECYCLING

Contact your local electronics recycling facility for more information about how to recycle Li-Po battery-powered products.



**WARNING:  
DO NOT LEAVE  
BATTERY CHARGING  
UNSUPERVISED**

- Connect drone to USB port with USB charger cable and choose a charging method pictured above
- The USB charger light will be red when charging and turn off when fully charged

## LAUNCHING YOUR DRONE SPINNER

- Turn the Drone Spinners on
- Match the Blasters to their corresponding Drone Spinners
  - Red Blaster – Red Spinner
  - Blue Blaster – Blue Spinner
- Place your Drone Spinner on a flat surface and fire multiple shots at it until it rises in the air
- The Drone Spinner will slowly descend. Keep it flying longer with every direct hit
- Each player must keep their Drone Spinner flying in the air while battling their opponent