

HOW TO REPLACE THE RECHARGEABLE BATTERY



argeecorp.com

- 1 Remove all 6 screws
- 2 Remove cover and battery
Keep gasket for water-tight seal
- 3 Replace **ONLY** with Ni-MH Rechargeable AAA battery
- 4 Replace cover and gasket
Tighten screws

PROTECT YOUR WARRANTY!

**** TIGHTEN ALL 6 SCREWS ****

WARRANTY VOID IF WATER ENTERS CUBE

Turn over for instructions to activate the solar light.



CAUTION: Do not over-tighten screws

TO ACTIVATE THE SOLAR LIGHT REMOVE THE BATTERY PULL-TAB

Your Let's Edge It!® Solar Cubes have been shipped with protectors to keep the battery fresh. You need to remove them prior to use from the underside of each Solar Cube..

- 1 Loosen only the first 2 screws
Do not remove
- 2 Remove tab by pulling out completely
Be careful not to dislodge the battery

3 PROTECT YOUR WARRANTY!

**** TIGHTEN ALL 6 SCREWS ****

WARRANTY VOID IF WATER ENTERS CUBE

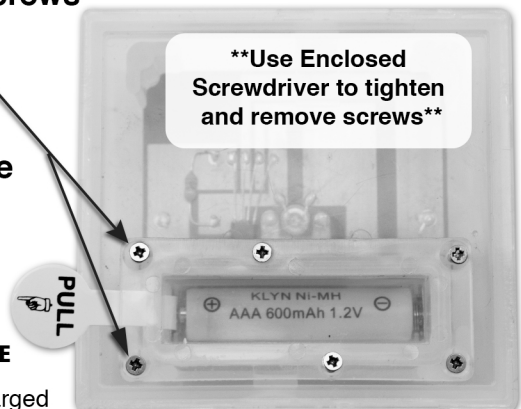

CAUTION: Do not over-tighten screws

Turn over for instructions to replace the battery.

Note: Solar lights may come in a discharged condition. If so, several days in the sun will bring them up to full charge.