

## **LSS-505+ Quick Start Guide and Troubleshooting**

You can also watch our quick start guide video and other videos at:



[tivax.com/collections/sewing-machines/products/desktop-sewing-machine-lss-505](http://tivax.com/collections/sewing-machines/products/desktop-sewing-machine-lss-505)

### **1. Threading**

The machine may have come pre-threaded and ready to use. Please take a look at how it is threaded when you first get it.

When threading the sewing machine, make sure that the power switch is in the OFF position.

Turn the hand wheel counterclockwise until the needle is in its highest position. Before threading, raise the presser foot so the thread can go in between the tension discs on the front of the machine.

Place a spool on the spool pin at the back of the machine, and follow the arrows marked on the machine to thread it. These are in order from 1 to 4. Then insert the thread downward through the metal loop on the needle bar (see image #5 below). If you wish to use the wire threader that came with the machine, insert the wire loop through the needle eye from back to front (image #6), place the thread through the wire loop, and pull the wire loop out of the needle eye. The needle eye will be threaded from front to back (image #7). The needle can also be threaded manually.

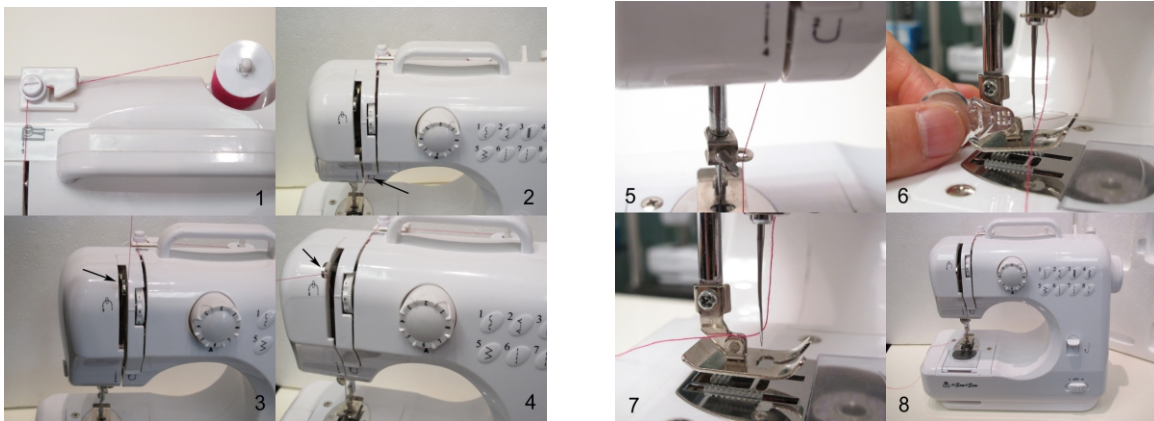

Next, you will need to catch the bobbin thread. Unwind 4 to 5 inches of bobbin thread, remove the clear plastic bobbin cover from the machine, and place the bobbin in the bobbin holder. Hold the needle thread loosely with your left hand. With your right hand, slowly turn the hand wheel counterclockwise (toward you). The needle should go down and come back up with the bobbin thread. Pull the bobbin thread tail the rest of the way up through the hole under the needle, so that it can hang over the edge of the machine as the needle thread does. Replace the bobbin cover. The machine is now threaded correctly.

## 2. Winding a bobbin (see below picture of back of machine)

Put a spool of thread on the spool pin. Wrap the thread around to the right of the bobbin winder tension disk (see arrow marked "1" on the machine). Wind the thread clockwise around the bobbin several times, or put the thread through a hole in the bobbin. Place the bobbin on the bobbin winder pin and push it to the left, towards the bobbin winder stop.



Turn on the power switch to start winding. It may be useful to guide the thread with your finger during winding, by carefully touching the thread in midair. CAUTION: Do not touch any moving parts of the machine while it is running.

Turn off the power switch when the desired amount of thread is wound on the bobbin. Push the bobbin back toward the right, remove it from the pin, and cut the thread.

## 3. Replacing the needle

Remove the batteries and/or unplug the power adapter before changing the needle.

Turn the hand wheel to raise the needle to its highest position.

Loosen the needle clamp screw. Remove the old needle.

Insert the new needle into the needle bar with the flat side of the needle toward the back of the machine. Push the needle up as far as it will go into the needle bar.

Tighten the needle clamp screw to hold the new needle in place.

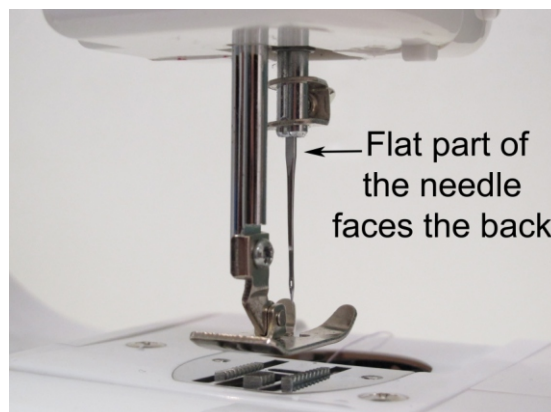

#### 4. Troubleshooting the bobbin holder

Occasionally, the bobbin holder may become loose and move freely within the throat of the machine. This can be remedied by removing the two screws holding the throat plate and repositioning the bobbin holder.

Raise the needle and presser foot. Take out the two screws and remove the throat plate. Align the bobbin holder with the back of the machine as shown in the picture below. The two tabs on the bottom of the throat plate will keep the bobbin holder in place. Put the plate back on. To check if the bobbin holder is aligned correctly, turn the hand wheel. The bobbin holder should not turn or get out of place anymore. Put the two screws back into the plate.

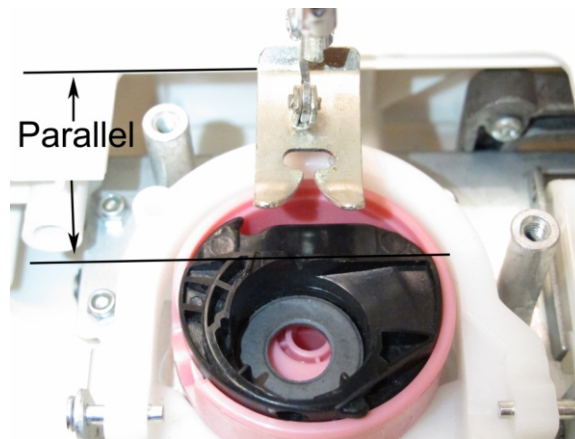

#### 5. Frequently asked questions

**Q. The stitches on top of the fabric look messy and loopy, or the stitches are too tight.**

A. This may mean there is no tension on the bobbin thread, or the top thread tension is too high. Make sure you are using a metal bobbin, since the bobbin tension system is magnetic. Take out the bobbin and look underneath it to make sure the ring-shaped magnet is still in place.

If the magnet is there and the bobbin is metal, but the problem continues, try adjusting the top thread tension. Turn the tension dial to a lower number until the stitching returns to normal.

**Q. The stitches on the underside of the fabric look messy and loopy, while the top stitches look normal.**

A. This usually means the top thread tension is too low. **IMPORTANT:** When you thread the top thread, make sure it is pressed between the two metal tension disks inside the machine, to the right of the tension dial. That is, make sure you pull the thread through guides 1 and 2 as marked on the machine, and make sure the thread stays there without falling out. This way, when you lower the presser foot, the tension disks will automatically close onto the thread.

If the stitches under the fabric are still loopy, you may need to tighten the tension by turning the dial to a higher number. For most sewing projects, tension should be 3, 4, or 5.

**Q. The machine keeps jamming up while sewing.**

A. The most common cause of jamming is that the top thread has no tension or low tension due to incorrect threading. Please follow the steps in the previous answer to solve this.

If that doesn't help, please try the following tips:

- Turn the hand wheel to lower the needle into the fabric before starting to sew. If you turn the machine on while the needle is still above the fabric, this can cause jamming.
- Make sure the needle is pushed up as far as it will go inside the needle bar (you may have to loosen the needle clamp screw to do this). Replace the needle if it is bent or broken. The flat side of the needle should face toward the back of the machine (toward the presser foot), and the needle should be threaded from front to back.
- The 12-stitch selection dial should always have the arrow pointing to a number, not stuck in between numbers.
- Make sure the bobbin holder is not turning or getting out of place when you turn the hand wheel. If it does get out of place, the needle may hit it, causing the machine to jam. The troubleshooting video on this web page shows how to adjust the bobbin holder so it stays in one place:



[tivax.com/collections/sewing-machines/products/desktop-sewing-machine-lss-505](https://www.tivax.com/collections/sewing-machines/products/desktop-sewing-machine-lss-505)

**Q. Why does the machine start sewing as soon as I turn it on? I haven't pressed the foot pedal yet.**

A. This is normal. When you are using the foot pedal, leave the power switch in the OFF position at all times, and the machine will start sewing when you press the foot pedal. If you want to use the machine without the foot pedal, use the power switch to start and stop sewing.

**Q. The power cord keeps falling out of the machine. How do I get it to stay in?**

A. This may mean that one of the pieces of metal in the power socket on the machine is not holding the power cord in place firmly enough. This can be fixed at home easily. Inside the power socket, you should see two pieces of metal. The one on the right is shaped like a stick, and the one on the left is flat. With a small tool such as a screwdriver, carefully bend the flat piece of metal slightly toward the right, so it is closer to the stick-shaped piece. After that, when you plug in the power cord, it should not fall out.

**Q. What size needle should I use?**

A. When buying replacement needles, look for standard sewing machine needles, size 14/90 (also called 90/14). These can be found at many craft stores, sewing stores, or major retailers.

**Q. What size bobbin should I use?**

A. The machine uses Class 15 metal bobbins. These can be found at many craft stores, sewing stores, or major retailers. Please make sure they are metal so they will work with the magnetic bobbin system.