



# **X600**

## **Quick Start Guide**

---

Visit [kaiserbaas.com](http://kaiserbaas.com) for more information

## Before operating your X600 please ensure you have read and understood the safety precautions

The X600 Action Camera has a waterproof body to a 12m depth (with doors securely closed/sealed). You won't need any additional waterproof case unless you are going below 12m.

Please ensure you remove the plastic protection film from the front lens and back screen before using.

**1**

### Charge your X600

Open the side door and connect your camera to a USB charger or computer using the included USB-C cable. To open the side door, hold down the latch release button on the side door and slide it down. Whilst charging the red light will appear. Once fully charged it will turn off.

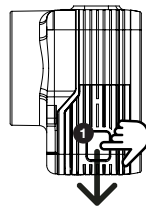
**2**

### Insert your SD Card

Once your camera is fully charged, insert the Micro SD card into the SD card slot inside the battery compartment. We recommend using a Class UHS 3 and above Micro SD card up to 128GB for maximum performance.

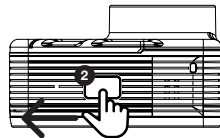

Note: Please ensure you format your SD card before you start filming with it for the first time.

3

### Format your SD Card before using the camera

Tap on the Settings icon (3) in the bottom right corner of the screen.

Tap to select the Settings icon the left of the screen. Scroll down the menu until you get to Format SD Card. Tap on Format SD Card. Tap on Confirm to format your SD Card.

NOTE: This will clear all data on the card and ensure it is ready for recording.

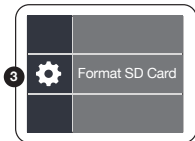
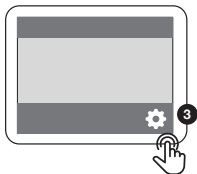

## Using your Camera

1

To turn your camera on/off - hold the Power/Mode button on the side of your X600 for few seconds.

2

Select from the following modes to capture your footage by scrolling down on the mode menu page: Video; Photo; Time Lapse Video; Time Lapse Photo; Slow Mo; Burst Mode; Self Timer; Photo & Video.

3

To access settings and change video/ image resolutions, tap the settings icon on the screen.

4

To start recording video, press the Record button on the top of your camera.

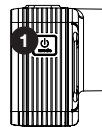

Side View

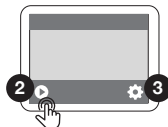

Back View

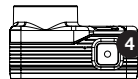

Top View

## Reviewing your footage

5

To review footage, tap the Playback icon on the screen.



Main Menu Screen

6

Scroll through the menu to select and review footage.



Playback Menu

7

Click on the back button to return to the main screen.

## Connecting to the KB Capture App

1

Turn on Wi-Fi on your camera by swiping down on the screen and then tapping the Wi-Fi icon

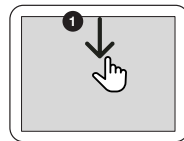

2

Go to your Smartphone settings and ensure your Wi-Fi is turned on. Select KB-X600 network. The default password is: 12345678.

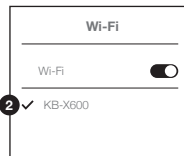

If your connection fails, please close down the App and relaunch it and restart the camera.



Visit [www.kaiserbaas.com/support](http://www.kaiserbaas.com/support) or email [helpdesk@kaiserbaas.com](mailto:helpdesk@kaiserbaas.com) for support. For the complete user guide, visit [www.kaiserbaas.com](http://www.kaiserbaas.com)

Scan these codes to access the KB-X600 App.

**X600 Action Cam**

14 Megapixels

**Video Resolution Options**

- 4K 30FPS (3840x2160) - Default
- 3K 30FPS (2880x2160)
- 2.7K 30FPS (2704x1520)
- 2.7K 30FPS (2704x2028)
- 1440P 60/30FPS (2560x1440)
- 1440P 60/30FPS (1920x1440)
- 1080P 60/30FPS (1920x1080)
- 1080P 60/30FPS (1440x1080)
- 720P 120/60/30FPS (1280x720)

**Photo Resolution (Image Size)**

16M, 14M, 12M, 8M, 5M, 3M

**Storage**

We recommend using a Class UHS 3 and above Micro SD card up to 128GB for maximum performance.

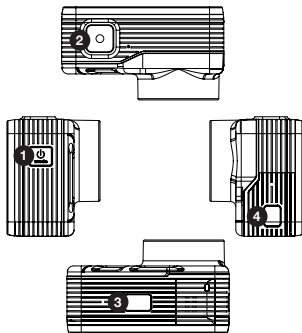

- |                  |                    |
|------------------|--------------------|
| 1. Power / Mode  | 4. Side Door Latch |
| 2. Record        | Release Button     |
| 3. Battery Latch |                    |
| Release Button   |                    |

**KAISER BAAS**