

fold
away **Petite**

Salcombe Edition Hutch



ASSEMBLY INSTRUCTIONS

Thank you for purchasing a Fold Away Petite - Salcombe Edition Hutch. If you have any questions regarding the assembly of this item please contact us on 0800 048 8606 (UK Customer Services). Outside of the UK please contact your local distributor.



Salcombe Edition Hutch

YOUR PARCELS WILL CONTAIN THE FOLLOWING PARTS

HARDWARE

	Connecting Bolt (CB1) QTY 30		Wooden Dowel (DOW1) - QTY 68		Cable Outlet (CAB1) - QTY 1
	Connecting Lock (CB1) QTY 30		Shelf Peg (SP1) QTY 36		Mini Connecting Lock (CB2) - QTY 2

PANELS

	Top QTY 1		Shelf QTY 1		Top CDIV QTY 2
	Right Side QTY 1		Long Back QTY 1		Bottom CDIV QTY 1
	Left Side QTY 1		Back QTY 1		9mm 4L Shelf QTY 4
	Sml Shelf QTY 1		Sml Back QTY 1		9mm 7L Shelf QTY 2
			Sml Shelf/Thread Rack QTY 1		

STEP 1

Insert connecting locks (CL1) as shown on the panel below. Screw mini connecting bolts into **two** of the holes indicated by a circle below.

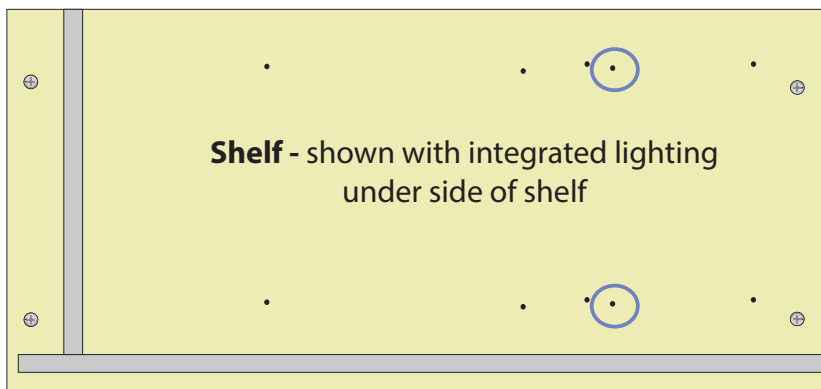

STEP 2

Turn the panel over and screw connecting bolts into the holes indicated by a circle.

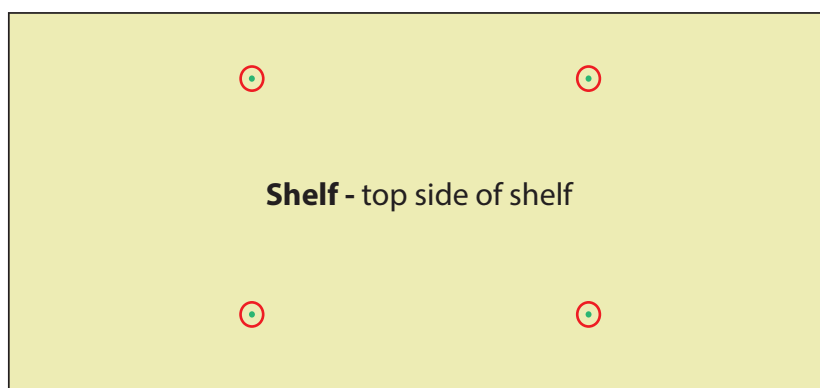
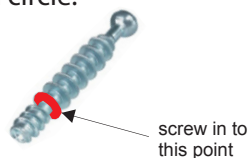

STEP 3

Insert connecting locks (CL1) as shown on the panels below

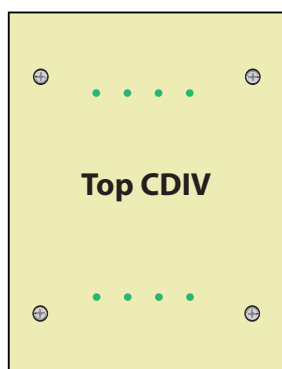

x2

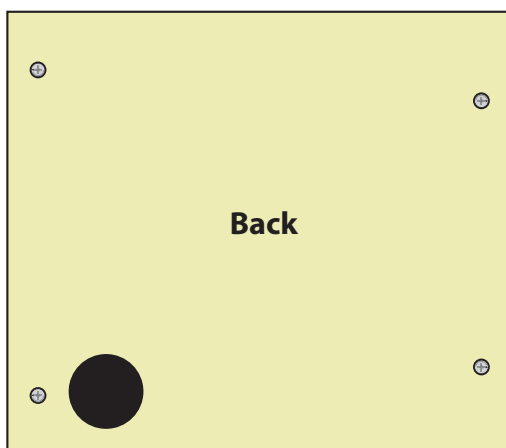

STEP 4

Screw connecting bolts into the **two** holes indicated by a circle below.

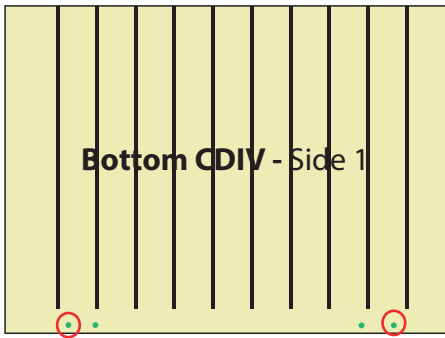

STEP 5

Turn the panel over and screw connecting bolts into the **two** holes indicated by a circle below.

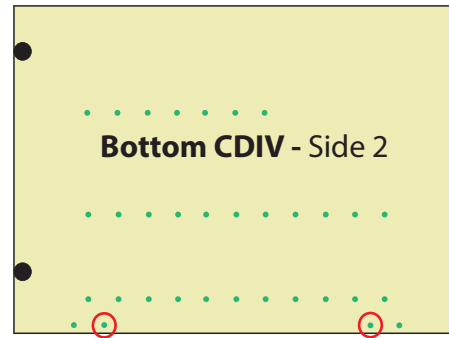

STEP 6

Attach the **shelf**, **bottom CDIV**, both of the **top CDIVs**, **back** and **small back** together as shown below. Once slotted together ensure you tighten all of the connecting locks.

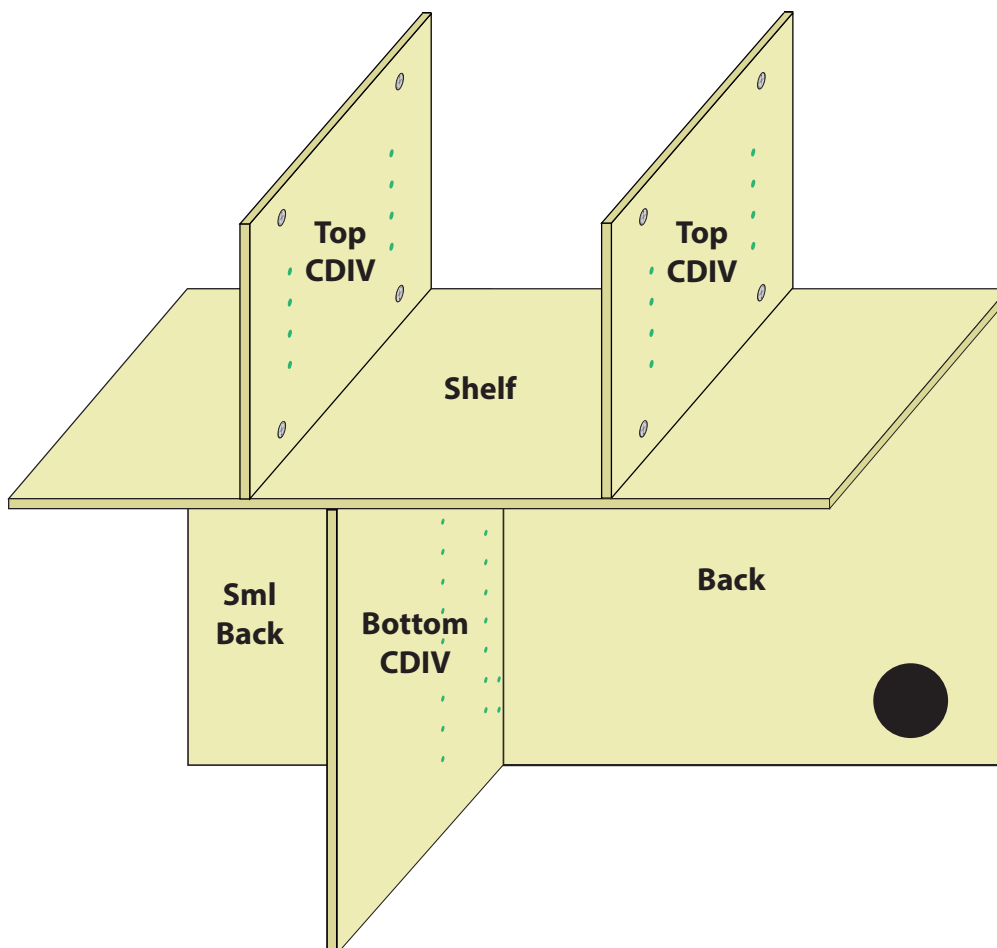

STEP 7

Insert connecting locks (CL1) as shown on the panels to the right. Screw connecting bolts into the holes indicated by a circle.

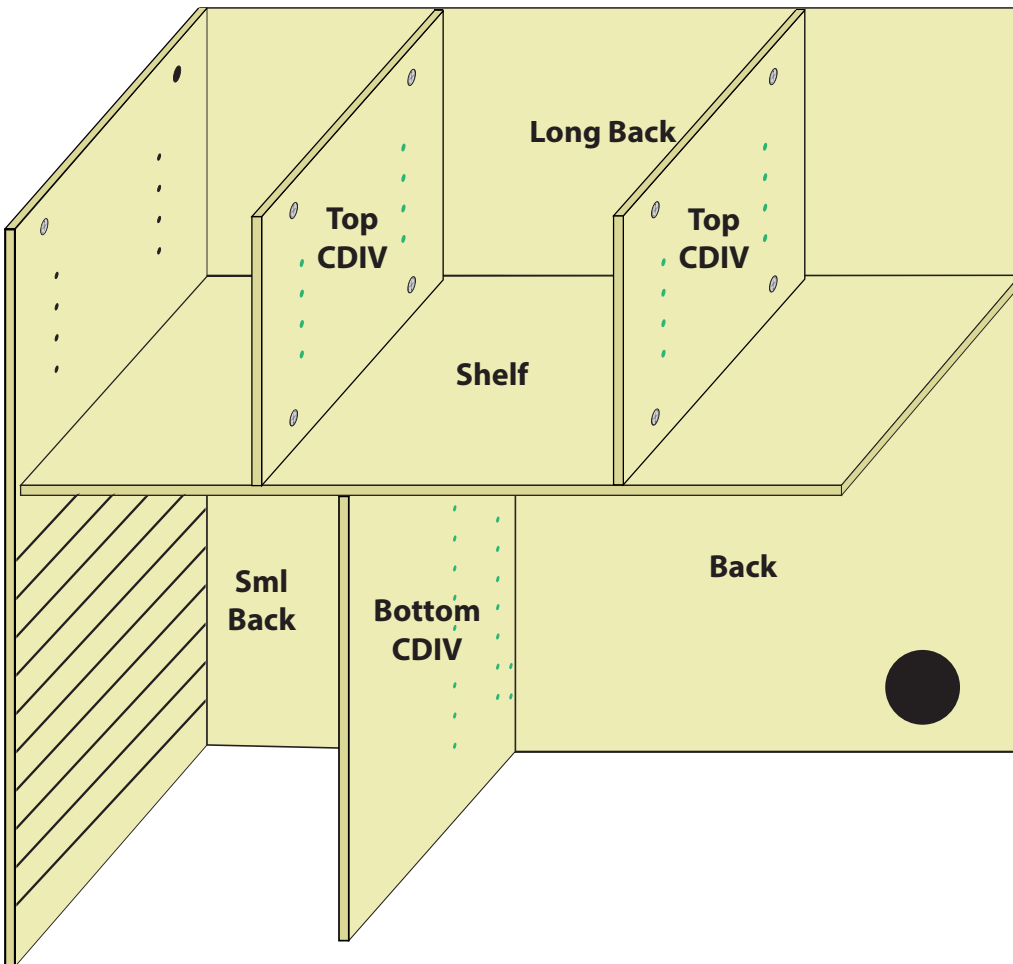
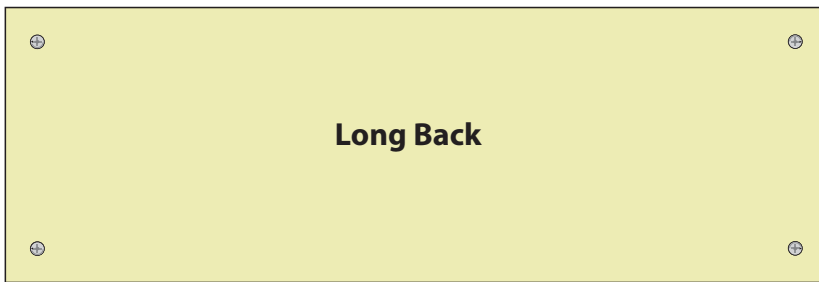
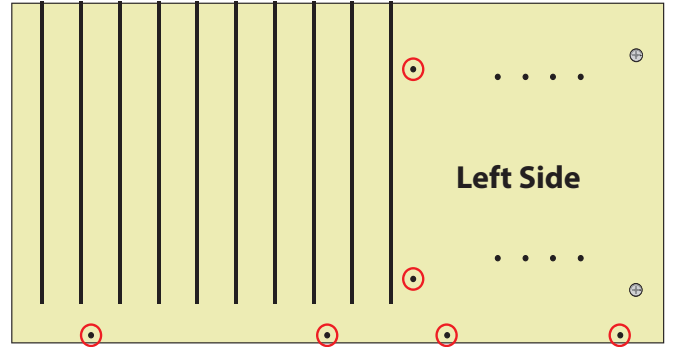
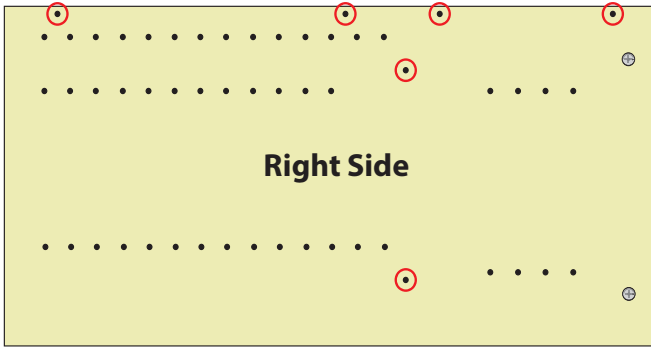

STEP 8

Attach the section you have already constructed, **long back** and **left side** together as shown below. Once slotted together ensure you tighten all of the connecting locks.

STEP 9

Attach the section you have already constructed and **right side** together as shown below. Once slotted together ensure you tighten the connecting locks.

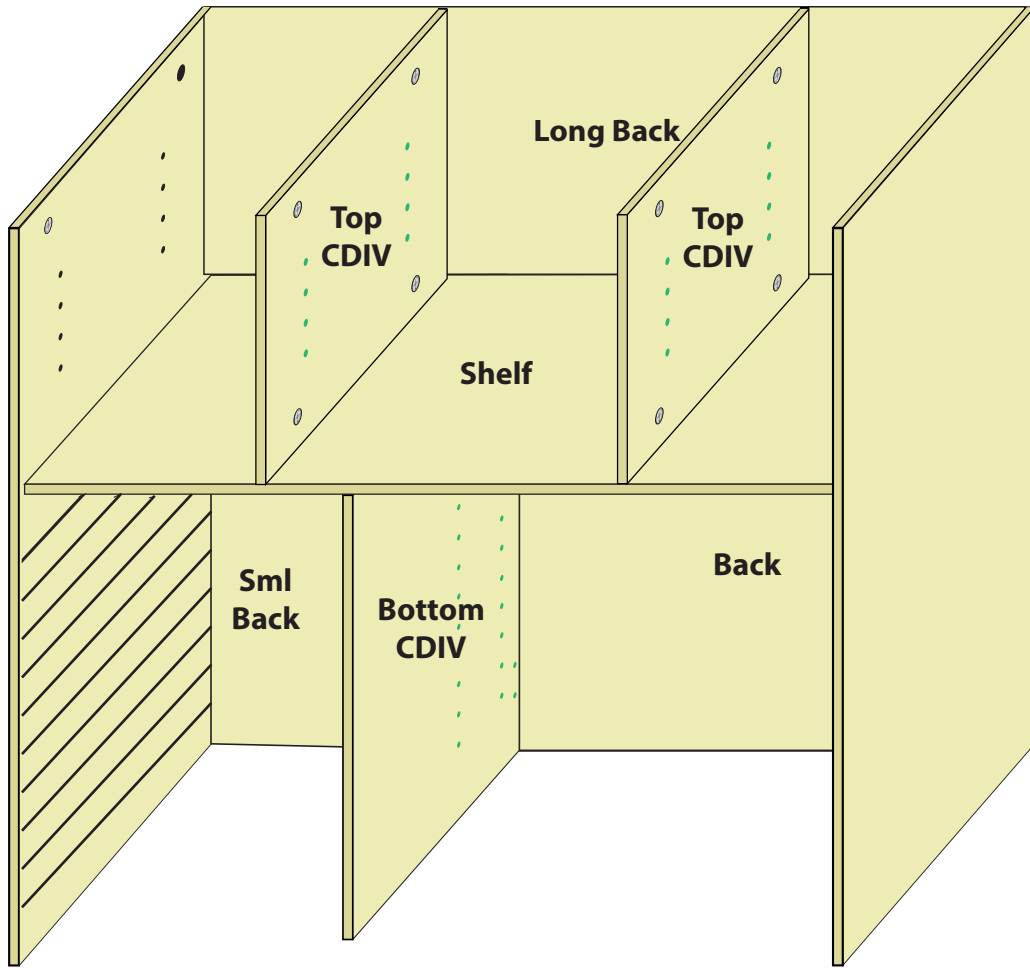

STEP 10

Screw connecting bolts into the holes indicated by a circle.

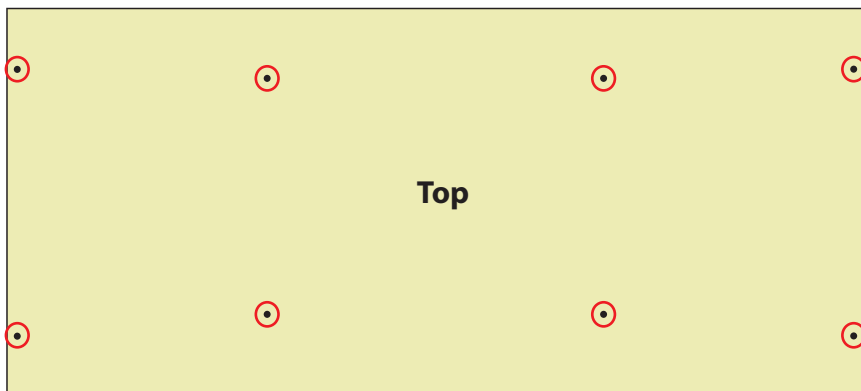

STEP 11

Attach the section you have already constructed and **top** together as shown below. Once slotted together ensure you tighten the connecting locks.

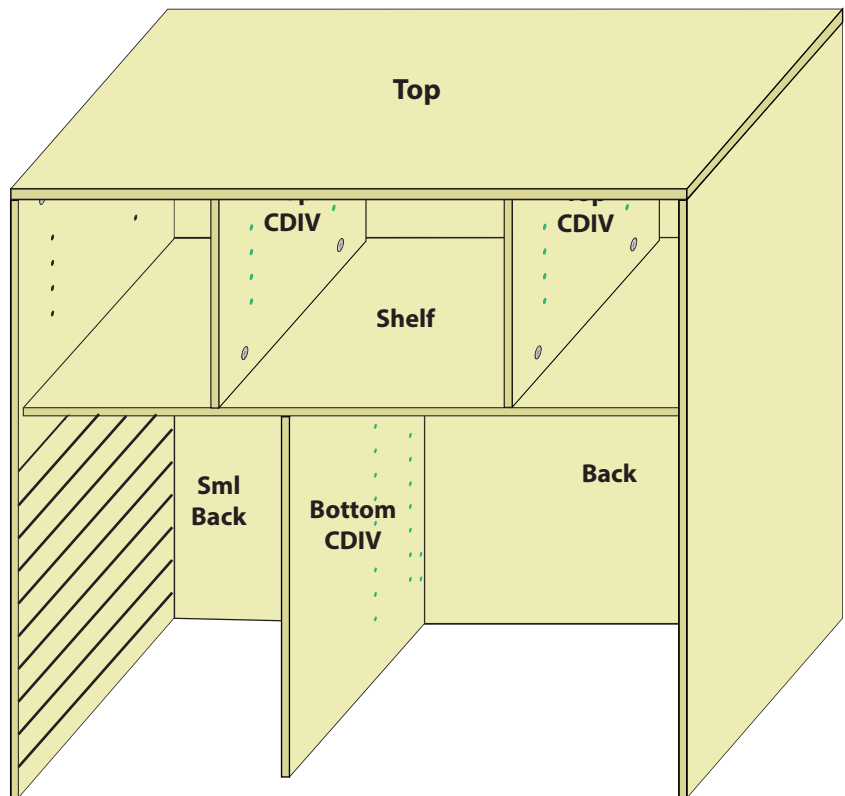

STEP 12

Insert shelf pegs and shelves as shown on the right to fit the Really Useful Boxes at the top of the unit.

Trays slot into the section on the left. Unlipped hobby trays can be used by placing them into one of the plain lipped trays. To use the deep 7 compartment tray place it onto a plain lipped tray and into the top slot as shown.



STEP 13

Insert shelf pegs and shelves to fit smaller boxes, ribbons and/or threads as shown to the right.

- To fit standard shelves use shelf pegs and simply sit the shelf on the pegs
- To store ribbons insert the shelf peg at the back one space lower than the one at the front so that the shelf is at an angle
- If you wish to store threads insert the dowels into the underside of the shelf that has been drilled. Then fit as shown below. If not this can be used a regular shelf

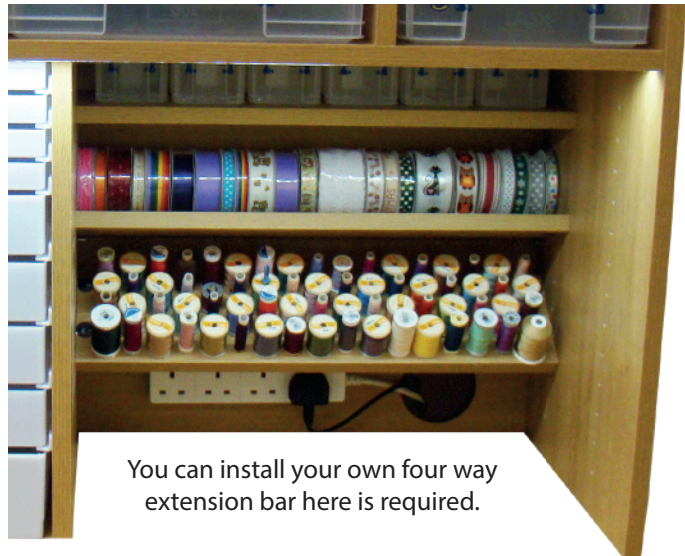

You can install your own four way extension bar here is required.

INSTALLING THE THREAD RACK (optional)

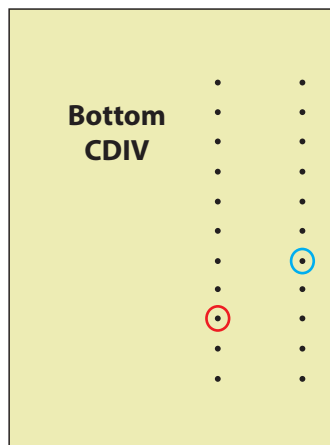

Screw a mini connecting bolt (CB2) into the hole marked with a red circle. Insert a shelf peg into the hole marked with a blue circle. Repeat on the side of the unit.

Rest the thread rack onto the shelf peg at the back and then lift the front up so the the mini connecting bolts slot into the corresponding fittings in the thread rack. Then tighten the locks so that the thread rack is secure

Thank you for purchasing a Storage 4 Crafts product.

Manufactured in the United Kingdom

www.storage4crafts.co.uk

Freephone: 0800 048 8606