



DB7 Quick Installation with BlueEye application

Locating the DB7

Mount the DB7 near the door to be monitored. Use the angle bracket (purchased separately) if needed to better supervise the area.

Powering the DB7

ALLOW 8 hours of charging before full function may be available

Connect the two power wires (recommend 24/0.20 up to 30 meters) to the 2 screws on the mounting base of the DB7. These are not polarity conscious so, 12-24 volts AC or DC can be used, minimum 10W power supply.



The DB7 requires 1A and 12 volts at the DB7 connection terminals over the supplied wires. Make sure the wires support this power. Connecting to the AUX terminals of the alarm panel will not receive enough current needed for correct operation.

Power Supply

When connecting the DB7 to power for the first time, the battery must be charged at least 60%, otherwise, not all functions may be available and the DB7 might shut down. Battery indication will be available in the BlueEye App after about 10 minutes.

Using Existing Doorbell Wires

Existing doorbell wires can be used, but **DO NOT** connect the DB7 in series with previously installed bell(s). The DB7 may NOT function after the battery will be drained out due to weak power supply.

Important Note

The installer requires a Paradox login so they can access the Installer Menu of BlueEye in order to generate the QR code of the Wi-Fi, so the DB7 so it can be added to the panel.

Adding the DB7 using Installer Section in BlueEye

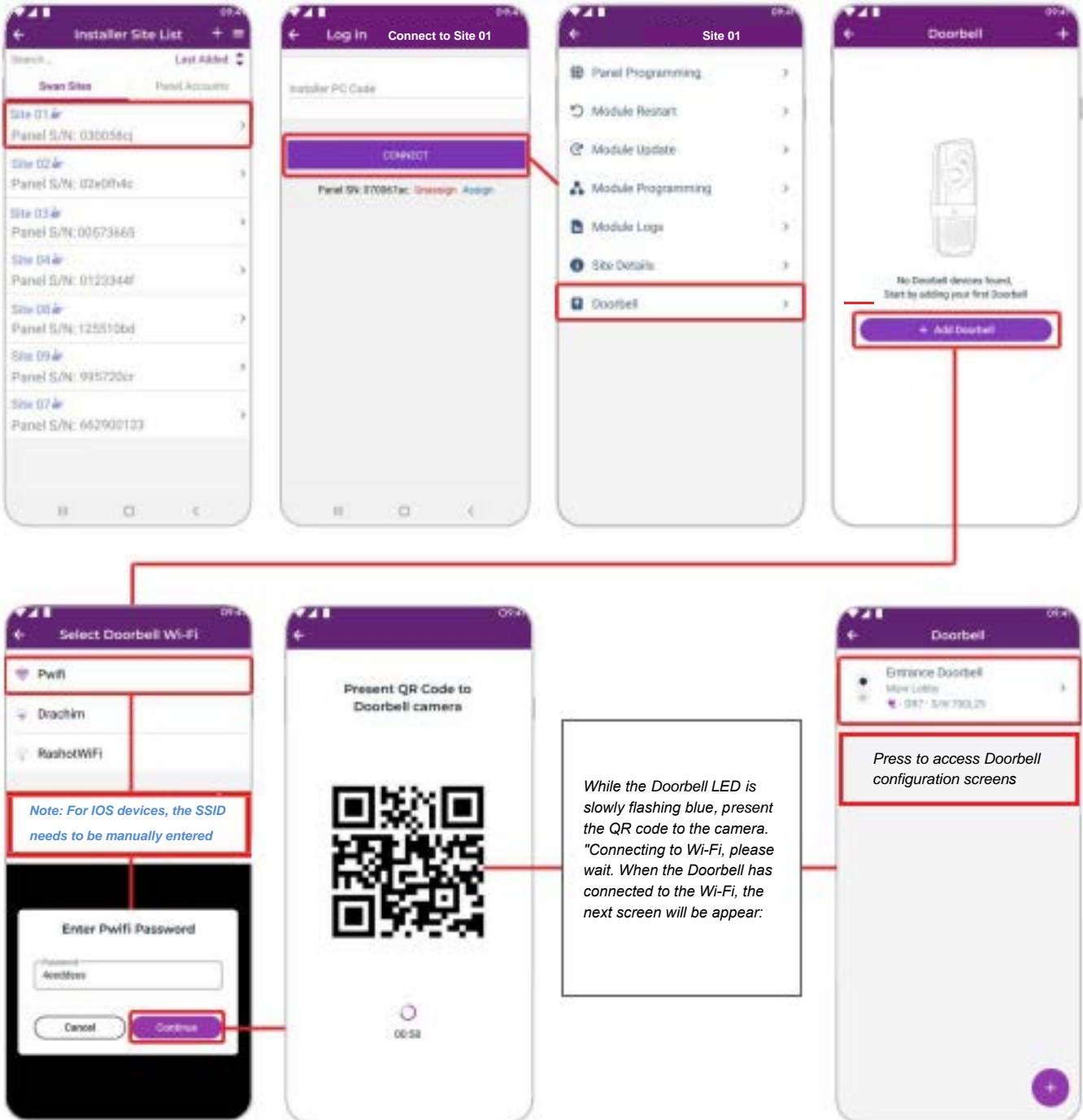

Doorbell Configuration

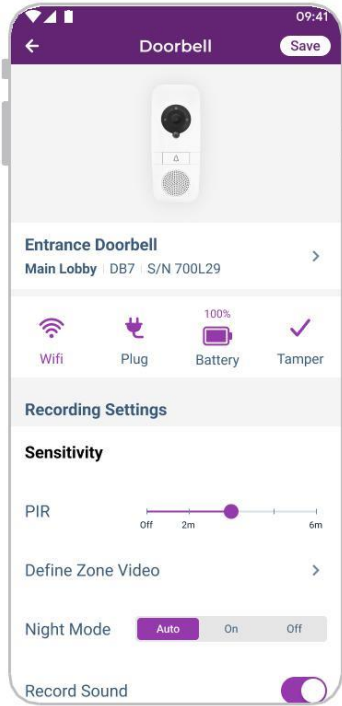

Wi-Fi Connection:

It is highly recommended to check that your Wi-Fi access point network is installed properly and that it does not have overlaps that may seriously affect the quality of connections. Please download the Wi-Fi Analyzer app, or similar to Picture 1, to scan the Wi-Fi networks (GPS location should be activated in most apps). Make sure that the Wi-Fi network the DB7 is connected to is not sharing the same frequency with another network, as per Picture 2. If there are at the same frequency with another network, as per Picture 3, you must change the channel frequency in the router as the video performance of the network will be affected.

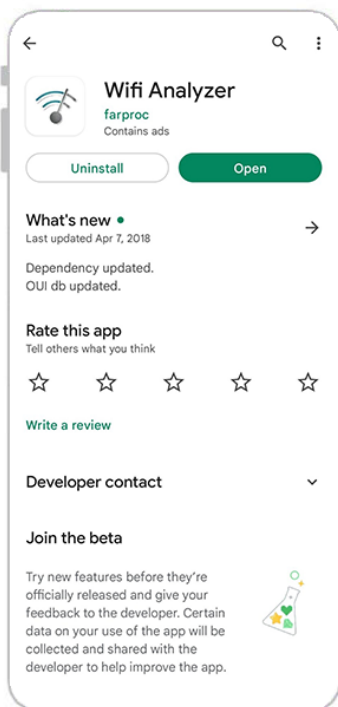

Picture 1

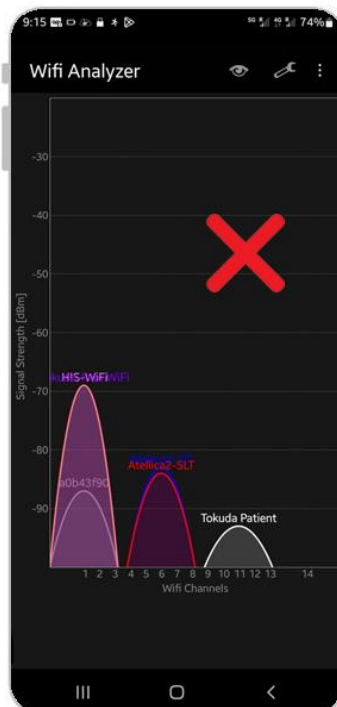

Picture 2



Picture 3

Choose **test**
Subscription Plan

	1 Year	3 Years
Swan Service Plan ⓘ	<input checked="" type="checkbox"/>	<input type="checkbox"/>
✓ 24/7 Connectivity, Push And Programming	\$14	\$38
✓ Doorbell Live Chat		10% SAVINGS
1 Doorbell Premium ⓘ	<input checked="" type="checkbox"/>	<input type="checkbox"/>
✓ Unlimited Calls and Events recordings	+\$36	+\$108
✓ 60 days Cloud Recording		10% SAVINGS
1 Doorbell Insurances ⓘ	<input checked="" type="checkbox"/>	<input type="checkbox"/>
✓ Theft/Damage Insured	+\$8	+\$24
Total	\$58.0	

Next

* Price excludes value added tax if applicable

1 year subscription

Choose **test**
Subscription Plan

	1 Year	3 Years
Swan Service Plan ⓘ	<input type="checkbox"/>	<input checked="" type="checkbox"/>
✓ 24/7 Connectivity, Push And Programming	\$14	\$38
✓ Doorbell Live Chat		10% SAVINGS
1 Doorbell Premium ⓘ	<input type="checkbox"/>	<input checked="" type="checkbox"/>
✓ Unlimited Calls and Events recordings	+\$36	+\$108
✓ 60 days Cloud Recording		10% SAVINGS
1 Doorbell Insurances ⓘ	<input type="checkbox"/>	<input checked="" type="checkbox"/>
✓ Theft/Damage Insured	+\$8	+\$24
Total		\$170.0

Next

* Price excludes value added tax if applicable

3 year subscription

Doorbell LED Indication (May vary from version to version)

Green solid	Connected to Wi-Fi and Paradox server (MQTT), normal operation
Green flashing	Speakerphone call in progress
Red flashing for 1 minute then solid	Lost Wi-Fi connectivity
Blue solid	Connected to Wi-Fi, No MQTT. Please confirm that the Wi-Fi network has unrestricted internet access
Blue flashing	Indicates QR code scanning mode
Purple solid	Firmware upgrading in process

Marking Site per Regulations

In many countries/counties it is required by law to indicate that the area is video supervised by a clear notice, by sign, or sticker. If it is required where the DB7 is installed, make sure you comply with the local regulations.

Thank you for choosing Paradox Products

PARADOX