

CANDY 2 TRUE WIRELESS EARBUDS USER MANUAL

CP-TW10

V21-11

1. Product Overview

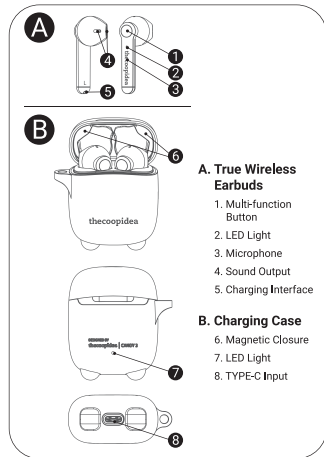

2. Inside the Box

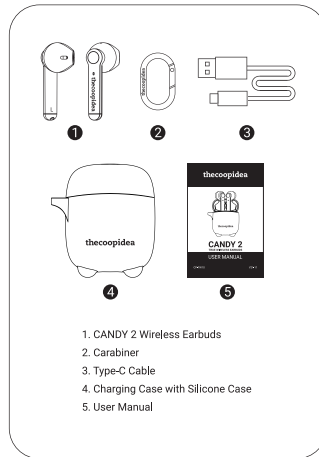

3. How to Charge

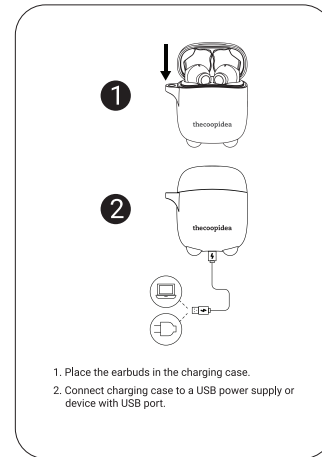

4. Battery Status

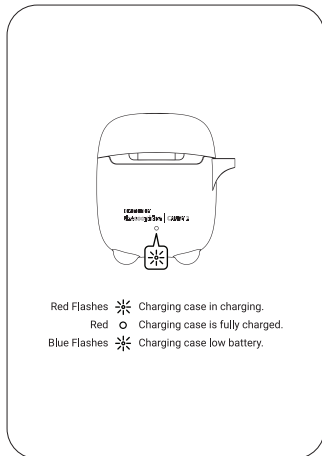

5. How to Wear

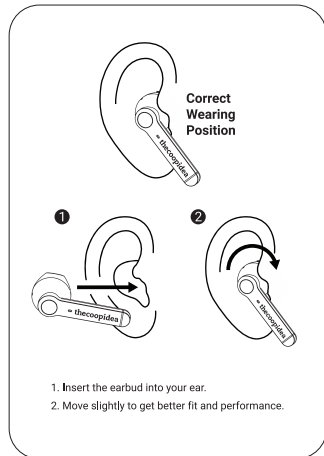

6. How to Pair (Auto-pairing)

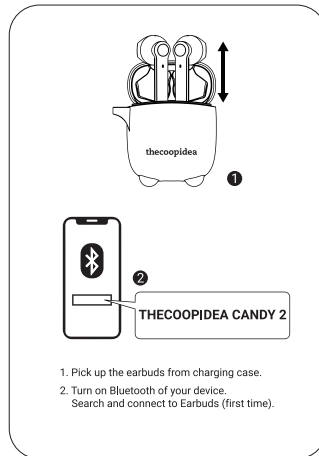

7. How to Turn On / Off Earbuds

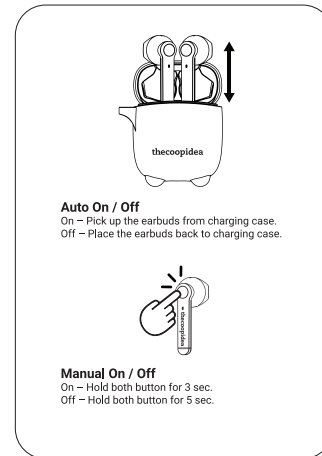

8. Call

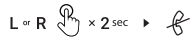
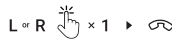
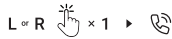
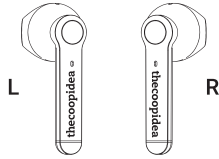

9. Music

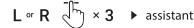
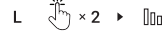
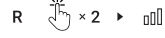
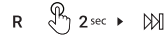
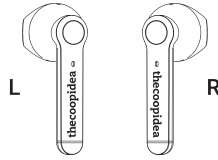

10. Full Control List

	L	R
Pick up call		• or •
Hang up		• or •
Reject call		• or •
Play/Pause		• or •
Next track		• or •
Previous track		• or •
Volume up		••
Volume down		••
Siri/Assistant	•••	•••

TAP HOLD 2SCE

11. Specification

Frequency Response	: 20 - 20000Hz
Wireless Version	: 5.0
Wireless Range	: 2.5 Hrs
Battery	: 300mAh
Input	: 5V/1A (Type-C)
Case Dimensions	: 56x46x24mm (LxWxH)
Case Net Weight	: 33.6g
Earbuds Net Weight	: 3.5g
Waterproof Rating	: IPX4
Stand by Time	: 50 Hrs
Playtime	: Up to 3Hrs Up to 8Hrs On-The-Go
Charging Time	: 60 mins (Earbuds) 90 mins (Charging Case)
Driver Size	: 10mm
Impedance	: 32 Ω
Antenna Type	: Ceramic Aantenna
Support Codec	: SBC,AAC
Support Profile	: HSP/HFP/A2DP/AVRCP
Mic	: Yes



12. Warning

- Always store the earbuds in the charging case and safely protected.
- Avoid storing the earbuds in hot or cold environments to prevent depletion of the battery capacity.
- Avoid storing the earbuds for extended periods of time without recharging them.
- If the earbuds or the charging case become dirty, it is recommended to clean them with a soft cloth that has been dampened with clean water.
- The OS version of mobile devices may affect performance of earbuds, it is recommended to update the OS of your mobile device to the latest version before use.
- It is strongly recommended to clean and dry the earbuds properly when it has been exposed to water and sweat.
- Don't put the earbuds into charging case while there is moist. Doing so can cause severe damage to the product. Earbuds charging case is not waterproof.
- Remove from power source once the product is fully charged. Extended periods

of over-charging will decrease battery life.

- Store the product in a dry area. Keep away from fire, heat, moist and erosive materials.
- Do not use rough chemical such as soap or cleanser to scrub the product.
- Do not disassemble, damage, or expose the product to water or fire. Warranty will be voided by any misuse of the product.
- If the battery is expanded or emits smell, stop using the product immediately.

thecoopidea

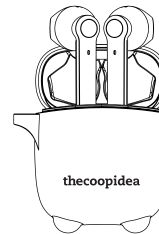

CANDY 2
TRUE WIRELESS EARBUDS

BOLD TO BE FREE
DARE TO BE DIFFERENT

For other languages and soft copy of the manual, please scan:



Find out more at:
www.thecoopidea.com

