

waterfloss

WaterFlo[®]sser

WF-450

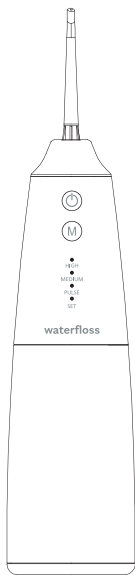

User Manual

Contents

Warranty - - - - -	02
Important Safeguards - - - - -	03
Warning - - - - -	04
Product Descriptions / Accessories - - - - -	05
Getting Started - - - - -	06
Jets Tips - - - - -	09
Advice for Use - - - - -	10
Cleaning & Storage - - - - -	11
Troubleshooting - - - - -	11

Warranty

Limited ONE-Year Warranty

Duro International Pte Ltd warrants to the original consumer/owner of this product that it is free from defects in material and workmanship for 12 months from the date of purchase. Consumer/owner will be required to send the product to Duro Sales & Service Centre, and submit original receipt as proof of purchase and eWarranty Registration Acknowledgement to support a warranty claim. Duro International Pte Ltd will repair or replace at its discretion any part of the product, which in its opinion is defective, provided the product has not been abused, misused, altered or damaged after purchase, was used according to instructions, and was use only with original accessories from WaterFloss. Installation and transportation are the responsibilities of the consumer/owner and are not covered by the warranty. This limited warranty excludes jet tips, Hose & Handleset, charging cable, etc.

eWarranty Registration

To be eligible for warranty coverage, the original purchaser must register the product online at www.duro.com.sg within 14 days from the date of purchase.

Helpful Tips

Check Battery Volume : When the product is in standby without any bright light (not in charging), press and hold the On/Off Button for 0.5 second to show the battery level indicator.

The number of Mode lights lit shows the amount of battery left in the water flosser.

Up to 100% - 4 Mode lights
Up to 75% - 3 Mode lights
Up to 50% - 2 Mode lights
25% and below - 1 Mode light

The Mode lights will flash when battery power falls below 20%.

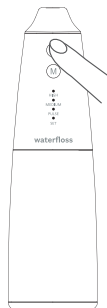

Important Safeguards

When using the water flosser, especially when children are present, basic safety precautions should always be followed, including the following:

READ ALL INSTRUCTIONS BEFORE USING THE WATER FLOSSER

DANGER:

To reduce the risk of electrocution:

- Do not handle socket, power adaptor and charging cable when hands are wet.
- Do not place in or immerse into water or other liquid.
- Do not place or store water flosser where it can fall or be pulled into a tub or sink.
- Check the power supply and the USB cord for damage before the first use and during the life of the product.

WARNING:

To reduce the risk of burns, electrocution, fire, or injury to persons:

- If product is opened/disassembled for ANY reason, warranty is VOID.
- Do not use this product if it has a damaged cord or plug, if it is not working properly, if it has been dropped or damaged, or dropped into water.
- Do not direct water under the tongue, into the ear, nose or other delicate areas. This product is capable of producing pressures that may cause serious damage in these areas.
- Use this product only as indicated in these instructions or as recommended by your dental professional.
- Only use tips and accessories recommended by WATERFLOSS.
- Do not drop or insert any foreign object into any opening or hose.
- Keep electrical cord away from heated surfaces.
- Do not use iodine or water insoluble concentrated essential oils in this product. Use of these can reduce performance and will shorten the life of the product. Use of these products may void warranty.
- Fill reservoir with water or other dental professional recommended solution only. Water temperature should not exceed 40°C.
- Remove any oral jewellery prior to use of this product. Do not use if you have an open wound on your tongue or in your mouth.
- Do not use if you have an open wound on your tongue or in your mouth.
- If your doctor has advised you to receive antibiotic premedication before dental procedures, you should consult your dentist before using this water flosser.
- Close supervision is necessary when this product is used by, on, or near children or people with special needs.
- Do not use this product for more than 4 minutes in each period, and the device is turned off for at least 10 minutes between uses.
- Unit will shut off automatically after 2 minutes of continuous usage.
- Children should be supervised to ensure that they do not play with the water flosser.
- Magnetic field: Pacemakers and similar implanted medical devices may be affected by magnet.

SAVE THESE INSTRUCTIONS

Product Description

Jet Tip
Release Button

Anti-Slip
Grip

USB-C
Charging Port

Flip Top
Water Inlet

Gravity Ball



Jet Tip

On/Off Button

Mode Switch Button

Indicator LED Lights

Water Tank

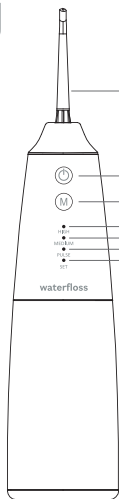

Notes: There may be some residual liquid in the product. This is the distilled water left after factory testing and inspection.

Product Accessories



2 x Standard Jet Tip
1 x Periodontal Pocket Tip
1 x Orthodontic Tip

1 x USB Charging Cable

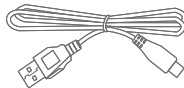

Getting Started

Charging the unit

1. Flip silicone cover from the charging port and insert USB Charging Cable supplied. **NOTE:** Make sure the charging port is dry before proceeding.
2. Plug other end of the USB Charging Cable to a USB power adaptor, power bank, laptop or car charger with output of **5.0 Volts, 1.0 Ampere**.
3. When charging, the LCD Indicator Lights will flash. When the unit is fully charged, the LED Indicator Lights will stay lighted.
4. Charge the water flosser for 8 hours before the first use or not been used for a long time. Subsequent charging time is between 4 - 5 hours.

CAUTION: Remember to reinstall silicone cover onto charging port after removing charging cable to prevent shortcircuit.

NOTE: This product cannot not be switched on and use while charging.

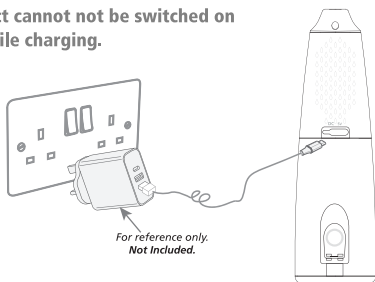

Filling Water

Method 1:

Flip open the Flip Top Water Inlet and hold the water flosser under a tap.

Press tight after filling up.

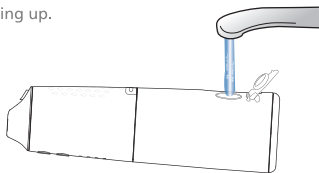

Method 2:

Hold the top half of the water flosser with one hand and the Water Tank with the other. Twist Water Tank anti-clockwise and pull apart.

Fill Water Tank with clean drinkable water. Align Gravity Ball into the Water Tank and twist clockwise to lock.

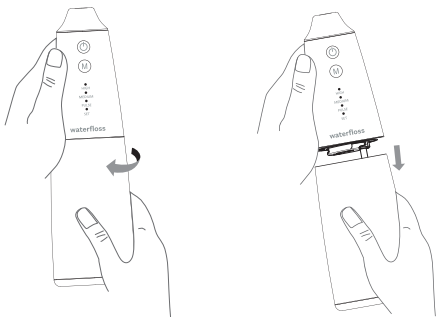

Installing and removal of Jet Tip

1. Insert the Jet Tip into the mounting hole; upon hearing the CLICK sound, installation is complete.
2. Press and hold the Jet Tip Release Button and pull Jet Tip upwards to remove with the other hand.

NOTE: Do not press Jet Tip Release Button when using the water flosser to prevent accidental injury.

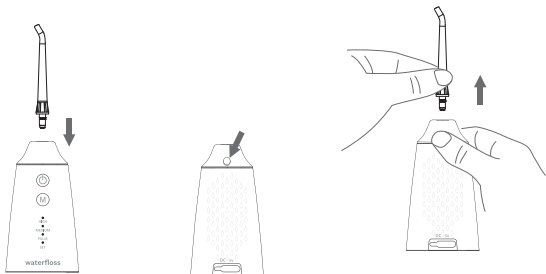

3 Modes of water flossing

HIGH mode: High pulse, strong pressure, deeper flossing for adults and strong teeth.

MEDIUM mode: For first time users, kids, or user with sensitive teeth and gums.

PULSE mode: Pulsed water jet, for massaging your gums.

SET mode: Pressure can be set from low to high, get the pressure right.

Setting Water Pressure in SET Mode

Press On/Off Button to turn on water flosser.
Press Mode Switch Button until it changes to SET. Press and hold Mode Switch Button to change the pressure from low to high.
Desired pressure setting will remain until you press and hold to change.

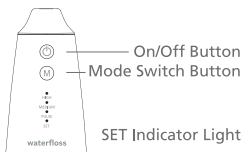

CAUTION: To avoid spraying everywhere, remove or empty Water Tank before turning on water flosser to set the pressure.

Using the Water Flosser

1. Fill up Water Tank with clean drinkable water.
2. Select your jet tip, dip into water and insert into jet tip mounting hole.
3. Press the Mode Switch Button to select the type of water flow you like.
4. Position the jet tip in your mouth.
5. Press and hold the On/Off Button to start the device.

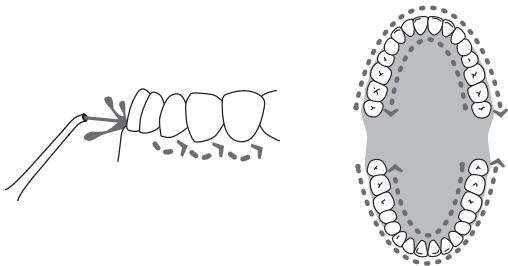

Helpful Tips

Never look into the mirror while using the water flosser. Water will splatter all over. Always position jet tip before powering ON.. You would want to bend over the basin with your lips partially closed, let the water run into the basin. You should point the jet tip at a 90 degree angle to your teeth, and allow jet tip to move along your gum line, pausing briefly at the spaces between your teeth.

We suggest that you start with your back molar, cleaning the front of your teeth, upper and lower, and then to the back of your teeth in the same manner. You can then finish by spending more time on area that needed additional attention or massaging your gum. When you are done, simply empty excess water into the basin.

SMART Timer



This unit is equipped with a 2-minute timer which will automatically shut down the device to prevent over heating. Allow device to rest shortly before restarting.

Jet Tips



The Standard Jet Tip (JT-450) is the classic tip for everyday use. It cleans deep between teeth and below the gumline to help prevent gum disease and improve your oral health.

Recommended to replace every 6 months.



The Periodontal Pocket Tip (PP-450) features a soft rubber tip designed for gentle, low-pressure delivery of therapeutic rinses below the gumline and periodontal pockets.

Recommended to replace every 3 months.

CAUTION: Always adjust water pressure to the lowest when using this tip.



The Orthodontic Tip (OD-450) has a tapered brush on the end to help remove plaque around braces and orthodontic brackets and wires. It also helps flush out bacteria and food residues trapped around the teeth and under the gumline.

Recommended to replace every 3 months.

Advice for use

- To avoid spraying everywhere, please make sure you have the jet tip pointed into your mouth before you turn the device on, and do not take the jet tip out of your mouth while it is working.
- For whom with sensitive teeth or beginners, lower pressure is recommended.
- Start with the lowest pressure setting when you use the Periodontal Pocket Tip (PP-450) to protect your gum.
- The Orthodontic Tip (OD-450) is also suitable for misaligned teeth.
- People who have not been flossing frequently or have sensitive gums may feel discomfort or bleeding when they start to use a water flosser. That discomfort or tendency to bleed will reduce gradually.
- A water flosser is an effective added tool for oral hygiene. It is not a replacement for brushing.
- The water flosser cannot replace your dentist, please visit your dentist for periodical checkup and consult if your teeth feel unwell continually.
- The water flosser can clean the teeth and gumline deeply and prevent the formation of dental calculus. If dental calculus has formed, you may need to go to the dentist for dental cleaning.

Cleaning & Storage

- **DO NOT** immerse device into water. Clean the device when necessary with a soft cloth and mild non-abrasive cleanser.
- If you've used mouthwash or another solution besides water, empty and then rinse the unit after to prevent clogging by filling the Water Tank with warm water and running the unit with jet tip pointed into the basin until it's empty. Leaving stale water in your Water Tank can cause bacteria to grow.
- Jet Tips are made of resin, so do not use hot water over 50°C.
- Hard water deposits may build up in your unit, depending on the mineral content of your water. If left unattended, this can hinder performance. Clean internal parts of the unit by adding 2 tablespoons of white vinegar or citric acid to a full Water Tank of warm water. Point the handle and jet tip into the basin. Turn unit on and run until Water Tank is empty. Rinse by repeating this process with a full Water Tank of clean warm water.
- When the device will not be used for an extended period (six months or more), be sure to fully charge it prior to storage. The unit contains a lithium battery. At the end of the battery life, please recycle at your nearest recycle centre per local requirement. The battery is not replaceable.

For more product information, kindly login to www.waterfloss.sg

Troubleshooting

Problem	Possible Cause	Remedy
Inadequate pressure.	Low battery.	Charge the device.
	Blocked nozzle of Jet Tip.	Test / replace with another Jet Tip.
Device lasts only a few minutes with full charge.	Defective charging cable.	Replace with new charging cable.
	Power adaptor faulty.	Change charging power source, eg. Power adaptor, power bank, etc.
	Dead battery.	Contact Service Centre.
Leakage between Jet Tip and mounting hole.	Jet Tip not fully installed.	Remove Jet Tip and reinstall.
Jet Tip leaks.	Tip is broken / cracked.	Replace with new Jet Tip.
Water leaks from Flip Top Water Inlet.	Flip Top Water Inlet is loose.	Press Flip Top Water Inlet firmly for tight seal.
	O-ring on Flip Top Water Inlet is dirty.	Clean O-ring and press firmly.
Device does not turn on.	Low battery, device kept idle for more than 3 months.	Activate the battery by recharging it for 8 hours.
Device stopped working suddenly.	Overheating protection is activated. Device will stop after 2 minutes of continuous use.	Restart device. Advisable to allow device to rest in between multiple uses.



Warranty Registration
www.duro.com.sg

Please register within 14 days
from the date of purchase.