

# waterfloss

## WaterFlosser

WF-100

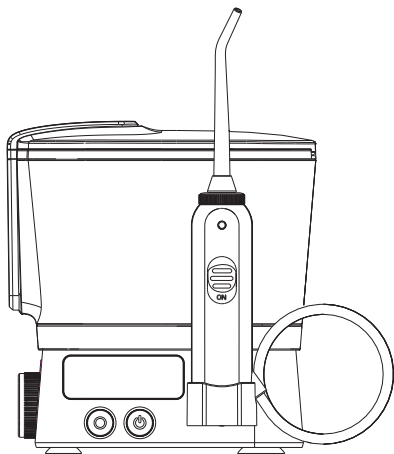

User Manual

# Contents

Warranty - - - - -	02
Important Safeguards - - - - -	03
Warning - - - - -	04
Product Descriptions / Accessories - - - - -	05
Getting Started - - - - -	06
Jets Tips - - - - -	08
Advice for Use - - - - -	09
Cleaning & Storage - - - - -	10
Troubleshooting - - - - -	11

# Warranty

## Limited ONE-Year Warranty

Duro International Pte Ltd warrants to the original consumer/owner of this product that it is free from defects in material and workmanship for 12 months from the date of purchase. Consumer/owner will be required to send the product to Duro Sales & Service Centre, and submit original receipt as proof of purchase and eWarranty Registration Acknowledgement to support a warranty claim. Duro International Pte Ltd will repair or replace at its discretion any part of the product, which in its opinion is defective, provided the product has not been abused, misused, altered or damaged after purchase, was used according to instructions, and was use only with original accessories from Water Floss. Installation and transportation are the responsibilities of the consumer/owner and are not covered by the warranty. This limited warranty excludes jet tips, Hose & Handleset, charging cable, etc.

## eWarranty Registration

To be eligible for warranty coverage, the original purchaser must register the product online at [www.duro.com.sg](http://www.duro.com.sg) within 14 days from the date of purchase.

## Helpful Tips

**Check Battery Volume :** When the product is in standby without any bright light (not in charging), press and hold the mode button for 0.5 second to show the battery level indicator.

The number of Mode lights lit shows the amount of battery left in the water flosser.

Above 61% - 3 Mode lights

31 to 60% - 2 Mode lights

30% and below - 1 Mode light

Charge the device when this symbol flashes on the LCD Display. 

## Important Safeguards

When using the water flosser, especially when children are present, basic safety precautions should always be followed, including the following:

### **READ ALL INSTRUCTIONS BEFORE USING THE WATER FLOSSER**

#### **DANGER:**

**To reduce the risk of electrocution:**

- Do not handle plug and charging cable when hands are wet.
- Do not place in or immerse into water or other liquid.
- Do not use while taking shower.
- Do not place or store water flosser where it can fall or be pulled into a tub or sink.
- Do not reach for water flosser that has fallen into water. Unplug immediately.
- Check the power supply and the USB cord for damage before the first use and during the life of the product.

## **WARNING:**

**To reduce the risk of burns, electrocution, fire, or injury to persons:**

- If product is opened/disassembled for ANY reason, warranty is VOID.
- Do not use this product if it has a damaged cord or plug, if it is not working properly, if it has been dropped or damaged, or dropped into water.
- Do not direct water under the tongue, into the ear, nose or other delicate areas. This product is capable of producing pressures that may cause serious damage in these areas.
- Use this product only as indicated in these instructions or as recommended by your dental professional.
- Only use tips and accessories recommended by WATERFLOSS.
- Do not drop or insert any foreign object into any opening or hose.
- Keep electrical cord away from heated surfaces.
- Do not use iodine or water insoluble concentrated essential oils in this product. Use of these can reduce performance and will shorten the life of the product. Use of these products may void warranty.
- Fill reservoir with water or other dental professional recommended solution only. Water temperature should not exceed 40°C.
- Remove any oral jewellery prior to use of this product. Do not use if you have an open wound on your tongue or in your mouth.
- Do not use if you have an open wound on your tongue or in your mouth.
- If your doctor has advised you to receive antibiotic premedication before dental procedures, you should consult your dentist before using this water flosser.
- Close supervision is necessary when this product is used by, on, or near children or people with special needs.
- Do not use this product for more than 4 minutes in each period, and the device is turned off for at least 10 minutes between uses.
- Unit will shut off automatically after 2 minutes of continuous usage.
- Children should be supervised to ensure that they do not play with the water flosser.
- Magnetic field: Pacemakers and similar implanted medical devices may be affected by magnet.

**SAVE THESE INSTRUCTIONS**

## Product Description

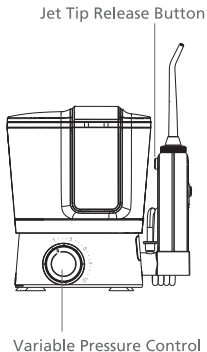
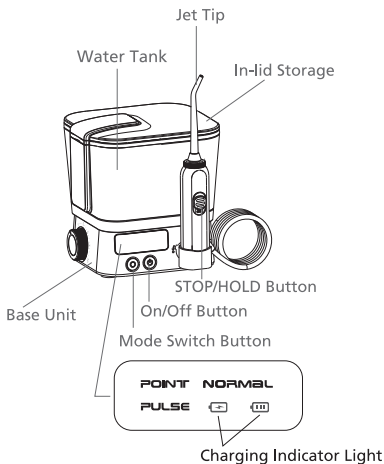

Notes: There may be some residual liquid in the product. This is the distilled water left after factory testing and inspection.

## Product Accessories



- 1 x Standard Jet Tip
- 1 x Periodontal Pocket Tip
- 1 x Orthodontic Tip
- 1 x Plaque Brush Tip
- 1 x Tongue Cleaner

- 1 x USB Charging Cable

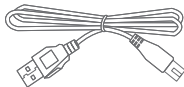

# Getting Started

## Assembly

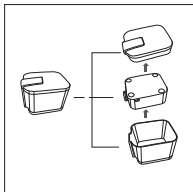

1. Remove the water flosser from the packaging and separate the In-lid Compartment, Base Unit and Water Tank.

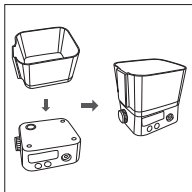

2. Position Water Tank onto the Base Unit and press to lock. (Please take note of direction.)

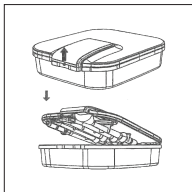

3. Open In-lid Compartment for jet tips and Hose & Handleset.

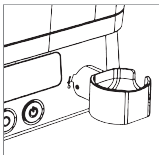
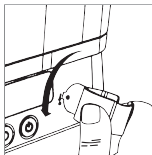
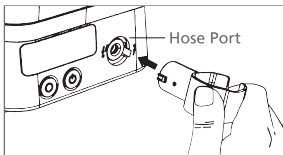

4. Insert the holder of the Hose & Handleset, press firmly into the hose port. Turn anti-clockwise till the holder is in a horizontal position. Do not over-turn.

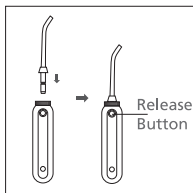

5. Choose a jet tip. Drip jet tip into water.

6. Insert the jet tip into the hole of the Handle. It locks with a click sound.

7. To remove jet tip, press the Jet Tip Release Button on the rear of handle.

## STOP/HOLD Button

During use you can stop the flow of water by sliding the STOP/HOLD Button to OFF position temporarily.

**CAUTION:** Do not stay at OFF position for more than 2 seconds with the device running. Turn off device if needed.

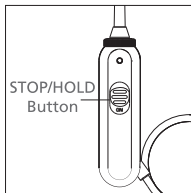

## Charging the unit

1. Remove silicone cover from the charging port and insert USB Charging Cable supplied. NOTE: Make sure the charging port is dry before proceeding.
2. Plug other end of the USB Charging Cable to a USB power adaptor, power bank, laptop or car charger with output of **5.0 Volts, 1.0 Ampere**.
3. When charging, the LCD display will flash RED breathing light. When the unit is fully charged, GREEN light will appear.
4. Charge the water flosser for 8 hours before the first use or not been used for a long time. Subsequent charging time is between 4 - 5 hours.

**CAUTION:** Remember to reinstall silicone cover onto charging port after removing charging cable to prevent shortcircuit.

**NOTE: This product cannot not be switched on and use while charging.**

## 3 Modes of water flossing

**NORMAL** mode: For general tooth and cleaning of the gum line. Water will shoot constantly with pulsation at a rate between 1250 - 1700 PPM.

**PULSE** mode: For massaging. Water will shoot continuously, alternating between high and low pressure.

**POINT** mode: For spot cleaning. Water will shoot for 1 second and pause for 1 second. This allows user to move the jet tip to another cleaning spot.

## Adjusting water pressure

Turn Variable Pressure Control dial on the side of the Base Unit to the lowest for first time user. Gradually increase pressure by turn dial clockwise over to the setting you are comfortable with, or as advise by your dentist.

## Using the Water Flosser

1. Fill up Water Tank with clean drinkable water.
2. Select your jet tip, dip into water and insert into the Hose & Handleset.
3. Press the Mode Switch Button to select the type of water flow you like.
4. Position the jet tip in your mouth.
5. Press and hold the On/Off Switch for 0.5 seconds to start the unit.

## Helpful Tips

Never look into the mirror while using the water flosser. Water will splatter all over. Always position jet tip before powering ON.. You would want to bend over the basin with your lips partially closed, let the water run into the basin. You should point the jet tip at a 90 degree angle to your teeth, and allow jet tip to move along your gum line, pausing briefly at the spaces between your teeth.

We suggest that you start with your back molar, cleaning the front of your teeth, upper and lower, and then to the back of your teeth in the same manner. You can then finish by spending more time on area that needed additional attention or massaging your gum. When you are done, simply empty excess water into the basin.

### SMART Timer



This unit is equipped with a 2-minute timer which will automatically shut down the device to prevent over heating. Allow device to rest shortly before restarting.

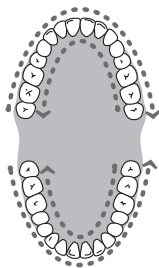

## Jet Tips



The Standard Jet Tip (JT-100) is the classic tip for everyday use. It cleans deep between teeth and below the gumline to help prevent gum disease and improve your oral health.

Recommended to replace every 6 months.





The Periodontal Pocket Tip (PP-100) features a soft rubber tip designed for gentle, low-pressure delivery of therapeutic rinses below the gumline and periodontal pockets.

Recommended to replace every 3 months.

**CAUTION:** Always adjust water pressure to the lowest when using this tip.



The Plaque Brush Tip (PS-100) removes plaque around all types of dental work and hard-to-reach areas. It has 3 thin tufts of bristles that gently access stubborn plaque around dental implants, crowns, bridges, veneers, and other areas that are especially prone to plaque growth.

Recommended to replace every 3 months.



The Orthodontic Tip (OD-100) has a tapered brush on the end to help remove plaque around braces and orthodontic brackets and wires. It also helps flush out bacteria and food residues trapped around the teeth and under the gumline.

Recommended to replace every 3 months.



With a gentle scraping and flushing action, the Tongue Cleaner (TC-100) removes bacteria and sulfur compounds that reside on the tongue and cause bad breath. Start with low pressure and increase gradually to your preference.

Recommended to replace every 6 months.

## Advice for use

- To avoid spraying everywhere, please make sure you have the jet tip pointed into your mouth before you turn the device on, and do not take the jet tip out of your mouth while it is working.
- For whom with sensitive teeth or beginners, lower pressure is recommended.
- Start with the lowest pressure setting when you use the Periodontal Pocket Tip (PP-100) to protect your gum.
- The Orthodontic Tip (OD-100) is also suitable for misaligned teeth.
- People who have not been flossing frequently or have sensitive gums may feel discomfort or bleeding when they start to use a water flosser. That discomfort or tendency to bleed will reduce gradually.

- A water flosser is an effective added tool for oral hygiene. It is not a replacement for brushing.
- The water flosser cannot replace your dentist, please visit your dentist for periodical checkup and consult if your teeth feel unwell continually.
- The water flosser can clean the teeth and gumline deeply and prevent the formation of dental calculus. If dental calculus has formed, you may need to go to the dentist for dental cleaning.

## Cleaning & Storage

- **DO NOT** immerse Base Unit into water. Clean the device when necessary with a soft cloth and mild non-abrasive cleanser.
- If you've used mouthwash or another solution besides water, empty and then rinse the unit after to prevent clogging by filling the Water Tank with warm water and running the unit with jet tip pointed into the basin until it's empty. Leaving stale water in your Water Tank can cause bacteria to grow.
- Jet Tips are made of resin, so do not use hot water over 50°C.
- Hard water deposits may build up in your unit, depending on the mineral content of your water. If left unattended, this can hinder performance. Clean internal parts of the unit by adding 2 tablespoons of white vinegar or citric acid to a full Water Tank of warm water. Point the handle and jet tip into the basin. Turn unit on and run until Water Tank is empty. Rinse by repeating this process with a full Water Tank of clean warm water.
- When the device will not be used for an extended period (six months or more), be sure to fully charge it prior to storage. The unit contains a lithium battery. At the end of the battery life, please recycle it at your nearest recycle centre per local requirement. The battery is not replaceable.

For more product information, kindly login to [www.waterfloss.sg](http://www.waterfloss.sg)

## Troubleshooting

<b>Problem</b>	<b>Possible Cause</b>	<b>Remedy</b>
The Water Tank is unstable / water leaks in-between Base Unit.	The Water Tank is not tightly pressed.	Align the tank valve with base unit valve and press gently.
Water does not shoot out after switching on.	Water Tank valve is in improper position, air trapped inside Hose & Handleset.	Reposition Water Tank, place handle 20cm below Base Unit, adjust pressure to maximum, and shake several times.
Inadequate pressure.	Low battery.	Charge the device.
Device lasts only a few minutes with full charge.	Blocked nozzle of Jet Tip.	Test / replace with another Jet Tip.
	Defective charging cable.	Replace with new charging cable.
	Power adaptor faulty.	Change charging power source, eg. Power adaptor, power bank, etc.
Leakage between Jet Tip and Handleset.	Dead battery.	Contact Service Centre.
	Jet Tip not fully installed.	Remove Jet Tip and reinstall.
Jet Tip leaks.	Tip is broken / cracked.	Replace with new Jet Tip.
	Hose is broken.	Replace with new Hose & Handleset.
Water leaks from hose.	Low battery, device kept idle for more than 3 months.	Activate the battery by recharging it for 8 hours.
Device does not turn on.	Overheating protection is activated. Device will stop after 2 minutes of continuous use.	Restart device. Advisable to allow device to rest in between multiple uses.



**Warranty Registration**  
**[www.duro.com.sg](http://www.duro.com.sg)**

Please register within 14 days  
from the date of purchase.