

ACCUFRO

**Model:DB100/DBW100
DB200/DBW200 (Wi-Fi model)
DB210/DBW210 (RFID + PCT model)**

Digital Beam Scale

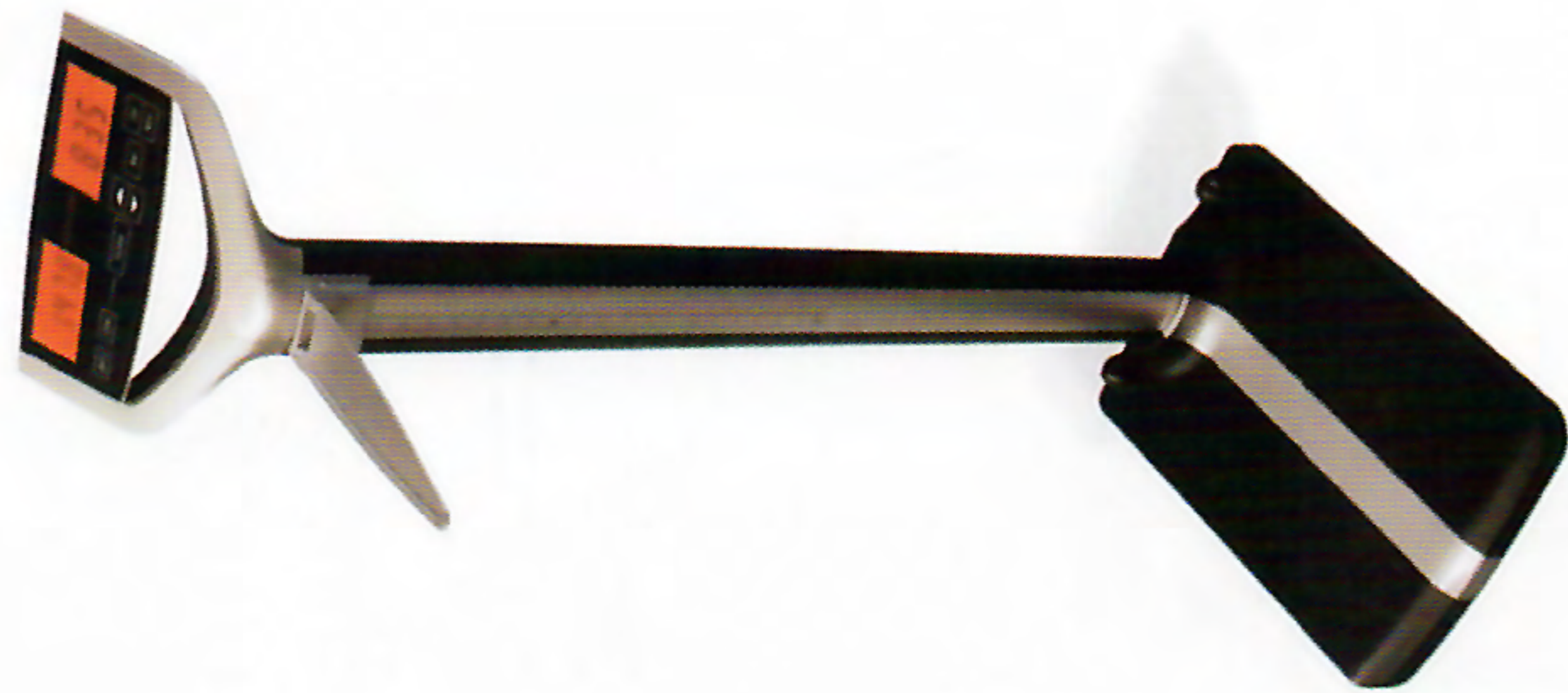

Disposal

Disposing of the device

Batteries

Do not dispose of the device in domestic waste. The device must be disposed of properly as electronic waste. Follow the national regulations which apply in your case. For further information, contact our service department at:

support@accuroweigh.com

Do not throw used batteries away in domestic waste. Dispose of batteries at collection points in the vicinity. When buying new batteries, select those low in harmful substances and containing no mercury (Hg), cadmium (Cd) or lead (Pb).

Warranty

A one-year warranty from date of delivery applies to defects attributable to poor materials or workmanship. All moveable parts - batteries, cables, mains units, rechargeable batteries etc. - are excluded. Defects which come under warranty will be made good for the customer at no charge on production of the receipt. No further claims can be entertained. The costs of transport in both directions will be borne by the customer should the equipment be located anywhere other than the customer's premises. In the event of transport damage, claims under warranty can be honored only if the complete original packaging was used for any transport and the scale secured and attached in that packaging just as it was when originally packed. All the packaging should therefore be retained.

A claim under warranty will not be honored if the equipment is opened by persons not expressly authorized by **Accuro** to do so.

Accuro scales' liability under this warranty is limited to the repair or replacement of the defective product and in no event shall NCI Technology, Inc. be liable for consequential or indirect damages to equipment or personnel.

Table of Contents

Congratulations!	3
Safety	3
Before you start	4
Operation	5
Assembly Instructions	8
Connecting DB200/210 or DBW200/210 scale to Network (Models with Wi-Fi and RFID feature)	11
Cleaning	15
What do I do if...	15
Maintenance	16
Technical data	16
Disposal	17
Warranty	17

Congratulations!

The **Accuro Digital Beam Scale** you have purchased is a high-precision yet sturdy piece of equipment. In accordance with national regulations, the **Accuro Digital Beam Scale** is used primarily in hospitals, gyms, and in-patient nursing facilities. Weight is determined within a few seconds. In addition to the conventional determination of weight, the **Accuro Digital Beam Scale** also has a function for determining body mass index. For this purpose, height is entered on the keypad and the body mass index associated with the weight value is output. The scale is of a very sturdy construction and will give you long and loyal service. It is easy to operate and the large display is easy to read. The **Accuro Digital Beam Scale** can easily be moved on its 1.5" wheels.

Safety

Before using the new scale, please take a time to read the following safety instructions.

- Follow the instructions in the instructions for use.
- Do not drop the scale or subject it to violent shocks.
- Use only the type of battery stated.
- Have scale serviced and re-calibrated on a regular basis.
- Have repairs carried out only by authorized persons.

Maintenance

To ensure that the scale accuracy is maintained, the product must be carefully set up and regularly maintained. Depending on the frequency of use, we recommend servicing every 3 to 5 years. Please ensure that a qualified service agent is used. If in doubt, contact Accuro Customer Service for further information.

Changing the batteries

When Low Batt appears in the display, you should change the batteries. You need 4-AA batteries.

- Carefully turn over the scale so that the base of the scale is accessible.
- Push the battery compartment closure towards "Battery" and open the cover.
- Remove the used batteries and insert new batteries in the holder.

Technical data

Dimensions	DB100/200/210	DBW100/200/210
Width:	15"	15"
Height:	53"	36"
Depth:	22"	22"
Platform Size	15" x 17" x 2"	15" x 17" x 2"
Weight	27 lbs	23.7 lbs
Power supply	AC-Transformer	AC-Transformer
Batteries	4 AA-size	4 AA-size
LCD	1½" LCD text character w/orange back light	1½" LCD text character w/orange back light
Capacity	500lb x 0.1 lb (225 kg x 0.05 kg)	500lb x 0.1 lb (225 kg x 0.05 kg)
Accuracy	+/- 0.1 lb, 0.05 kg	+/- 0.1 lb, 0.05 kg

Cleaning

Clean the rubber surface and the housing as required using a domestic cleaning agent or commercially-available disinfectant. Follow the manufacturer's instructions.

Under no circumstances use abrasive or acid cleaners, white spirit, benzene or the like for cleaning. Such substances can damage the high-quality surfaces.

What do I do if...

- ... **no weight display comes on?**
 - Check the batteries.
 - Is the plug connector on the scale properly connected?
- ... **0.0 does not appear before the weighing operation?**
 - Press the Zero button to turn on the scale
 - there is no load on the scale
- ... **---- appears instead of 0.0 before weighing?**
 - Press the Zero button
 - there is no load on the scale.
- ... **one segment is illuminated constantly or not at all?**
 - The relevant segment has a fault. Contact the Service dept for more info.
- ... **Low Batt appears in the display?**
 - Batteries are low. Replace with a new set of batteries.
- ... **ou Ld appears in the display?**
 - Maximum load has been exceeded.

Before you start...

Unpacking

Carefully remove the scale from the shipping carton. If you notice any shipping damage to the product, please contact the shipper immediately. Please retain all shipping material in case the product needs to be returned or the scale needs to be shipped to another location.

Remove the packaging and place the scale on a firm, level surface. The scope of supply includes:

Model: DB100/200/210	Model:DBW100/200/210
• Weighing platform	• Weighing platform
• Column with display indicator	• Column with display indicator
• 4 mounting screws to attach the base	• 4 mounting screws to attach the base
• Height Rod with Lever	• 4-AA batteries
• 4-AA batteries	• AC-Transformer
• AC-Transformer	• PCT (Personal Connectivity Tag)
• PCT (Personal Connectivity Tag)	(For Model DBW210)
(For Model DB210)	

Power supply

The scale is generally powered by the supplied AC-Transformer. 4-AA batteries are used as a power back-up and will supply enough power to power the scale for 7 days.

- Carefully turn over the scale so that the base of the scale is accessible.
- Push the battery compartment closure towards "Battery" and open the cover.
- Install the supplied 4-AA batteries.
- Close the cover and then turn the scale back up the right way.

The AC power connection socket for the main unit is in the rear of the base of the scale.

Operation

Display Module Types

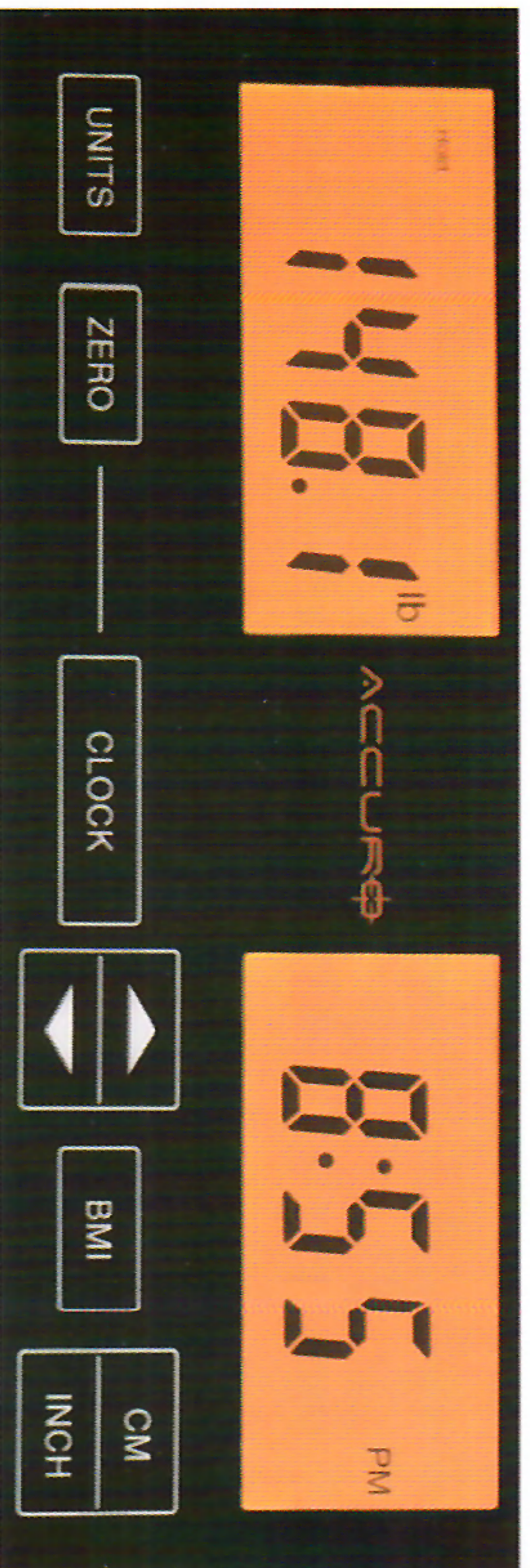

DB100/DBW100

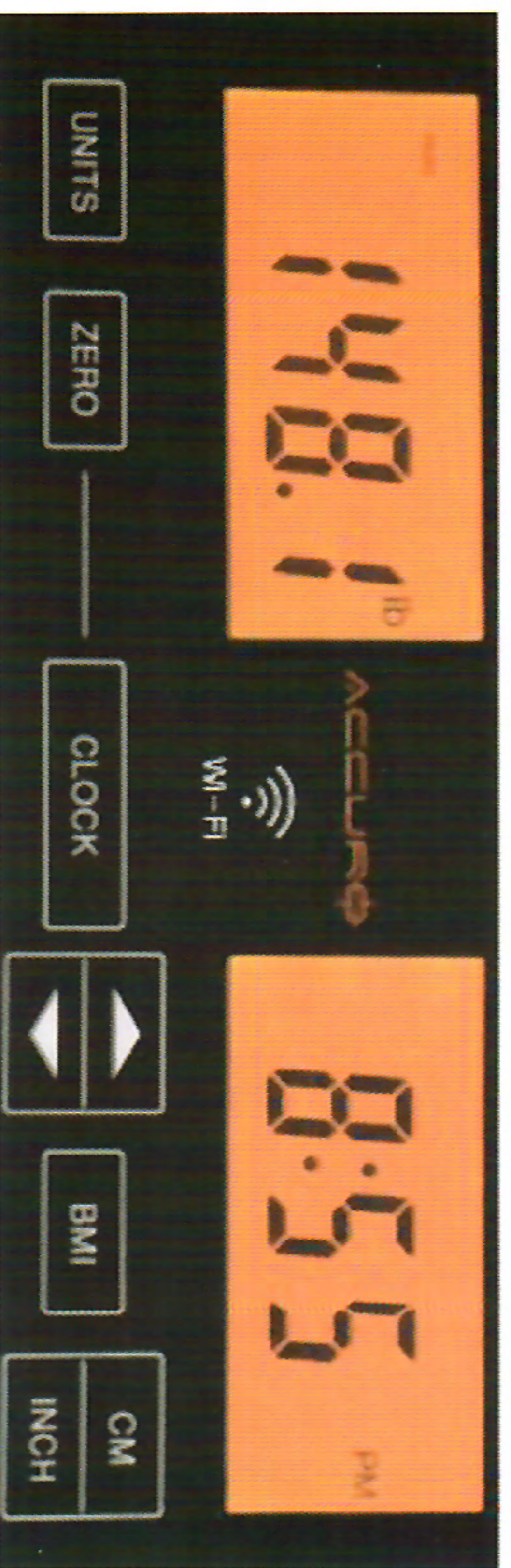

DB200/DBW200 (WiFi model only)

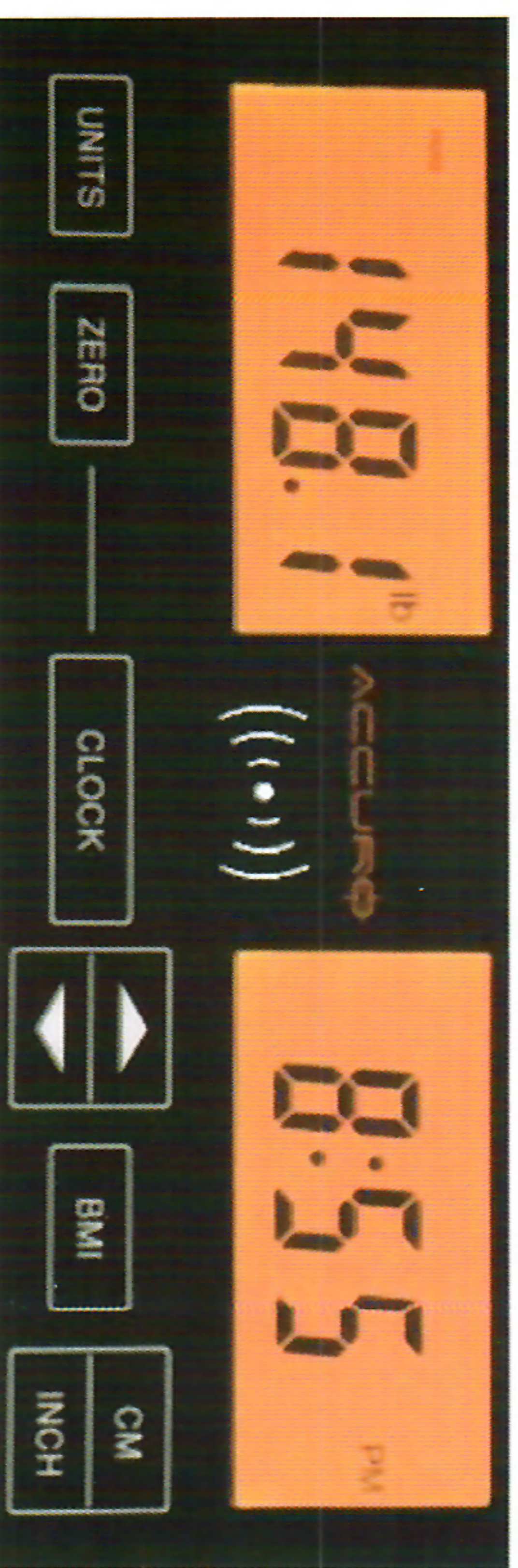

DB210/DBW200 (RFID model only with PCT Tag)



If you did not previously create a profile or do not have a PCT tag (will obtain PCT at a later time) you can still register for an account. Select "Without a Tag ID" button and enter your Body Weight and Height Information. Proceed to enter your email and create password and select Register. You are finished!

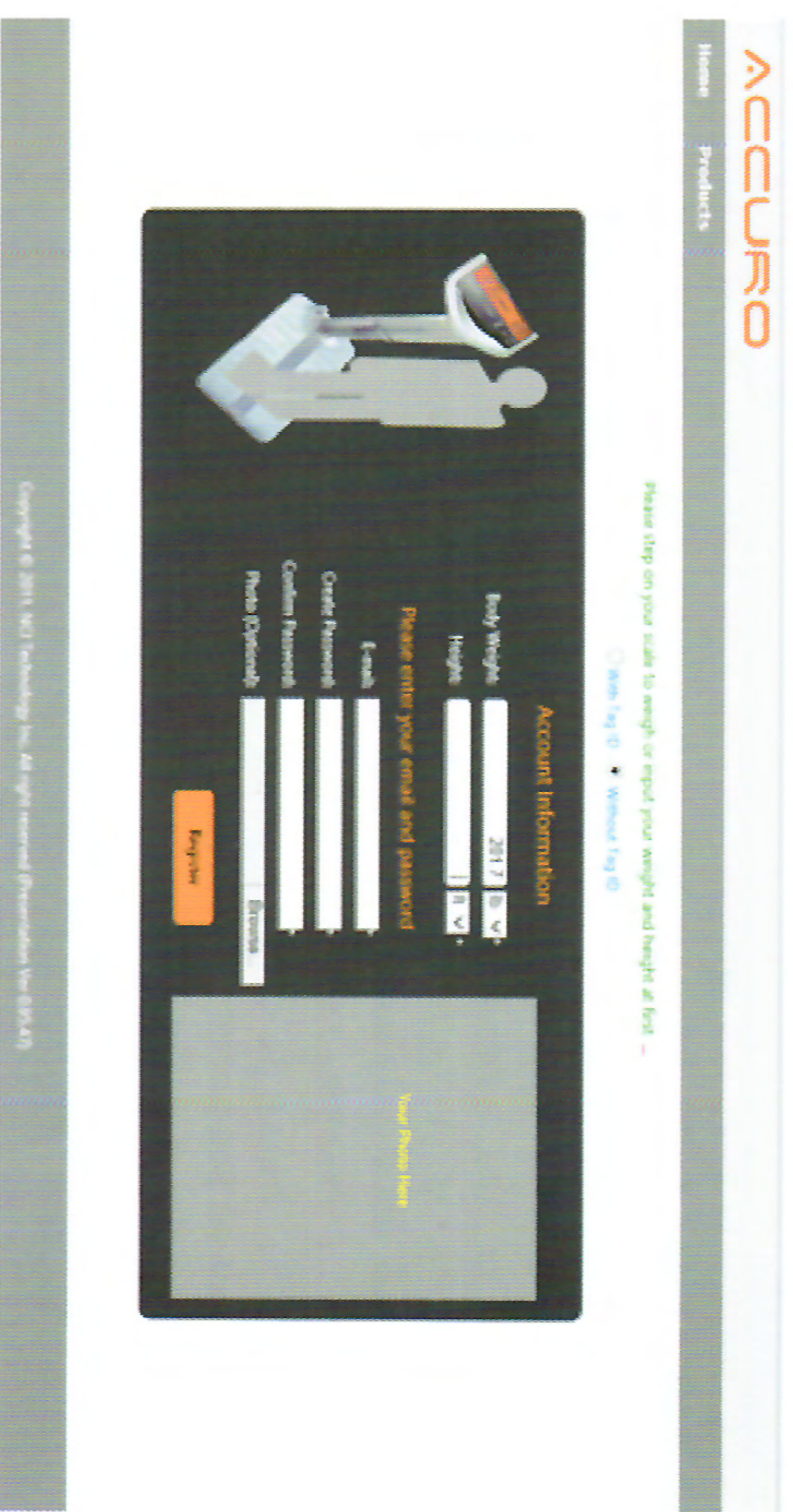

NOTE: Body Weight is for example purpose.

When connection is established a notification box will appear indicating the setup is complete. If setup fails, perform steps 1 through 3 again. If you have trouble setting up your scale please contact support center at support@accuroweigh.com

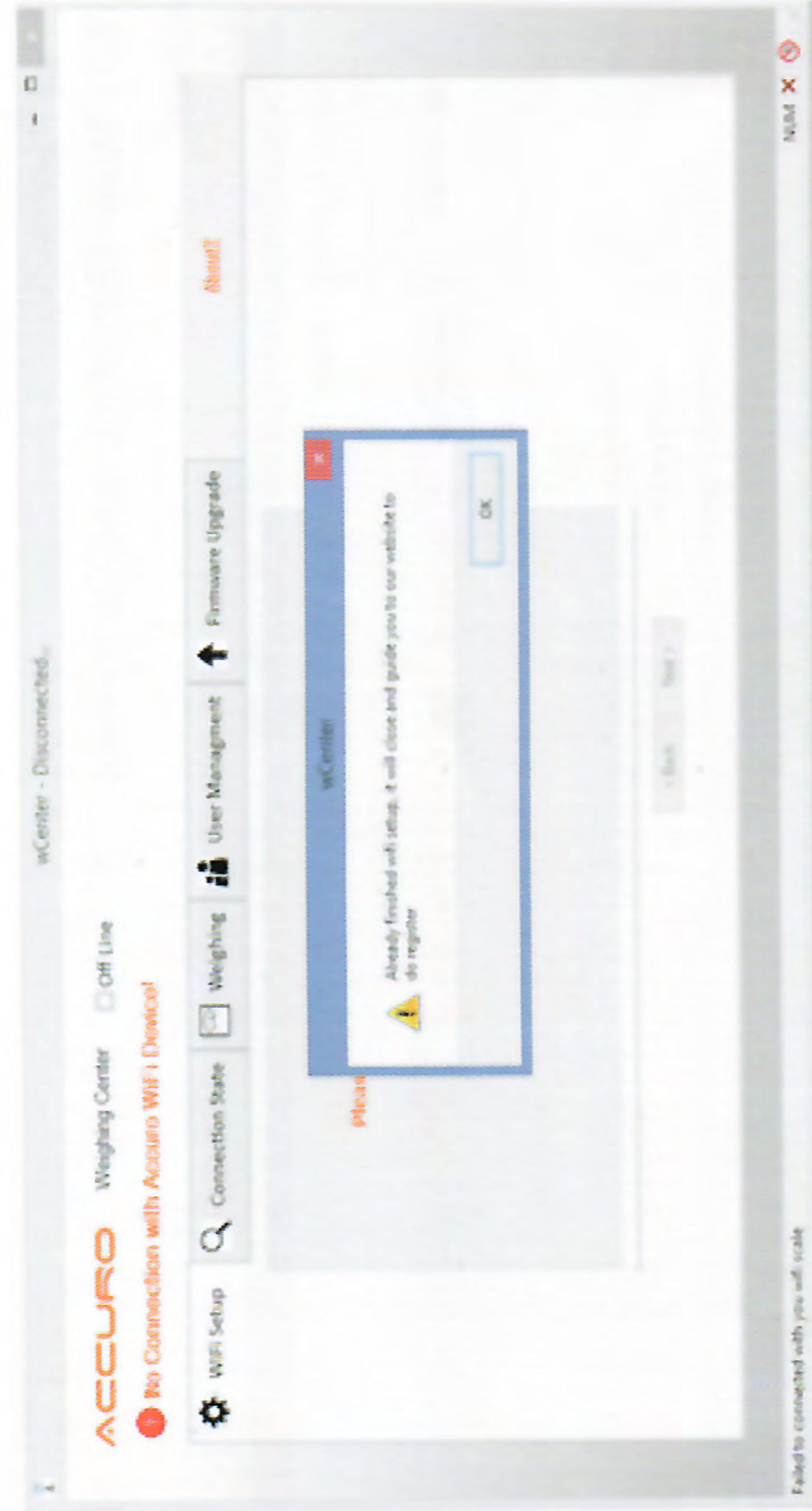

If you already have a PCT (Tag ID), scan your PCT over the RFID symbol on the scale display, the ID tag number will appear in the Card No box, and then step on scale. If successful, you will see your weight in the Body Weight box. Complete the registration process by entering your email and password and select Register. You are finished!

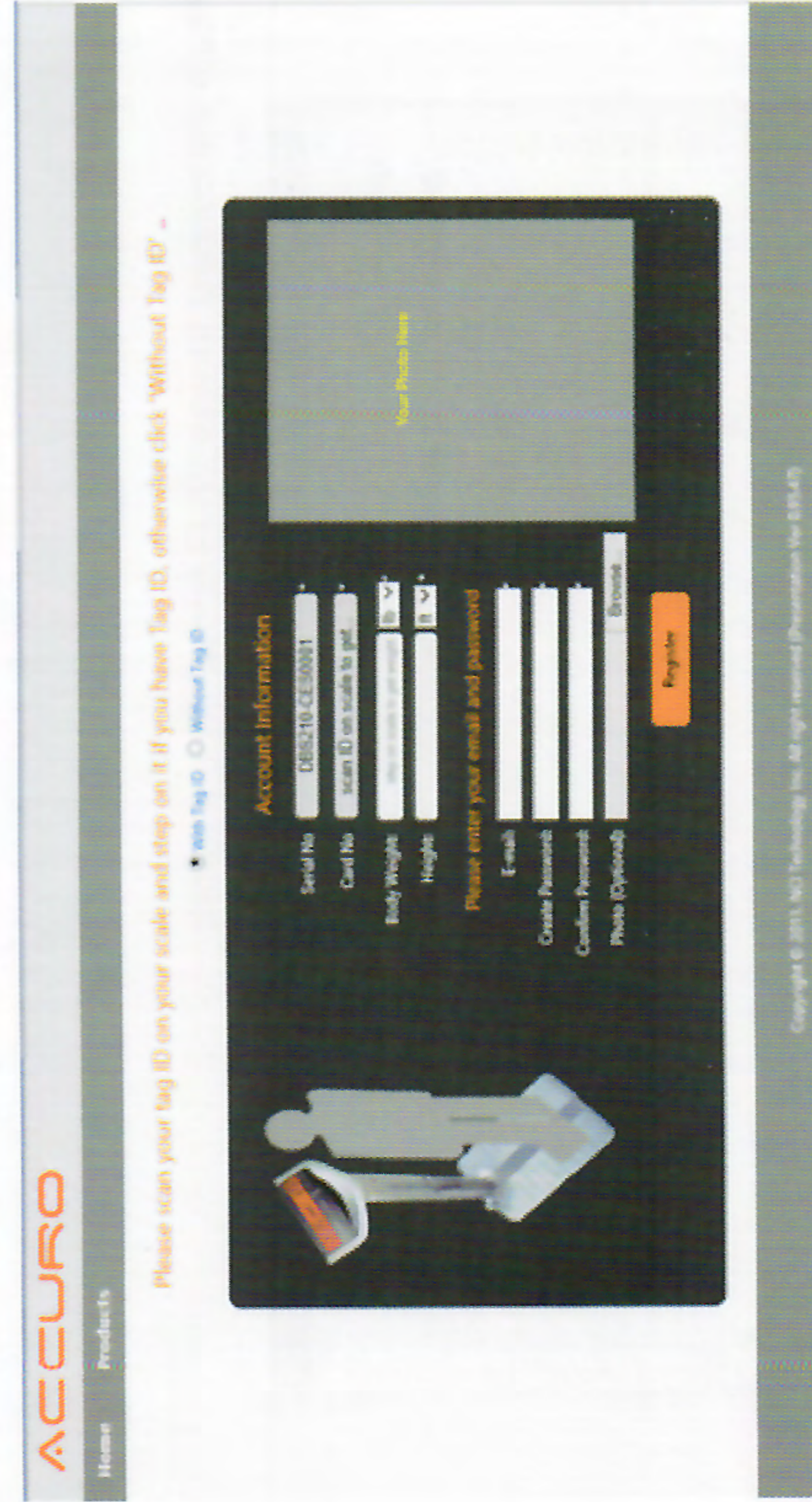

NOTE: Selected Wi-Fi Scale in box is for instructional purpose.

Buttons

Zero: The scale can be reset to a zero weight by pressing the zero button.

Units: Press the Units button to toggle between Lb/Kg mode.

BMI: The scale will go into BMI mode.

Clock: Accesses the clock setting. See instructions below for clock settings.

Scale Features

Instant On: The scale will turn on automatically when the user steps on the scale or any button is pressed. The scale will automatically turn off after 15 seconds.

BMI: Accesses BMI mode. See instructions below for BMI use.

Scale Display: Two LCD displays are utilized to indicate the Weight, BMI, Clock and the current scale status.

Weight Display: The user weight is displayed on the left side LCD.

Low Batt: Indicates when the batteries require replacement.

BMI/Clock Display: The BMI measurement is displayed on the right side LCD. The clock will be displayed when the BMI feature is not in use.

WiFi Capabilities (WiFi Model – DB200/DBW200): WiFi scale to connect to home/office network.

RFID Reader (RFID model – DB210/DBW210): Built-in RFID Tag Reader for use with a Personal Connectivity RFID Tag (PCT)

Scale Operation

User weighing

1. Step on the scale and remain still.
2. When a stable weight is reached, the display will lock and hold the weight reading.
3. The scale will hold the weight and after 15 seconds shut off automatically.

BMI (Body Mass Index) Reading

1. Step on the scale and remain still.
2. When a stable weight is reached, the display will lock and hold the weight reading.
3. Press the BMI button.
4. The height will flash on the right side display. Enter the height with the up/down arrow buttons. Press the BMI button to accept the correct height.
5. The BMI value will be displayed on the right side display and the weight will be displayed on the left side display.

Zero Button

1. Press the zero button.
2. The display will display a zero button after the scale becomes stable.

Setting the Clock

1. Press and hold the Clock button.
2. The left side display will show 12HR or 24HR; release the clock button.
3. To select 12HR or 24HR mode press the up/down arrow buttons then press the Clock button to accept.
4. The hour digit will flash, use the up/down button to enter the correct hour. Press the clock button to accept.
5. The minute digit will flash, use the up/down button arrow buttons then press the clock button to accept and exit the clock setting mode.

Step 3

Under Network Name (SSID) select your home/office router from the drop-down box
Enter your Network Key (password)
Confirm Key (Password)
Select Wi-Fi Scale (SSID of the scale) to connect
Click on "Next"



NOTE: Selected Wi-Fi Scale in box is for example purpose.

Wi-Fi Scale will connect to your Wi-Fi home/office network



Connecting DB200/210 or DBW200/210 scale to Network (Models with Wi-Fi and RFID feature)

If connecting to the network for the first time you will need to download and install the WiFi Setup Program found at <http://www.accuroweigh.com>. Click on SUPPORT and select **Software Download** from the drop-down menu. You will see a screen similar to the one below. Follow the steps below.

Step 1

SOFTWARE DOWNLOAD

Download our easy to use software for the wifi based scales. This software is fully supported. Both as an executable and zip format are available.

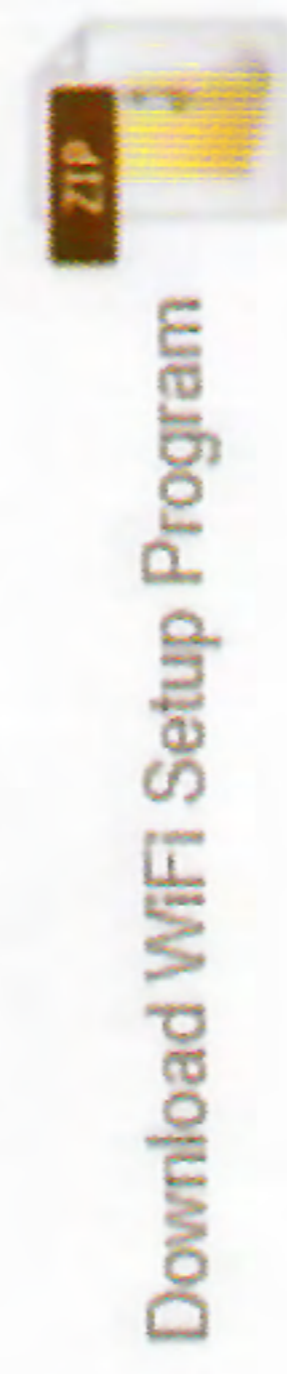
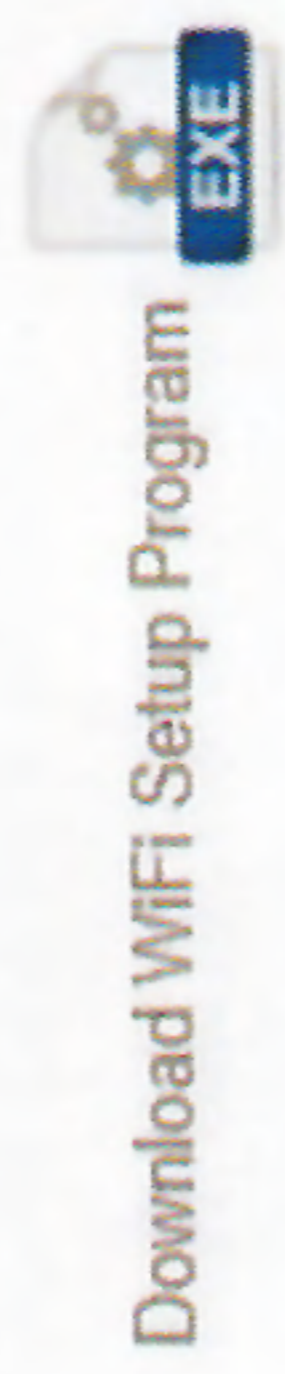

Step 2

Click "Run" to launch program

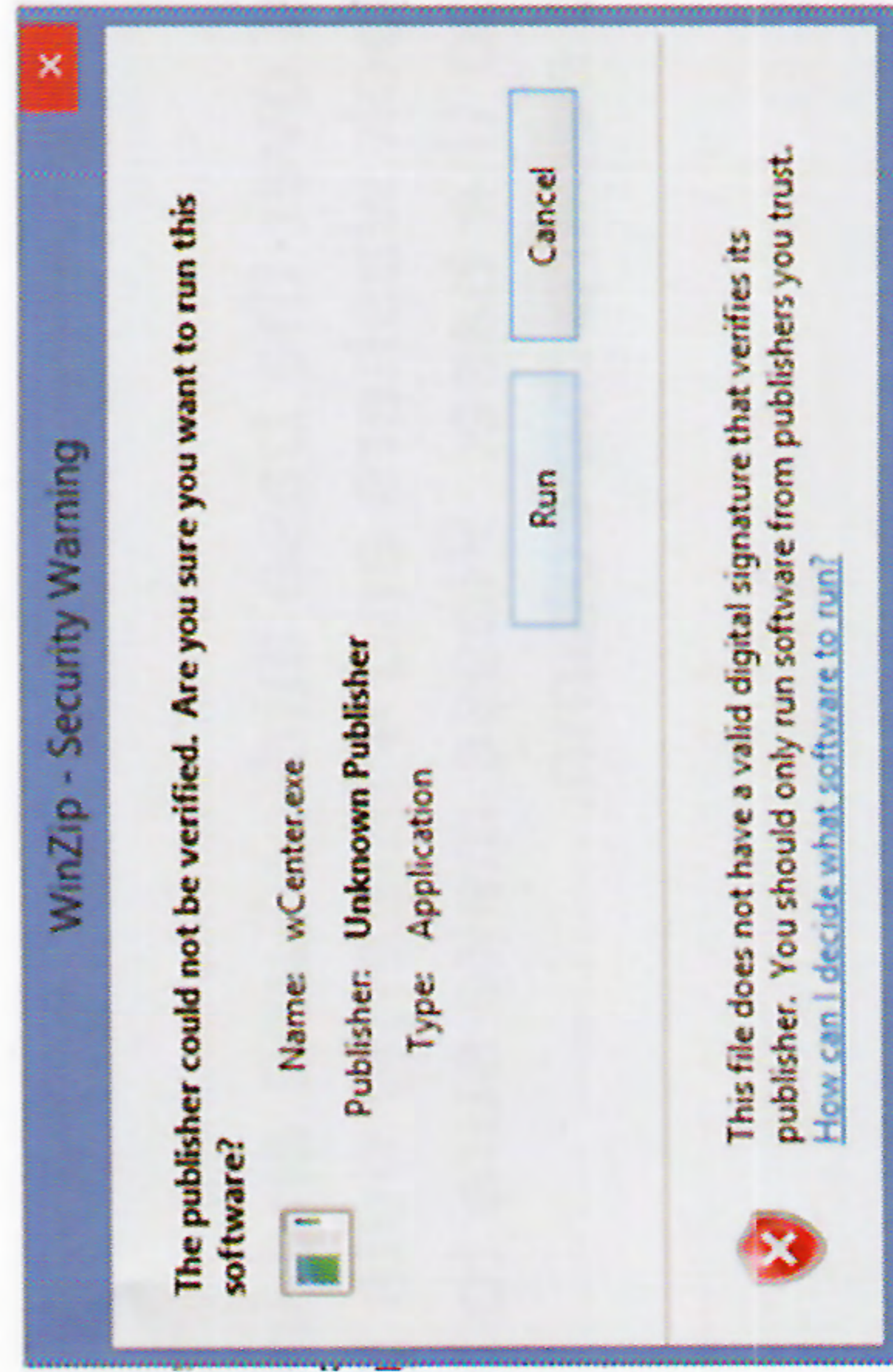

Assembly Instructions

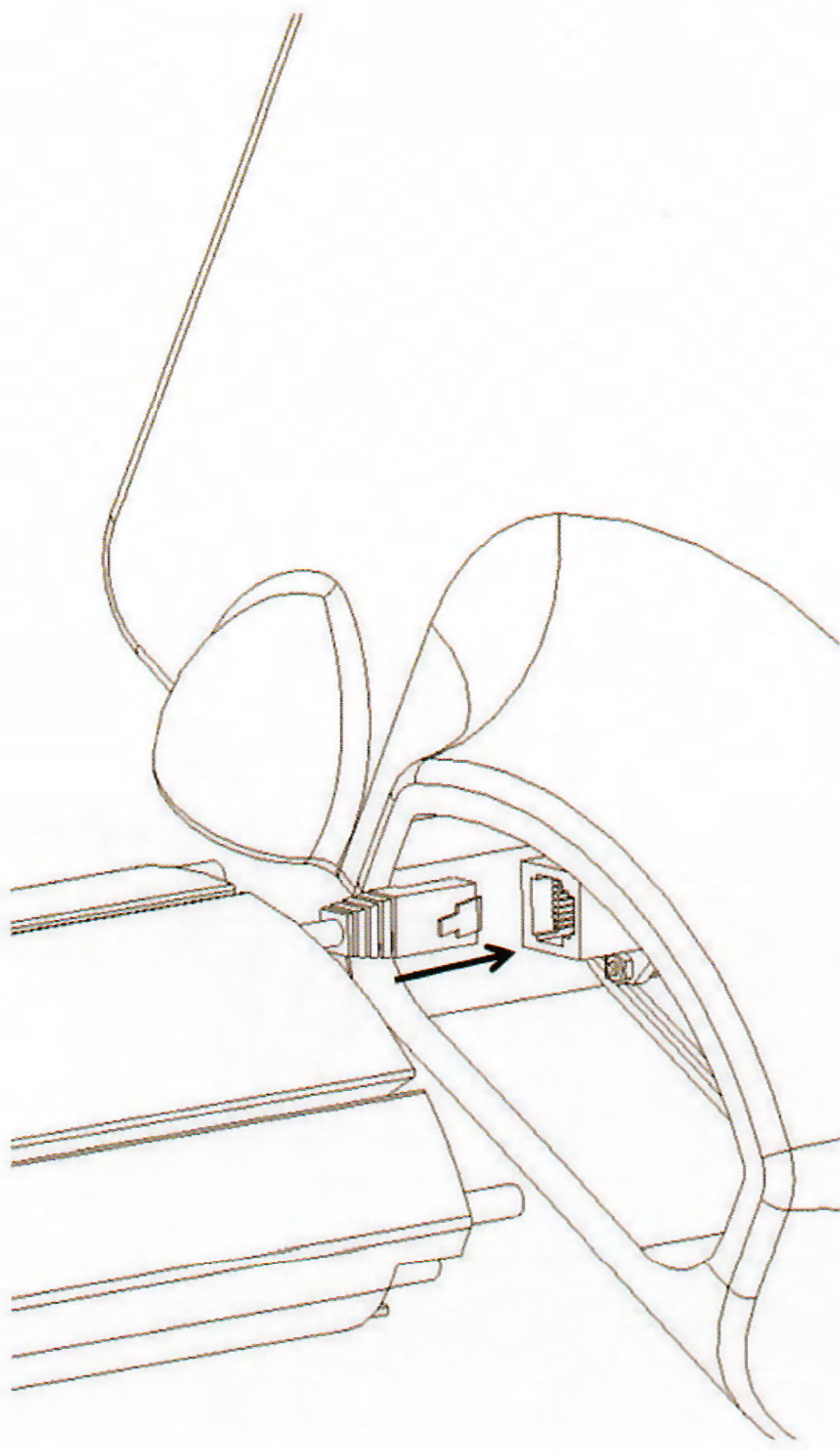

Step 1. Connect the cable to the base. The cable will be located inside the column.

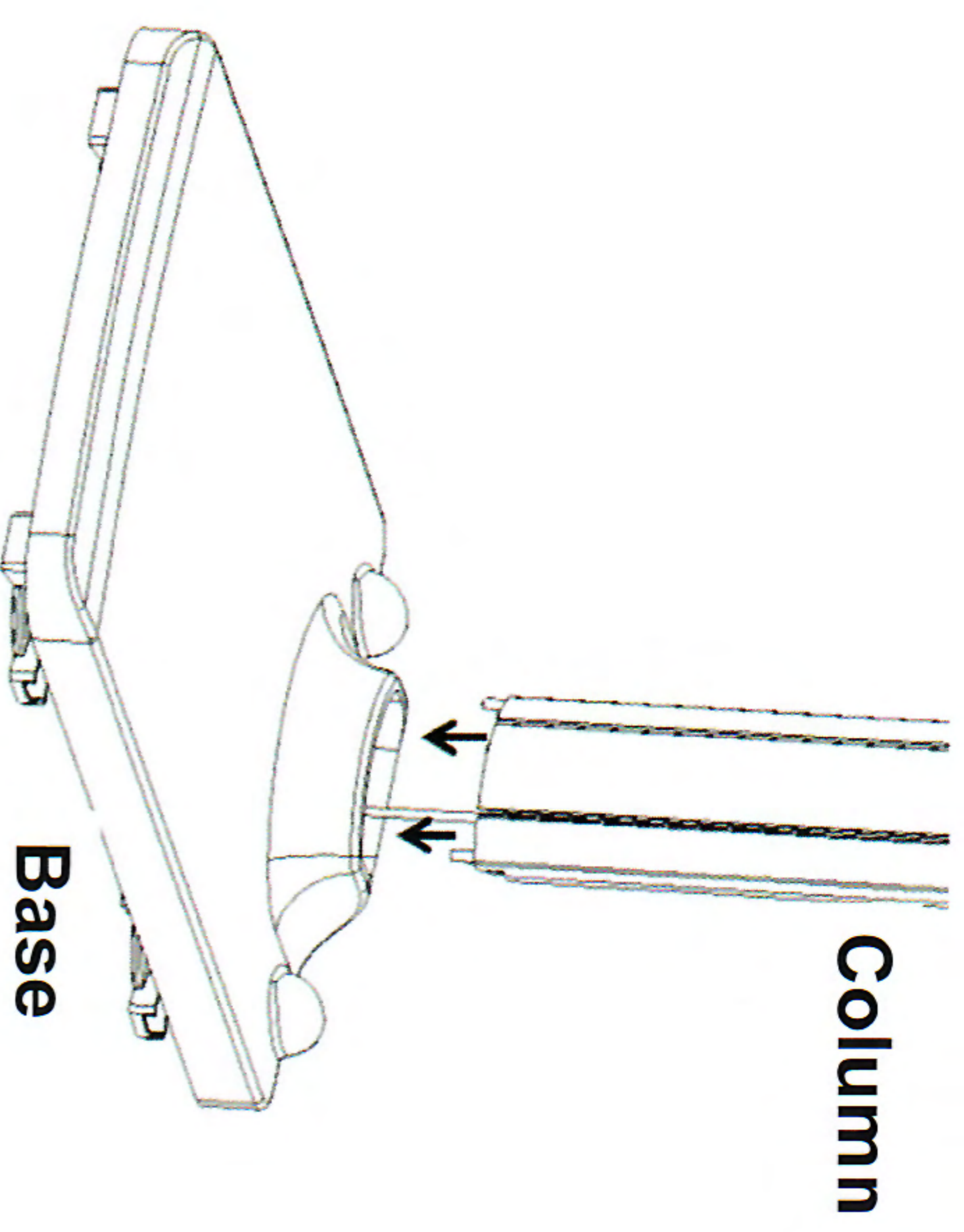

Step 2. Insert column into base as shown.

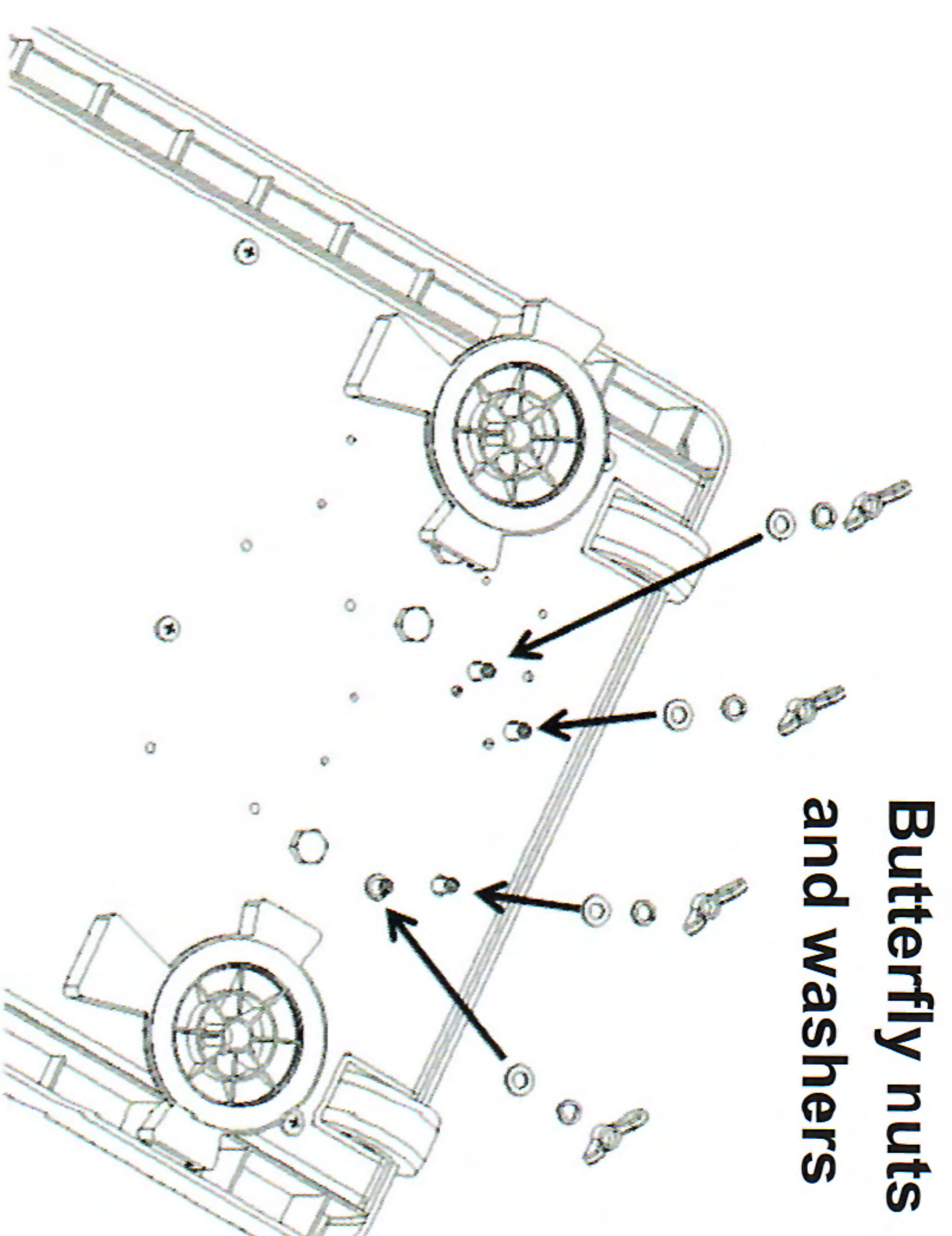

Step 3. Turn over the base and column and insert 4 washers, 4 lock washers and 4 butterfly nuts to attach the column to the base. Please make sure to tighten the 4 nuts to secure the column.