

# INSTRUCTIONS FOR SETUP

To contact NEMO Customer Service  
Email: [journey@nemoequipment.com](mailto:journey@nemoequipment.com)  
Phone: 800-997-9301

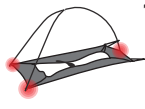

## 1 Insert Poles in Corner Anchors

Lay the inner tent on the ground and arrange pole set so pole color matches corner webbing color. Press the ball end of each pole into its corresponding Jake's Foot™ fitting and insert locking pole tip into corner grommet.

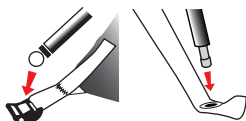

## 2 Attach Inner Tent to Poles

Attach the inner tent canopy to the poles using pole clips. The integrated Flybar™ clip attaches like a normal pole clip but significantly increases headroom and interior volume.

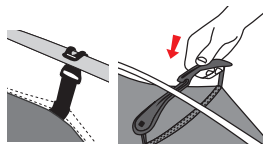

## 3 Stake in Place

Position your tent as desired and stake the four corner anchors. As you pull at the corners, watch the tension in the floor of the tent to keep it even. If the ground is too hard for stakes, tie anchors to rocks or other heavy objects.



## 4 Attach Rain Fly

Cover the inner tent with the rain fly. Locate the webbing straps on the corners of the fly and clip to the outermost bar on the Jake's Foot™.

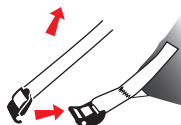

## 5 Tension Fly and Vestibule(s)

Secure poles to rain fly with internal pole wraps. Stake vestibule(s) and pull firmly on all adjustable corner anchors. Add guylines for additional strength. A properly tensioned tent ensures maximum water shedding and wind resistance.



## 6 Volumize (optional)

Locate integrated small plastic hook(s) to connect rain fly to inner tent near door(s). Attach each hook to its corresponding webbing loop for increased interior volume.

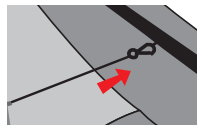

©2019 NEMO Equipment, Inc.

Remember to leave no trace. Before leaving your campsite, take a thorough look around making sure you have not left anything behind, out of place, or damaged.

**HORNET™  
SERIES**