

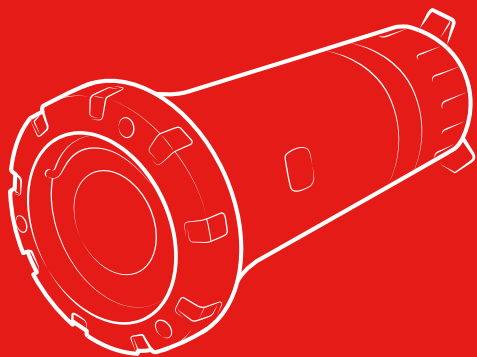

ALPKIT

EASTWOOD | HATHERSAGE | AMBLESIDE



TRINITY

KEEP ME SAFE FOR FUTURE REFERENCE

DATE: 01/03/18

Say hello to Trinity, a dual-function lantern and torch (can we call it a tortern?). With a 190 lumen LED and handy dimmer function, Trinity can shed the right amount of light on any situation. Here's how to get started.

IMPORTANT:

Thank you for purchasing the Alpkit Trinity Torch. Please curtail your excitement and do not use this product until you have read, understood, and complied with all the instructions and warnings contained within this manual.

SPECIFICATION

Bulb: 1 x XP-E Cree LED

Water Resistance: IPX5

WARNING

- Do not shine torch directly into your eyes
- Do not submerge.
- Do not disassemble or modify this product as it will invalidate your warranty
- Keep Trinity clean to prevent dirt and dust from entering the electric elements
- Remove any moisture before storage
- Do not store Trinity with batteries inside for long periods of time

CARE AND MAINTENANCE

- Clean with a damp cloth.
- Ensure that Trinity is dry before storing in a dry place.

BATTERIES

4 x AA good quality alkaline or Nimh rechargeable batteries.

Compatibility:

Battery Type	Compatibility
Alkaline	Yes
Li-Ion	No
Li-Ion Rechargeable	No
NiMH Rechargeable	Yes
NiCd rechargeable	No
NiZn rechargeable	No



THE ALPINE BOND
3 YEAR GUARANTEE

If this product does not meet your expectations upon delivery or does not live up to the demands placed upon it, please return it within 3 years of purchase for repair, replacement or refund. If the problem is our fault then we will do this to your satisfaction, if it's your fault we will help the best we can!

Email: support@alpkit.com

Phone: 01773 417007

Website: www.alpkit.com/support

INSTRUCTIONS FOR USE: LANTERN MODE

Open the retractable supports to stand up the light.

To redirect the beam for the lantern mode, pull up the outer shade to full extension.

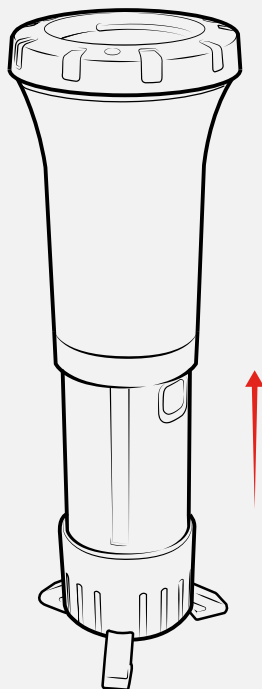

INSTRUCTIONS FOR USE: TORCH MODE

Press the power button on the torch body to illuminate.

To dim:

When illuminated, press and hold the told power button, the torch will begin to dim from 100% > 10% (blink at 10%) > 100%. Stop pressing when you've reached the right dimness.

To turn off, click once more.

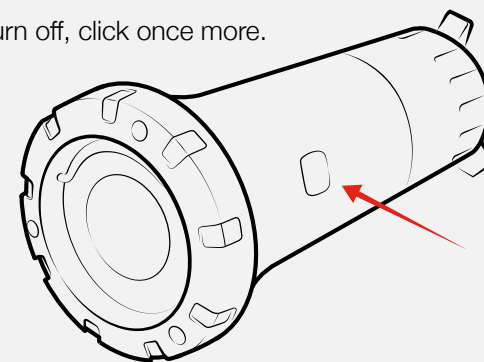

CHANGE THE BATTERIES

Unscrew the base cap and tip out the battery cradle, insert 4 x AA batteries in the direction indicated in the cradle.

Reinsert the cradle into the light in the direction indicated. Screw on the bottom cap, ensuring that the red O-ring is covered.

! Not compatible with Lithium batteries

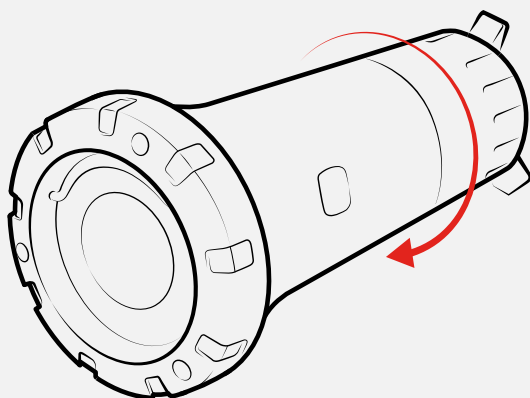

SERVICE AND REPAIRS

If the torch does not work, check that the battery has been inserted the right way around and that it is not flat. Check that there is no water in the torch, dry thoroughly if there is and try again. Check contacts for signs of corrosion caused by the battery leaking or through damp. Clean contacts with a light emery cloth. If issues cannot be corrected using these instructions, contact Alpkit for advice.

DISPOSAL AND RETURNS

Throwing batteries in the household bin can be hazardous to the environment and your health. You can recycle them by:

- Returning them to us to dispose of safely.
- Returning them to the store where you bought them to dispose of safely
- Visiting RecycleNow.com to find your nearest battery bank.

Any torch with a WEEE icon (the crossed-out wheelie bin) cannot be put in household waste. Instead, either:

- Return to us to dispose of for you.
- Visit RecycleNow.com to find your nearest electricals recycling point.



CONTINUE THE JOURNEY

When your partnership with this product is over please don't leave it hidden in a cupboard, never to see another adventure. Wash it, pass it on, give to a friend, sell it, donate it to charity, make it into something else or recycle it and let someone else live their dream.

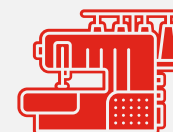

REPAIR STATION HACK, PATCH & SEW

In store service for your kit: alpkit.com/stores



CONTINUUM PROJECT

For more ideas on how you can extend the life of or donate your outdoor products visit: alpkit.com/continuum