

PRODUCT INFORMATION PACKET

Model No: 048A11O787
Catalog No: X009
3/4,1075,OPEN,48Y,1/60/115
Direct Drive



Regal and Marathon are trademarks of Regal Beloit Corporation or one of its affiliated companies.
©2021 Regal Beloit Corporation, All Rights Reserved. MC017097E





Nameplate Specifications

Output HP	0.75 HP	Output KW	0.56 kW
Frequency	60 Hz	Voltage	115 V
Current	10.2 A	Speed	1075 RPM
Service Factor	1	Phase	1
Efficiency	64 %	Duty	Continuous
Insulation Class	B	Design Code	L
KVA Code	C	Frame	48Z
Enclosure	Open Air Over	Overload Protector	Automatic Lock Rotor Only
Ambient Temperature	40 °C	Drive End Bearing Size	6203
Opp Drive End Bearing Size	6203	UL	Recognized
CSA	Y	CE	N
IP Code	10		

Technical Specifications

Electrical Type	Permanent Split Capacitor	Starting Method	Across The Line
Poles	6	Rotation	Selective Counterclockwise
Mounting	Resilient Ring - Extended Studs	Motor Orientation	Horizontal
Drive End Bearing	Ball	Opp Drive End Bearing	Ball
Frame Material	Rolled Steel	Shaft Type	Single Special Extension
Overall Length	10.75 in	Frame Length	5.25 in
Shaft Diameter	0.500 in	Shaft Extension	4.06 in
Assembly/Box Mounting	F1 Only		
Outline Drawing	A-SS403435-525	Connection Diagram	6906493

This is an uncontrolled document once printed or downloaded and is subject to change without notice. Date Created: 01/12/2021

NAMEPLATE LOC. @ 'C'
 READ FROM TERM. END
 WHEN TWO PART N.P. IS USED,
 CENTER PIECES AT 'C'

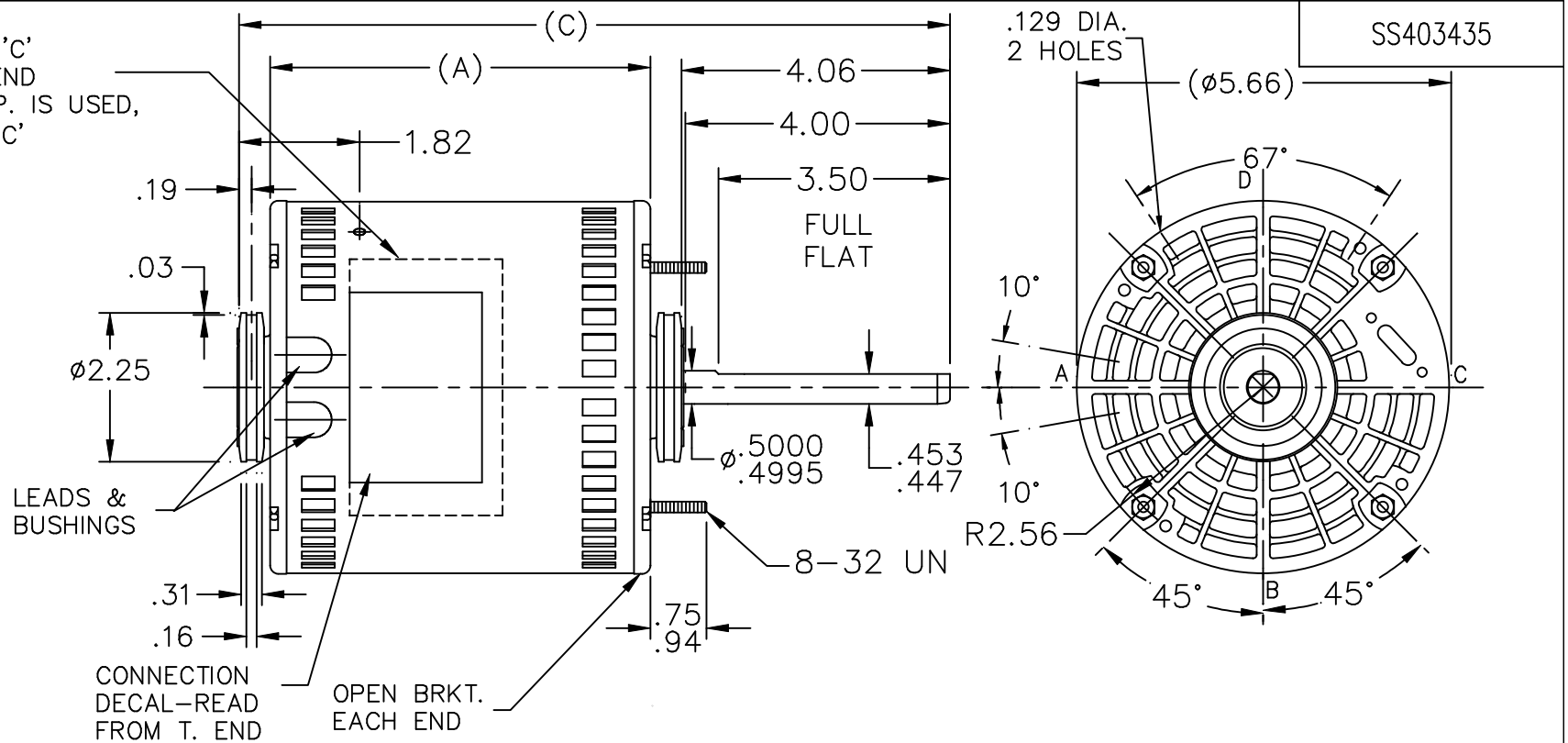
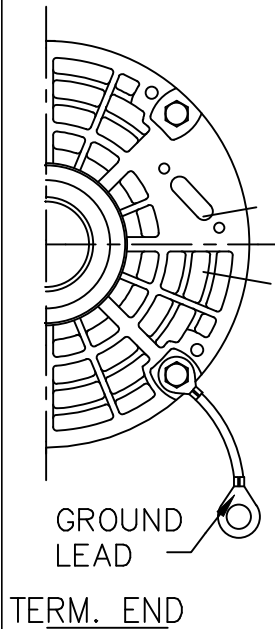

LEAD DESCRIPTION:

1 WHITE, 1 BLACK, 1 BLUE, & 1 RED LEAD WITH
 .50 BARE WIRE STRIP. 30.00" LONG

2 BROWN LEADS WITH .25 FLAG-TYPE QUICK
 CONNECTS 30.00" LONG. BROWN/WHITE MARKED
 LEAD IS COMMON TO WHITE.

REVERSING LEADS ARE MOLDED INTO MATING
 PULL-APART PLUGS. 1 YELLOW & 1 PURPLE
 LEAD PER PLUG. 5.00" LONG.

GREEN GROUND LEAD WITH TERM. FOR
 #10 SCREW 12.00" LONG.

DASH	FR.	C	A
475	48Y	10.25	5.25
525	48Y	10.75	5.75

12/24/2008

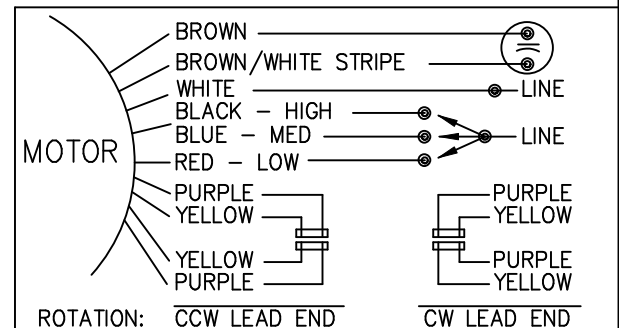

NO.	REVISION	BY & DATE	CHK	ANG	TOLERANCES UNLESS SPECIFIED	
					DEC.	INCHES
					.X	±.1
					.XX	±.03
					.XXX	±.005
					.XXXX	±.0005
					ANG	±7'30"

<p>TITLE OUTLINE</p> <p>MAT'L.</p> <p>FINISH</p>	DRAWN NJS 08-19-2004
	CHK ML 08-19-2004
	APPD MJS 08-19-2004
	SCALE 3=8
	REF
	FMF MU61357
	PREV

THIS DRAWING IN DESIGN AND DETAIL IS OUR PROPERTY AND MUST NOT BE USED EXCEPT IN CONNECTION WITH OUR WORK ALL RIGHTS OF DESIGN AND INVENTION ARE RESERVED THIS IS AN ELECTRONICALLY GENERATED DOCUMENT - DO NOT SCALE THIS PRINT		RFP 08-19-2004	CAD FILE SS403435	SIZE A	DRAWING NO. SS403435	PAGE OF	REV.
		DIST WP					

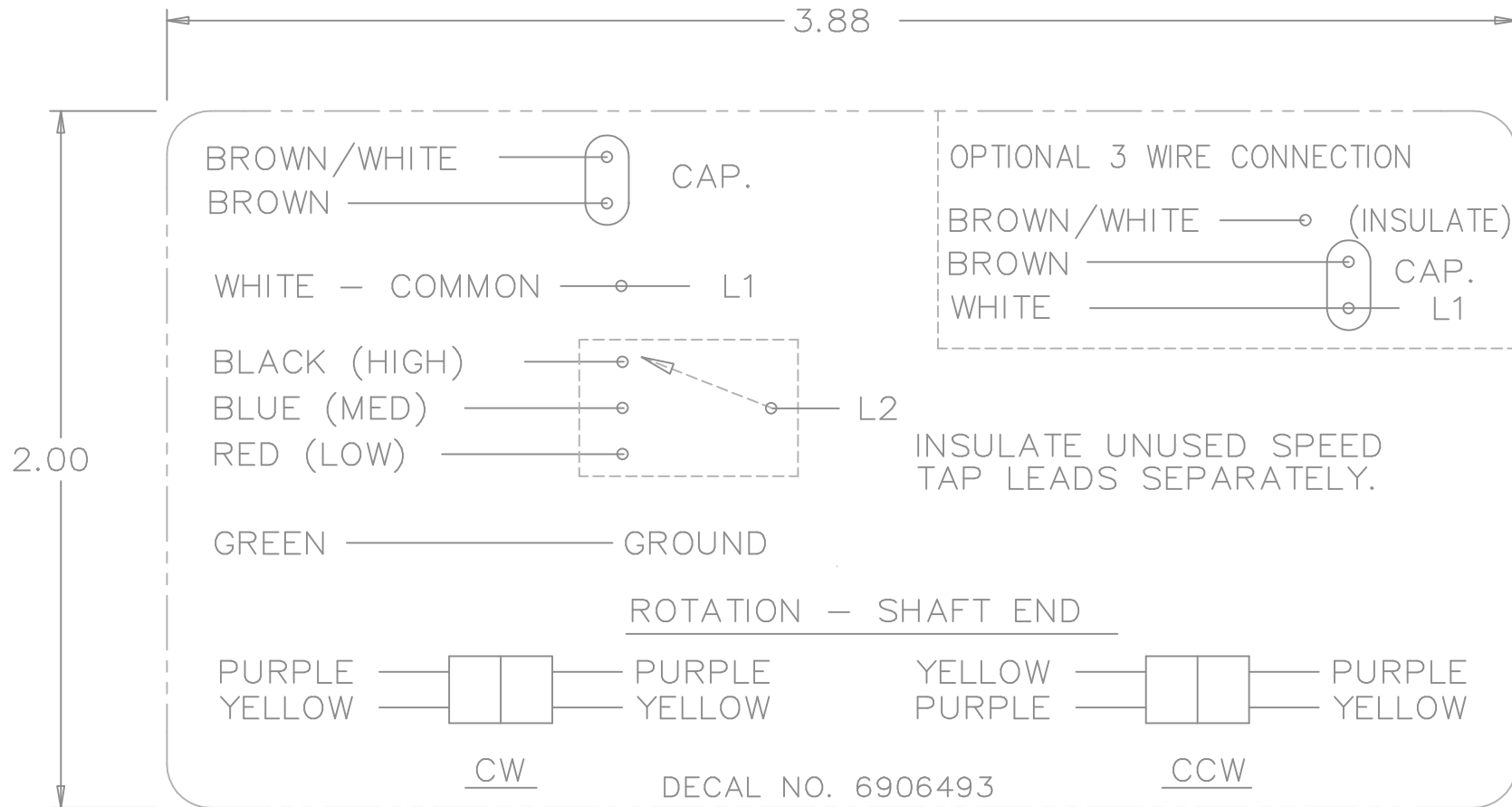

				TOLERANCES UNLESS SPECIFIED		REGAL-BELOIT <i>Motor Technologies</i>	DRAWN MRB 04-16-1998				
				DEC.	INCHES		CHK	ML	04-22-1998		
				.X	±.1		APPD	GK	04-22-1998		
3	REMOVED 'MARATHON ELECTRIC' CN 35106	DRS 05-01-2002	TOM	.XX	±	TITLE CONNECTION DECAL	SCALE	1=1			
2	PART NAME WAS CONNECTION DIAGRAM CN 25669	MRB 04-25-1998		.XXX	±.005		REF				
1	NEW DRAWING CN 25669	MRB 04-22-1998		.XXXX	±.0005	MAT'L.	FMF				
NO.	REVISION	BY & DATE	CHK	ANG	±	FINISH	PREV				
THIS DRAWING IN DESIGN AND DETAIL IS OUR PROPERTY AND MUST NOT BE USED EXCEPT IN CONNECTION WITH OUR WORK ALL RIGHTS OF DESIGN AND INVENTION ARE RESERVED THIS IS AN ELECTRONICALLY GENERATED DOCUMENT - DO NOT SCALE THIS PRINT				RFP	CAD FILE 6906493		SIZE	DRAWING NO.	PAGE	OF	REV.
				DIST	WP		A	6906493			3



MARATHON ELECTRIC CORPORATION
TYPICAL PERFORMANCE CURVE for AC MOTOR

Customer

Curve at

115 Volts
60 HZ
0.75 HP

HP 0.75

PHASE 1

Model No 48A11O787

VOLTS 115

Catalog No X009

HZ 60

RPM 1075

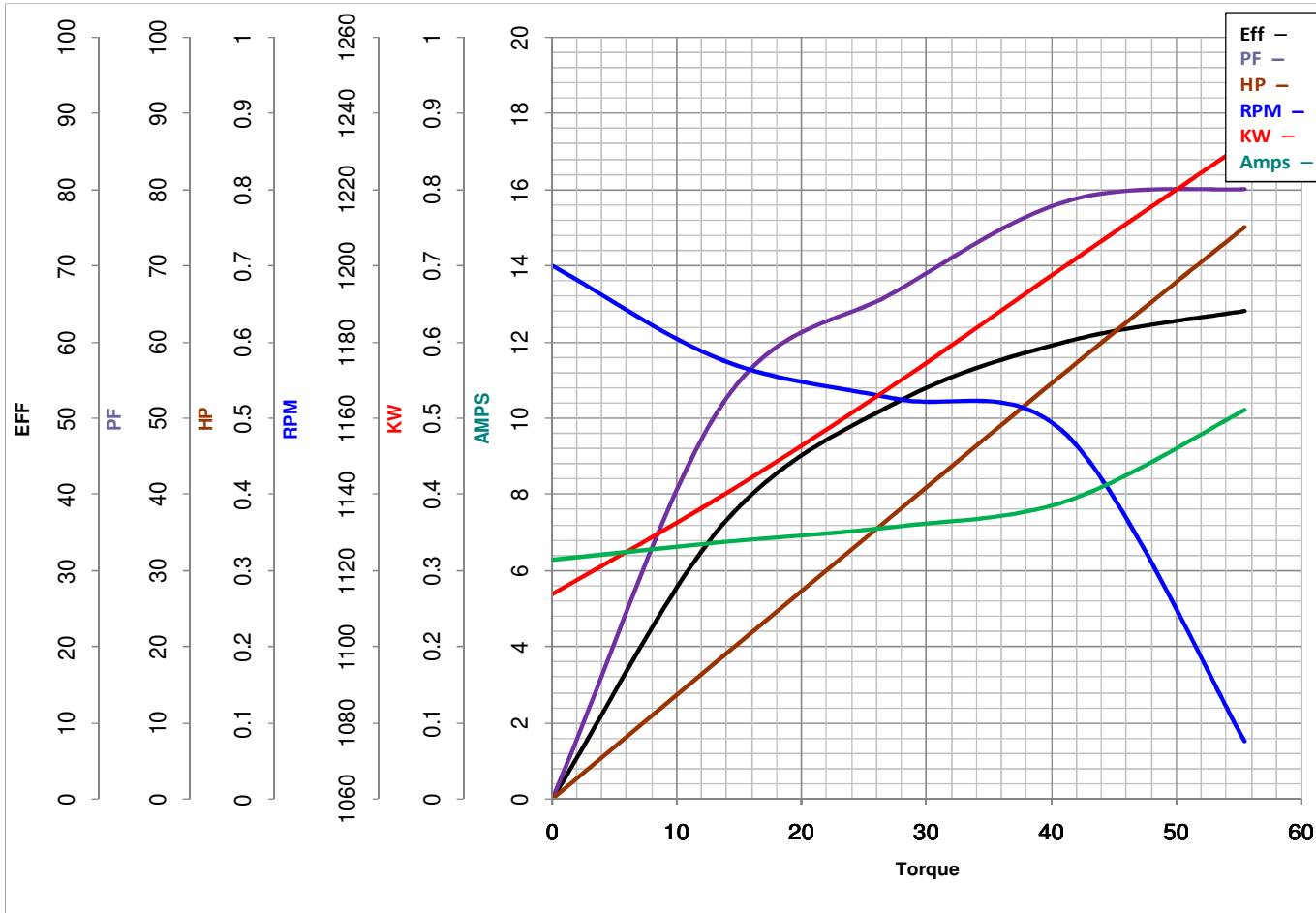

Torque in Oz.Ft

FL TORQUE 55.5 Oz.Ft
BD TORQUE 89.7 Oz.Ft
LR TORQUE 14.4 Oz.Ft

FL AMPS 10.2
PU TORQUE 10.8 Oz.Ft
LR AMPS 25.2

WINDING PE486951-1

Date 1/4/2019