

Turbo air
AIR CONDITIONER MANUFACTURER

4184 E. Conant St.
Long Beach, CA 90808
Tel. 888-900-1002
Fax. 310-900-1088
www.turboairinc.net

Project :

Model # :

Item # :

Qty :

Approval :

Unit Cooler

Model : LED168B



≡ FEATURES / BENEFITS ≡

- Blue anti-corrosion-fin increases the life span of the coil.
- Air-pass guard is located at the bottom of the coil to improve heat exchange rate.
- Easy to replace defrost heater. (LED model)
- Corrugated fin is used to increase heat exchanges rate by expanding the surface area.
- Even in confined space, all parts can be reached easily by opening the front cover.
- Location of power connector makes replacement of motor convenient.
- Seamless inner groove copper tube increases the heat exchange rate by reducing the space between the fin and copper tube.
- Venturi type distributor and precise orifice hole are used to minimize the pressure drop and maximize the freezing capacity respectively.
- Even in confined space, all parts can be reached easily by opening the front cover.
- Thermostat is installed to prevent over temperature on heater.
- Circuit opens automatically over 50°F.
- Parts available :
 - Expansion Valve (Sporlan) (Pre Mounted)
 - Solenoid Valve (Sporlan)
 - Thermostat (Johnson Control)
- The spiral fan guard enables cold air to be delivered efficiently and thoroughly.
- The protruding fan and motor placement substantially reduce vibration and noise.
- PSC fan motor, which prevents oil evaporation, is used for long life expectancy.
- EC Motor (optional) for high energy efficiency.
- Unique air flow system (patent pending) results in improved circulation within crowded walk-in cooler/freezer.
- Anti-oxidizing stainless steel mounting and bolts.

Unit Cooler

Model : LED168B

LED ELECTRIC DEFROST MODELS 60HZ. WITH PSC MOTORS.

Capacity BTUH/Watts 10°F /6°C TD -20°F / -29°C SST	Fan Data	
	CFM/m³H	No.
16880	2600	4

EC Motor Data			Defrost Heater (Total Amps)		
230V 1Ph 60Hz					
HP	Total Amps	Watts	Watts	230/ 1/60	230/ 3/60
1/15	1.40	320	3600	15.7	9.0

Connections (Inches)				Approx. Net Wt. Lbs
Coil Inlet	Suction	External Equalizer	Drain	
1/2 OD	1-1/8 ID	1/4 OD	3/4 MPT	77

Design and specifications subject to change without notice

■ **WARRANTY : 1 Year Fan Motor and Parts Warranty**

PLAN VIEW

(unit : inch)

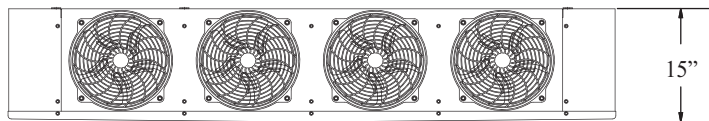

3/4" MPT (14NPS)
Drain Connection

FRONT VIEW

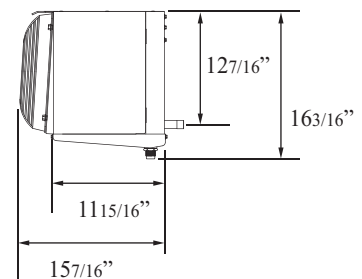

SIDE VIEW

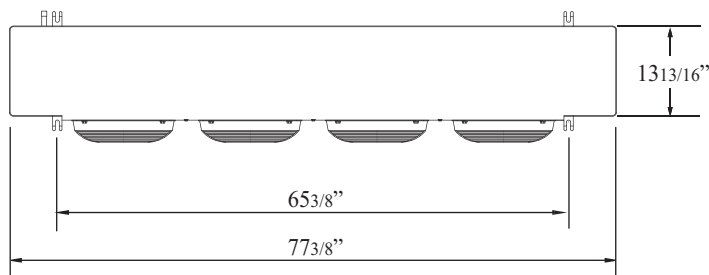

TOP VIEW



■ Toll Free : 888-900-1002