

PRODUCT INFORMATION PACKET



Model No: OCB1026A
Catalog No: OCB1026A
1/4 HP OEM Replacement Motor, 1075 RPM, 2 Speed, 208-230 Volts, 48 Frame, Semi Enclosed
HVAC/R OEM Replacement Motors



Regal and Century are trademarks of Regal Beloit Corporation or one of its affiliated companies.
©2020 Regal Beloit Corporation, All Rights Reserved. MC017097E





Nameplate Specifications

Output HP	1/4 Hp	Output KW	0.19 kW
Frequency	60 Hz	Voltage	208-230 V
Current	2.2 A	Speed	1075 rpm
Service Factor	1	Phase	1
Duty	Air Over	Insulation Class	B
Frame	48Y	Enclosure	Semi Enclosed
Thermal Protection	Automatic	Ambient Temperature	60 °C
UL	Recognized	CSA	Y
CE	N		

Technical Specifications

Electrical Type	Permanent Split Capacitor	Starting Method	Across The Line
Poles	6	Rotation	Reversible
Mounting	Lug	Motor Orientation	Horizontal
Drive End Bearing	Sleeve	Opp Drive End Bearing	Sleeve
Frame Material	Rolled Steel	Shaft Type	Flat
Overall Length	8.20 in	Frame Length	3.50 in
Shaft Diameter	0.500 in	Shaft Extension	4.2 in
Connection Drawing	614131-052	Outline Drawing	OCB1026A-S01

This is an uncontrolled document once printed or downloaded and is subject to change without notice. Date Created:22/09/2020

4	3	2	1																																																																																				
GENERAL INFORMATION: SHAFT RUNOUT: .001 [.03] T.I.R. PER INCH LENGTH OF EXTENSION END PLAY: .010 [.25] TO .063 [1.60] BEARINGS: SLEEVE MOUNTING POSITION: HORIZONTAL ELECTRICAL DATA: OVERLOAD PROTECTOR: AUTOMATIC RESET (T.I. 7AM 036) LEADS: NO. 18 GA., .06 [1.5] THK. EPDM 125°C INSUL. GROUND LEAD: NO. 18 GA., .03 [.8] THK. GRN INSUL.		<table border="1" style="width:100%; border-collapse: collapse;"> <tr> <th>REV</th> <th>ECO</th> <th>REV BY</th> <th>DATE</th> <th>APPD</th> <th>DATE</th> </tr> <tr> <td>B</td> <td>0025554</td> <td>O. CARVAJAL</td> <td>05-01-2012</td> <td>M. AVILA</td> <td>05-01-2012</td> </tr> </table> <p>REV ROT. →</p> <p>TOP OF NAMEPLATE (ADHESIVE)</p> <p>TOP OF WARNING STICKER (WHEN REQ'D) (ADHESIVE)</p> <p>3X ϕ.434 [ϕ11.02] HOLE EQUALLY SPACED ON A ϕ7.000 [177.80] B.C.</p> <p>GROUND LEAD (TERMINAL AT MOTOR MUST NOT PROTRUDE BEYOND MOTOR O.D.)</p> <p>LEAD LENGTH</p> <p>LEAD LENGTH</p> <p>30°</p> <p>8.20 [208.3]</p> <p>3.99 [101.3]</p> <p>4.21 [106.9]</p> <p>1.50 [38.1]</p> <p>.44 [11.1]</p> <p>3.06 [77.7] USABLE FLAT</p> <p>ϕ.5000^{+0.0000}_{-.0005}</p> <p>ϕ12.700^{+0.000}_{-.013}</p> <p>.453±.005 [11.5±.13] FLAT</p>		REV	ECO	REV BY	DATE	APPD	DATE	B	0025554	O. CARVAJAL	05-01-2012	M. AVILA	05-01-2012																																																																								
REV	ECO	REV BY	DATE	APPD	DATE																																																																																		
B	0025554	O. CARVAJAL	05-01-2012	M. AVILA	05-01-2012																																																																																		
<table border="1" style="width:100%; border-collapse: collapse;"> <tr> <th>NAMEPLATE DATA:</th> <th>EXTERNAL CONNECTION DIAGRAM</th> </tr> <tr> <td> MODEL NO.: F48Z06A01 CUST. P/N: OCB1026A HP: 1/4 ROT.: REV RPM: 1075/2 SPD TYPE: UF FRAME: 48Y VOLTS: 208-230 PH: 1 AMPS: 2.2 HZ: 60 INS.: B AMB.: 60°C DUTY: AIR OVER CAP.: 5.0 MFD/440 V ENCL: SEMI-ENCL. UL LOGO CSA LOGO THERMALLY PROTECTED </td> <td> <p>SEP. CAP.</p> <p>BRN</p> <p>YEL</p> <p>LINE</p> <p>BLK HI</p> <p>RED LO</p> <p>ORN</p> <p>PUR</p> <p>614131-052</p> <p>SHOWN FOR CCWLE ROT. FOR CWLE ROT. INTERCHANGE ORN AND BRN LEADS</p> </td> </tr> </table>		NAMEPLATE DATA:	EXTERNAL CONNECTION DIAGRAM	MODEL NO.: F48Z06A01 CUST. P/N: OCB1026A HP: 1/4 ROT.: REV RPM: 1075/2 SPD TYPE: UF FRAME: 48Y VOLTS: 208-230 PH: 1 AMPS: 2.2 HZ: 60 INS.: B AMB.: 60°C DUTY: AIR OVER CAP.: 5.0 MFD/440 V ENCL: SEMI-ENCL. UL LOGO CSA LOGO THERMALLY PROTECTED	<p>SEP. CAP.</p> <p>BRN</p> <p>YEL</p> <p>LINE</p> <p>BLK HI</p> <p>RED LO</p> <p>ORN</p> <p>PUR</p> <p>614131-052</p> <p>SHOWN FOR CCWLE ROT. FOR CWLE ROT. INTERCHANGE ORN AND BRN LEADS</p>	<table border="1" style="width:100%; border-collapse: collapse;"> <tr> <th>LEAD DATA</th> <th>ENCLOSURE</th> </tr> <tr> <td> <table border="1" style="width:100%; border-collapse: collapse;"> <tr> <th>GREEN (GRD)</th> <th>53.0/56.0 [1346/1422]</th> <th>#10 EYELET</th> </tr> <tr> <td>BROWN</td> <td>53.0/56.0 [1346/1422]</td> <td>.25 [6.4] FEMALE SPADE</td> </tr> <tr> <td>YELLOW</td> <td>53.0/56.0 [1346/1422]</td> <td>.25 [6.4] FEMALE SPADE</td> </tr> <tr> <td>BLACK</td> <td>53.0/56.0 [1346/1422]</td> <td>.25 [6.4] FEMALE SPADE</td> </tr> <tr> <td>RED</td> <td>53.0/56.0 [1346/1422]</td> <td>.25 [6.4] FEMALE SPADE</td> </tr> <tr> <td>ORANGE</td> <td>53.0/56.0 [1346/1422]</td> <td>.25 [6.4] FEMALE SPADE</td> </tr> <tr> <td>PURPLE</td> <td>53.0/56.0 [1346/1422]</td> <td>.25 [6.4] FEMALE SPADE</td> </tr> <tr> <td>COLOR</td> <td>LENGTH</td> <td>TERMINAL OR STRIP LENGTH</td> </tr> </table> </td> <td> <table border="1" style="width:100%; border-collapse: collapse;"> <tr> <td>MAIN FRAME - OLE</td> <td>OPEN</td> </tr> <tr> <td>END FRAME - OLE</td> <td>OPEN</td> </tr> <tr> <td>MAIN FRAME - LE</td> <td>ENCLOSED</td> </tr> <tr> <td>END FRAME - LE</td> <td>OPEN</td> </tr> </table> </td> </tr> <tr> <td colspan="2"> <table border="1" style="width:100%; border-collapse: collapse;"> <tr> <th>PERFORMANCE CURVE NO.</th> <th>TORQUE @1075 RPM (25°C)</th> <th>APPROVED SAMPLE</th> <th>UL COMPONENT FILE #</th> <th>CCN #</th> <th>CSA FILE #</th> <th>CLASS #</th> </tr> <tr> <td>C19783</td> <td>27.6 OZ. FT.</td> <td>0040105</td> <td>E46412</td> <td>PRGY2</td> <td>LR43341</td> <td>4211-01</td> </tr> </table> </td> <td colspan="2"> <table border="1" style="width:100%; border-collapse: collapse;"> <tr> <th>DR BY:</th> <th>DATE</th> <th>DESCRIPTION</th> </tr> <tr> <td>YL</td> <td>04-15-2011</td> <td>MODEL-RFHP-48FR OUTLINE</td> </tr> <tr> <th>APPD:</th> <th>DATE</th> <th>EDS DATE</th> </tr> <tr> <td>HZ</td> <td>04-15-2011</td> <td>11-11-2011</td> </tr> <tr> <td>THRD ANGLE PROJECTION</td> <td></td> <td>FORMAT REV G</td> </tr> <tr> <td colspan="3"> CONFIDENTIAL: THIS DRAWING AND ITS INFORMATION ARE THE EXCLUSIVE AND CONFIDENTIAL PROPERTY OF REGAL-BELOIT CORPORATION AND ARE NOT TO BE DISCLOSED, DUPLICATED, DISTRIBUTED OR OTHERWISE USED WITHOUT THE WRITTEN CONSENT OF REGAL-BELOIT CORPORATION. -ALL RIGHTS RESERVED. </td> </tr> </table> </td> </tr> <tr> <td colspan="2"> GEOMETRIC CHARACTERISTICS & SYMBOLS □ FLATNESS - STRAIGHTNESS < ANGLARITY ⊥ PERPENDICULARITY (SQUARENESS) // PARALLELISM ○ ROUNDNESS (CIRCULARITY) ∅ CYLINDRICITY ~ PROFILE OF ANY SURFACE ~ PROFILE OF ANY LINE † RUNOUT ⊕ TRUE POSITION ⊙ CONCENTRICITY = SYMMETRY ASME Y14.5M 1994 </td> <td colspan="2"> REGAL-BELOIT CORPORATION (RBC) PROVIDES TECHNICAL ASSISTANCE TO OUR CUSTOMERS IN SEVERAL AREAS. SINCE RBC DOES NOT RECEIVE ALL DATA CONCERNING THE USE AND APPLICATION OF THE MOTOR, THE SUITABILITY OF THE MOTOR FOR THE APPLICATION MUST BE DETERMINED BY THE CUSTOMER. DIMENSIONS WITHOUT TOLERANCES ARE FOR REFERENCE ONLY. </td> </tr> <tr> <td style="text-align: center;">4</td> <td style="text-align: center;">3</td> <td style="text-align: center;">2</td> <td style="text-align: center;">1</td> </tr> </table>		LEAD DATA	ENCLOSURE	<table border="1" style="width:100%; border-collapse: collapse;"> <tr> <th>GREEN (GRD)</th> <th>53.0/56.0 [1346/1422]</th> <th>#10 EYELET</th> </tr> <tr> <td>BROWN</td> <td>53.0/56.0 [1346/1422]</td> <td>.25 [6.4] FEMALE SPADE</td> </tr> <tr> <td>YELLOW</td> <td>53.0/56.0 [1346/1422]</td> <td>.25 [6.4] FEMALE SPADE</td> </tr> <tr> <td>BLACK</td> <td>53.0/56.0 [1346/1422]</td> <td>.25 [6.4] FEMALE SPADE</td> </tr> <tr> <td>RED</td> <td>53.0/56.0 [1346/1422]</td> <td>.25 [6.4] FEMALE SPADE</td> </tr> <tr> <td>ORANGE</td> <td>53.0/56.0 [1346/1422]</td> <td>.25 [6.4] FEMALE SPADE</td> </tr> <tr> <td>PURPLE</td> <td>53.0/56.0 [1346/1422]</td> <td>.25 [6.4] FEMALE SPADE</td> </tr> <tr> <td>COLOR</td> <td>LENGTH</td> <td>TERMINAL OR STRIP LENGTH</td> </tr> </table>	GREEN (GRD)	53.0/56.0 [1346/1422]	#10 EYELET	BROWN	53.0/56.0 [1346/1422]	.25 [6.4] FEMALE SPADE	YELLOW	53.0/56.0 [1346/1422]	.25 [6.4] FEMALE SPADE	BLACK	53.0/56.0 [1346/1422]	.25 [6.4] FEMALE SPADE	RED	53.0/56.0 [1346/1422]	.25 [6.4] FEMALE SPADE	ORANGE	53.0/56.0 [1346/1422]	.25 [6.4] FEMALE SPADE	PURPLE	53.0/56.0 [1346/1422]	.25 [6.4] FEMALE SPADE	COLOR	LENGTH	TERMINAL OR STRIP LENGTH	<table border="1" style="width:100%; border-collapse: collapse;"> <tr> <td>MAIN FRAME - OLE</td> <td>OPEN</td> </tr> <tr> <td>END FRAME - OLE</td> <td>OPEN</td> </tr> <tr> <td>MAIN FRAME - LE</td> <td>ENCLOSED</td> </tr> <tr> <td>END FRAME - LE</td> <td>OPEN</td> </tr> </table>	MAIN FRAME - OLE	OPEN	END FRAME - OLE	OPEN	MAIN FRAME - LE	ENCLOSED	END FRAME - LE	OPEN	<table border="1" style="width:100%; border-collapse: collapse;"> <tr> <th>PERFORMANCE CURVE NO.</th> <th>TORQUE @1075 RPM (25°C)</th> <th>APPROVED SAMPLE</th> <th>UL COMPONENT FILE #</th> <th>CCN #</th> <th>CSA FILE #</th> <th>CLASS #</th> </tr> <tr> <td>C19783</td> <td>27.6 OZ. FT.</td> <td>0040105</td> <td>E46412</td> <td>PRGY2</td> <td>LR43341</td> <td>4211-01</td> </tr> </table>		PERFORMANCE CURVE NO.	TORQUE @1075 RPM (25°C)	APPROVED SAMPLE	UL COMPONENT FILE #	CCN #	CSA FILE #	CLASS #	C19783	27.6 OZ. FT.	0040105	E46412	PRGY2	LR43341	4211-01	<table border="1" style="width:100%; border-collapse: collapse;"> <tr> <th>DR BY:</th> <th>DATE</th> <th>DESCRIPTION</th> </tr> <tr> <td>YL</td> <td>04-15-2011</td> <td>MODEL-RFHP-48FR OUTLINE</td> </tr> <tr> <th>APPD:</th> <th>DATE</th> <th>EDS DATE</th> </tr> <tr> <td>HZ</td> <td>04-15-2011</td> <td>11-11-2011</td> </tr> <tr> <td>THRD ANGLE PROJECTION</td> <td></td> <td>FORMAT REV G</td> </tr> <tr> <td colspan="3"> CONFIDENTIAL: THIS DRAWING AND ITS INFORMATION ARE THE EXCLUSIVE AND CONFIDENTIAL PROPERTY OF REGAL-BELOIT CORPORATION AND ARE NOT TO BE DISCLOSED, DUPLICATED, DISTRIBUTED OR OTHERWISE USED WITHOUT THE WRITTEN CONSENT OF REGAL-BELOIT CORPORATION. -ALL RIGHTS RESERVED. </td> </tr> </table>		DR BY:	DATE	DESCRIPTION	YL	04-15-2011	MODEL-RFHP-48FR OUTLINE	APPD:	DATE	EDS DATE	HZ	04-15-2011	11-11-2011	THRD ANGLE PROJECTION		FORMAT REV G	CONFIDENTIAL: THIS DRAWING AND ITS INFORMATION ARE THE EXCLUSIVE AND CONFIDENTIAL PROPERTY OF REGAL-BELOIT CORPORATION AND ARE NOT TO BE DISCLOSED, DUPLICATED, DISTRIBUTED OR OTHERWISE USED WITHOUT THE WRITTEN CONSENT OF REGAL-BELOIT CORPORATION. -ALL RIGHTS RESERVED.			GEOMETRIC CHARACTERISTICS & SYMBOLS □ FLATNESS - STRAIGHTNESS < ANGLARITY ⊥ PERPENDICULARITY (SQUARENESS) // PARALLELISM ○ ROUNDNESS (CIRCULARITY) ∅ CYLINDRICITY ~ PROFILE OF ANY SURFACE ~ PROFILE OF ANY LINE † RUNOUT ⊕ TRUE POSITION ⊙ CONCENTRICITY = SYMMETRY ASME Y14.5M 1994		REGAL-BELOIT CORPORATION (RBC) PROVIDES TECHNICAL ASSISTANCE TO OUR CUSTOMERS IN SEVERAL AREAS. SINCE RBC DOES NOT RECEIVE ALL DATA CONCERNING THE USE AND APPLICATION OF THE MOTOR, THE SUITABILITY OF THE MOTOR FOR THE APPLICATION MUST BE DETERMINED BY THE CUSTOMER. DIMENSIONS WITHOUT TOLERANCES ARE FOR REFERENCE ONLY.		4	3	2	1
NAMEPLATE DATA:	EXTERNAL CONNECTION DIAGRAM																																																																																						
MODEL NO.: F48Z06A01 CUST. P/N: OCB1026A HP: 1/4 ROT.: REV RPM: 1075/2 SPD TYPE: UF FRAME: 48Y VOLTS: 208-230 PH: 1 AMPS: 2.2 HZ: 60 INS.: B AMB.: 60°C DUTY: AIR OVER CAP.: 5.0 MFD/440 V ENCL: SEMI-ENCL. UL LOGO CSA LOGO THERMALLY PROTECTED	<p>SEP. CAP.</p> <p>BRN</p> <p>YEL</p> <p>LINE</p> <p>BLK HI</p> <p>RED LO</p> <p>ORN</p> <p>PUR</p> <p>614131-052</p> <p>SHOWN FOR CCWLE ROT. FOR CWLE ROT. INTERCHANGE ORN AND BRN LEADS</p>																																																																																						
LEAD DATA	ENCLOSURE																																																																																						
<table border="1" style="width:100%; border-collapse: collapse;"> <tr> <th>GREEN (GRD)</th> <th>53.0/56.0 [1346/1422]</th> <th>#10 EYELET</th> </tr> <tr> <td>BROWN</td> <td>53.0/56.0 [1346/1422]</td> <td>.25 [6.4] FEMALE SPADE</td> </tr> <tr> <td>YELLOW</td> <td>53.0/56.0 [1346/1422]</td> <td>.25 [6.4] FEMALE SPADE</td> </tr> <tr> <td>BLACK</td> <td>53.0/56.0 [1346/1422]</td> <td>.25 [6.4] FEMALE SPADE</td> </tr> <tr> <td>RED</td> <td>53.0/56.0 [1346/1422]</td> <td>.25 [6.4] FEMALE SPADE</td> </tr> <tr> <td>ORANGE</td> <td>53.0/56.0 [1346/1422]</td> <td>.25 [6.4] FEMALE SPADE</td> </tr> <tr> <td>PURPLE</td> <td>53.0/56.0 [1346/1422]</td> <td>.25 [6.4] FEMALE SPADE</td> </tr> <tr> <td>COLOR</td> <td>LENGTH</td> <td>TERMINAL OR STRIP LENGTH</td> </tr> </table>	GREEN (GRD)	53.0/56.0 [1346/1422]	#10 EYELET	BROWN	53.0/56.0 [1346/1422]	.25 [6.4] FEMALE SPADE	YELLOW	53.0/56.0 [1346/1422]	.25 [6.4] FEMALE SPADE	BLACK	53.0/56.0 [1346/1422]	.25 [6.4] FEMALE SPADE	RED	53.0/56.0 [1346/1422]	.25 [6.4] FEMALE SPADE	ORANGE	53.0/56.0 [1346/1422]	.25 [6.4] FEMALE SPADE	PURPLE	53.0/56.0 [1346/1422]	.25 [6.4] FEMALE SPADE	COLOR	LENGTH	TERMINAL OR STRIP LENGTH	<table border="1" style="width:100%; border-collapse: collapse;"> <tr> <td>MAIN FRAME - OLE</td> <td>OPEN</td> </tr> <tr> <td>END FRAME - OLE</td> <td>OPEN</td> </tr> <tr> <td>MAIN FRAME - LE</td> <td>ENCLOSED</td> </tr> <tr> <td>END FRAME - LE</td> <td>OPEN</td> </tr> </table>	MAIN FRAME - OLE	OPEN	END FRAME - OLE	OPEN	MAIN FRAME - LE	ENCLOSED	END FRAME - LE	OPEN																																																						
GREEN (GRD)	53.0/56.0 [1346/1422]	#10 EYELET																																																																																					
BROWN	53.0/56.0 [1346/1422]	.25 [6.4] FEMALE SPADE																																																																																					
YELLOW	53.0/56.0 [1346/1422]	.25 [6.4] FEMALE SPADE																																																																																					
BLACK	53.0/56.0 [1346/1422]	.25 [6.4] FEMALE SPADE																																																																																					
RED	53.0/56.0 [1346/1422]	.25 [6.4] FEMALE SPADE																																																																																					
ORANGE	53.0/56.0 [1346/1422]	.25 [6.4] FEMALE SPADE																																																																																					
PURPLE	53.0/56.0 [1346/1422]	.25 [6.4] FEMALE SPADE																																																																																					
COLOR	LENGTH	TERMINAL OR STRIP LENGTH																																																																																					
MAIN FRAME - OLE	OPEN																																																																																						
END FRAME - OLE	OPEN																																																																																						
MAIN FRAME - LE	ENCLOSED																																																																																						
END FRAME - LE	OPEN																																																																																						
<table border="1" style="width:100%; border-collapse: collapse;"> <tr> <th>PERFORMANCE CURVE NO.</th> <th>TORQUE @1075 RPM (25°C)</th> <th>APPROVED SAMPLE</th> <th>UL COMPONENT FILE #</th> <th>CCN #</th> <th>CSA FILE #</th> <th>CLASS #</th> </tr> <tr> <td>C19783</td> <td>27.6 OZ. FT.</td> <td>0040105</td> <td>E46412</td> <td>PRGY2</td> <td>LR43341</td> <td>4211-01</td> </tr> </table>		PERFORMANCE CURVE NO.	TORQUE @1075 RPM (25°C)	APPROVED SAMPLE	UL COMPONENT FILE #	CCN #	CSA FILE #	CLASS #	C19783	27.6 OZ. FT.	0040105	E46412	PRGY2	LR43341	4211-01	<table border="1" style="width:100%; border-collapse: collapse;"> <tr> <th>DR BY:</th> <th>DATE</th> <th>DESCRIPTION</th> </tr> <tr> <td>YL</td> <td>04-15-2011</td> <td>MODEL-RFHP-48FR OUTLINE</td> </tr> <tr> <th>APPD:</th> <th>DATE</th> <th>EDS DATE</th> </tr> <tr> <td>HZ</td> <td>04-15-2011</td> <td>11-11-2011</td> </tr> <tr> <td>THRD ANGLE PROJECTION</td> <td></td> <td>FORMAT REV G</td> </tr> <tr> <td colspan="3"> CONFIDENTIAL: THIS DRAWING AND ITS INFORMATION ARE THE EXCLUSIVE AND CONFIDENTIAL PROPERTY OF REGAL-BELOIT CORPORATION AND ARE NOT TO BE DISCLOSED, DUPLICATED, DISTRIBUTED OR OTHERWISE USED WITHOUT THE WRITTEN CONSENT OF REGAL-BELOIT CORPORATION. -ALL RIGHTS RESERVED. </td> </tr> </table>		DR BY:	DATE	DESCRIPTION	YL	04-15-2011	MODEL-RFHP-48FR OUTLINE	APPD:	DATE	EDS DATE	HZ	04-15-2011	11-11-2011	THRD ANGLE PROJECTION		FORMAT REV G	CONFIDENTIAL: THIS DRAWING AND ITS INFORMATION ARE THE EXCLUSIVE AND CONFIDENTIAL PROPERTY OF REGAL-BELOIT CORPORATION AND ARE NOT TO BE DISCLOSED, DUPLICATED, DISTRIBUTED OR OTHERWISE USED WITHOUT THE WRITTEN CONSENT OF REGAL-BELOIT CORPORATION. -ALL RIGHTS RESERVED.																																																						
PERFORMANCE CURVE NO.	TORQUE @1075 RPM (25°C)	APPROVED SAMPLE	UL COMPONENT FILE #	CCN #	CSA FILE #	CLASS #																																																																																	
C19783	27.6 OZ. FT.	0040105	E46412	PRGY2	LR43341	4211-01																																																																																	
DR BY:	DATE	DESCRIPTION																																																																																					
YL	04-15-2011	MODEL-RFHP-48FR OUTLINE																																																																																					
APPD:	DATE	EDS DATE																																																																																					
HZ	04-15-2011	11-11-2011																																																																																					
THRD ANGLE PROJECTION		FORMAT REV G																																																																																					
CONFIDENTIAL: THIS DRAWING AND ITS INFORMATION ARE THE EXCLUSIVE AND CONFIDENTIAL PROPERTY OF REGAL-BELOIT CORPORATION AND ARE NOT TO BE DISCLOSED, DUPLICATED, DISTRIBUTED OR OTHERWISE USED WITHOUT THE WRITTEN CONSENT OF REGAL-BELOIT CORPORATION. -ALL RIGHTS RESERVED.																																																																																							
GEOMETRIC CHARACTERISTICS & SYMBOLS □ FLATNESS - STRAIGHTNESS < ANGLARITY ⊥ PERPENDICULARITY (SQUARENESS) // PARALLELISM ○ ROUNDNESS (CIRCULARITY) ∅ CYLINDRICITY ~ PROFILE OF ANY SURFACE ~ PROFILE OF ANY LINE † RUNOUT ⊕ TRUE POSITION ⊙ CONCENTRICITY = SYMMETRY ASME Y14.5M 1994		REGAL-BELOIT CORPORATION (RBC) PROVIDES TECHNICAL ASSISTANCE TO OUR CUSTOMERS IN SEVERAL AREAS. SINCE RBC DOES NOT RECEIVE ALL DATA CONCERNING THE USE AND APPLICATION OF THE MOTOR, THE SUITABILITY OF THE MOTOR FOR THE APPLICATION MUST BE DETERMINED BY THE CUSTOMER. DIMENSIONS WITHOUT TOLERANCES ARE FOR REFERENCE ONLY.																																																																																					
4	3	2	1																																																																																				

REVISION: ECO	REVISADO POR: O. CARVAJAL	FECHA: 05-01-2012	APROBADO POR: M. AVILA	FECHA: 05-01-2012
B	0025554			

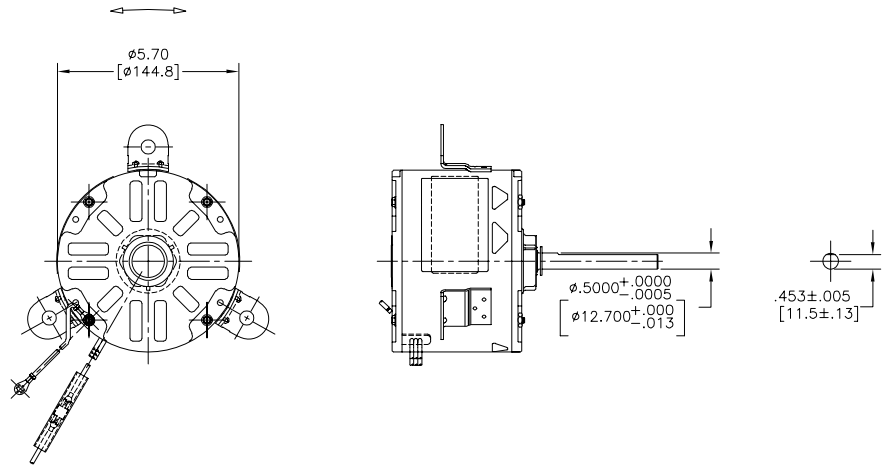

F48Z06A01
OCB1026A

1/4

1075/2 SPD
UF
48Y
208-230

1

2.2

60
B
60°C

5.0 MFD/440 V

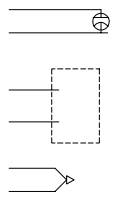

614131-052

	53.0/56.0	
	[1346/1422]	
	53.0/56.0	
	[1346/1422]	
	53.0/56.0	
	[1346/1422]	
	53.0/56.0	
	[1346/1422]	
	53.0/56.0	
	[1346/1422]	
	53.0/56.0	
	[1346/1422]	

C19783	27.6 OZ. FT.	0040105	E46412	PRGY2	LR43341	4211-01
--------	--------------	---------	--------	-------	---------	---------

CARACTERISTICAS DE GEOMETRIA Y SIMBOLOS

- ▮ PLANICIDAD
- RECTITUD
- ∠ ANGULARIDAD
- ⊥ PERPENDICULARIDAD (A ESQUADRA)
- // PARALELISMO
- REDONDEZ (CIRCULARIDAD)
- ⊘ CILINDRICIDAD
- ⊖ PERFIL DE CUALQUIER SUPERFICIE
- ⊖ PERFIL DE CUALQUIER LINEA
- ↑ VARIACION
- ⊕ POSICION REAL
- ⊙ CONCENTRICIDAD
- ≡ SIMETRIA

ASME Y14.5M 1994

REGAL-BELOIT CORPORATION (RBC)
PROVEE ASISTENCIA TECNICA A
NUESTROS CLIENTES EN VARIAS AREAS.
DESDE QUE RBC NO RECIBE TODOS
LOS DATOS EN RELACION AL USO Y A
LA APLICACION DEL MOTOR, LA
APLICACION ADECUADA DEL MOTOR
DEBE SER DETERMINADA POR EL
CLIENTE.

DIMENSIONES SIN TOLERANCIA SON
DE REFERENCIA SOLAMENTE

DIBUJADO POR:
YL

APROBADO POR:
HZ

TERCER ANGULO
DE PROYECCION

04-15-2011

04-15-2011

FECHA EDS: 11-11-2011
REV. FORMATO: G

CONFIDENCIAL: ESTE DIBUJO Y SU INFORMACION
SON PROPIEDAD DE USO EXCLUSIVO Y CONFIDENCIAL DE
REGAL-BELOIT CORPORATION. Y NO DEBERAN SER REVELADOS,
DUPLICADOS, DISTRIBUIDOS O USARSE DE OTRA MANERA
SIN EL CONSENTIMIENTO ESCRITO DE REGAL-BELOIT
CORPORATION. -TODOS LOS DERECHOS RESERVADOS.

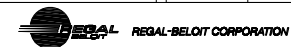

DESCRIPCION:

MODEL-RFHP-48FR
OUTLINE

TAMAÑO:

C NUMERO DE DIBUJO:
OCB1026A

ESCALA: NONE

HOJA: 1

版本	ECO	编制	日期	批准	日期
B	0025554	O. CARVAJAL	05-01-2012	M. AVILA	05-01-2012

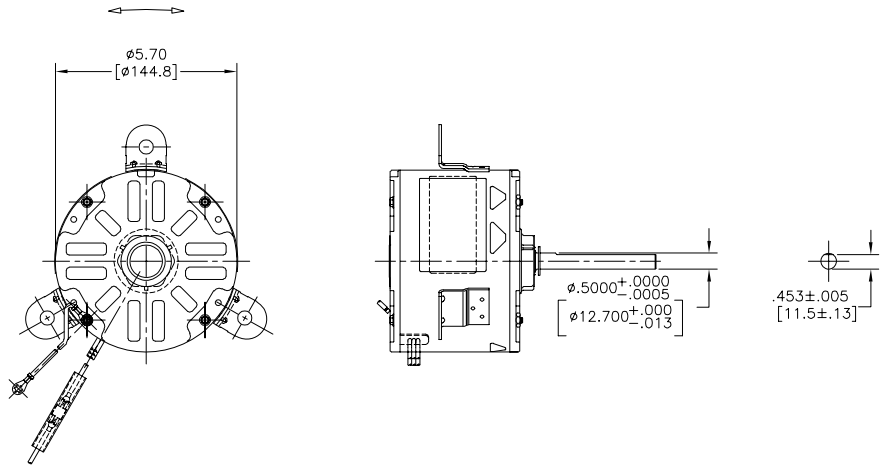

F48Z06A01
OCB1026A

1/4

1075/2 SPD
UF
48Y
208-230

1

2.2
60
B
60°C

5.0 MFD/440 V

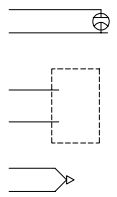

614131-052

	53.0/56.0	
	[1346/1422]	
	53.0/56.0	
	[1346/1422]	
	53.0/56.0	
	[1346/1422]	
	53.0/56.0	
	[1346/1422]	
	53.0/56.0	
	[1346/1422]	
	53.0/56.0	
	[1346/1422]	

C19783	27.6 OZ. FT.	0040105	E46412	PRGY2	LR43341	4211-01
--------	--------------	---------	--------	-------	---------	---------

- 形位公差
- 平面度
- 直线度
- ∠ 倾斜度
- ⊥ 垂直度
- ∥ 平行度
- 圆度
- ⊙ 圆跳动
- ⊖ 面轮廓度
- ⊖ 线轮廓度
- ↻ 圆跳动
- ↻ 位置度
- ↻ 对称度

ASME Y14.5M 1994

REGAL-BELOIT CORPORATION (RBC) 在个别领域为客户提供技术支持。鉴于 RBC 未收到任何涉及电机使用和应用环境的数据，电机的适用性由客户自己决定。

未注公差尺寸仅供参考。

除图：
批准：YL 04-15-2011
HZ 04-15-2011
第三角投影
图框格式发布日期 11-11-2011
图框格式版本 C
机密：本图纸及相关信息所有权归 REGAL-BELOIT CORPORATION。未经 REGAL-BELOIT CORPORATION 书面授权，不得泄露、复制或传播作其他用途。— 版权所有



MODEL-RFHP-48FR
OUTLINE

名称	MODEL-RFHP-48FR OUTLINE	
图幅	C	图号
比例	NONE	页号
		1

4

3

2

1

REV	ECO	REV BY	DATE	APPD	DATE
B	0020045	YL	04-15-2011	HZ	04-15-2011

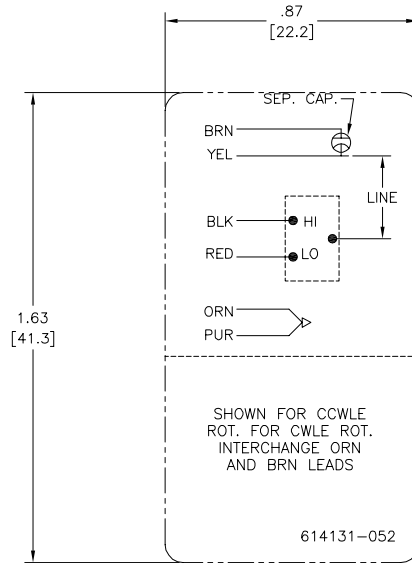

- NOTES:
- FOR USE WITH 614129 OR 2513020-001 NAMEPLATE BLANKS
 - INDICATES DIMENSION LIMITS

GEOMETRIC CHARACTERISTICS & SYMBOLS ▭ FLATNESS — STRAIGHTNESS ∠ ANGULARITY ⊥ PERPENDICULARITY (SQUARENESS) ∥ PARALLELISM ○ ROUNDNESS (CIRCULARITY) ⌀ CYLINDRICITY △ PROFILE OF ANY SURFACE ∩ PROFILE OF ANY LINE † RUNOUT ⊕ TRUE POSITION ⊙ CONCENTRICITY ≡ SYMMETRY	UNLESS OTHERWISE SPECIFIED DIM. TOLERANCES ARE AS FOLLOWS: INCH X XX XXX XXXX ±.1 ±.02 ±.005 ±.0005 mm ±0.5 ±0.13 ±0.013 ANG. ±.50 DEG REMOVE BURRS & BREAK SHARP EDGES: INCH .003-.015 mm 0.1-.04 CORNER FILLETS TO: INCH .020 mm 0.5 MACHINE SURFACES: INCH 125 mm 3.2 METRIC DIMS. SHOWN IN [BRACKETS]	DR BY:	YL	04-15-2011	ELECTRICAL PRODUCTS COMPANY A DIVISION OF A.O. SMITH CORPORATION
		APPD:	HZ	04-15-2011	
		THIRD ANGLE PROJECTION		EDS DATE 02-22-2008 FORMAT REV F	SIZE C DWG NO 614131-052
		CONFIDENTIAL: THIS DRAWING AND ITS INFORMATION ARE THE EXCLUSIVE AND CONFIDENTIAL PROPERTY OF A.O. SMITH CORP. AND ARE NOT TO BE DISCLOSED, DUPLICATED, DISTRIBUTED OR OTHERWISE USED WITHOUT THE WRITTEN CONSENT OF A.O. SMITH CORP. -ALL RIGHTS RESERVED.		ASME Y14.5M 1994	SCALE SHEET 1

4

3

2

1

4

3

2

1

REVISION:	ECO	REVISADO POR:	FECHA:	APROBADO POR:	FECHA:
B	0020045	YL	04-15-2011	HZ	04-15-2011

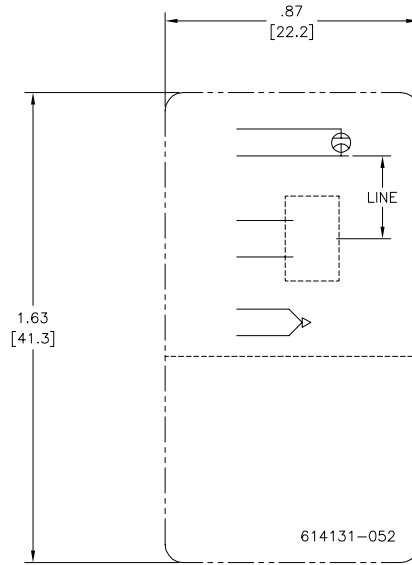

- NOTAS:
1. PARA USO CON PLACA DE DATOS EN BLANCO 614129 OR 2513020-001.
 2. INDICA LIMITES DE DIMENSION

CARACTERISTICAS DE GEOMETRIA Y SIMBOLOS ▽ PLANICIDAD — RECTITUD ∠ ANGULARIDAD ⊥ PERPENDICULARIDAD (A ESCUADRA) // PARALELISMO ○ REDONDEZ (CIRCULARIDAD) Ⓞ CILINDRICIDAD Ⓜ PERFIL DE CUALQUIER SUPERFICIE ⤴ PERFIL DE CUALQUIER LINEA † VARIACION ⊕ POSICION REAL ⊙ CONCENRICIDAD ⊖ SIMETRIA	A MENOS QUE SE ESPECIFIQUE DE OTRA MANERA, LAS TOLERANCIAS DE LAS DIMS. SON LAS SIGUIENTES: PULG ±.1 ±.02 ±.005 ±.0005 mm ±0.5 ±0.13 ±0.013 ANG. ±50 GRADOS ELIMINAR REBABAS Y ORILLAS FILOSAS DEL BORDE. PULG .003-.015 mm 0.1-0.4 FILETEAR ESQUINA: PULG .020 mm 0.5 MAQUINAR SUPERFICIES PULG .125 mm 3.2 DIMS METRICAS MOSTRADAS [PARENTESIS]	DIBUJADO POR:	YL	04-15-2011	ELECTRICAL PRODUCTS COMPANY A DIVISION OF A. O. SMITH CORPORATION
		APROBADO POR:	HZ	04-15-2011	
		TERCER ANGULO DE PROYECCION		FECHA EDS: 02-22-2008 REV. FORMATO: F	TAMAÑO: C
		CONFIDENCIAL: ESTE DIBUJO Y SU INFORMACION SON PROPIEDAD DE USO EXCLUSIVO Y CONFIDENCIAL DE A.O.SMITH CORP. Y NO DEBERAN SER REVELADOS, DUPLICADOS, DISTRIBUIDOS O USARSE DE OTRA MANERA SIN EL CONSENTIMIENTO ESCRITO DE A.O. SMITH CORP. -TODOS LOS DERECHOS RESERVADOS.ASME Y14.5M 1994		NUMERO DE DIBUJO:	614131-052
				ESCALA:	HOJA: 1

4

3

2

1

4

3

2

1

版本	ECO	编制	日期	批准	日期
B	0020045	YL	04-15-2011	HZ	04-15-2011

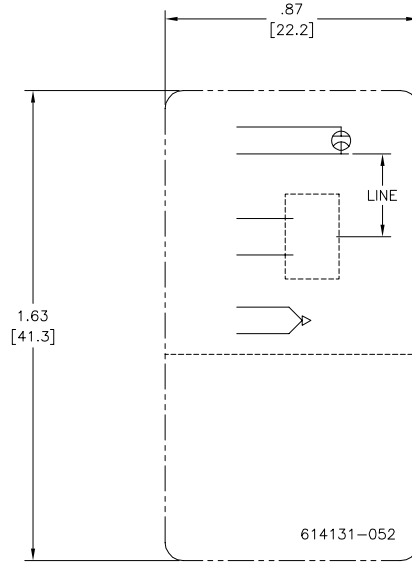

形位公差 □ 平面度 — 直线度 ∠ 倾斜度 ⊥ 垂直度 // 平行度 ○ 圆度 ⊙ 圆跳动 Ⓜ 面轮廓度 Ⓡ 轮廓度 Ⓢ 线轮廓度 Ⓣ 圆跳动 Ⓤ 位置度 Ⓥ 同轴度 Ⓦ 对称度	除另有注明 尺寸公差如下： 英寸 X XX XXX XXXX 毫米 ±.1 ±.02 ±.005 ±.0005 角度 ±.50 度 清理毛刺和尖棱 英寸 .003-.015 毫米 0.1-0.4 内圆角 英寸 .020 毫米 0.5 表面粗糙度 英制 125 米制 3.2 米制尺寸显示在[]	绘图： YL 批准： HZ 第三角投影	04-15-2011 04-15-2011 图纸格式发布日期 02-22-2008 图纸格式版本 F	AC Smith Innovation has a name. ELECTRICAL PRODUCTS COMPANY A DIVISION OF A. O. SMITH CORPORATION
	名称 CONN DIAGRAM-NAMEPLATE	图幅 C	图号 614131-052	比例 1
	机密：本图纸及相关信息所有权归A. O. SMITH公司所有。 未经A. O. SMITH公司书面授权，不得泄露、复制、传播或作 其他用途。—版权所有	ASME Y14.5M 1994		
	图纸格式发布日期 02-22-2008 图纸格式版本 F			

4

3

2

1