

PRODUCT INFORMATION PACKET

FASCO®

Model No: D459

Catalog No: D459

1/15 HP OEM Replacement Motor, 3000 RPM, 230/460 Volts, 3.3" Diameter, Semi Enclosed
HVAC/R OEM Replacement Motors



Regal and Fasco are trademarks of Regal Beloit Corporation or one of its affiliated companies.
©2019 Regal Beloit Corporation, All Rights Reserved. MC017097E

REGAL



Nameplate Specifications

Output HP	1/15 Hp	Output KW	0.05 kW
Frequency	60 Hz	Voltage	230/460 V
Current	1.2/6 A	Speed	3000 rpm
Service Factor	1	Phase	1
Duty	Air Over	Insulation Class	B
Frame	3.3	Enclosure	Open Air Over
Thermal Protection	Thermally Protected	Ambient Temperature	40 °C
UL	No	CSA	N
CE	N		

Technical Specifications

Electrical Type	Shaded Pole	Starting Method	Across The Line
Poles	2	Rotation	Clockwise Shaft End
Mounting	Extended Studs	Drive End Bearing	Ball
Opp Drive End Bearing	Ball	Frame Material	Steel
Shaft Type	Flat	Overall Length	10.20 in
Frame Length	4.52 in	Shaft Diameter	0.250 in
Shaft Extension	3 in		

This is an uncontrolled document once printed or downloaded and is subject to change without notice. Date Created:29/10/2019

FRONT END

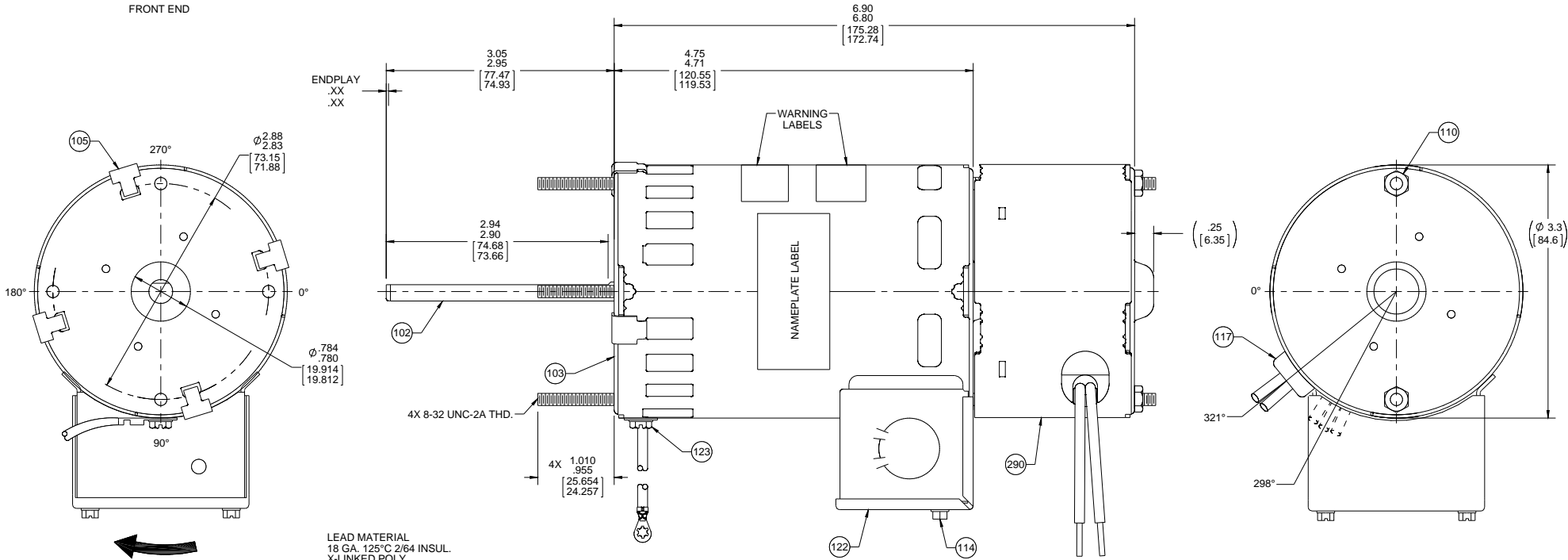

LEAD MATERIAL
 18 GA. 125°C 2/64 INSUL.
 X-LINKED POLY.
 (1) ORANGE, (1) YELLOW,
 (1) BLUE, (1) RED, (1) BLACK
 7.00/5.00 [177.80/127.00]
 .56/.44 [14.22/11.18] STRIP

SWITCH LEADS
 18 GA. 105°C 4/64 INSUL.
 THERMO., (2) BROWN
 17.50/15.50 [444.50/393.70]
 .56/.44 [14.22/11.18] STRIP

GROUND LEAD
 18 GA. 105°C 2/64 INSUL.
 THERMO., GRN/YEL
 13.00/11.00 [330.20/279.40]
 TERM. 89020156
 AMP 61794-1

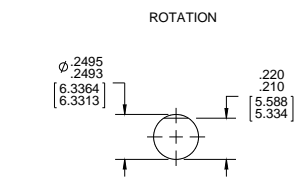

NOTES:
 1. NO PACKAGING TAPE OVER CARTON LABEL.

61294176

WARNING

WHEN OPERATED ON 460 V. SPECIAL CARE SHOULD BE TAKEN WITH HANDLING, CONNECTIONS AND GROUNDING TO AVOID SHOCK HAZARD.

WARNING LABEL TO READ RIGHT FROM BACK END

61305568

SAFETY WARNING
 This motor must be grounded in accordance with local or national electrical codes to prevent possible injury due to electrical shock.

AVERTISSEMENT DE SECURITE
 Ce moteur doit être fondée sur conformément à la réglementation locale ou national électrique codes pour prévenir éventuelles blessures en raison de choc électrique.

WARNING LABEL TO READ RIGHT FROM BACK END

00464072

FASCO Fasco Industries, Inc
 Motor Division

Assembled in Mexico
 No. 71219007 TYPE U21B T.P.
 230/460 V 60 Hz Class B
 1.2/6 A 3000 RPM
 Model D459 Sealed Ball Brg SW280-10

1/15 HP
 Max Amb: 40°C
 SW125VA-120V

61299553

Connection Diagram
 230 V 460 V
 Orm — Line Orm — Line
 Yel — Line Yel — Line
 Blu — Line Blu — Ins
 Red — Ins Red — Ins
 Blk — Ins Blk — Ins
 Grn/Yel — Grd
 Brn — Switch
 Brn — Switch

CUSTOMER:	FASCO DIST.	APPLICATION:	GAS FURNACE									
CUSTOMER PN:	D459	MOTOR WEIGHT:	4 5/8 LBS.									
		ENVIRONMENT:	DRY									
HORIZONTAL	UP	MOTOR TYPE					REFERENCE SAMPLE					
		B	LA	FR	A	S	C	E	B	A		
		00	21	34	F	07	DG	9	0	0		
TYPICAL PERFORMANCE AT 230/460 VOLTS 60 HZ												
MOTOR SPEED	IDLE			LOADED			LOCKED			BREAK		
	RPM	AMP	WATT	IN OZ	RPM	AMP	WATT	IN OZ	AMP	WATT	IN OZ	
460 V	3526	.48	98	23.57	3000	.59	168	6.70	.74	189	23.75	

DRAWING REVISION	REVISION BY	DATE	TOLERANCES UNLESS OTHERWISE SPECIFIED:	DRAWN BY	DATE	DESCRIPTION
T	PLA	3/8/2016	DEC. INCH mm ANGLE	PLA	3/8/2016	MOTOR ASSY
ECO-0096613	APPROVED BY	DATE	.X +0.1 [±2.5]		3/8/2016	
	MLS	3/8/2016	.XX +0.01 [±0.25]			
			.XXX +0.005 [±0.127]			
			.XXXX +0.0005 [±0.0127]			
			REMOVE BURRS & BREAK SHARP EDGES: .003/015 [0.076/3.81] X 45° CORNER FILLETS: R.02 [5.1]			
			MACHINED SURFACES: .125/3.2 INCH V mm			
			mm SHOWN IN [BRACKETS]			
				THIRD ANGLE PROJECTION	SIZE	DRAWING NUMBER
				C		71219007
						PROCESS/FINISH
						BLACK
						SHEET
						1 OF 2

- NOTES:
1. ALL SPACINGS THRU AIR BETWEEN WIRE AND METAL MUST BE AT LEAST .094 [2.388].
 2. NO KNOCKOUTS REMOVED.
 3. ASSEMBLE SPRING BETWEEN WASHER AND BEARING ON CLIP END WITH SPRING FINGERSTOWARD BEARING.
 4. ASSEMBLE BALL BEARINGS TO BEARING RETAINER PER 88834419.
 5. HI POT MOTOR ASSEMBLY AT 2350 VOLTS FOR 1 SECOND.
 6. COIL LEADS INSIDE CONDUIT BOX AFTER TESTING AND SECURE COVER WITH PG 114 SCREW.

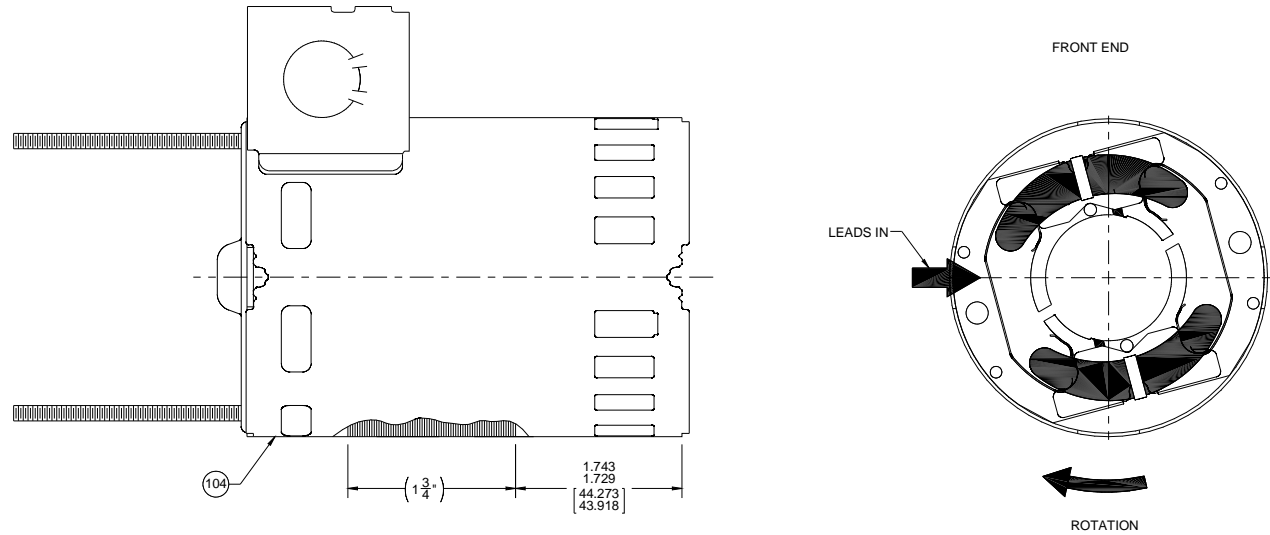

SWITCH SPECIFICATIONS

1. PRESS ACTUATOR ASSEMBLY AND THIMBLE SO THAT TOP OF METAL ACTUATOR PLATE IS .568/ .548 [14.427/13.919] FROM END OF SHAFT.
2. SWITCH MUST BE ADJUSTED TO OBTAIN .035/.025 [.889/.635] AIR GAP BETWEEN THIMBLE AND SWITCH IN FULL OPERATING POSITION.
3. ASSEMBLE SWITCH ASSEMBLY AND ACTUATOR PER PROCESS STANDARD.
4. WHEN ASSEMBLING HEYCO, NO SLACK ALLOWED INSIDE SWITCH COVER.
5. SWITCH MUST MAKE CONTACT BETWEEN 1800-2500 RPM AS SPEED INCREASES AND BREAK 50-500 RPM BELOW ACTUAL MAKE.
6. SWITCH MECHANISM TO GIVE QUIET OPERATION ABOVE 2500 RPM.

PACKING SPECIFICATIONS

1. PACK 1 PER CONTAINER, 140 MAX. PER PALLET, PACKING ASSY.: 87854917, 20 CARTONS MAX. PER LAYER, 7 LAYERS PER PALLET, PER 88834200 AND 88834408.
2. CARTON LABELS MUST ALL FACE ONE DIRECTION TOWARD THE OPEN END OF THE PALLET. SEE 88834408.

DRAWING REVISION T	REVISION BY PLA	DATE 3/8/2016	TOLERANCES UNLESS OTHERWISE SPECIFIED: DEC. INCH mm ANGLE .X ±0.1 [±2.5] ±1° .XX ±0.01 [±0.25] .XXX ±0.005 [±0.127] .XXXX ±0.0005 [±0.0127]	DRAWN BY PLA	Regal Beloit America, Inc.
ECO ECO-0096613	APPROVED BY MLS	DATE 3/8/2016	APPROVED BY MLS	DATE 3/8/2016	
ECO DESCRIPTION CORRECTED N/P AMPS & REDRAWN ON SW.			EDGE: .003/.015 [0.076/.381] X 45° CORNER FILLETS: R.02 [51] MACHINED SURFACES: .125/ .3/2 INCH V mm √ mm SHOWN IN [BRACKETS]	REFERENCE	DESCRIPTION MOTOR ASSY
<small>PROPRIETARY AND CONFIDENTIAL INFORMATION. THIS DOCUMENT IS THE PROPERTY OF REGAL BELOIT AMERICA, INC. OWNERSHIP AND CONTAINS OWNERS PROPRIETARY INFORMATION. ANY PERSON, CORPORATION OR OTHER FIRM RECEIVING IT IS DEEMED, BY RECEIVING IT, TO AGREE THAT IT, AND/OR ANY PART OF IT, SHALL NOT BE DISCLOSED TO ANY PERSON, CORPORATION OR OTHER ENTITY, DUPLICATED, AND/OR USED, EXCEPT AS EXPRESSLY APPROVED IN WRITING IN ADVANCE BY OWNER. THIS DOCUMENT SHALL BE RETURNED TO OWNER UPON REQUEST. IT MAY BE SUBJECT TO CERTAIN RESTRICTIONS UNDER APPLICABLE EXPORT CONTROL LAWS AND REGULATIONS.</small>			THIRD ANGLE PROJECTION	MATERIAL	PROCESS/FINISH BLACK
			SIZE C	DRAWING NUMBER 71219007	SHEET 2 OF 2