

PRODUCT INFORMATION PACKET

FASCO®

Model No: D291

Catalog No: D291

1/10-1/15-1/25-1/40 HP Fan Coil / Room Air Conditioner Motor, 1050 RPM, 4 Speed, 115 Volts, 42 Frame, OAO
Fan Coil / Room Air Conditioner Motors



Regal and Fasco are trademarks of Regal Beloit Corporation or one of its affiliated companies.
©2020 Regal Beloit Corporation, All Rights Reserved. MC017097E

REGAL



Nameplate Specifications

Output HP	1/10-1/15-1/25-1/40 Hp	Output KW	0.07 kW
Frequency	60 Hz	Voltage	115 V
Current	2.2/1.4/1.0/0.7 A	Speed	1050 rpm
Service Factor	1	Phase	1
Duty	Continuous	Insulation Class	B
Frame	42	Enclosure	Open Air Over
Thermal Protection	Automatic	Ambient Temperature	40 °C
UL	Recognized	CSA	Y
CE	N		

Technical Specifications

Electrical Type	Permanent Split Capacitor	Starting Method	Across The Line
Poles	6	Rotation	Clockwise Lead End
Mounting	Resilient Base	Drive End Bearing	Sleeve
Opp Drive End Bearing	Sleeve	Frame Material	Na
Shaft Type	Flat	Overall Length	24.68 in
Shaft Diameter	0.500 in	Shaft Extension	10.75 in
Connection Drawing	SEE OUTLINE	Outline Drawing	7186001716_S001

This is an uncontrolled document once printed or downloaded and is subject to change without notice. Date Created:06/11/2020

NOTES

1. THRU AIR SPACING BETWEEN WIRE AND METAL .094 MIN.
2. THE BOLT TOLERANCE 7 - 12 IN. LBS.
3. FOR WASHER SET-UP SEE CHART C600 0279, DETAIL "A".
4. SALES TO SPECIFY ON P.O. WHICH PACK TO USE.

Uncontrolled Copy

ECO	REV.	DATE	SPEC/CHECK
641584	16	9-20-10	M/R/MKR
631602	13	8-15-03	JAK/RWS
638799	14	11-11-08	GAE/GAE
639182	15	03-10-09	GAE/GAE

- A. SEE PACKAGING MANUAL PAGE 2 FOR PACKAGING PROCEDURES
- 1 MOTOR/CARTON:
10 MOTOR/SILAYER:
5 LAYERS/PALLET:
50 MOTOR/S/PALLET.
- B. SEE DRAWING 8785 6079 SH. 2 FOR PALLET LAYOUT.
- C. CENTER LABEL, 6119 6054, ON END OF CARTON.
- D. PLACE PAMPHLET, 8122 4579, IN CARTON WITH MOTOR.

PERFORMANCE TEST AT 115 VOLTS 60 HZ	115 VOLTS 60 HZ	1 PH	1/10 HP	CAP. 4 MFD 320 VAC	BREAK
AMP	WATT	OZ/IN	RPM	AMP	OZ/IN
1.39	105.6	126	1050	2.09	3.10
.58	59.4	96	74.0	1.27	2.03
48	40.7	54	52.0	87	1.45
.29	30.8	37	36.0	62	1.05
		28	1050	60	1.05
					91
					39.0

PRODUCTION TEST AT 115 VOLTS 60 HZ		PERFORMANCE TEST		115 VOLTS 60 HZ		1 PH		1/10 HP		CAP. 4 MFD 320 VAC		BREAK
AMP	WATT	RPM	AMP	WATT	OZ/IN	RPM	AMP	WATT	OZ/IN	AMP	WATT	OZ/IN
1.39	105.6	1195	1.26	96	128.0	1050	2.09	220	41.0	3.10	329	133.0
.70	59.4	1193	.64	54	74.0	1050	1.27	128	24.0	2.03	197	77.0
.48	40.7	MED HI	.44	37	52.0	1050	87	86	17.0	1.45	133	57.0
.35	29	MED LO	.32	28	36.0	1050	62	60	11.0	1.05	91	39.0
		LO										

HI-POT TEST 2000 VOLTS
MAX LEAKAGE CURRENT 5 mA
7186 0017 MA

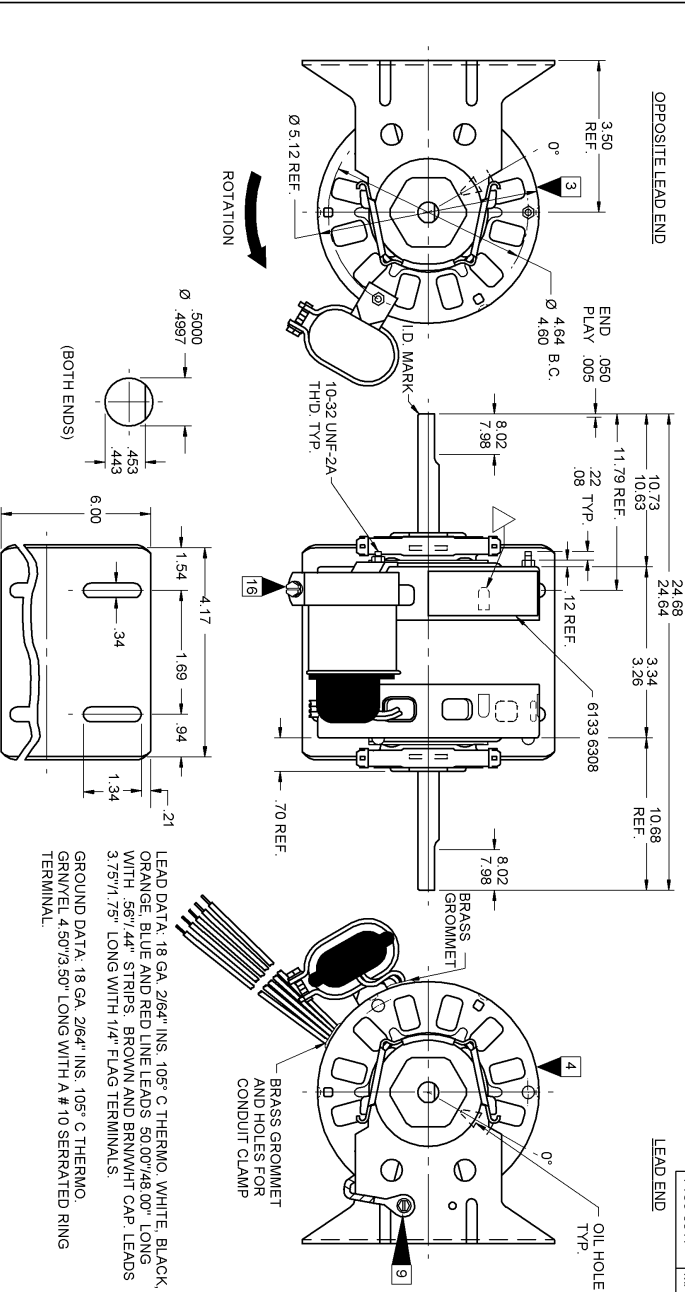

7186 0017 = MADE IN U.S.A.
7186 0017R = ASSEMBLED IN MEXICO

FASCO INDUSTRIES, INC.
CONNECTION DIAGRAM

BRN BRN WHT
BRN WHT
WHT COMM
BLK HI
RED M LO
LINE
CAPACITOR
LINE

MODEL D291
ORIG. LO
REDO

DATE/PART CODE AREA PER 8882 6003

LOCATE EDGE OF NAMEPLATE .05 FROM EDGE OF OPP. LE COVER TO READ
RIGHT FROM LEAD END OF MOTOR CENTER AT 280° CWLW.
SIZE 3.50 X 1.00

APPLICATOR: DIST. SALES
FINISH COLOR: GRAY
MOTOR WEIGHT: LBS.
ENVIRONMENT: DRY
INSULATION CLASS: B

MOTOR TYPE P.S.C.
MOTOR NUMBER REV. 71860017 16