

# PRODUCT INFORMATION PACKET

FASCO®

Model No: D176  
Catalog No: D176  
1/10-1/20 HP Fan & Blower Motor, 1050 RPM, 2 Speed, 115 Volts, 42 Frame, OAO  
Direct Drive Motors



Regal and Fasco are trademarks of Regal Beloit Corporation or one of its affiliated companies.  
©2020 Regal Beloit Corporation, All Rights Reserved. MC017097E

REGAL



**Nameplate Specifications**

Output HP	1/10-1/20 Hp	Output KW	0.07 kW
Frequency	60 Hz	Voltage	115 V
Current	3.9/1.7 A	Speed	1050 rpm
Service Factor	1	Phase	1
Duty	Air Over	Insulation Class	A
Frame	42	Enclosure	Open Air Over
Thermal Protection	Thermally Protected	Ambient Temperature	40 °C
UL	Recognized	CSA	Y
CE	N		

**Technical Specifications**

Electrical Type	Shaded Pole	Starting Method	Across The Line
Poles	6	Rotation	Clockwise Shaft End
Mounting	Resilient Rings	Drive End Bearing	Sleeve
Opp Drive End Bearing	Sleeve	Frame Material	Na
Shaft Type	Flat	Overall Length	6.40 in
Shaft Diameter	0.375 in	Shaft Extension	3.00 in
Connection Drawing	SEE OUTLINE	Outline Drawing	71510112

This is an uncontrolled document once printed or downloaded and is subject to change without notice. Date Created:06/11/2020

OPPOSITE LEAD END

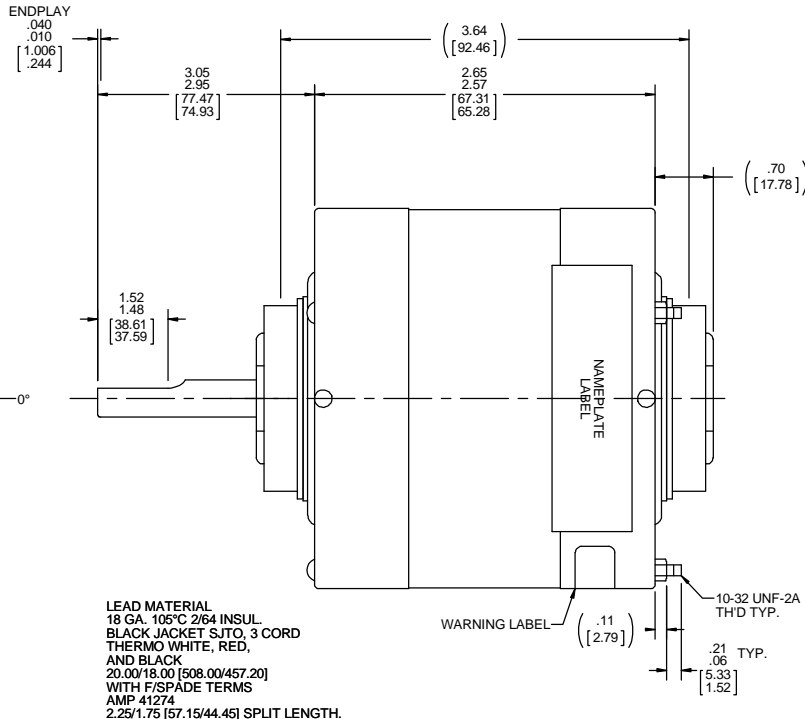
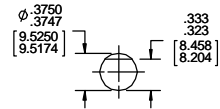
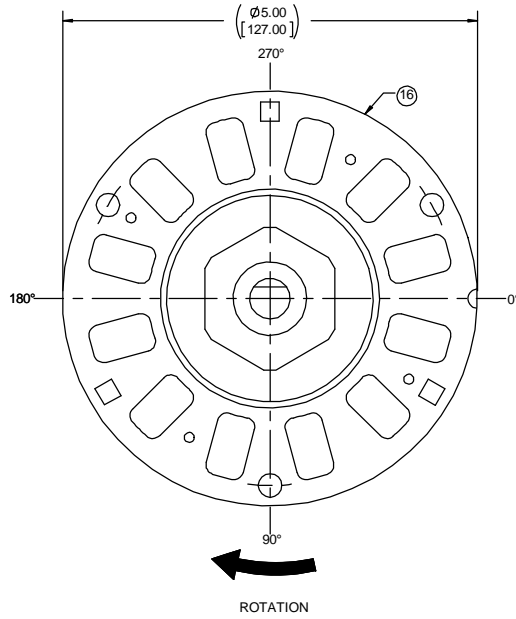

**LEAD MATERIAL**  
18 GA. 105°C 2/64 INSUL.  
BLACK JACKET SJTO, 3 CORD  
THERMO WHITE, RED,  
AND BLACK  
20.00/18.00 [508.00/457.20]  
WITH F/SPADE TERMS  
AMP 41274  
2.25/1.75 [57.15/44.45] SPLIT LENGTH.

**GROUND LEAD MATERIAL**  
18 GA. 105°C 2/64 INSUL.  
THERMO. GRN/YEL  
7.00/6.00 [177.80/152.40]  
WITH RING TERM.  
AMP 350436-2

LEAD END

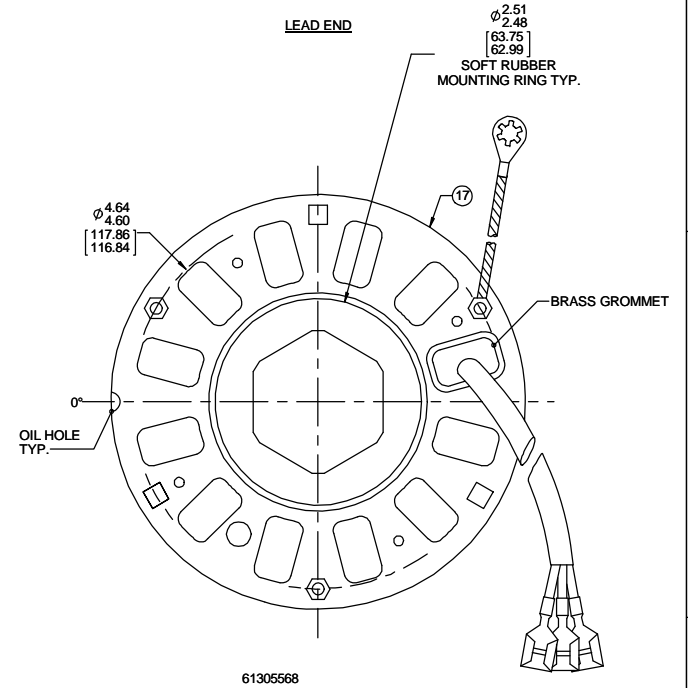

61305568

**SAFETY WARNING**  
This motor must be grounded in accordance with local or national electrical codes to prevent possible injury due to electrical shock

**AVERTISSEMENT DE SÉCURITÉ**  
Ce moteur doit être fondée sur conformément à la réglementation locale ou national électrique codes pour prévenir d'éventuelles blessures en raison de choc électrique

**NOTES:**

- THRU AIR SPACING BETWEEN WIRE AND METAL .10 [2.54] MIN.
- SHAFT IS BONDERIZED.
- FOR WASHER SET-UP, SEE CHART C6000279, DETAIL H'.
- ROTOR FREENESS TO BE WITHIN 3/4 OZ. IN. TORQUE.
- TIE BOLT TORQUE TOLERANCE 10-15 IN.LBS.
- PLACE PAMPHLET, 61224579, IN CARTON WITH MOTOR.
- PACK 1 MOTOR PER CONTAINER, 32 MOTORS PER LAYER, 6 LAYERS PER PALLET, 192 MAX. PER PALLET.
- SEE PACKAGING MANUAL PAGE 2 FOR PACKAGING PROCEDURE.
- CENTER LABEL, 61196039, ON END OF CARTON.
- CARTON LABELS MUST ALL FACE ONE DIRECTION TOWARD THE OPEN END OF THE PALLET. SEE 88834408.
- NO PACKAGING TAPE OVER CARTON LABEL.
- SEE DRAWING 87856079 SHEET 1 FOR PALLET LAYOUT.

00464072

00464551

Fasco Industries, Inc.  
Motor Division

**FASCO** **RU** **C**

Assembled In Mexico  
No. 71510112 Type U51  
115 V 60 Hz  
3.9-1.7 A 1050 RPM  
Model D176  
Thermally Protected

Connection Diagram  
White — Line  
Black-HI — Line  
Red-LO — Line

61299553

LOCATE NAMEPLATE ON .25 [6.35] FROM FACE OF LEAD END COVER TO READ RIGHT FROM LEAD END OF MOTOR CENTER AT 0°

CUSTOMER:	FASCO DIST.	APPLICATION:	COUNTER SALES	HI-POT TEST 2000 VOLTS MAX. LEAKAGE CURRENT 5mA			
CUSTOMER PN:	D176	MOTOR WEIGHT:	5.90 LBS.				
		ENVIRONMENT:	DRY				
MOTOR TYPE SHADED POLE				REFERENCE SAMPLE			
B	LA	FR	A	S	C	E	B
00	51	11	V	03	DP	6	5
TYPICAL PERFORMANCE AT 115 VOLTS 60 HZ				PH 1 1/10 HP			
IDLE				LOADED			
MOTOR SPEED	RPM	AMP	WATT	IN OZ	RPM	AMP	WATT
HIGH	1177	3.4	210	106	1050	3.7	287
LOW	1173	1.3	79	45	1050	1.5	110

PRODUCTION TEST AT IDLE 115 VOLTS 60 HZ		MOTOR SPEED
AMP	WATT	HIGH
3.74-3.06	231.0-189.0	
1.43-1.17	86.9-71.1	LOW

DRAWING REVISION AA	REVISION BY BAA	DATE 12/06/2017	TOLERANCES UNLESS OTHERWISE SPECIFIED: DEC. INCH mm ANGLE .X ±0.1 [±2.5] 1° .XX ±0.01 [±0.25] .XXX ±0.005 [±0.127] .XXXX ±0.0005 [±0.0127]
ECO-0130286	APPROVED BY KSA	DATE 12/06/2017	REMOVED BURRS & BREAK SHARP EDGES: .0031 [0.0787/381] X 45° CORNER FILLETS: R.02 [51]
ECO DESCRIPTION REDRAWN TO SOLID WORKS. REVISE WARNING LABEL	APPROVED BY KSA	DATE 12/06/2017	MATERIAL
THIRD ANGLE PROJECTION			SIZE [DRAWING NUMBER]
C			71510112

REGAL™ Regal Beloit America, Inc.	DESCRIPTION OUTLINE MOTOR ASSY	PROCESS/FINISH GRAY
DATE 12/06/2017	REFERENCE	SHEET 1 OF 1