

PRODUCT INFORMATION PACKET

FASCO®

Model No: D115
Catalog No: D115
1/12 HP OEM Replacement Motor, 1550 RPM, 115/230 Volts, 4.4" Diameter, TEAO
HVAC/R OEM Replacement Motors



Regal and Fasco are trademarks of Regal Beloit Corporation or one of its affiliated companies.
©2019 Regal Beloit Corporation, All Rights Reserved. MC017097E

REGAL



Nameplate Specifications

Output HP	1/12 Hp	Output KW	0.06 kW
Frequency	60 Hz	Voltage	115/230 V
Current	2.5/1.3 A	Speed	1550 rpm
Service Factor	1	Phase	1
Duty	Air Over	Insulation Class	A
Frame	4.4	Enclosure	Totally Enclosed Air Over
Thermal Protection	Thermally Protected	Ambient Temperature	40 °C
UL	Recognized	CSA	Y
CE	N		

Technical Specifications

Electrical Type	Shaded Pole	Starting Method	Across The Line
Poles	4	Rotation	Counterclockwise Shaft End
Mounting	Extended Studs	Drive End Bearing	Sleeve
Opp Drive End Bearing	Sleeve	Frame Material	Na
Shaft Type	Flat	Overall Length	6.62 in
Shaft Diameter	0.500 in	Shaft Extension	2.00 in

This is an uncontrolled document once printed or downloaded and is subject to change without notice. Date Created:29/10/2019

OPPOSITE LEAD END

LEAD END

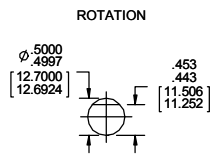
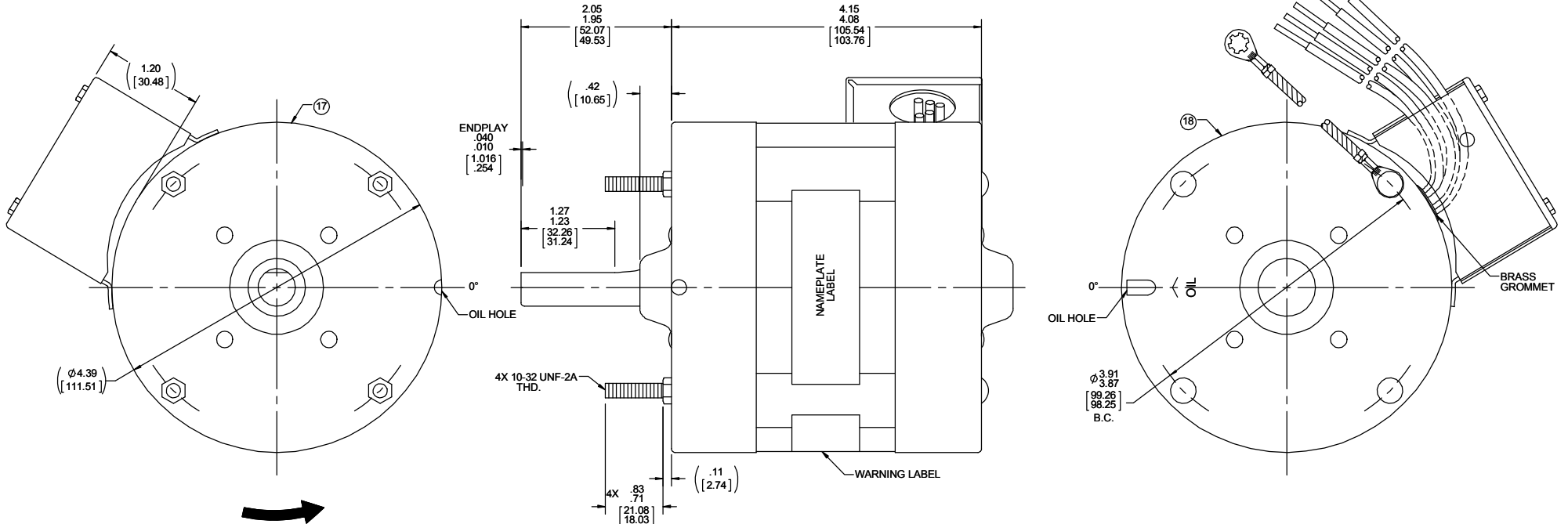

LEAD MATERIAL
 18 GA. 105°C 2/64 INSUL
 THERMO WHITE, BLACK,
 BLUE, RED, AND PURPLE
 28.00/26.00 [711.20/660.40]
 .56/ .44 [14.22/11.18]
 GRN/YEL GROUND LEAD
 7.00/6.00 [177.80/152.40]
 W/ TING TERMINAL
 AMP 350436-2

NOTES:

1. SHAFT IS BONDERIZED.
2. THRU AIR SPACING BETWEEN WIRE AND METAL IS .094 [2.388].
3. TIE BOLT TORQUE TOLERANCE 7-10 IN LBS.
4. ROTOR FREEMESS TO BE WITHIN 1 OZ. IN.
5. FOR WASHER SET-UP, SEE CHART C6000270, DETAIL "H".
6. MAXIMUM 0.1 Ω RESISTANCE BETWEEN GROUND TERMINAL AND MOTOR FRAME.
7. MOTORS MUST START WITH 180 VOLTS APPLIED TO LOWEST SPEED.
8. SEE PACKAGING MANUAL PAGE 2 FOR PACKAGING PROCEDURE.
9. PACK 1 PER CONTAINER, 45 PER LAYER, 6 LAYERS PER PALLET, 270 PER PALLET.
10. SEE DRAWING 87856079 SHEET 1 FOR PALLET LAYOUT.
11. PLACE PAMPHLET, 61224579, IN CONTAINER WITH MOTOR.
12. CENTER CARTON LABEL ON END OF CONTAINER.
13. CARTON LABELS MUST ALL FACE ONE DIRECTION TOWARD THE OPEN END OF THE PALLET, PER 88834408.
14. NO PACKAGING TAPE OVER CARTON LABEL.

61305568

SAFETY WARNING
 This motor must be grounded in accordance with local or national electrical codes to prevent possible injury due to electrical shock

AVERTISSEMENT DE SÉCURITÉ
 Ce moteur doit être fondée sur conformément à la réglementation locale ou national électrique codes pour prévenir d'éventuelles blessures en raison de choc électrique

00464072 00464533

FASCO Fasco Industries, Inc. Motor Division

Assembled in Mexico No. 71085162 TYPE UB TEAO PH 1
 115/230 V 60 Hz 1550 RPM 1/12 HP
 2.5/1.3 A 1550 RPM 1/12 HP
 MODEL D115 Thermally Protected LR8319 MAX AMB: 40°C

Connection Diagram
 115 V 230 V
 Wht—Line Wht—Line
 Pur—Line Not Used
 Blk—Line Blk—Line
 Red—Line Red—Line
 Bk—Line Bk—Line

61299553

CUSTOMER: FASCO DIST.		APPLICATION: MOTOR WEIGHT:		DIST. SALES: 8.67 LBS.		HI-POT TEST 2000 VOLTS MAX LEAKAGE CURRENT 5 mA											
CUSTOMER PN: D115		ENVIRONMENT: DRY															
MOTOR TYPE SHADED POLE						REFERENCE SAMPLE											
B		LA		FR		A		S		C		E		B		A	
00		08		10		T		08		AM		5		7		0	
TYPICAL PERFORMANCE AT 115/230 VOLTS 60 HZ 1 PH 1/12 HP																	
IDLE				LOADED				LOCKED				BREAK					
MOTOR SPEED	RPM	AMP	WATT	IN OZ	RPM	AMP	WATT	IN OZ	AMP	WATT	IN OZ	IN OZ					
115 V	1768	1.84	95	57	1550	2.40	166	20	3.25	198	60						
230 V	1768	.92	95	57	1550	1.20	166	20	1.65	198	60						

PRODUCTION TEST AT IDLE 115/230 VOLTS 60 HZ		MOTOR SPEED	
AMP	WATT	115 V	230 V
2.02 - 1.66	104.5 - 85.5	115 V	
1.01 - .83	104.5 - 85.5	230 V	

DRAWING REVISION AA	REVISION BY SDM	DATE 1/25/2018	TOLERANCES UNLESS OTHERWISE SPECIFIED: DEC. INCH mm ANGLE .X ±0.1 [±0.25] 1° .XX ±0.01 [±0.25] .XXX ±0.005 [±0.127] .XXXX ±0.0005 [±0.0127]	DRAWN BY SDM	DATE 1/25/2018	DESCRIPTION OUTLINE MOTOR ASSY
ECO-0133837	APPROVED BY SED	DATE 1/25/2018	REMOVE BURRS & BREAK SHARP EDGES: .003/.015 [0.076/.381] X 45° CORNER FILLETS: R.02 [51] MACHINED SURFACES: 125/ 3.2/ INCH/ mm SHOWN IN (BRACKETS)	APPROVED BY SED	DATE 1/25/2018	MATERIAL PROCESS/FINISH GRAY
CHANGE WARNING LABEL TO 61305568 <small>COPYRIGHT REGAL BELOIT AMERICA, INC. ALL RIGHTS RESERVED. PROPRIETARY AND CONFIDENTIAL INFORMATION. THIS DOCUMENT IS THE PROPERTY OF REGAL BELOIT AMERICA, INC. OWNER AND CONTAINS OWNERS PROPRIETARY INFORMATION. ANY PERSON, CORPORATION OR OTHER FIRM RECEIVING IT IS DEEMED BY RECEIVING IT, TO AGREE THAT IT, AND/OR ANY PART OF IT, SHALL NOT BE DISCLOSED TO ANY PERSON, CORPORATION OR OTHER ENTITY, DUPLICATED, AND/OR USED, EXCEPT AS EXPRESSLY APPROVED IN WRITING IN ADVANCE BY OWNER. THIS DOCUMENT SHALL BE RETURNED TO OWNER UPON REQUEST. IT MAY BE SUBJECT TO CERTAIN RESTRICTIONS UNDER APPLICABLE EXPORT CONTROL LAWS AND REGULATIONS.</small>			THIRD ANGLE PROJECTION	SIZE C	DRAWING NUMBER 71085162	SHEET 1 OF 1