

Caution : Do this at your own risk

This should take about 30 to 40 min (note taking any more than this can cause the head to dry out)

Please unbox the new unit and have a good look at how it sits in the machine

Please note the tape and the cap protection covers will have to be removed.

If after looking at this information you feel you cant do this then don't.

Tools required..Phillips screwdriver, No. 2

40 cm or longer shaft length (one magnetised is recommended as screws may drop)

Step one..Remove these three panels in this order .

Lift **printer cover** you will see two screws either side connecting the lid to the hinges, remove these.

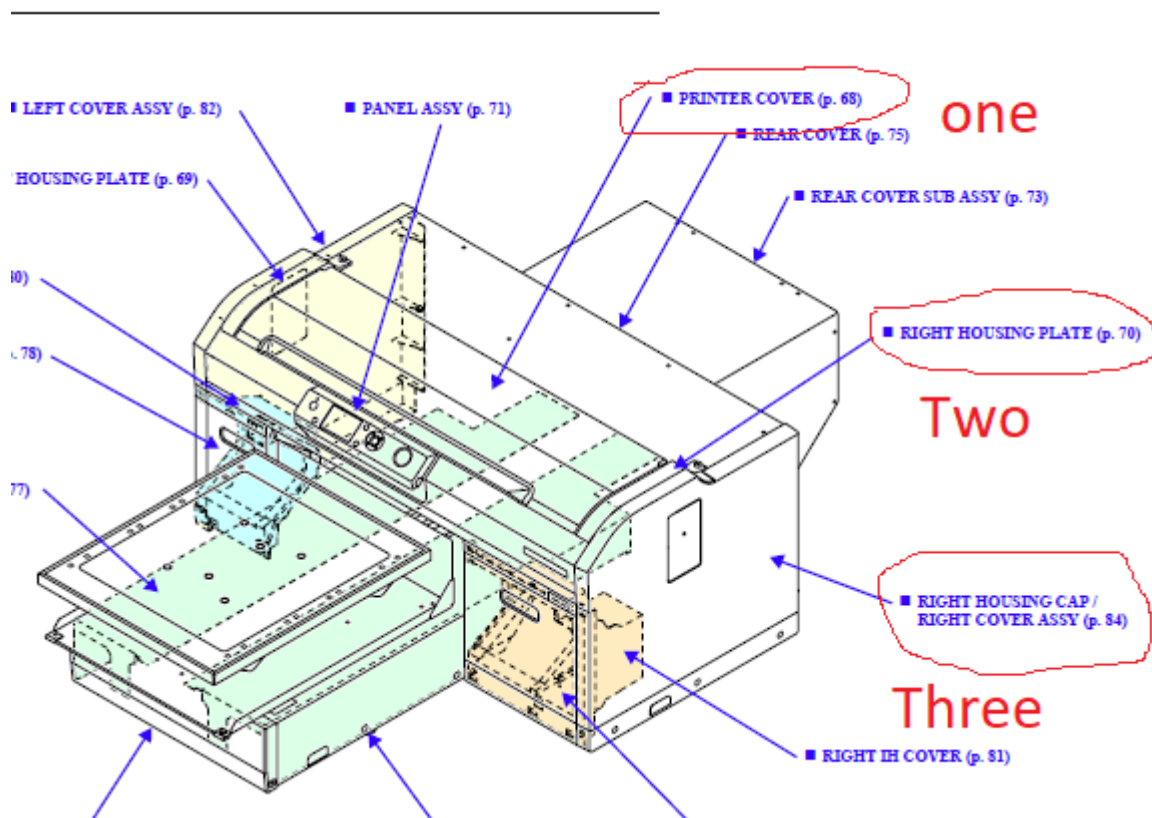

When you lift Step

two.. remove one screw on right housing plate.

Step three.. remove seven screws holding the right cover assy.. it needs a little wriggle to pull it out to the right.

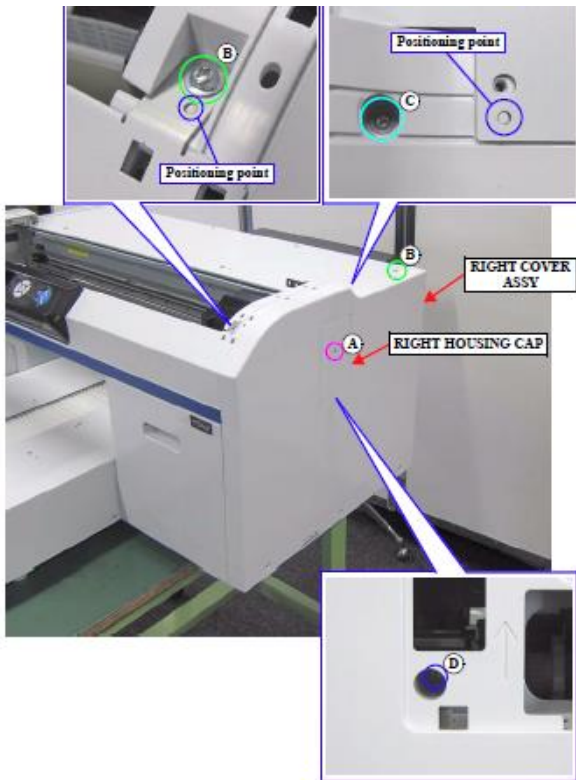

Figure 3-31. Removing the RIGHT HOUSING CAP / RIGHT COVER ASSY

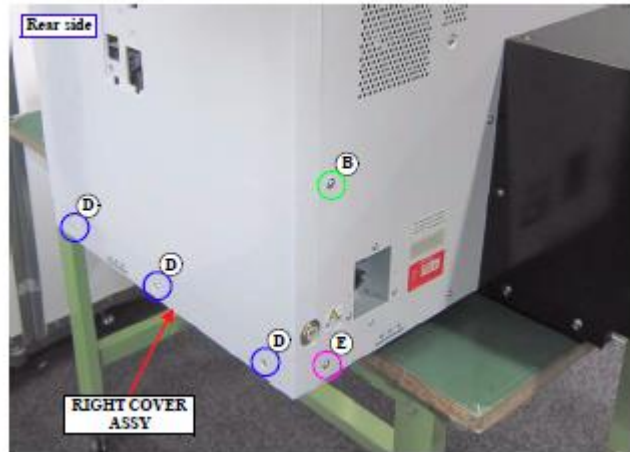
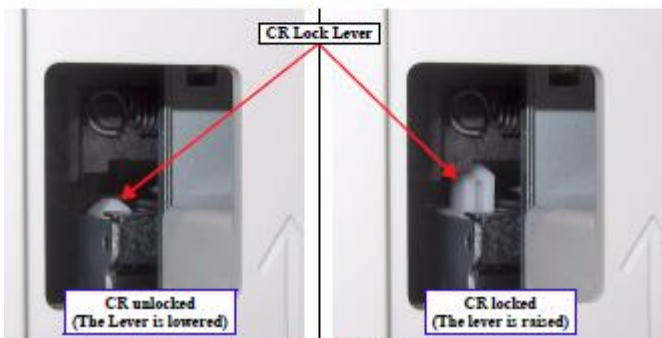

Figure 3-32. Removing the RIGHT COVER ASSY

This is very important step...You need to free the print head from its home position ..



Figure 3-9. Unlocking the CR UNIT



Rotate the gear shown in the figure in the direction of the arrow to unlock the CR Unit (about 10 rounds). This will free the head caridge so gently shift the print head to the left.. do not force if tight , look to see if the lever is down.

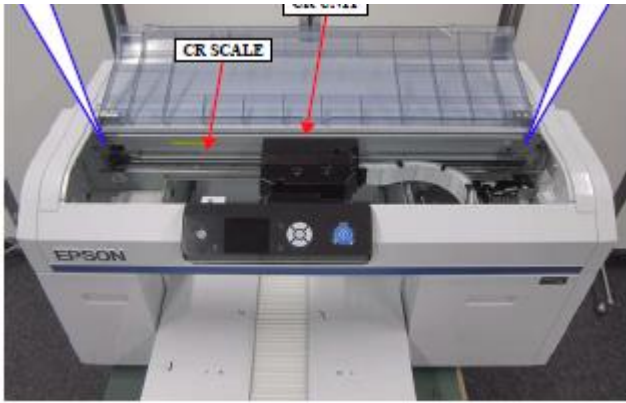

Now the easy part!

Remove Screw one A Then remove this panel

Remove the screw, and remove the Maintenance Cover.

- A) Silver M3x6 Cup S-tite screw: 1 pcs

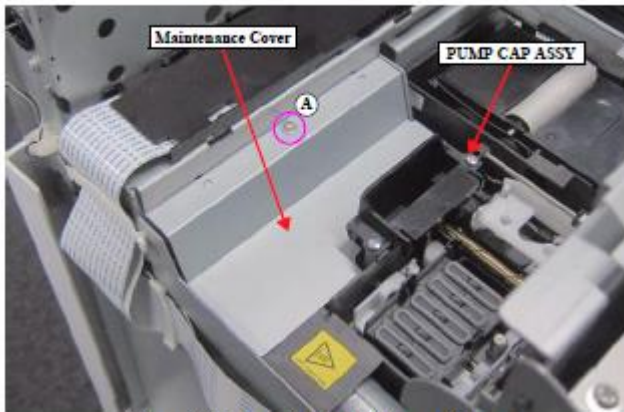
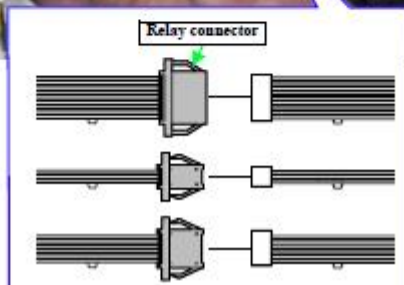
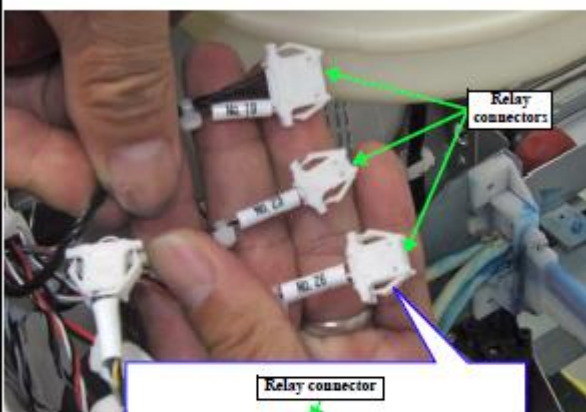

Figure 3-85. Removing the Maintenance Cover

Disconnect wires Undo the clamp in the green circle

- Leave the relay connectors at the main body side to reuse them.
- Confirm the relay connectors to disconnect the cables.



- 8. Pull the cables in the hole on the frame.

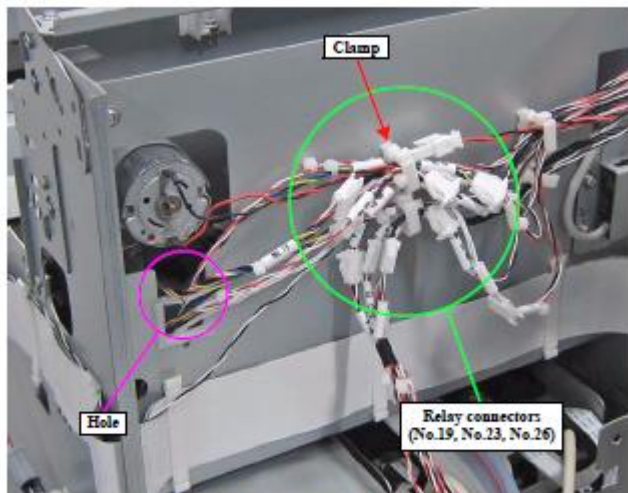

Figure 3-86. Removing the relay connector

9. Remove the Waste Ink Tube from the DUCT TUBE ASSY.

10. Pull the Waste Ink Tube in the hole on the frame.

11. Remove the two screws that secure the PUMP CAP ASSY. Circled in green below

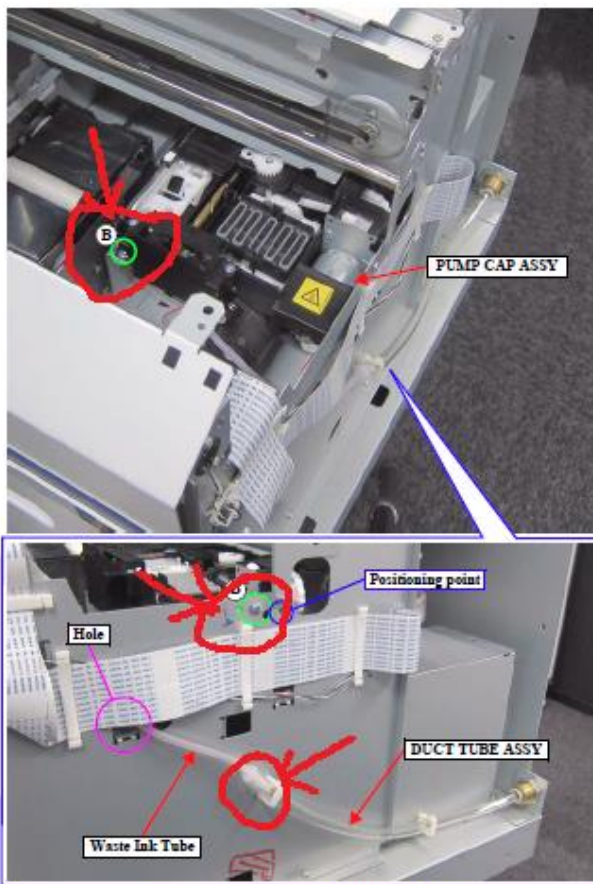

Figure 3-87. Removing the PUMP CAP ASSY

The tank will wriggle out if you lift the front first then gently pull the cables out with the unit.

Put the new one in the same way you removed the old one.

You just need to reassemble the machine and turn on machine to return the carriage assy to its home position.

12. Release the cables of the relay connectors (No.23, No.26) from the clamp, and remove the PUMP CAP ASSY.

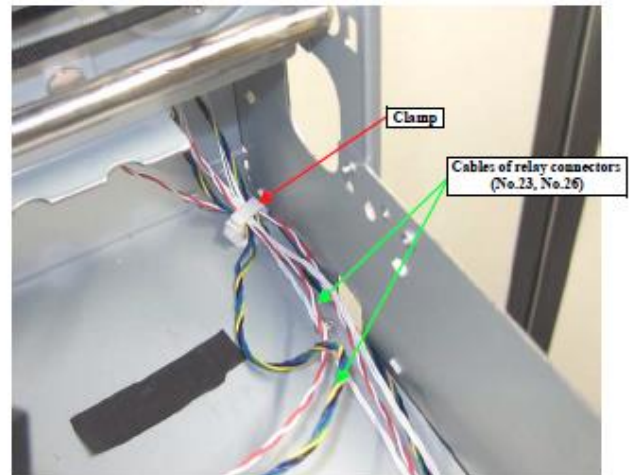

Figure 3-88. Releasing the cables