

10 : 00

estimated
assembly time



1 or more

people required

Ok, let's
get started!



- Put on mood music!
- To prevent damage to product, use the clean side of package carton or rug as working surface for assembly.
- In the event of missing or damaged parts, delivery problems etc., please reach out to our team. We will be happy to fix the problem!

care guide

- Clean regularly with a soft and dry cloth.
- To protect finish, avoid use of abrasive cleaners.
- Wipe up spills immediately. Please!



product
parts

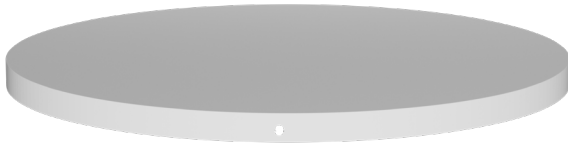

(A)
Tabletop
x1

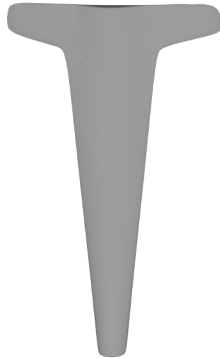

(B)
Legs
x3

what's included



(C)- Bolt
x3

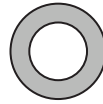

(D)- Washer
x3



(E)- Wrench
x1

assembly instructions

Friendly Tip: Take a deep breath going in. This may be a tricky part, but nothing too overwhelming. Just follow these steps to the T and the outcome will be worth it!



- ⓘ While assembling the product, tighten the bolts up to 50%. Once all parts are in place, only then fully tighten the bolts.

step 1:

Place tabletop (A) upside down. Taking the image as reference, align table legs (B) to the holes on tabletop (A). Start securing each table leg (B) using washer (D) and bolt (C).

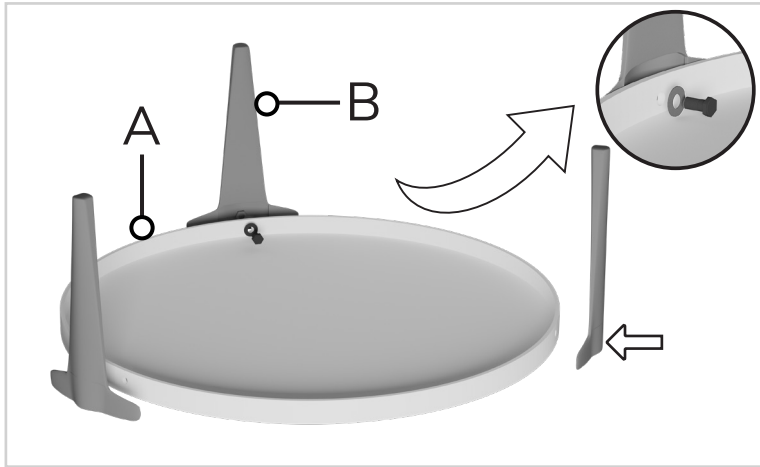

step 2:

Tighten all points using wrench (E).

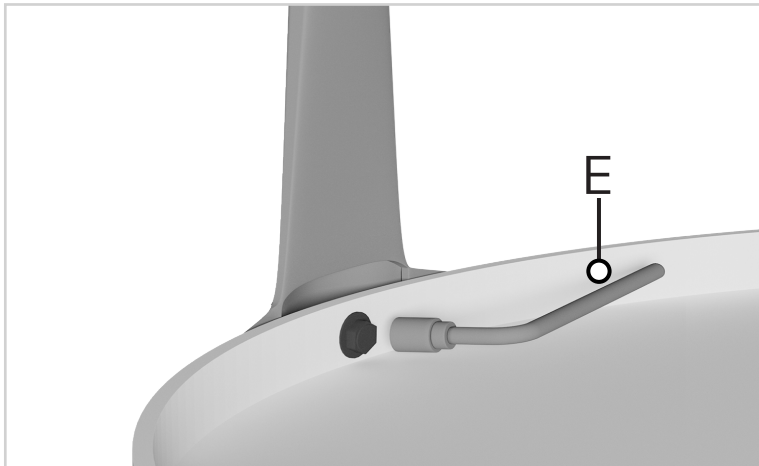

Voila! Your table is now assembled and secure!

you've
got
a home
with us

