

Quick start and installation instructions for SwitchBot Keypad

It takes about 10 minutes to install the SwitchBot Keypad.

We can use the Screw Kit (Two 3.5 x 25 mm [#6 x 1"] screws, two expansion bolts) to install the Keypad to the wall, or use the alignment sticker to attach the Keypad to the wall.

Before installing the Keypad to the wall, we can find a favorable position and hold the Keypad to the wall with our hand. Then try to unlock the SwitchBot Lock via the Keypad. If the SwitchBot Lock can be unlocked by the Keypad successfully, then this position is acceptable for the Keypad. After all these confirmations, we can either drill the hole or attach the sticker to install the Keypad.

Please refer to the guidance in the manual.

Getting Started

1. Remove the battery cover and install the batteries. Make sure the batteries are installed in the right direction. Then put the cover back on.
2. Open our app, register an account and sign in.
3. Tap "+" at the top right of the Home page, find the Keypad icon and select, then follow the instructions to add your Keypad.

Installation

Method 1: Install with Screws

Before installation you will need:



Electric Drill



Rubber Hammer



Pencil



Screwdriver

Step 1: Confirm Installation Position

Tips: To avoid repeatedly changing positions after installation and causing damage to your wall, we suggest that you add Keypad on our app first to see whether you can control the Lock via Keypad at the chosen position. Make sure your Keypad is installed within 5 meters (16.4 ft) from your Lock.

Add Keypad following the instructions on the app. After adding successfully, find a suitable position on the wall, attach SwitchBot Keypad to the chosen position with your hands, then check if you can lock and unlock SwitchBot Lock smoothly when using Keypad.

If everything works correctly, place the alignment sticker to the position chosen and mark holes for screws using a pencil.

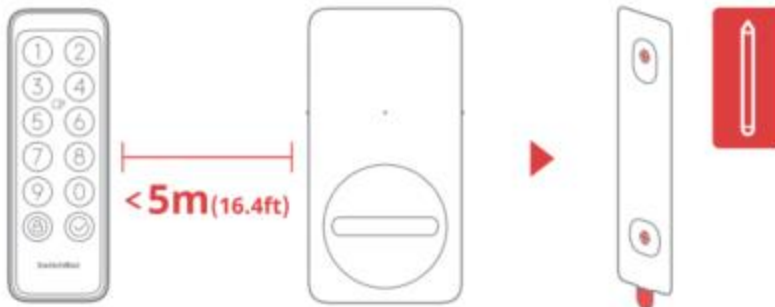

Step 2: Determine Drill Bit Size and Drill Holes

Tips: For outdoor usage, we recommend that you install with screws to prevent SwitchBot Keypad being moved without your permission. Concrete or other hard surfaces can be challenging for drilling. If you are not experienced with drilling into a particular type of wall, you may want to consider consulting a professional.

Prepare a suitably sized electric drill bit before drilling.

① When installing on more rugged surfaces like concrete or brick:

Use an electric drill with the 6 mm (15/64") sized drill bit to drill holes at the marked positions, then use the rubber hammer to hammer the expansion bolts into the wall.

② When installing on surfaces like wood or plaster:

Use an electric drill with the 2.8 mm (7/64") sized drill bit to drill holes at the marked positions.

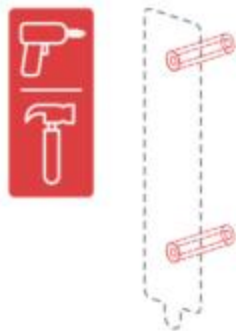

Step 3: Attach Mounting Plate to the Wall

Tips: If the wall surface is uneven, you may need to place two rubber rings at the two screw holes at the bottom of the mounting plate.

Affix mounting plate to the wall using screws. Make sure the mounting plate is firmly attached, there should be no excess movement when you press either side.

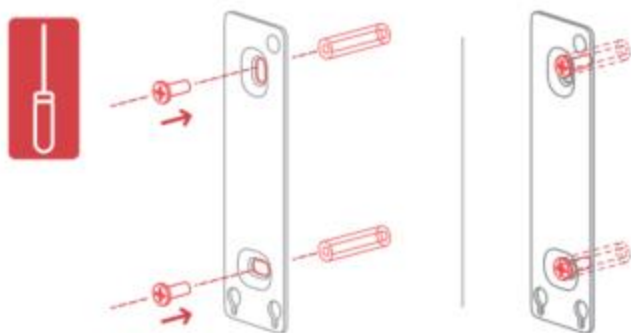

Step 4: Attach Keypad to Mounting Plate

Align the two metal round buttons at the back of Keypad with the two round locating holes at the bottom of mounting plate. Then slide Keypad downwards along the mounting plate until it can not go any further. Press the Keypad from different angles using your hands to make sure it is stable.

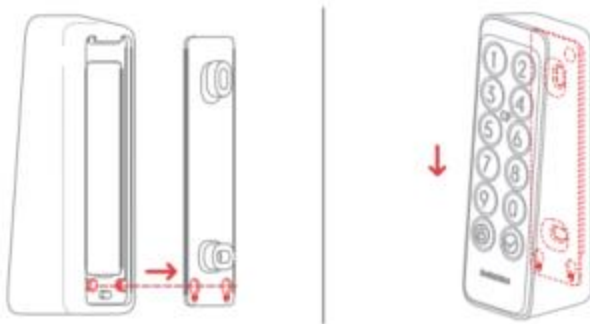

Method 2: Install with Adhesive Tape

Step 1: Confirm Installation Position

Tips:

① To avoid repeatedly changing positions after installation and causing damage to your wall, we suggest that you add Keypad on our app first to see whether you can control the Lock via Keypad at the chosen position. Make sure your Keypad is installed within 5 meters (16.4 ft) from your Lock.

② 3M adhesive tape can only attach firmly to smooth surfaces like glass, ceramic tile and smooth door surface. Please clean the installation surface first before installation. (We recommend you install with screws to prevent your Keypad being removed.)

Add your Keypad following the instructions on our app. After adding successfully, find a suitable position on the wall, attach your Keypad to the position with your hands, then check if you can lock and unlock SwitchBot Lock smoothly using Keypad. If so, use pencil to mark the position.



Step 2: Attach Mounting Plate to the Wall

Tips: Make sure the installation surface is smooth and clean. Make sure the temperature of the adhesive tape and installation surface is higher than 0°C, otherwise the tape used may loosen.

Attach adhesive tape to the back of mounting plate, then stick the mounting plate to the wall at the marked position. Press the mounting plate against the wall for 2 minutes to ensure it is firm.

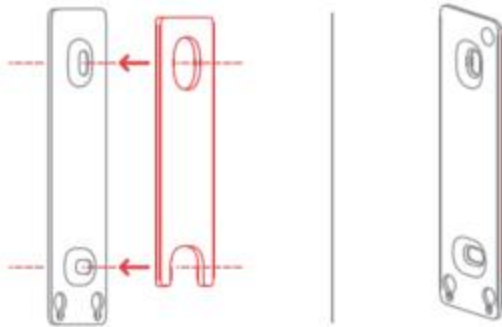

Step 3: Attach Keypad to Mounting Plate

Tips: Make sure the mounting plate has been firmly attached to the wall before continuing.

Align the two metal round buttons at the back of Keypad with the two round locating holes at the bottom of mounting plate. Then slide Keypad downwards along the mounting plate until it can not go any further. Press the Keypad from different angles using your hands to make sure it is stable.

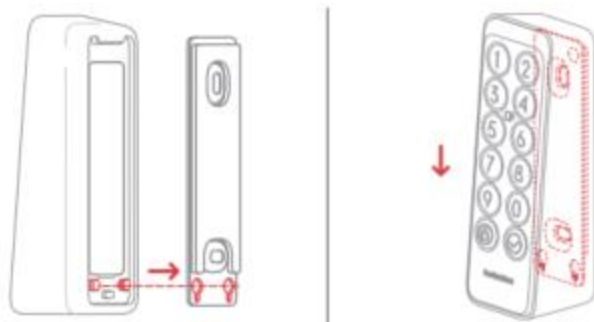

How many digits can the SwitchBot Keypad set to its passcode?

The SwitchBot Keypad can set a password of at least 6 digits and at most 12 digits.

Can I use an NFC card from other brands to work with SwitchBot Keypad?

Currently, only the SwitchBot NFC Card that comes with the Keypad can work with it. An NFC card from other brands does not support SwitchBot Keypad.

Can the Keyboard be installed outdoors?

SwitchBot Keypad can be installed outdoors. It has a waterproof level up to IP65.

Here is the information on the working environment for the SwitchBot Keypad.

Working Temperature: -25 °C~ 66 °C

Working Humidity: RH10%~90% (non-condensing)

How long can the Keypad's battery last?

How long can we use the SwitchBot Keypad before changing the battery? This depends on how many times and how frequently we operate the Keypad.

Here are some situations for our reference.

If one person uses the Keypad, it can satisfy for 3 years of use with 3-time of unlocking per day.

If three people use the Keypad, it can satisfy for 2 years of use with 3-time of unlocking per person per day.

What is the battery type for the SwitchBot Keypad and what is its capacity?

To maintain normal operation, the SwitchBot Keypad requires **2** pieces of **CR123A** batteries. Each CR123A battery has **1500mAh** capacity.

Please refer to the article below to see how to replace the battery correctly.

What does the triangle plastic thing do in the box?

This is a triangle-shaped opener that comes with the SwitchBot Keypad.



triangle opener

It is mainly used to open the cover of the Keypad on the back when there is a need to replace the battery.



Please do not lose this opener. Otherwise, we might not be able to replace the battery smoothly when needed.