

# SONOFF

## RM433R2

User manual V1.0

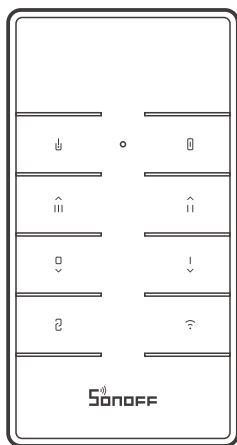

## 433MHz Remote Controller

· 中文-----	1-3	· English-----	4-6
· Deutsch-----	7-9	· Español-----	10-12
· Français-----	13-15	· Italiano-----	16-18
· Русский язык-----	19-21	· Português-----	22-24
· FCC Warning-----	25		

## 取出电池绝缘片

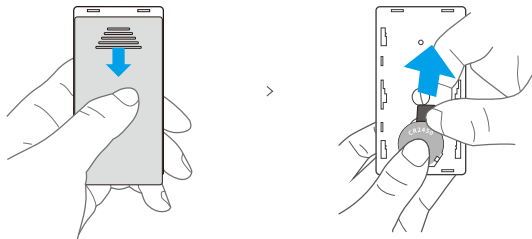

⚠ 设备分带电池和不带电池版本。

## 产品参数

型号	RM433R2
发射频率	433MHz
遥控器尺寸	87x45x12mm
遥控器底座尺寸	86x86x15mm(可选)
供电	3V纽扣电池 x 1 (电池型号:CR2450)
外壳材料	PC V0

## 产品介绍

本设备适用于带433MHz遥控功能的SONOFF产品，以及支持433MHz通讯协议的其它设备。

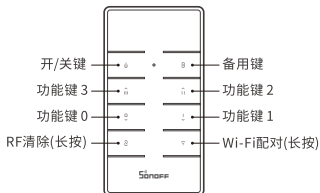

⚠ 与不同的设备配对使用时，每个按键对应的功能不同。

## 按键定义示例

### 1. 以 iFan04 风扇灯控制器为例：

按键	功能
⏻	灯开/关灯
🔇	静音
🛑	关闭风扇
⏴	一档风速
⏵	二档风速
⏶	三档风速
🔗	长按5秒至风扇灯蜂鸣器“滴滴”两声,即可清码。 清码后,如需再次使用RF,请在重新上电后5秒内按任意按键至风扇灯蜂鸣器“滴”一声,即可配对成功。
📶	长按5秒直到风扇灯蜂鸣器呈两短一长响声,设备进入快速配网模式(Touch),可在app端进行添加设备。在配网模式下,短按任意按键可退出当前模式。

### 2. 以D1调光器为例：

按键	功能
⏻	开
🔇	关
🛑	短按为一级亮度,长按为减弱亮度
⏴	短按为二级亮度,长按为减弱亮度
⏵	短按为三级亮度,长按为增强亮度
⏶	短按为四级亮度,长按为增强亮度
🔗	长按5秒直到设备蜂鸣器发出“滴滴”两声,再松开,约5秒后清码成功。清码后,如需再次使用遥控器,请在重新上电后5秒内短按任意按键,设备蜂鸣器发出“滴”一声,即可配对成功。
📶	长按5秒直到设备灯呈现呼吸状态,设备进入快速配网模式。可在app端进行添加设备。在配网模式下,短按任意按键可退出当前模式。

## 适配 SONOFF 设备

- RFR2
- BASICRFR3
- 4CHPROR3
- SlampherR2
- RF BridgeR2
- D1调光器
- TX系列墙壁开关
- iFan04 风扇灯控制器

## RM433R2底座

安装方法1：可直接用3M胶贴在遥控器底座背面两边安装。

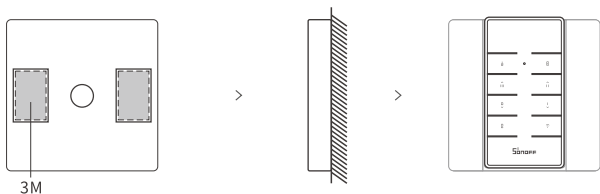

安装方法2：拆开取下底座两边的盖子，用螺丝安装底座。

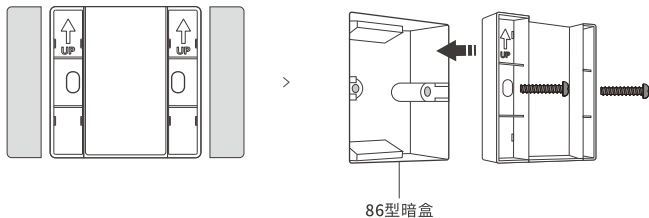

⚠ 本产品不提供底座，请单独购买。

## Pull out the battery insulation sheet

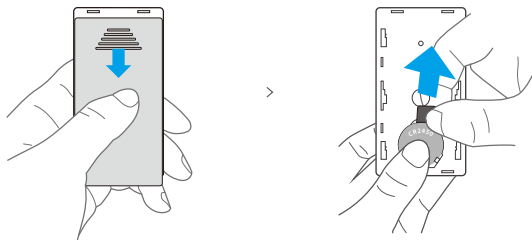

ⓘ The device has the version with battery and without battery.

## Specifications

Model	RM433R2
RF	433MHz
Remote controller size	87x45x12mm
Remote controller base size	86x86x15mm (not included)
Power supply	3V button cell x 1 (Battery model: CR2450)
Material	PC V0

## Product Introduction



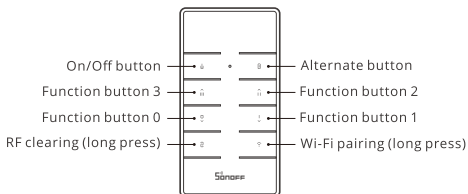





The RM433R2 applies to all SONOFF products with 433MHz frequency and other devices supporting the 433MHz communication protocol.











ⓘ Buttons are created with different functions when pairing with different products.

## Buttons Instructions

### Example 1: iFan04 Wi-Fi Fan & Light Controller

Buttons	Functions
	On/Off (light)
	Mute
	Off (fan)
	Low speed
	Medium speed
	High speed
	Long press for 5s until the ceiling fan makes two sounds "Beep Beep" to clear the code. After clearing code is completed, if you need to use the product, please press any button within 5s after powering on again until the ceiling fan makes a sound "Beep", and pairing is successful.
	Long press for 5s until the fan makes two short and one long "Beep" sound to enter the quick pairing mode (Touch). Then you can add the device on eWeLink APP. In quick pairing mode, you can short press any button on the remote controller to exit this mode.

### Example 2: D1 Wi-Fi smart dimmer

Buttons	Functions
	On
	Off
	Short press for the low brightness, long press to turn down the brightness
	Short press for the medium brightness, long press to turn down the brightness
	Short press for the higher brightness, long press to turn up the brightness
	Short press for the high brightness, long press to turn up the brightness
	Long press for 5s until you hear "Beep Beep" and release, then the remote controller is cleared successfully. After clearing code is completed, if you need to use, short press any button within 5s after powering on again and you will hear "Beep", which indicates the remote controller is paired successfully.
	Long press for 5s until the connected light enters the breathing mode, which indicates the device enters quick pairing mode (Touch), then you can add the light on eWeLink APP. In quick pairing mode, you can short press any button on the remote controller to exit this mode.

## Works with SONOFF devices

- RFR2
- BASICRFR3
- 4CHPROR3
- SlampherR2
- RF BridgeR2
- D1 Wi-Fi smart dimmer
- TX series Wi-Fi smart switches
- iFan04 Wi-Fi Fan & Light Controller

## RM433R2-BASE

### Installation method 1:

Install the base on the wall with 3M adhesive tapes.

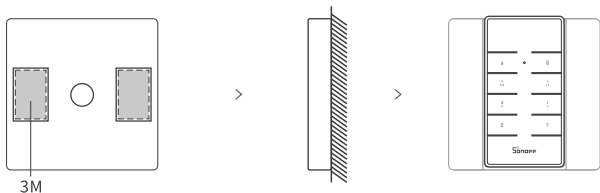

### Installation method 2:

Remove the two upper covers from both sides of the base to install with screws.

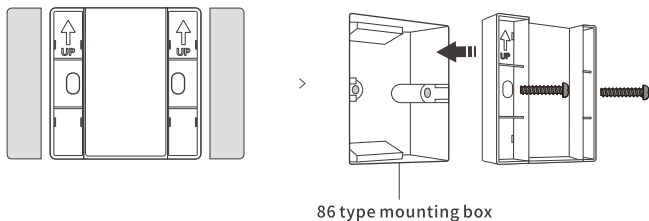

⚠ The base is not included into the package, please purchase it separately.

## Ziehen Sie die Batterieisolierungsfolie heraus

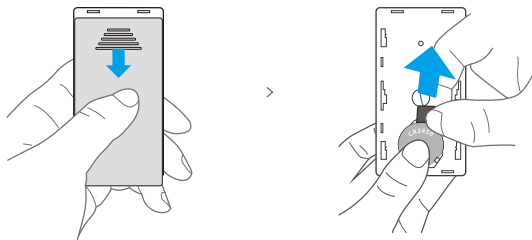

⚠ Das Gerät ist in der Version mit Batterie und ohne Batterie verfügbar.

## Technische Daten

Modell	RM433R2
HF	433MHz
Abmessungen der Fernbedienung	87x45x12mm
Abmessungen der Basis	86x86x15mm (nicht enthalten)
Spannungsversorgung	3V-Tastenzelle x 1 ( Batterie-Modell: CR2450)
Materialien	PC V0

## Produktvorstellung

Der RM433R2 ist für alle SONOFF-Geräte mit 433 MHz Frequenz und andere Geräte gedacht, die das 433 MHz-Kommunikationsprotokoll unterstützen.

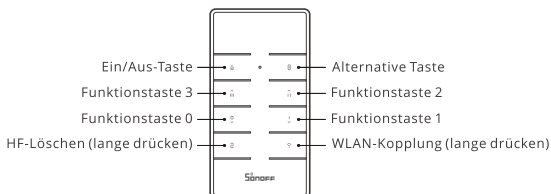









⚠ Die Tasten erhalten bei der Kopplung mit unterschiedlichen Produkten unterschiedliche Funktionen.











# Anleitung für Tasten

## Beispiel 1: iFan04 Wifi-Deckenventilator & Lichtsteuerung

Tasten	Funktionen
	Ein/Aus (Licht)
	Stummschaltung
	Aus (Ventilator)
	Niedrige Geschwindigkeit
	Mittlere Geschwindigkeit
	Hohe Geschwindigkeit
	5 Sekunden lang drücken, bis der Deckenventilator zwei Töne „di di“ abgibt, dann ist der Code erfolgreich gelöscht. Nachdem der Code vollständig gelöscht wurde, drücken Sie bitte innerhalb von 5 Sekunden nach dem Wiedereinschalten eine beliebige Taste, bis der Deckenventilator einen Ton „di“ abgibt, dann ist die Kopplung erfolgreich ausgeführt.
	5 Sekunden lang drücken, bis der Deckenventilator zwei kurze und einen langen "Piep" - Ton abgibt. Das Gerät wechselt in den Schnellkopplungsmodus(Touch). dann können Sie das Licht auf eWeLink APP hinzufügen. Im Schnellkopplungsmodus können Sie eine beliebige Taste auf der Fernbedienung kurz drücken, um diesen Modus zu verlassen.

## Beispiel 2: D1 intelligenter WLAN-Dimmer

Tasten	Funktionen
	Ein
	Aus
	Kurz drücken für die niedrige Helligkeit, lange drücken, um die Helligkeit zu senken.
	Kurz drücken für die mittlere Helligkeit, lange drücken, um die Helligkeit zu senken
	Kurz drücken für die höhere Helligkeit, lange drücken, um die Helligkeit zu erhöhen.
	Kurz drücken für die hohe Helligkeit, lange drücken, um die Helligkeit zu erhöhen.
	Halten Sie 5 Sekunden lang gedrückt, bis Sie „Bi Bi“ hören und lassen Sie es los, dann wird die Fernbedienung erfolgreich entfernt. Wenn Sie eine beliebige Taste innerhalb von 5 Sekunden nach dem Wiedereinschalten kurz drücken müssen, hören Sie „Bi“, das zeigt, dass die Fernbedienung erfolgreich gekoppelt ist.
	Drücken Sie 5 Sekunden lang, bis das angeschlossene Licht in den Atemmodus wechselt, dies zeigt an, dass das Gerät in den Schnellkopplungsmodus wechselt (Touch), dann können Sie das Licht auf eWeLink APP hinzufügen. Im Schnellkopplungsmodus können Sie eine beliebige Taste auf der Fernbedienung kurz drücken, um diesen Modus zu verlassen.

## Funktioniert mit SONOFF-Geräten

- RFR2
- BASICRFR3
- 4CHPROR3
- SlampherR2
- RF BridgeR2
- D1 intelligenter WLAN-Dimmer
- Intelligente WLAN-Schalter der TX-Serie
- iFan04 Wifi-Deckenventilator & Lichtsteuerung

## RM433R2-BASE

### Installations methoden 1:

Montieren Sie die Basis an der Wand mit 3M-Klebebändern.

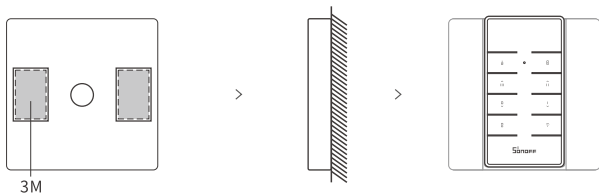

### Installations methoden 2:

Entfernen Sie die beiden oberen Abdeckungen von beiden Seiten der Basis, um sie mit Schrauben zu befestigen.

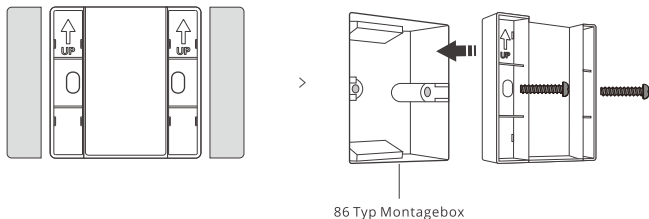

ⓘ Die Basis ist nicht im Lieferumfang enthalten, bitte separat erwerben.

## Retire la lámina de aislamiento de la batería

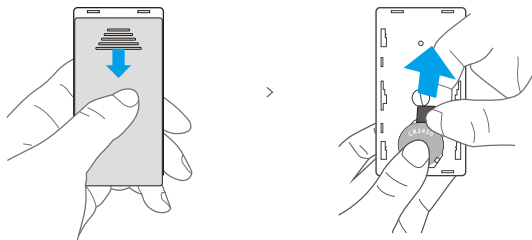

⚠ El dispositivo viene en el diseño con batería y sin batería.

## Especificaciones

Modelo	RM433R2
RF	433MHz
Tamaño del control remoto	87x45x12mm
Tamaño de la base	86x86x15mm (no incluida)
Fuente de alimentación	1 baterías de botón de 3 V (Modelo de la batería: CR2450)
Materiale	PC V0

## Introducción al producto



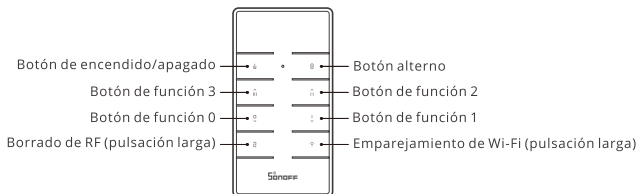





El RM433R2 se utiliza con todos los productos SONOFF con 433 MHz de frecuencia y otros dispositivos que admitan el protocolo de comunicación de 433 MHz.











⚠ Los botones reciben distintas funciones al emparejarlos con productos distintos.

## Instrucciones de los botones

### Ejemplo 1: Controlador Wi-Fi de ventilador y luces iFan04

Botones	Funciones
	Encendido/apagado (luz)
	Silencio
	Apagar (ventilador)
	Velocidad baja
	Velocidad media
	Velocidad alta
	Mantenga pulsado durante 5 segundos hasta que el ventilador emita dos pitidos para borrar el código correctamente Después de borrar el código, si necesita utilizar, pulse cualquier botón en un plazo de 5 s después de volver a encenderlo, hasta que el ventilador de techo emita un pitido y el emparejamiento se haya realizado correctamente.
	Mantenga pulsado durante 5 segundos hasta que el ventilador emita dos pitidos cortos y uno largo acceder al modo de emparejamiento rápido (Touch). Luego puede agregar la luz a la aplicación eWelink. En el modo de emparejamiento rápido, puede pulsar brevemente cualquier botón del controlador remoto para salir de ese modo.

### Ejemplo 2: Atenuador inteligente Wi-Fi D1

Botones	Funciones
	Encendido
	Apagado
	Pulsación corta para baja intensidad, pulsación larga para reducirla
	Pulsación corta para intensidad media, pulsación larga para reducirla
	Pulsación corta para intensidad alta, pulsación larga para aumentarla
	Pulsación corta para intensidad alta, pulsación larga para aumentarla
	Presione de manera sostenida durante 5 segundos hasta que escuche "Bi Bi" y suelte; entonces el controlador remoto se ha limpiado exitosamente. Si lo necesita usar, pulse brevemente cualquier botón dentro de los 5 segundos luego de encenderlo nuevamente hasta que escuche "Bi", lo que indica que el controlador remoto está emparejado correctamente.
	Presione de manera sostenida durante 5 segundos hasta que la luz conectada entre en "modo respiración", lo que indica que el dispositivo entró en modo de apareamiento rápido (Touch); luego puede agregar la luz a la aplicación eWelink. En el modo de emparejamiento rápido, puede pulsar brevemente cualquier botón del controlador remoto para salir de ese modo.

## Funciona con los dispositivos SONOFF

- RFR2
- BASICRFR3
- 4CHPROR3
- SlampherR2
- RF BridgeR2
- Atenuador inteligente Wi-Fi D1
- Interruptores inteligentes Wi-Fi de la serie TX
- Controlador Wi-Fi de ventilador y luces iFan04

### RM433R2-BASE

#### Métodos de instalación 1:

Instale la base en la pared con las cintas adhesivas 3M.

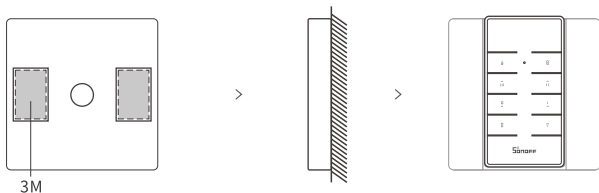

#### Métodos de instalación 2:

Quite las dos tapas superiores de ambos lados de la base para realizar la instalación con tornillos.

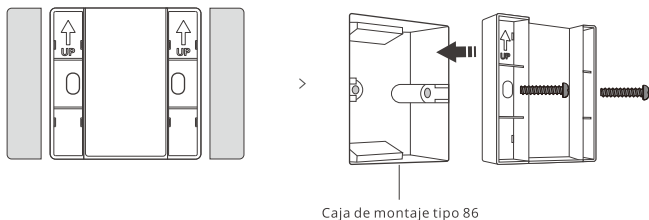

ⓘ La base no está incluida en el paquete y se debe adquirir por separado.

## Retirez la feuille d'isolation de la batterie

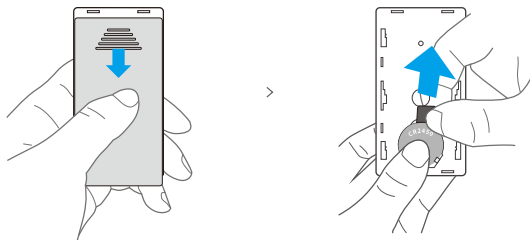

ⓘ Cet appareil existe en deux versions, à savoir avec batterie et sans batterie.

## Spécifications

Modèle	RM433R2
FR	433MHz
Dimensions de la télécommande	87x45x12mm
Dimensions de la base	86x86x15mm (non incluse)
Alimentation	1 piles bouton de 3 V (Modèle de batterie: CR2450)
Matériau	PC V0

## Présentation du produit



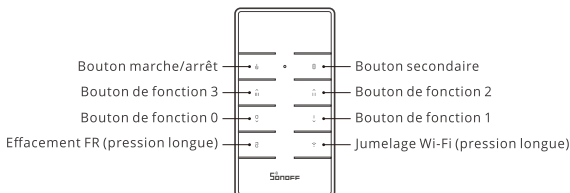





La RM433R2 s'applique à tous les produits SONOFF utilisant la fréquence de 433 MHz ainsi qu'aux autres appareils supportant le protocole de communications 433 MHz.











ⓘ Les boutons sont créés avec différentes fonctions lors du jumelage avec différents produits.

## Instructions des boutons

### Exemple 1 : commande de ventilateur et d' éclairage de plafond Wi-Fi iFan04

Boutons	Fonctions
	Marche/arrêt (éclairage)
	Silence
	Arrêt (ventilateur)
	Basse vitesse
	Vitesse moyenne
	Grande vitesse
	Pression longue de 5 s pour jusqu'à ce que le ventilateur de plafond émette deux sons « di di » pour effacer le code. Une fois l'effacement du code fait, si vous devez utiliser, veuillez appuyer sur l'un des boutons dans les 5 s après avoir rallumé le ventilateur de plafond jusqu'à ce qu'il émette un son « di » et réussisse son jumelage.
	Pression longue de 5 s pour jusqu'à ce que le ventilateur émette deux bips courts et un bip long pour passer au mode de jumelage rapide (Touch). Puis vous pouvez ajouter la lumière sur l'application eWeLink. En mode d'appairage rapide, vous pouvez appuyer brièvement sur n'importe quelle touche de la télécommande pour quitter ce mode.

### Exemple 2 : variateur Wi-Fi intelligent D1

Boutons	Fonctions
	Marche
	Arrêt
	Pression courte pour la faible luminosité, pression longue pour réduire la luminosité
	Pression courte pour la luminosité moyenne, pression longue pour réduire la luminosité
	Pression courte pour la luminosité maximale, pression longue pour augmenter la luminosité
	Pression courte pour la luminosité forte, pression longue pour augmenter la luminosité
	Appuyez longuement pendant 5 secondes jusqu'à ce que vous entendiez « Bi Bi » et relâchez, puis la télécommande est effacée avec succès. Si vous avez besoin d'utiliser la télécommande, appuyez brièvement sur n'importe quelle touche dans les 5 secondes qui suivent la remise sous tension et vous entendrez « Bi », qui indique que la télécommande est appairée avec succès.
	Appuyez longuement pendant 5 secondes jusqu'à ce que la lumière connectée entre en mode respiration, ce qui indique que l'appareil entre en mode d'appairage rapide (Touch), puis vous pouvez ajouter la lumière sur l'application eWeLink. En mode d'appairage rapide, vous pouvez appuyer brièvement sur n'importe quelle touche de la télécommande pour quitter ce mode.

## Fonctionne avec les appareils SONOFF

- RFR2
- BASICRFR3
- 4CHPROR3
- SlampherR2
- RF BridgeR2
- Variateur Wi-Fi intelligent D1
- Commutateurs intelligents Wi-Fi gamme TX
- Commande de ventilateur et d'éclairage de plafond Wi-Fi iFan04

### RM433R2-BASE

#### Méthodes d'installation 1:

Installez la base sur le mur avec des bandes adhésives 3M.

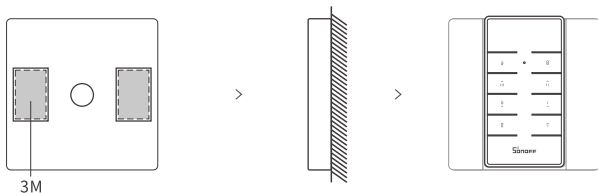

#### Méthodes d'installation 2:

Retirez les deux couvercles supérieurs des deux côtés de la base pour l'installer avec des vis.

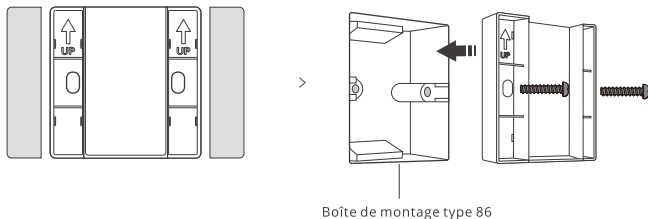

ⓘ La base n'est pas incluse dans l'emballage, veuillez l'acheter séparément.



## Rimuovere il foglio di isolamento della batteria

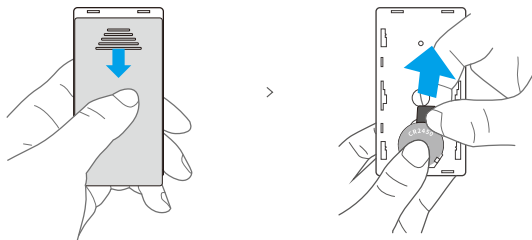

⚠ Il dispositivo possiede la versione con batteria e senza batteria.

## Specifiche

Modello	RM433R2
RF	433MHz
Dimensione telecomando	87x45x12 mm
Dimensione della base	86x86x15 mm (non inclusa)
Alimentazione	1 batterie a bottone da 3V(Codice batteria: CR2450)
Materiale	PC V0

## Introduzione al prodotto



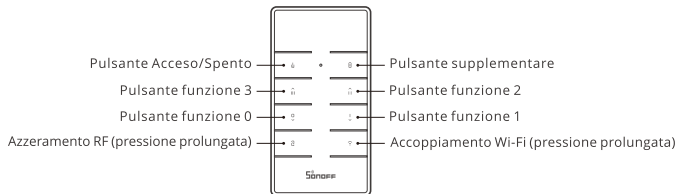





L'RM433R2 è applicabile a tutti i prodotti SONOFF aventi una frequenza di 433 MHz e ad altri dispositivi che supportano il protocollo di comunicazione 433 MHz.











⚠ I pulsanti sono definiti in base alle diverse funzioni quando si accoppiano con prodotti differenti.

# Istruzioni relative ai pulsanti

## Esempio 1: Controller ventilatore e luce da soffitto Wi-Fi iFan04

Pulsanti	Funzioni
	Acceso/Spento (luce)
	Silenzia
	Spento (ventilatore)
	Bassa velocità
	Velocità media
	Alta velocità
	Premere in maniera prolungata per almeno 5 secondi fino a quando il ventilatore a soffitto emette due suoni "bip bip" per azzerare il codice correttamente. Dopo che l'attivazione del codice di azzeramento è completata, premere nuovamente qualsiasi pulsante entro 5 secondi dall'accensione fino a quando la ventola a soffitto emette un "bip" se si desidera utilizzare e l'accoppiamento è avvenuto correttamente.
	Premere in maniera prolungata per almeno 5 secondi fino a quando il ventilatore emette due suoni brevi e uno lungo, il dispositivo entra in modalità di accoppiamento rapido (Touch). A questo punto è possibile aggiungere la luce sull'APP eWeLink. Premere brevemente un pulsante qualsiasi del telecomando per uscire dalla modalità di accoppiamento rapido.

## Esempio 2: Dimmer smart Wi-Fi D1

Pulsanti	Funzioni
	Acceso
	Spento
	Premere brevemente per ottenere una bassa luminosità, premere in maniera prolungata per diminuire la luminosità
	Premere brevemente per ottenere una luminosità media, premere in maniera prolungata per diminuire la luminosità
	Premere brevemente per ottenere la luminosità massima, premere in maniera prolungata per aumentare la luminosità
	Premere brevemente per aumentare la luminosità, premere in maniera prolungata per aumentare la luminosità
	Mantenere premuto per 5 secondi e rilasciare dopo il segnale "Bip Bip", che indica che le impostazioni del telecomando sono state cancellate con successo. In caso di necessità di utilizzo, premere brevemente un pulsante qualsiasi entro 5 secondi dalla riaccensione; il segnale "Bip" indica che il telecomando è stato accoppiato con successo.
	Mantenere premuto per 5 secondi finché la luce collegata non entra in modalità di attivazione, il che indica che il dispositivo si trova in modalità di accoppiamento rapido (Touch); a questo punto è possibile aggiungere la luce sull'APP eWeLink. Premere brevemente un pulsante qualsiasi del telecomando per uscire dalla modalità di accoppiamento rapido.

## Compatibili con i dispositivi SONOFF

- RFR2
- BASICRFR3
- 4CHPROR3
- SlampherR2
- RF BridgeR2
- Dimmer smart Wi-Fi D1
- Switch smart Wi-Fi serie TX
- Controller ventilatore e luce da soffitto Wi-Fi iFan04

### RM433R2-BASE

#### Metodi di installazione 1:

Installare la base a parete utilizzando nastri adesivi 3M.

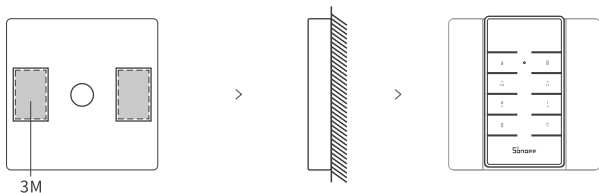

#### Metodi di installazione 2:

Rimuovere le due protezioni superiori da entrambi i lati della base per il montaggio da effettuare utilizzando le apposite viti.

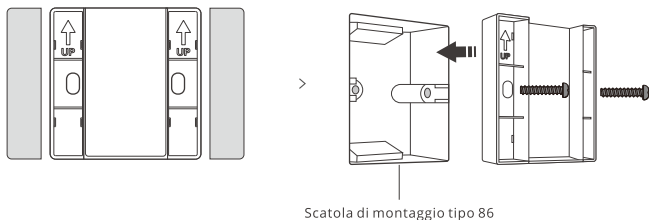

⚠ La base non è inclusa nella confezione, da acquistare separatamente.

## Снимите изоляционный лист батареи

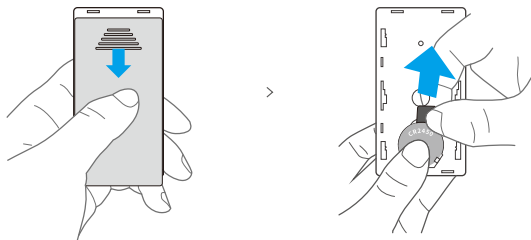

⚠ Устройство имеет версию с батареей и без батареи.

## Технические характеристики

Модель	RM433R2
РЧ	433 МГц
Размер пульта	87 x 45 x 12 мм
Размер базы	86 x 86 x 15 мм (не входит в комплект)
Источник питания	Кнопочный элемент 3 В x 1 (Модель батареи: CR2450)
Материал	PC V0

## Знакомство с изделием









Модель RM433R2 совместима со всеми продуктами SONOFF с частотой 433 МГц и другими устройствами, поддерживающими протокол обмена данными 433 МГц.











⚠ При сопряжении с различными продуктами используются кнопки с различными функциями.

# Инструкция по управлению кнопками

## Пример 1: WiFi-контроллер потолочного вентилятора и света iFan04

Кнопки	Функции
	Вкл./Выкл. (свет)
	Без звука
	Выкл. (вентилятор)
	Низкая скорость
	Средняя скорость
	Высокая скорость
	Удерживайте в течение 5 секунд, пока потолочный вентилятор не издаст два звуковых сигнала, чтобы сбросить этот код. После сброса кода, чтобы вновь начать использование, нажмите любую кнопку в течение 5 секунд после включения; потолочный вентилятор издаст звуковой сигнал, что указывает на успешное сопряжение.
	Удерживайте в течение 5 секунд, пока вентилятор не издаст два коротких и 1 длинный звуковых сигнала, устройство перейдет в режим быстрого сопряжения. После этого можно добавлять светильник в приложении eWeLink. В режиме быстрого связывания устройств можно выполнить короткое нажатие любой кнопки на пульте дистанционного управления, чтобы выйти из этого режима.

## Пример 2: Смарт-регулятор света D1 Wi-Fi

Кнопки	Функции
	Вкл.
	Выкл.
	Нажмите, чтобы включить на низкой яркости; нажмите и удерживайте, чтобы уменьшить яркость.
	Нажмите, чтобы включить на средней яркости; нажмите и удерживайте, чтобы уменьшить яркость.
	Нажмите, чтобы включить на более высокой яркости; нажмите и удерживайте, чтобы увеличить яркость.
	Нажмите, чтобы включить на высокой яркости; нажмите и удерживайте, чтобы увеличить яркость.
	Выполните долгое нажатие в течение 5 секунд, пока не услышите два звуковых сигнала, который означает, что сброс пульта дистанционного управления выполнен успешно. При необходимости использовать устройство после повторного включения питания выполните короткое нажатие любой кнопки в течение времени, не превышающего 5 секунд. Вы услышите звуковой сигнал, который означает, что связывание пульта дистанционного управления выполнено успешно.
	Выполните долгое нажатие в течение 5 секунд, пока индикатор соединения не перейдет в «дышащий режим». Это говорит о том, что устройство перешло в режим быстрого связывания устройств (касайтесь). После этого можно добавлять светильник в приложении eWeLink. В режиме быстрого связывания устройств можно выполнить короткое нажатие любой кнопки на пульте дистанционного управления, чтобы выйти из этого режима.

## Поддерживаемые устройства SONOFF

- RFR2
- BASICRFR3
- 4CHPROR3
- SlampherR2
- RF BridgeR2
- Smart-регулятор света D1 Wi-Fi
- Smart-переключатели Wi-Fi серии TX
- WiFi-контроллер потолочного вентилятора и света iFan04

### RM433R2-BASE

#### Способы установки 1:

Установите базу на стену с помощью клейкой ленты ЗМ.

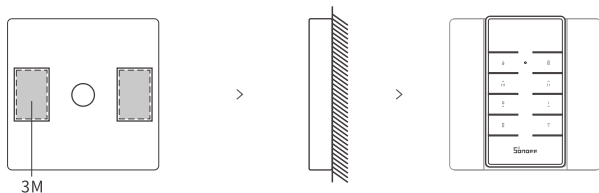

#### Способы установки 2:

Снимите две верхние крышки с обеих сторон базы для выполнения установки с использованием винтов.

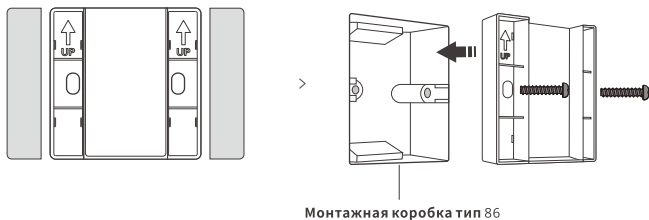

⚠️ База не входит в комплект поставки, необходимо приобрести ее отдельно.

## Retire a plástico de isolamento da bateria

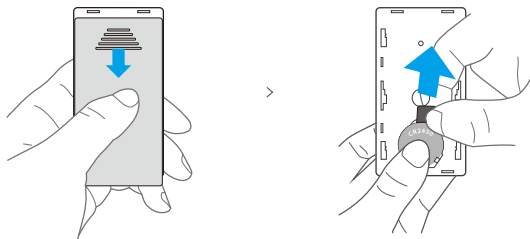

ⓘ O aparelho possui a versão com bateria e sem bateria.

## Parâmetros do produto

Modelo	RM433R2
RF	433MHz
Tamanho do controle remoto	87x45x12mm
Tamanho da base do controle remoto	86x86x15mm (não incluído)
Fonte de alimentação	Célula-botão de 3V x 1 (Modelo da bateria: CR2450)
Material	PC V0

## Descrição do produto

O RM433R2 se aplica a todos os produtos SONOFF com frequência 433MHz e outros dispositivos que suportam o protocolo de comunicação 433MHz.

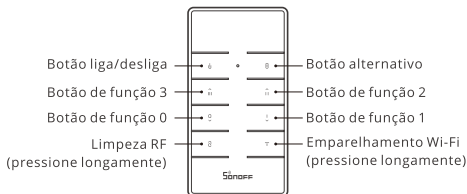

ⓘ Os botões são criados com diferentes funções ao emparelhar com diferentes produtos.

# Instruções dos botões

## Exemplo 1: iFan04 Wi-Fi Fan & Light Controller

Botões	Funções
	Liga/Desliga (Luz)
	Mudo
	Desligado (ventilador)
	Baixa velocidade
	Média velocidade
	Alta velocidade
	Pressione e segure por 5s até que o ventilador de teto emita dois sons "Bipe Bipe" para limpar o código de limpeza com sucesso. Após a conclusão do código de limpeza, se você precisar usar o produto, pressione qualquer botão em 5s após ligá-lo novamente, até que o ventilador de teto faça um som "Bipe" e o emparelhamento seja bem-sucedido.
	Pressione e segure por 5s até que o ventilador emita dois "Bipes" curtos e um longo para entrar no modo de emparelhamento rápido (Toque). Depois, você pode adicionar o dispositivo no eWeLink APP. No modo de emparelhamento rápido, você pode pressionar rapidamente qualquer botão no controle remoto para sair desse modo.

## Exemplo 2: D1 Wi-Fi smart dimmer

Botões	Funções
	Liga
	Desliga
	Pressione rapidamente para o brilho baixo, pressione e segure para diminuir o brilho
	Pressione rapidamente para o brilho médio, pressione e segure para diminuir o brilho
	Pressione rapidamente para aumentar o brilho, pressione e segure para aumentar o brilho
	Pressione rapidamente para alto brilho, pressione e segure para aumentar o brilho
	Pressione longamente por 5s até ouvir "Bipe Bipe" e solte, então o controle remoto é apagado com sucesso. Depois que o código de limpeza for concluído, se você precisar usar, pressione rapidamente qualquer botão em 5s após ligar novamente e você ouvirá um "Bipe", que indica que o controle remoto foi emparelhado com sucesso.
	Pressione e segure por 5s até que a luz conectada entre no modo de respiração, o que indica que o dispositivo entra no modo de emparelhamento rápido (Toque), então você pode adicionar a luz no APP eWeLink. No modo de emparelhamento rápido, você pode pressionar rapidamente qualquer botão no controle remoto para sair desse modo.



## Funciona com dispositivos SONOFF

- RFR2
- BASICRFR3
- 4CHPROR3
- SlampherR2
- RF BridgeR2
- D1 Wi-Fi smart dimmer
- TX series Wi-Fi smart switches
- iFan04 Wi-Fi Fan & Light Controller

### RM433R2-BASE

#### Método 1:

Instale a base na parede com fitas adesivas da 3M.

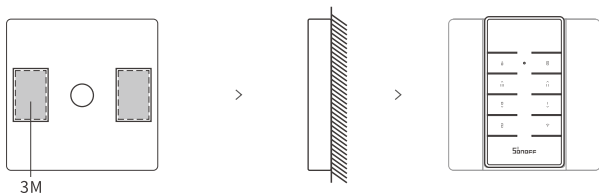

#### Método 2:

Remova as duas tampas superiores de ambos os lados da base para instalar com parafusos.

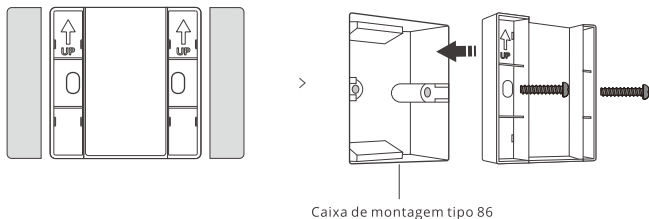

⚠ A base não está incluída no pacote; please adquira-o separadamente.

## FCC Warning

Changes or modifications not expressly approved by the party responsible for compliance could avoid the user's authority to operate the equipment.

This device complies with part 15 of the FCC Rules. Operation is subject to the following two conditions: (1) This device may not cause harmful interference, and (2) this device must accept any interference received, including interference that may cause undesired operation.

### **FCC Radiation Exposure Statement:**

The device has been evaluated to meet general RF exposure requirement. The device can be used in portable exposure condition without restriction.

### **Note:**

This equipment has been tested and found to comply with the limits for a Class B digital device, pursuant to part 15 of the FCC Rules. These limits are designed to provide reasonable protection against harmful interference in a residential installation. This equipment generates, uses and can radiate radio frequency energy and, if not installed and used in accordance with the instructions, may cause harmful interference to radio communications. However, there is no guarantee that interference will not occur in a particular installation. If this equipment does cause harmful interference to radio or television reception, which can be determined by turning the equipment off and on, the user is encouraged to try to correct the interference by one or more of the following measures:

- Reorient or relocate the receiving antenna.
- Increase the separation between the equipment and receiver.
- Connect the equipment into an outlet on a circuit different from that to which the receiver is connected.
- Consult the dealer or an experienced radio/TV technician for help.

Hereby, Shenzhen Sonoff Technologies Co., Ltd. declares that the radio equipment type RM433R2 is in compliance with Directive 2014/53/EU. The full text of the EU declaration of conformity is available at the following internet address:

<https://sonoff.tech/usermanuals>

The logo features the word "SONOFF" in a bold, black, sans-serif font. Above the letter "O" are three curved lines representing radio signal waves.

**Shenzhen Sonoff Technologies Co., Ltd.**

1001, BLDG8, Lianhua Industrial Park, shenzhen, GD, China  
ZIP code: 518000 Website: sonoff.tech

MADE IN CHINA

