

[Skip to content](#)

**Manuals+**

User Manuals Simplified.



# SONOFF 12655 4-Key 433MHz Remote Control User Manual

April 23, 2022 April 24, 2022 [Leave a comment on SONOFF 12655 4-Key 433MHz Remote Control User Manual](#)

[Home](#) » [SonOFF](#) » SONOFF 12655 4-Key 433MHz Remote Control User Manual 

# SONOFF

12655 4-Key 433MHz Remote Control  
User Manual

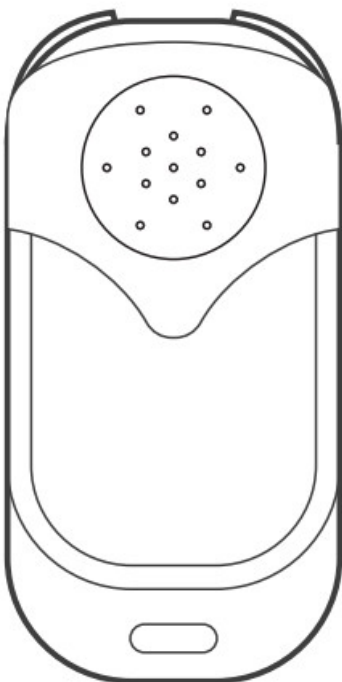

Contents [hide](#)

[1 Product Introduction](#)

[2 Specifications](#)

[3 How to use](#)

[4 Works with SONOFF devices](#)

[5 FCC Warning](#)

[6 Documents / Resources](#)

[6.1 Related Manuals / Resources](#)

## Product Introduction

The device applies to all SONOFF products with 433MHz frequency and other devices supporting the 433MHz communication protocol.

## Specifications

|                       |  |
|-----------------------|--|
| Model                 | 4-key 433MHz Remote Controller             |
| RF                    | 433MHz                                     |
| Power supply          | 3V button cell x 1 (Battery model: CR2032) |
| Working current       | 10mA                                       |
| Operating temperature | 0°C-40°C                                   |
| Product size          | 55x30x14mm                                 |

## How to use

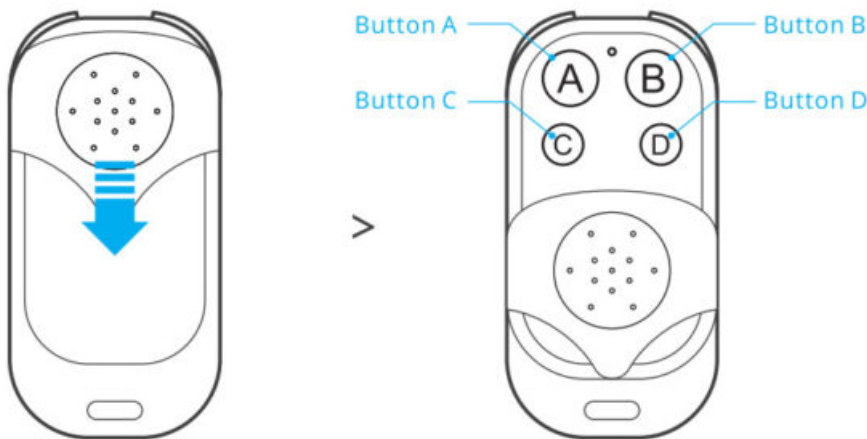

Swipe down the protective cover

Button A/B/C/D is able to learn devices that support 433MHz communication protocol respectively. After learning successfully, the on / off of these devices can be controlled by this remote controller.

⚠ Different devices have different learning methods, please refer to the User Manual of the devices that support the 433MHz communication protocol.

## Works with SONOFF devices

- RFR2
- BASICRFR3
- 4CHPROR3
- SlampherR2
- RF BridgeR2
- TX series Wi-Fi smart switches

Learning case:

1. Remote control and RFR2 learning method Long press the RFR2 pairing button for 3 seconds until the RFR2 signal indicator flashes red, then short press the key to learning on the remote control, and the RFR2 signal indicator flashes red again, indicating that the pairing is successful.
2. The learning method of TX series Wi-Fi smart switches of remote controller Long touch the key of the channel to be paired on the switch for 3 seconds, release it after hearing the “drop” sound of the switch, and then short press the key to be paired on the remote control. If you hear the “drop” sound of the switch again, it indicates that the pairing is successful.

## FCC Warning

Changes or modifications not expressly approved by the party responsible for compliance could avoid the user's authority to operate the equipment. This device complies with part 15 of the FCC Rules. Operation is subject to the following two conditions: (1) This device may not cause harmful interference, and (2) this device must accept any interference received, including interference that may cause undesired operation.



**Shenzhen Sonoff Technologies Co., Ltd.**

3F & 6F, Bldg A, No. 663, Bulong Rd, Shenzhen, GD, China

ZIP code: 518000

Website: [sonoff.tech](http://sonoff.tech)

MADE IN CHINA



UK  
CA



## Documents / Resources

SONOFF



4-key 433MHz Remote Controller  
User manual V1.0

© 2017-2018 Sonoff Technology Co., Ltd. All rights reserved.

[SONOFF 12655 4-Key 433MHz Remote Control](#) [pdf] User Manual

4-433, 4433, 2APN54-433, 2APN54433, 12655 4-Key 433MHz Remote Control, 12655, 4-Key 433MHz Remote Control

## Related Manuals / Resources



[SONOFF 433MHz Remote Controller RM433 User Manual](#)

RM433 User manual V1.1 433MHz Remote Controller Operation Guide  
Before operating the product, please press and push down...

[Remote Tech SB4 Smart key User Manual](#)

Remote Tech SB4 Smart key User Manual This remote has lock, unlock, and panic buttons; you can lock...



### [Remote Tech RT-CY686 Remote Key User Manual](#)

Company: Remote Tech LLC Address: 310 ALDER RD,Dover,DE 19904,USA Name: Remote Key Model: RT-CY687, RT-CY686, RT-CYRC3, RT-CYRC4 ...



### [Sonoff RM433 Remote Controller User Manual](#)

Sonoff RM433 Remote Controller Install batteries The battery is not included, please purchase it separately. Specifications Model RM433R2...

## Leave a comment

Your email address will not be published.

Comment

Name

Email

Website

Save my name, email, and website in this browser for the next time I comment.

## [Manuals+](#),

- [home](#)
- [privacy](#)