

## SwitchBot LED Strip Light User Manual

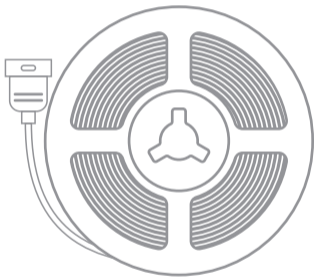

LED Strip Light  
(5m/16.4ft)



Controller



Power Adaptor



Remote Control



Mounting Buckles x 6  
(with screws)



User Manual

### Package Contents

### Preparation

- A smartphone or tablet with Bluetooth 4.2 or above.
- Download the SwitchBot app on App Store or Google Play Store.
- Open SwitchBot app and register for a SwitchBot account or sign in directly if you have an account.



iOS 11.0+



Android 5.0+

### Installation

#### Before Installing

- Turn on the device and check if it lights up normally.
- Open the app, tap the top right + icon and add the device according to the guide.
- Check if the functions work properly then start to install.

#### Steps

1. Clean the installation surface and ensure that it is dry and clean.

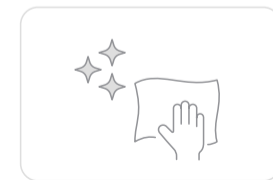

2. Peel off the strip liner on the back, stick it on the installation surface.

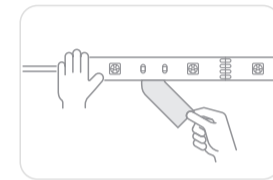

3. If you wish, you may secure your strip light by using the mounting buckles and screws provided, especially at turns.

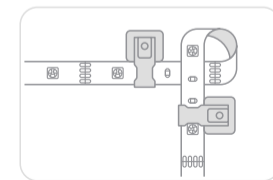

4. Plug in the power adapter.

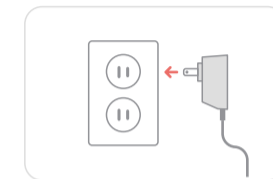

5. Control the device using the remote control, controller or the app.

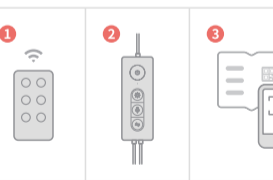

### Functions of the Controller



On/off button

Brightness control

Music mode

Click once: Switches scene  
Hold: Color loop

### Safety Information

- Before using this product, check your electricity voltage. Inappropriate voltage will damage the product and cause safety issues.
- Only cut the strip light at the designated point. The cut off part will not work. Cut the strip light only when the power is off. Otherwise, this can lead to a short circuit.
- Please keep the installation surface clean and even for easy adhesion.
- Use the mounting buckles on surfaces such as wallpaper for a more secure installation.
- The strip light is NOT waterproof, keep away from water.
- Only use the product indoor. When in use, maintain a good airflow for cooling.

- When bending the product during installation, avoid bending the LED parts to maintain a long product life.
- Never allow children to install this product alone.

## Firmware and Factory Reset

### Firmware

Make sure you have the most updated firmware by upgrading in time.

### Factory Reset

Press the power on/off button and music mode button for 8 seconds until red, green and blue light flow through the LED strip light.

Note: After resetting the device, all settings will resume to its default values.

## Specifications

Model: W1701100

Rated Power: 15 W

Input Rating: 100 - 240V 50/60Hz

Connection:

IEEE 802.11b/g/n, 2.4 GHz Wi-Fi

Color Type: RGB

Dimming Range: 1 to 100%

Ways of Control: Controller, app, voice

control or remote control

Operation Life: Around 25,000 hours

Operation Environment: Indoor only

Operating Temperature:

-10 to 45 °C (14 to 113 °F)

Operating Humidity: 10 to 90 %RH

## Troubleshooting

Please visit [support.switch-bot.com](http://support.switch-bot.com) for more information.



## Return and Refund Policy

SwitchBot LED Strip Light has a one-year warranty which begins from the date of purchase. The following situations are not included in the Return and Refund Policy:

- Intended damage or abuse.
- Inappropriate storage (drop down or soaking in water).
- Modify or repair of product.
- Natural wearing of product.
- Natural disasters.

## Contact and Support

Setup and Troubleshooting:

[support.switch-bot.com](http://support.switch-bot.com)

Support Email:

[support@wondertechlabs.com](mailto:support@wondertechlabs.com)

Feedback: If you have any concern or problem when using our product, please kindly send feedback from the Profile > Feedback page in the SwitchBot app.

## CE/UKCA Warning

EU Regulatory Conformance :

RF exposure information: The Maximum Permissible Exposure (MPE) level has been calculated based on a distance of 20 cm between the device and the human body. To maintain compliance with RF exposure requirement, use product that maintain a 20 cm distance between the device and human body.

CE DOC

Hereby, Woan Technology (Shenzhen) Co., Ltd. declares that the radio equipment type W1701100 is in compliance with Directive 2014/53/EU. The full text of the EU declaration of conformity is available at the following internet address: [support.switch-bot.com](http://support.switch-bot.com).

UKCA DOC

Hereby, Woan Technology (Shenzhen) Co., Ltd. declares that the radio equipment type W1701100 is in compliance with UK Radio Equipment Regulations (SI 2017/1206).

The full text of the UK declaration of conformity is available at the following internet address: [support.switch-bot.com](http://support.switch-bot.com).

Address: Room 1101, Qiancheng Commercial Center, No.5 Haicheng Road, Mabu Community, Xixiang Sub-district, Bao'an District, Shenzhen, Guangdong, P.R.China, 518100

Wi-Fi: 2412MHz-2472MHz

BLE: 2402MHz-2480MHz

Operation Temperature: -10 ~ 45 °C

## FCC Warning

This device complies with Part 15 of the FCC Rules. Operation is subject to the following two conditions:  
(1) This device may not cause harmful interference.  
(2) This device must accept any interference received, including interference that may cause undesired operation.

NOTE: This equipment has been tested and found to comply with the limits for a Class B digital device, pursuant to Part 15 of the FCC Rules. These limits are designed to provide reasonable protection against harmful interference in a residential installation. This equipment generates uses and can radiate radio frequency energy and, if not installed and used in accordance with the instructions, may cause harmful interference to radio communications. However, there is no guarantee that interference will not occur in a particular installation.

If this equipment does cause harmful interference

to radio or television reception, which can be determined by turning the equipment off and on, the user is encouraged to try to correct the interference by one or more of the following measures:

- Reorient or relocate the receiving antenna.
- Increase the separation between the equipment and receiver.
- Connect the equipment into an outlet on a circuit different from that to which the receiver is connected.
- Consult the dealer or an experienced radio/TV technician for help.

NOTE: The manufacturer is not responsible for any radio or TV interference caused by unauthorized modifications to this equipment. Such modifications could void the user's authority to operate the equipment.

FCC Radiation Exposure Statement

This equipment complies with FCC radiation exposure limits set forth for an uncontrolled environment. This equipment should be installed and operated with minimum distance 20 cm between the radiator & your body.