

This guide will show you how to obtain, install and configure the JustBoom Player.

Remember that this guide will cover slightly different steps when using the Raspberry Pi Zero.



Before you start.

JustBoom Player has been tested with:

- JustBoom Amp HAT
- JustBoom DAC HAT
- JustBoom Digi HAT
- JustBoom Amp Zero
- JustBoom DAC Zero
- JustBoom Digi Zero

Note that the player can also be used with many of the audio cards already present on the market like iQaudio, HiFiBerry, Allo and others.



Section 1 – Retrieve the image

Step 1 – Use this [link to download the JustBoom Player](#).

Should you need to access via SSH remember that the credentials are:

Username: justboom

Password: justboom

If you are familiar with this section and you are using a Raspberry Pi Zero you can skip directly to [Section 2 – Access JustBoom Player’s HotSpot](#) otherwise skip to [Section 3 – Configure JustBoom Player](#)

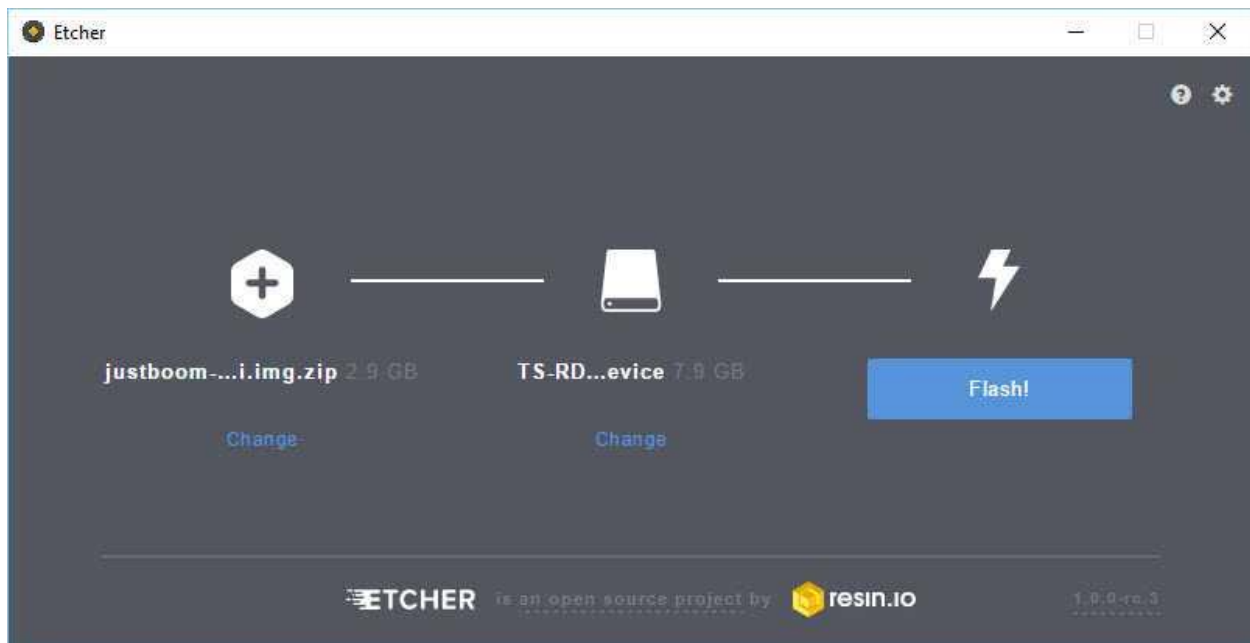

Step 2 – Use our favourite tool [Etcher](#) to transfer the image onto a Micro SD card. Select the image you want to flash, choose the drive on which to write and flash the card.

Note that a card of 4GB or more is required.

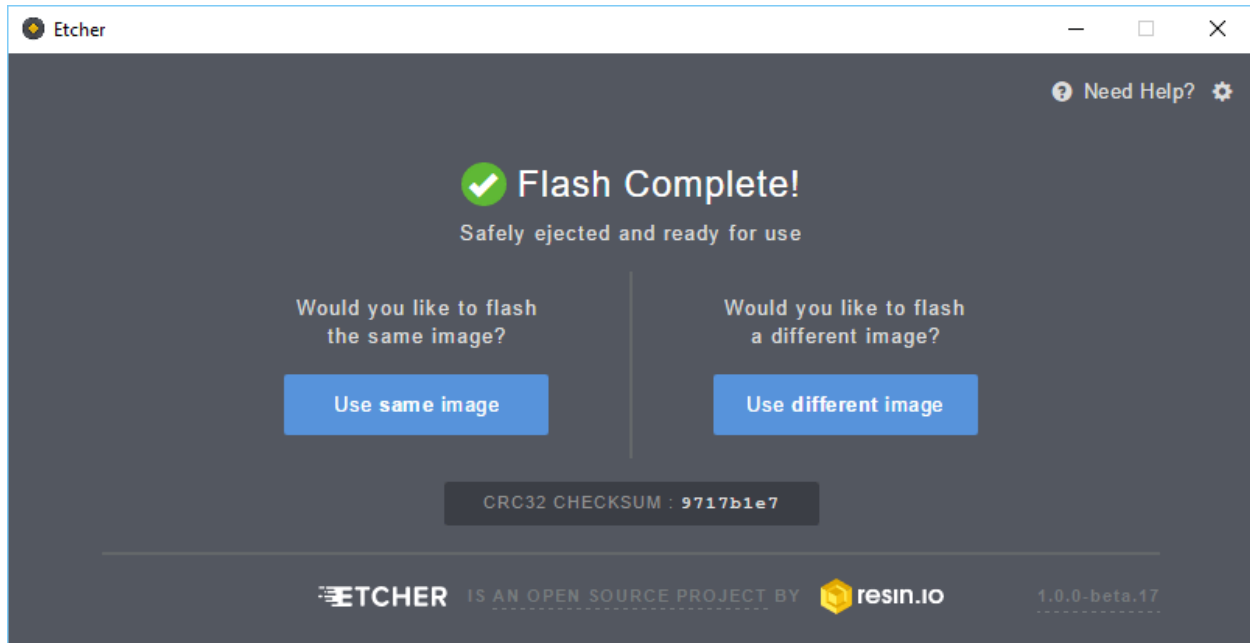

Step 3 – After a while your image will have been written onto your Micro SD card. Remove it from your reader and insert it in your Raspberry Pi.

Make sure that you have followed one of [our assembly guides](#) before you get to this point.

Network Settings

Network Status

Wireless

Hotspot

IP Address: 192.168.211.1

Online: 

Section 2 – Access JustBoom Player’s HotSpot

If you are running JustBoom Player on a Raspberry Pi Zero chances are that you will only be able to have a Wi-Fi dongle to connect to the rest of the network. When JustBoom Player starts under these conditions, it automatically creates a HotSpot to allow further configuration.

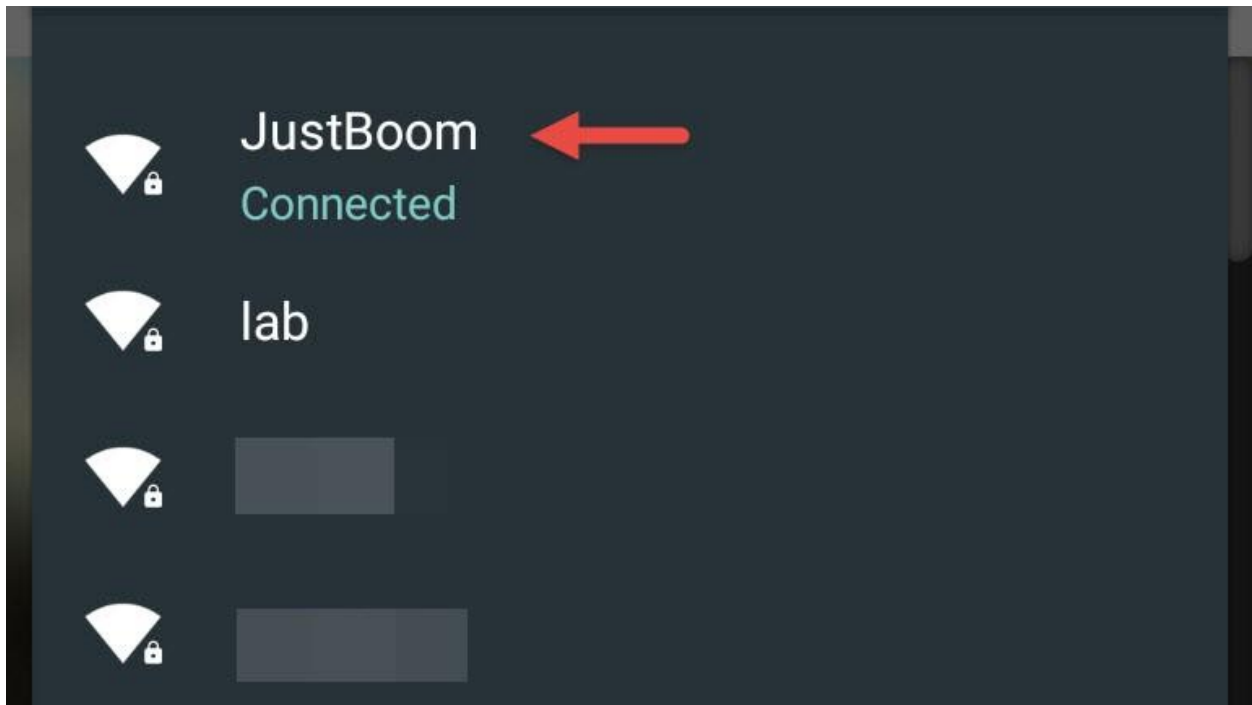

Step 1 – The easiest way to connect to JustBoom Player via its HotSpot is to use a mobile phone. With it connect to the JustBoom SSID using password **justboom**.



Step 2 – With your browser point to <http://justboom.local>. This should take you to JustBoom Player's home page. [Check the notes below](#).

Click on the cog in the bottom right corner of the screen then click on "Network".

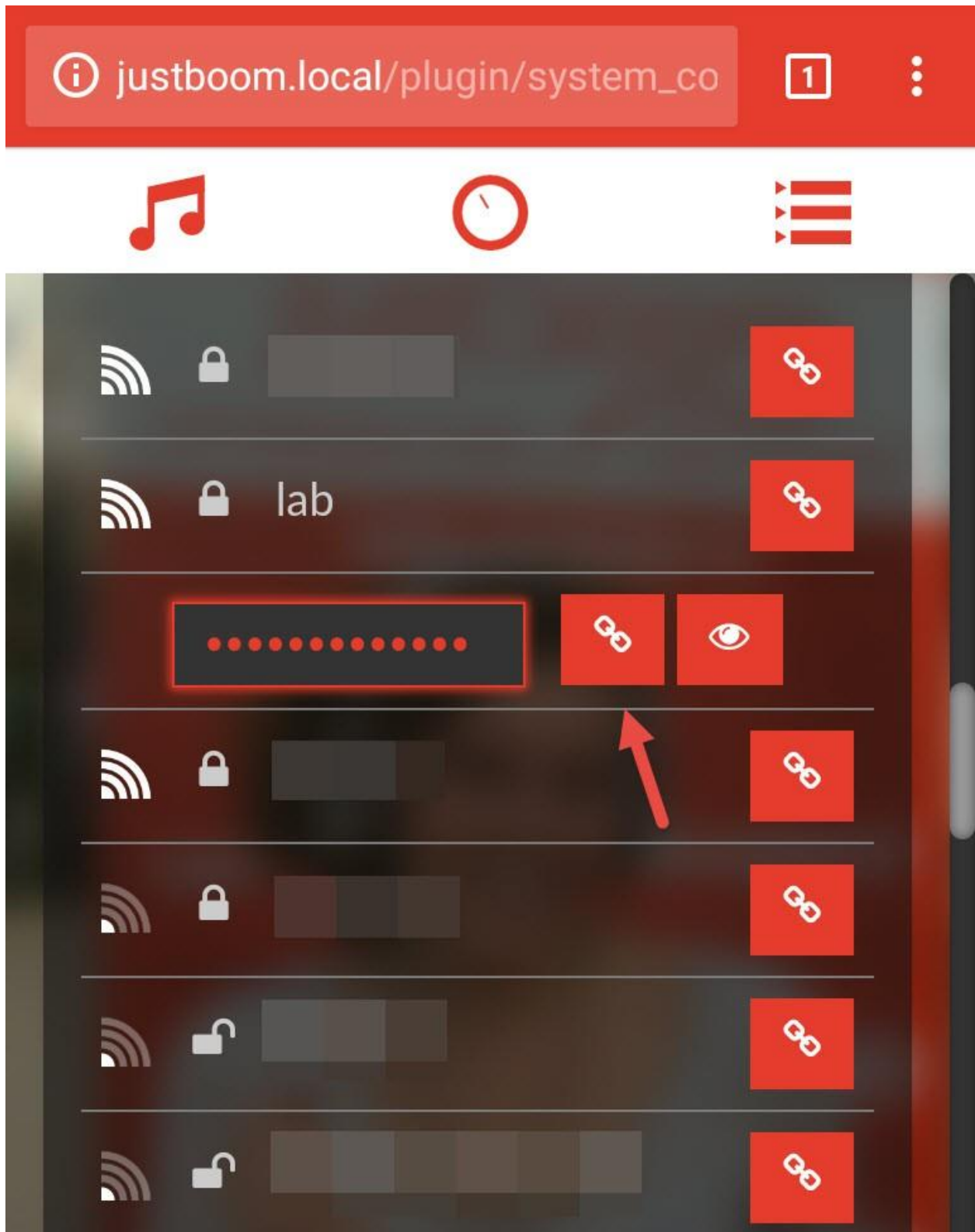

Step 3 – Select your home SSID and set the WPA passkey then click on the connect button as shown in the picture.

JustBoom Player is now connected to your network and you can move to the next section to finalise the configuration.



Section 3 – Configure the JustBoom Player

Step 1 – Power up your Raspberry Pi and wait a couple of minutes for the OS to boot up completely.

Point your browser to <http://justboom.local> to be redirected to JustBoom Player’s main page. [Check the notes below](#). Once there click on the cog from the top right corner.

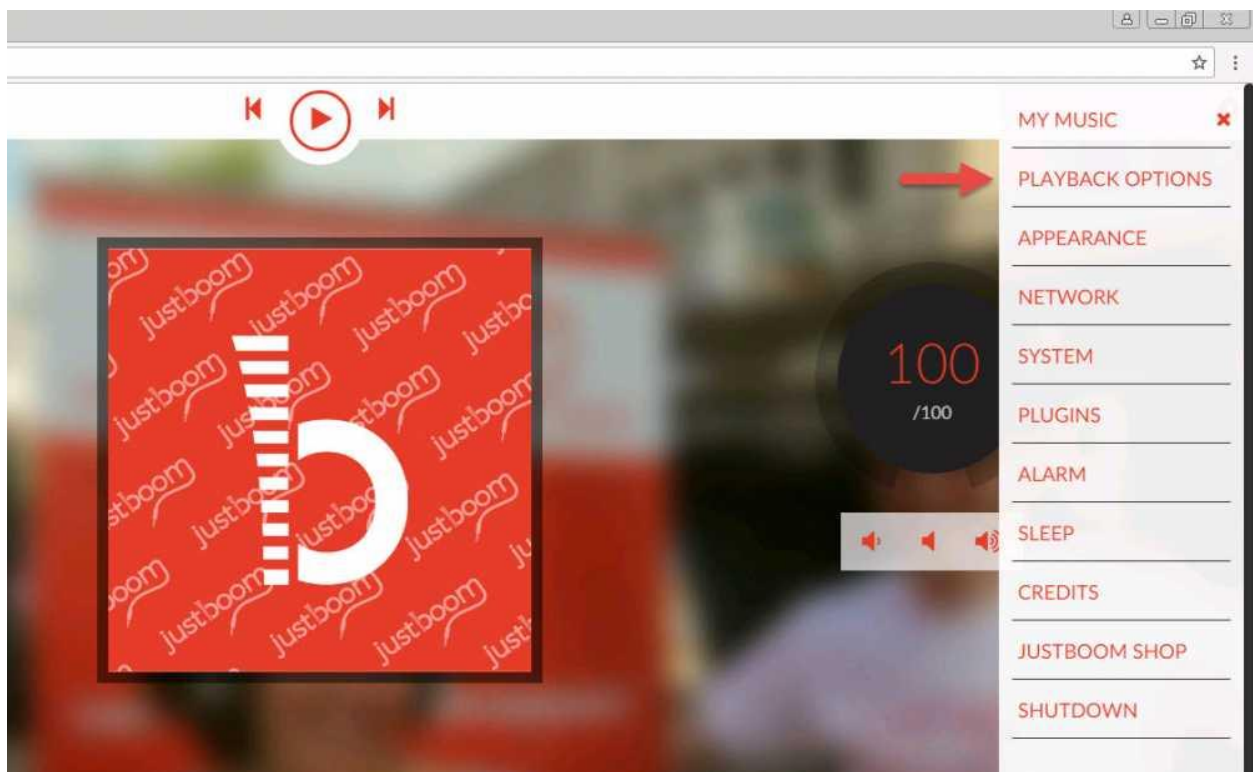

Step 2 – Select “Playback Options”.

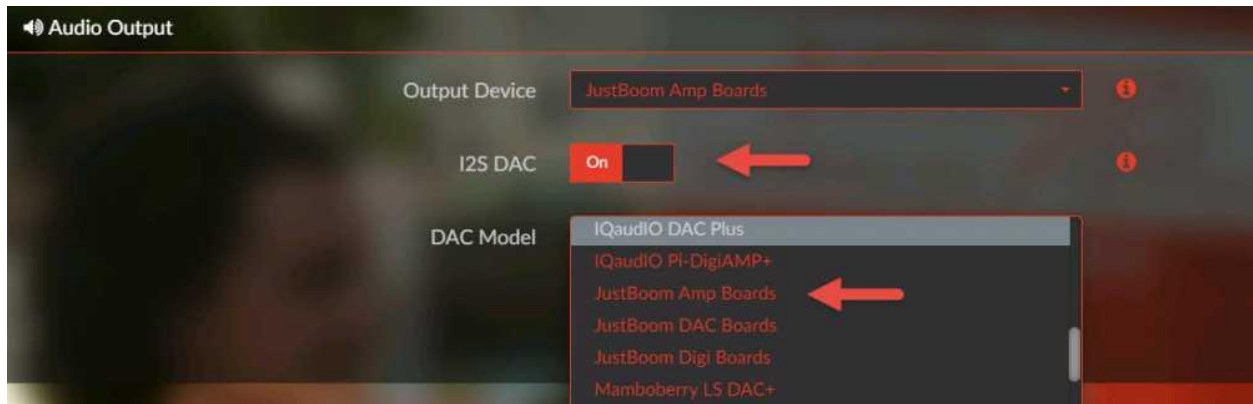

Step 3 – Enable I2S if your card is compatible with that and then choose your device from “DAC Model”. For example to use the JustBoom cards this what you should choose from the drop-down:

- JustBoom DAC Boards for DAC HAT or DAC Zero
- JustBoom Amp Boards for Amp HAT or Amp Zero
- JustBoom Digi Boards for Digi HAT or Digi Zero

Then “Save” the configuration.

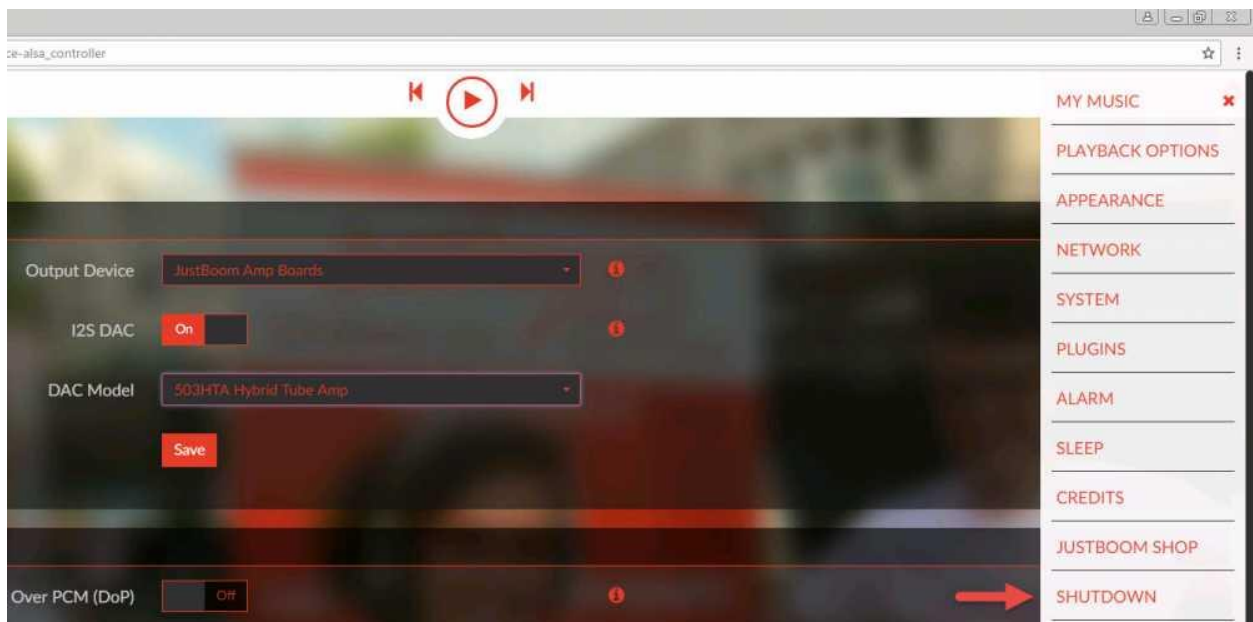

Step 4 – Select “Shutdown” from the menu on the right and click on the “Restart” button.

Once the browser page is refreshed you should be able to hear a sound from JustBoom Player when it starts up.

You will now be able to enjoy JustBoom Player.

ZeroConf Browser

 Services



 Info

  **Screen Sharing**

raspberrypi (VNC Server)
_rfb._tcp.local.
raspberrypi.local.:5900
/192.168.1.20

  **_UDISKS-SSH**

raspberrypi
_udisks-ssh._tcp.local.
raspberrypi.local.:22
/192.168.1.20

  **Workstation**

raspberrypi [00:0f:60:05:91:60]
_workstation._tcp.local.
raspberrypi.local.:9
/192.168.1.20



Note for Android users: Android OS doesn't officially support mDNS which is needed to resolve .local addresses. Although some distributions will have added this protocol some other Android based systems will not be able to make sense of these addresses. If your browser cannot resolve justboom.local you will have to use its IP address instead which by default is 192.168.211.1. An easy way to find that out is by using [ZeroConf Browser](#) which allows you to browse the LAN for devices that offer mDNS/Apple Bonjour services and identify their IP address.

Note for Windows users: If your browser cannot resolve justboom.local you will need to install [Bonjour from Apple](#). Alternatively you will have to find out the IP address of your JustBoom Player box. If you have connected a monitor to your Raspberry Pi you should see it on the screen most likely in the form of 192.168.x.y. Your browser will have to be pointed to <http://192.168.x.y>

Additional notes:

The JustBoom Player also provides a captive portal when in Hotspot mode so that whatever address you will try to use in the browser the request will be redirected to your JustBoom Player's home page. On a PC in fact as you connect to the Hotspot your browser will directly open up to the JustBoom Player's home page with the address <http://www.msftconnecttest.com/playback>.