

What Should We Check Before Purchasing the SwitchBot Lock

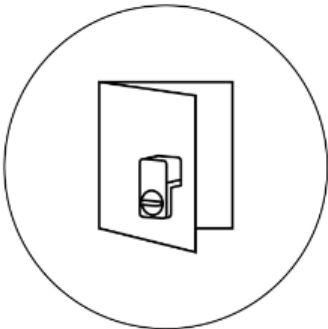

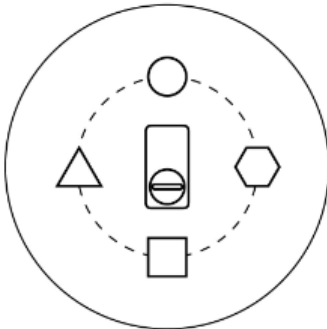
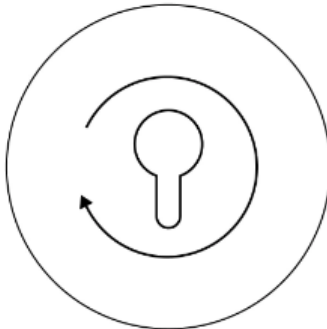
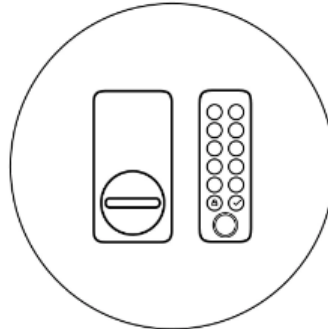

Before buying, please check if SwitchBot Lock is compatible with your original door lock and if it can be used with your smartphone or Apple Watch.

1. General information about SwitchBot Lock.

			
<p>Interior use only</p> <p>The SwitchBot Lock is installed on the interior side of the door.</p>	<p>Multipoint locks</p> <p>The SwitchBot Lock can be adapted to various locks by changing accessories.</p>	<p>Any number of rotations</p> <p>The SwitchBot Lock works no matter the number of locking rotations required.</p>	<p>Pair with Keypad</p> <p>Pair with SwitchBot Keypad or Keypad Touch for an even better experience.</p>

2. Identify the type of your door lock.

If your door lock is Deadbolt or Jimmy-Proof, please check compatibility by size or by model. If you are not sure about your door lock brands or if your door lock is special, please contact support@wondertechlabs.com and send us the door lock photo and size, we will be happy to help.

			
Deadbolt ✓	Jimmy-Proof ✓	Uncertain !	Special !

3. Checking lock brands and models.

If your door lock is in the list below, SwitchBot Lock can fit your door lock.

Kwikset

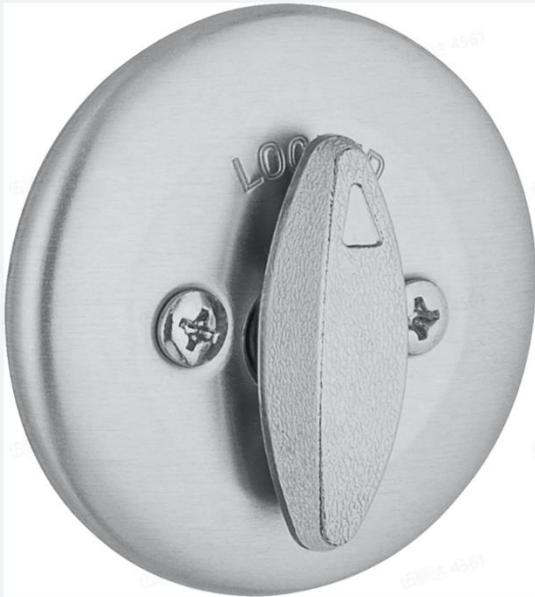
Models	Pictures
660 Single Cylinder Deadbolt	

660 Single Cylinder
Deadbolt



780 Single Cylinder
Deadbolt



Cove Venetian
Bronze Exterior Entry
Door Knob and Single
Cylinder Deadbolt
Combo Pack

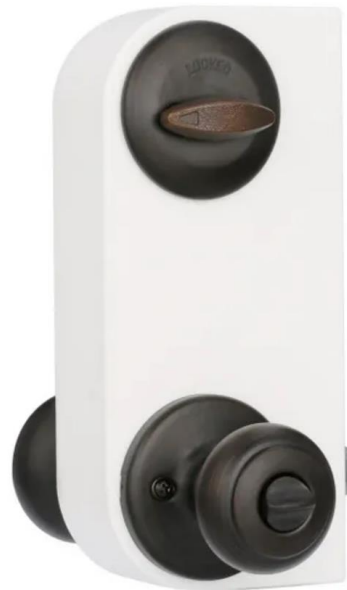

Schlage

Models	Pictures
B60 N COL 619	 A rectangular, brushed metal handle with a curved, ergonomic grip. A silver screw is visible on the left side of the handle.
B60 622	 A circular, black handle with a curved, ergonomic grip. A black screw is visible in the center of the handle.

Baldwin

Models	Pictures
--------	----------

93800-013



Model380 RDB
15 SMT CP
RCAL



Single Cylinder
93800-016



Emtek

Models	Pictures
8469 C-Keyway US15	 A square, brushed metal door handle with a horizontal lever. The handle is mounted on a square backplate. A small screw is visible on the side of the handle. The number '8469' is embossed on the bottom left corner of the backplate.
8466	 A dark, possibly black or dark bronze, door handle with a curved, oval-shaped backplate. The handle has a curved lever. A small screw is visible on the side of the handle. The number '8466' is embossed on the bottom left corner of the backplate.

Omnia

Models	Pictures
--------	----------

COLDB



ARCHDB



D9000



4. Measure your door lock.

If your Deadbolt or Jimmy-Proof door lock fits the dimensions below, the SwitchBot Lock will fit your door lock.

Deadbolt:

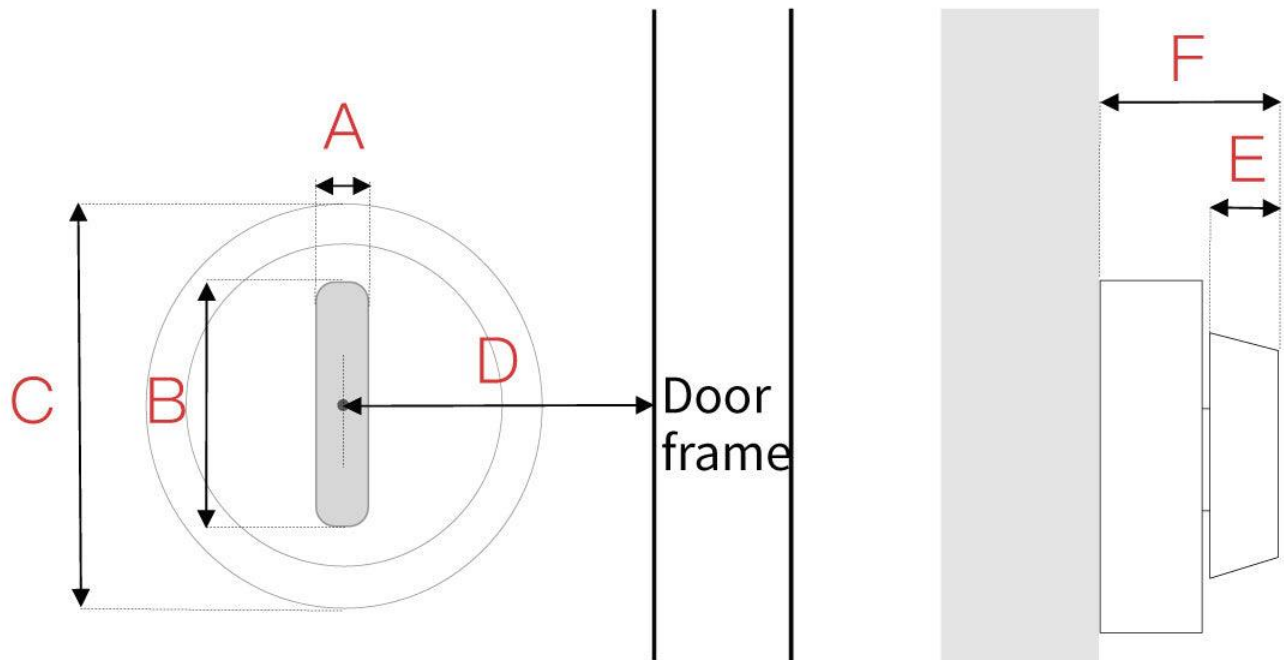

A:2~23mm B:23~42mm C: \leq 56mm
D: \geq 40mm E: \geq 5mm F:0~56mm

Jimmy-Proof:

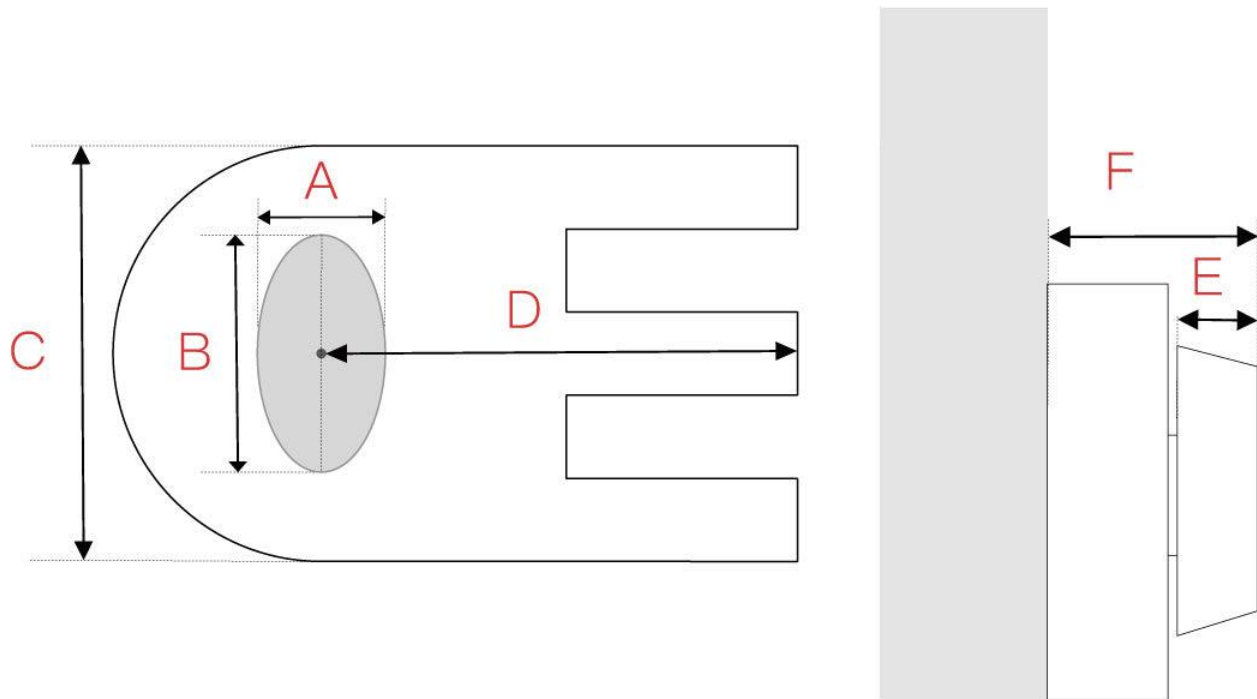

A:2~23mm B:23~42mm C: \leq 56mm
D: \geq 40mm E: \geq 5mm F:0~56mm

Low Battery Alert

With the SwitchBot Lock connected to a SwitchBot Hub, we will get a low battery alert when the battery level is lower than 20%. Under this circumstance, a muffled sound and a red indicator light will be coming out of the Lock every time we try to operate it, locking or unlocking. This would be a sign to tell us to change the battery as soon as possible. Otherwise, we will no longer be able to control the Lock when the battery is dead. Note: we should replace two CR123 brand new batteries.

Delete or Reset

Only when we delete the SwitchBot Lock connected to the SwitchBot account can we pair it to another account. When the SwitchBot Lock is paired to another account, all local data associated with the previous account will be deleted and can not be recovered. Please proceed with caution.

The status of the SwitchBot Lock can be used as a condition to trigger other SwitchBot devices on the Scene function.

There are four conditions of the Lock to choose from:

- Locked
- Unlocked
- Door was closed
- Door was opened

Note:

- A SwitchBot Hub connected to the account is necessary if we want to create a Scene
- We cannot create a Scene to trigger the Lock itself

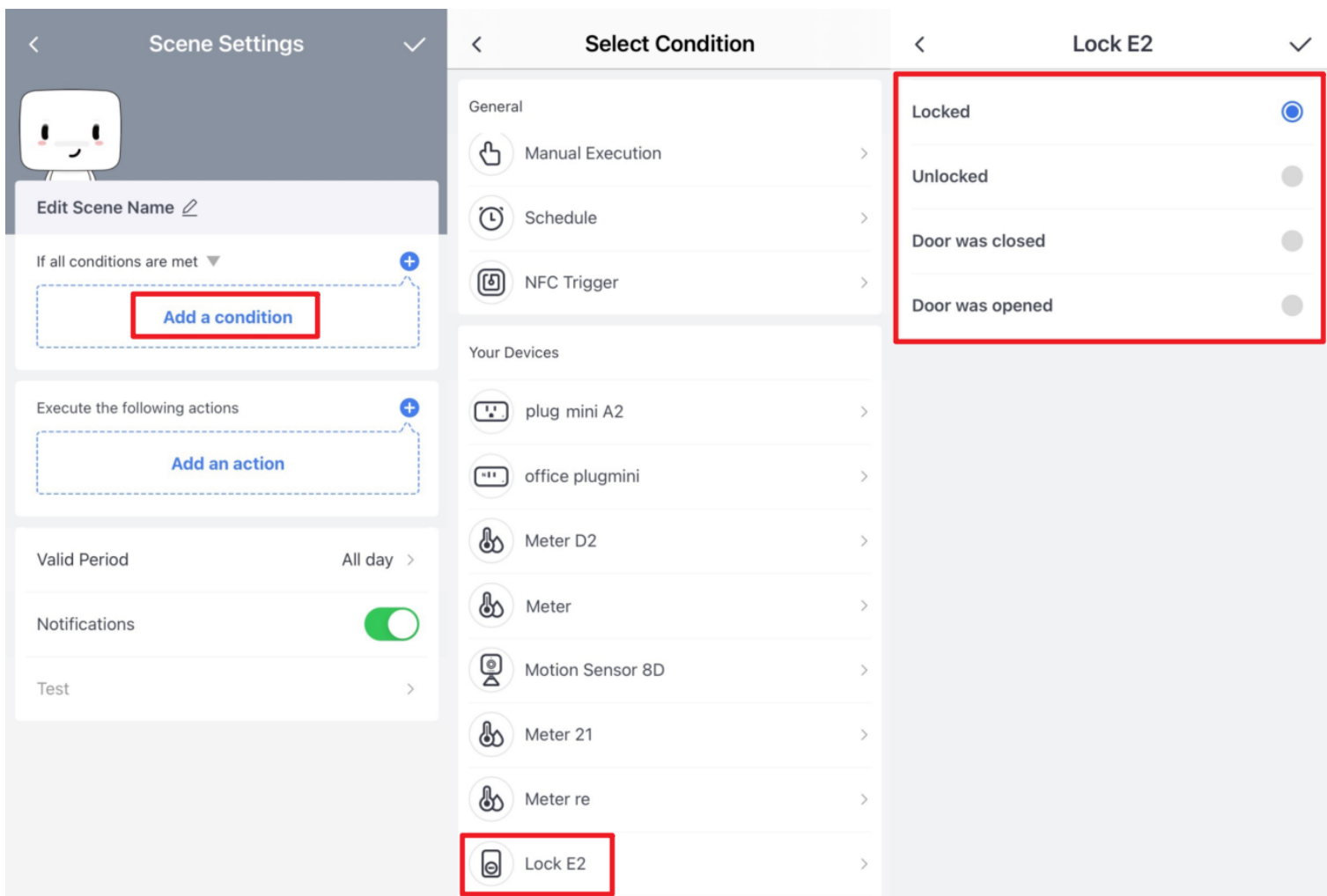

NFC Tag Function

With the SwitchBot Tag included in the package, we can go to the Lock Settings page >NFC and write a Lock /unlock action into the Tag for touch control.

Settings

Lock E2
SwitchBot | All Devices

- Notifications On >
- Alert >
- Auto-Lock On >
- Recalibrate >
- Basic Settings >
- Cloud Services >
- Firmware & Battery >
- FAQs >
- Device Info >
- NFC** >

Delete

NFC

You can pair SwitchBot Tag with your devices through NFC for speedy communication.

Function Shortcut

- Lock** >
Lock when you get closer to SwitchBot Tag
- Unlock** >
Unlock when you get closer to SwitchBot Tag

How to Use NFC

Put your device's NFC area close to the Tag.

1. During data write-in, do not move your device away or this may stop the process.
2. Every time the Tag writes in data, previous data settings will be replaced.

The scanning area for iOS device is at the top back

Not for now

Got it

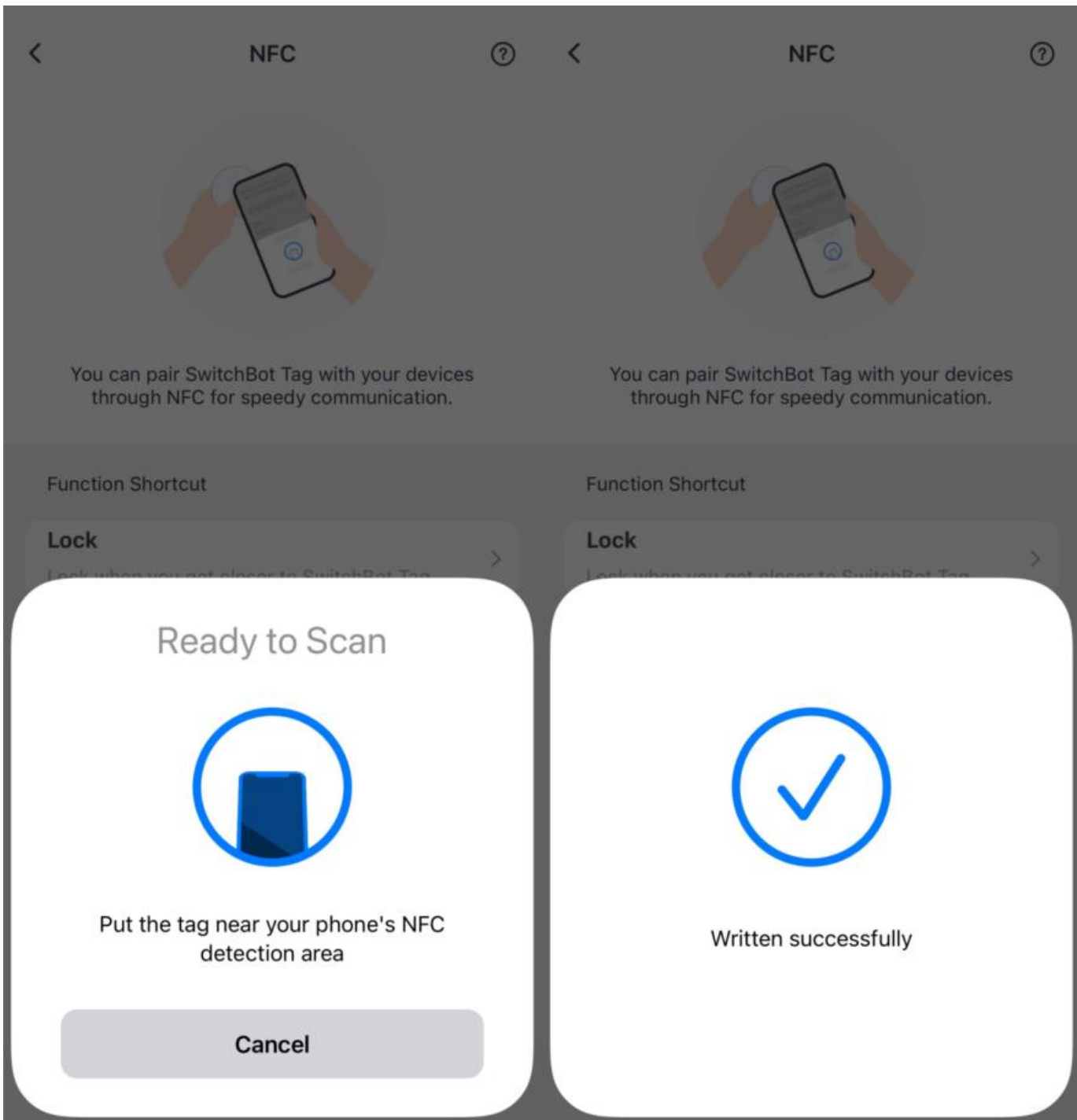

Note:

- If the SwitchBot Tag has been written to control the SwitchBot Lock under SwitchBot account A, this Tag can no longer be used to write another action under account B due to security reasons. The only way to cover this is to write the data of a non-SwitchBot Lock device under the SwitchBot account A. After that, this Tag can be used to write data under other accounts.

- The optimal position for an iOS and Android cellphone to scan the SwitchBot Tag is different. Please refer to the sketch below to find the best position to do the scanning.



Check the Operation Log of the SwitchBot Lock

Go to the control panel of the SwitchBot Lock, we can check the operation log of it.

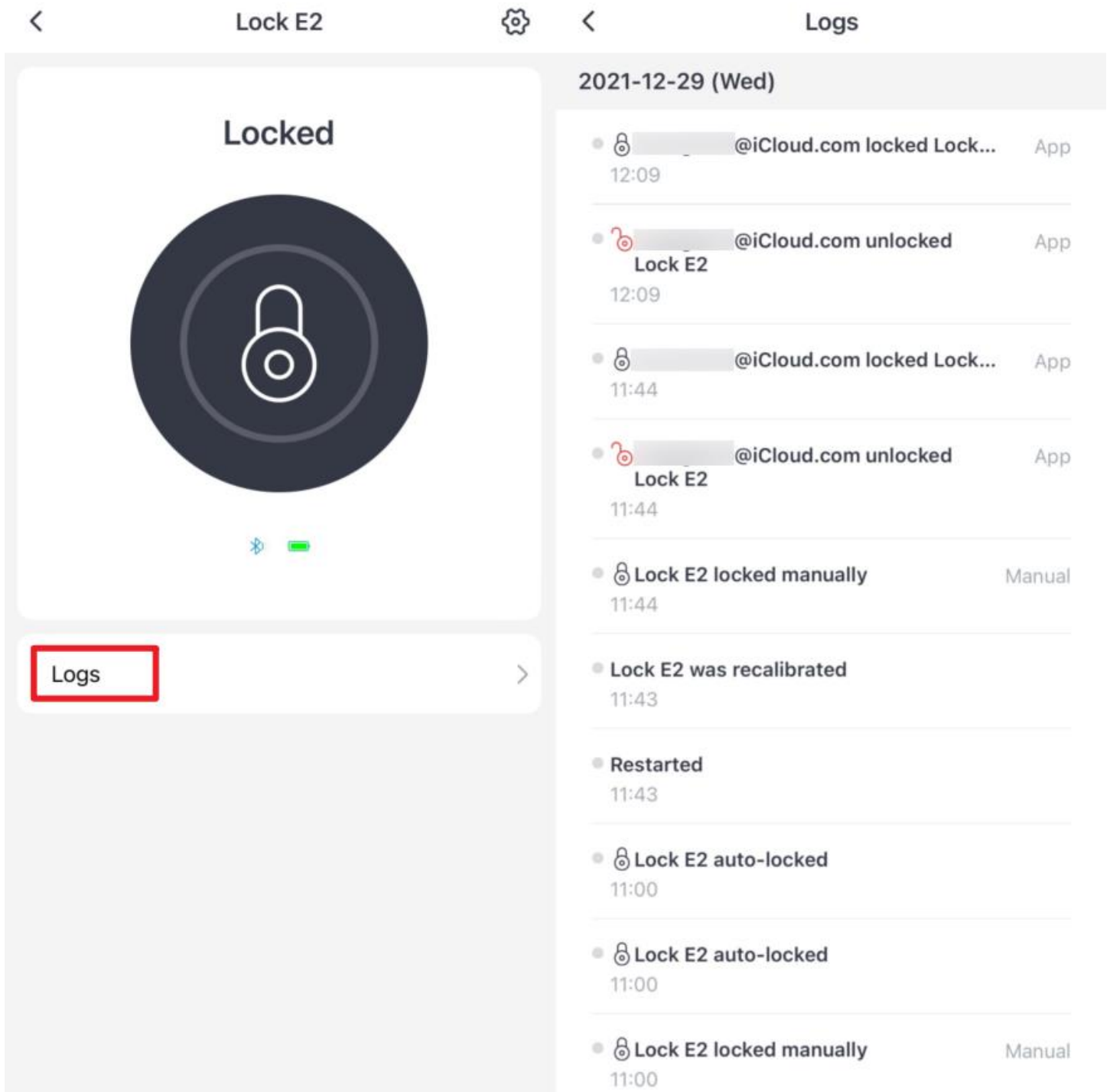

Get Alert From the SwitchBot Lock

When the Cloud Service of the SwitchBot Lock is enabled, we can turn on the notification on the settings page. Of course, we can select the type of event we want to be notified of.



Notification Settings

Allow Notifications



Send notifications from events

Locked/Unlocked manually



Locked/Unlocked by a user



Auto-Locked



Door Ajar



27

28

29

Minute

0

30

Second

1

31

2

32

3

33

If the door is not closed after a set amount of time, push notifications will be sent.

Left Unlocked



0

1

Minute

2

0

Second

3

1

4

2

5

3

If the door is not locked after a set amount of time, push notifications will be sent.

Low Battery

When the battery level is critical ($\leq 20\%$), you will get notifications every 12 hours until you replace batteries to prevent locking yourself out.

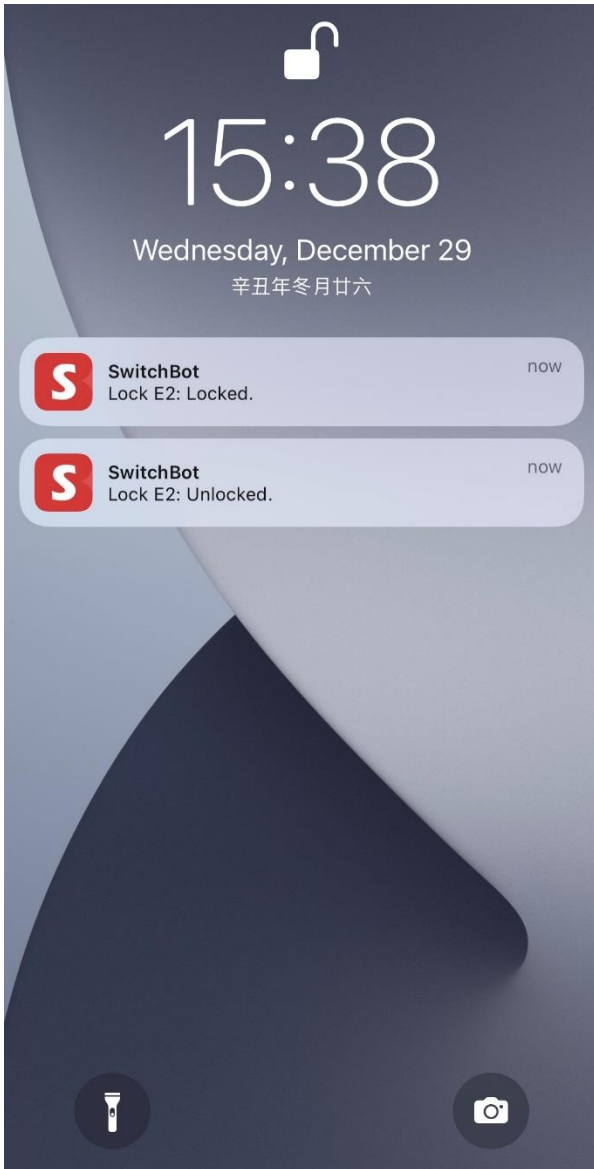

Remote Control for the SwitchBot Lock

If the Cloud Service of the SwitchBot Lock is enabled via a SwitchBot Hub, we can remotely lock or unlock the door even when the cellphone is out of the Bluetooth range of the Lock.

The response time will be differed depending on the network the SwitchBot Hub is connected to, and the number of the SwitchBot devices we have connected to the Hub.

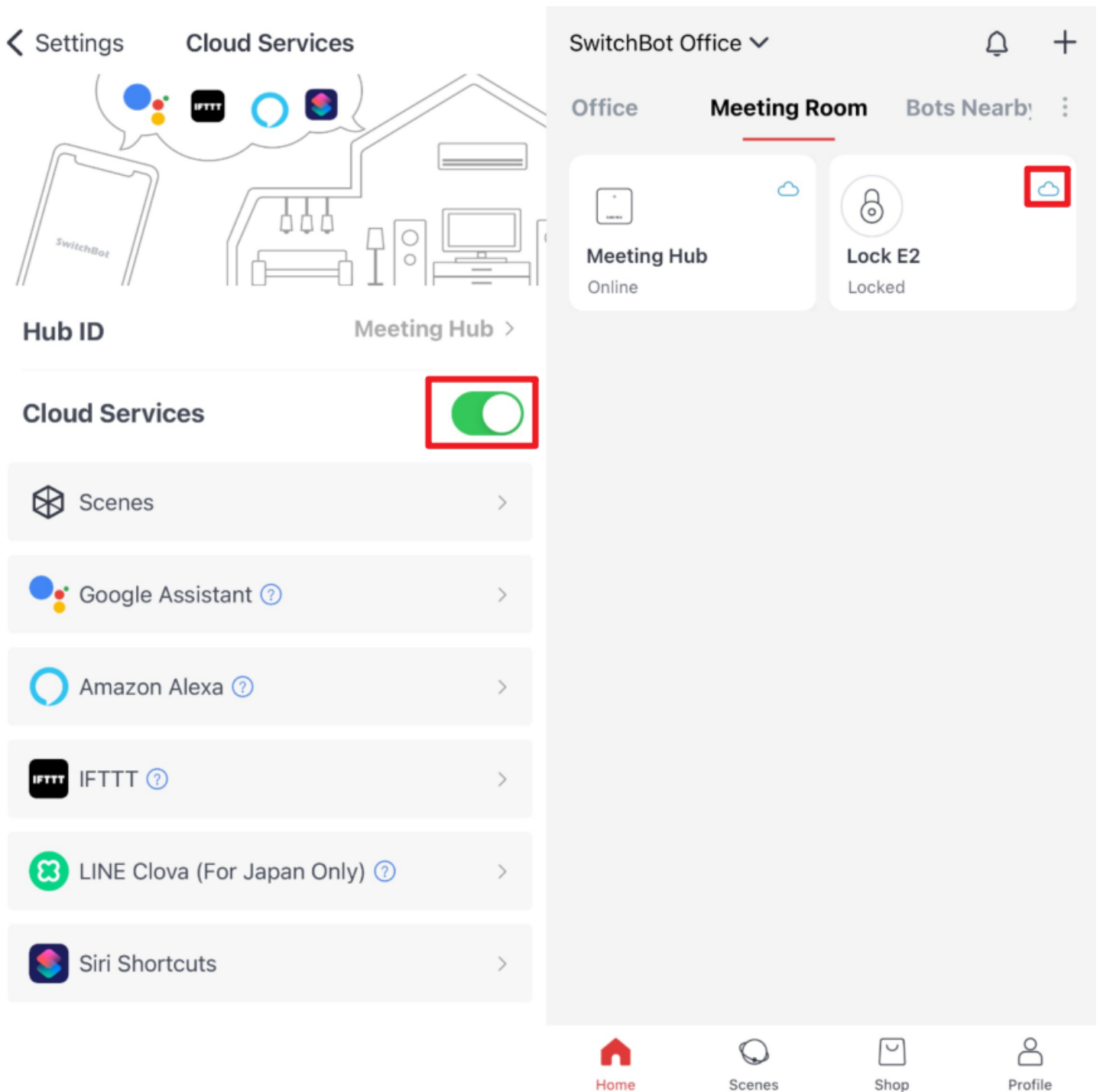

Widget Function for the SwitchBot Lock

We can use the Widget function on the iOS or Android system to directly access the SwitchBot Lock.

For the reason that we **DO NOT** need to unlock the cellphone to access the Lock via Widget, please use it with caution.

For more information about how to set up Widget, please refer to the article below.

For iOS system

[Setting Up the Widgets for iPhone](#)

For Android system

[How to create SwitchBot widget\(s\) with Android device?](#)

Use Apple Watch to Access the SwitchBot Lock

We can use Apple Watch to access the SwitchBot Lock. It requires Apple Watch Series 2 and a newer model to be compatible with this function. The operating system should be above WatchOS 4.0.

When we are within the Bluetooth range of the Lock, we can control it directly. When we are out of the Bluetooth range, we can also control it remotely, which requires a SwitchBot Hub connected to the account and the Cloud Service of the Lock has been enabled.

Auto-Lock Function for the SwitchBot Lock

We can enable the Auto-Lock function on the settings page of the SwitchBot Lock. When this function is enabled, the door will be locked automatically after a preset time when it is closed.

To avoid an unwanted incident, please test the Auto-Lock function indoors.

Note:

- Please upgrade the firmware version of the SwitchBot Lock to V3.5 or above and the App version to V6.1 before using the Auto-Lock function. Otherwise, it will not work correctly.

- The Auto-Lock function is disabled by default.

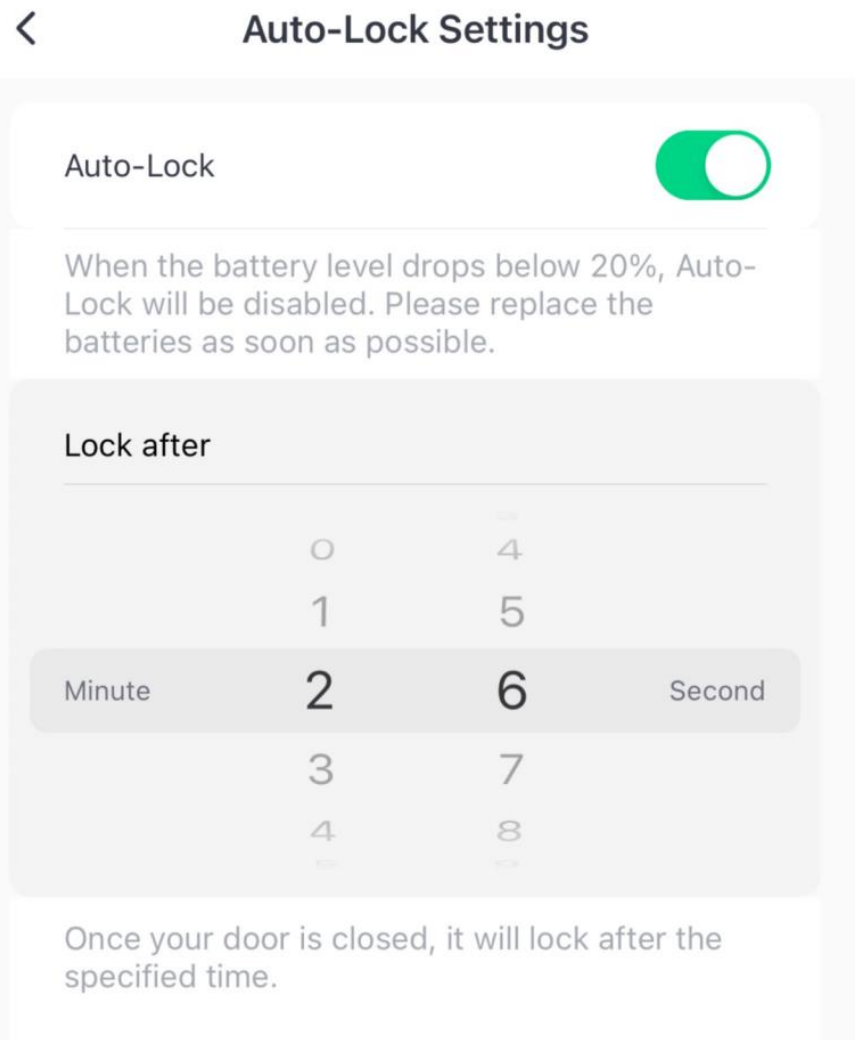
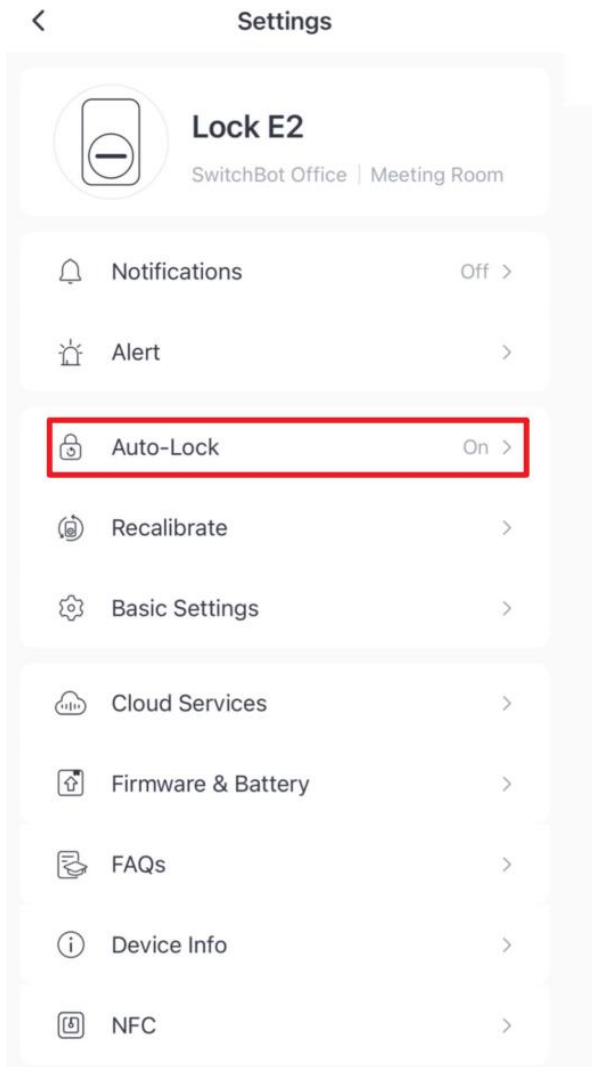

Door Status Detection From the SwitchBot Lock

When we are calibrating the SwitchBot Lock, information of the Lock's spatial position is also recorded. The SwitchBot Lock will use this information to tell whether the door is opened or closed. Please note that the Lock does not realise this function by calling your phone's GPS information but by the internal sensors locating the direction of the magnetic field.

With this feature, we can set up the Door Ajar alert on the notification setting page.



Notification Settings

Door Ajar



27

28

29

Minute

0

30

Second

1

31

2

32

3

33

If the door is not closed after a set amount of time, push notifications will be sent.

We can also create an automatic Scene triggered by the status of the door, opened or closed.

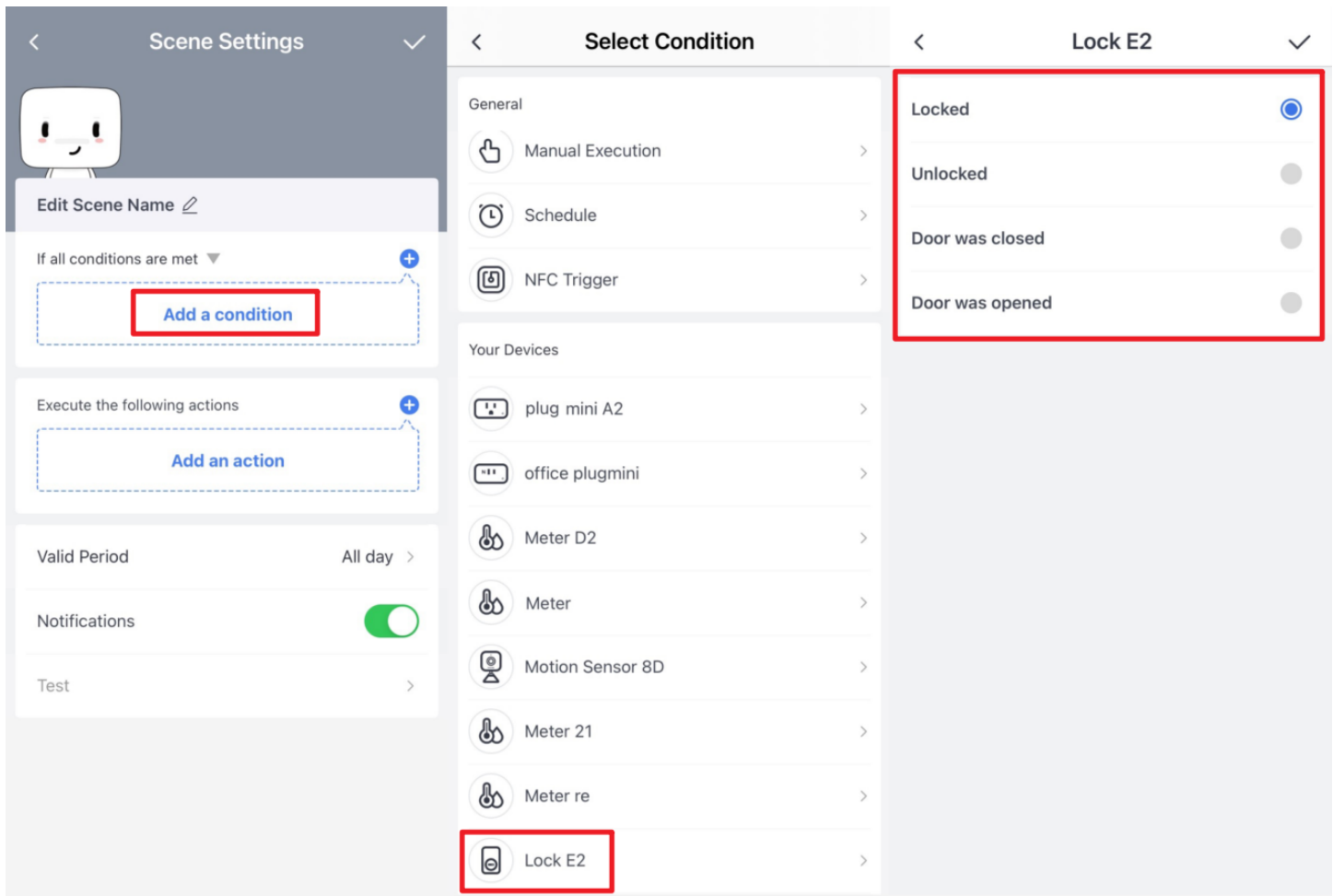

Emergency Unlock Function for the SwitchBot Lock

If the SwitchBot Lock lost the calibration data of locking and unlocking position, we would see it is getting into the status of uncalibrated on the control panel.

Do not panic about this.

We can still tap on the lock icon to control the SwitchBot Lock. But at this point, the Lock will turn the thumbturn clockwise or counterclockwise until it cannot go any further. So the SwitchBot Lock can also lock or unlock the door with its calibration data lost.

But we recommend to re-calibrate the Lock ASAP under this situation.



Calibration error. Please recalibrate.



Not calibrated

Emergency unlock



Logs



Operate the SwitchBot Lock

Tap on the Lock icon on the homepage; we can lock or unlock the door.

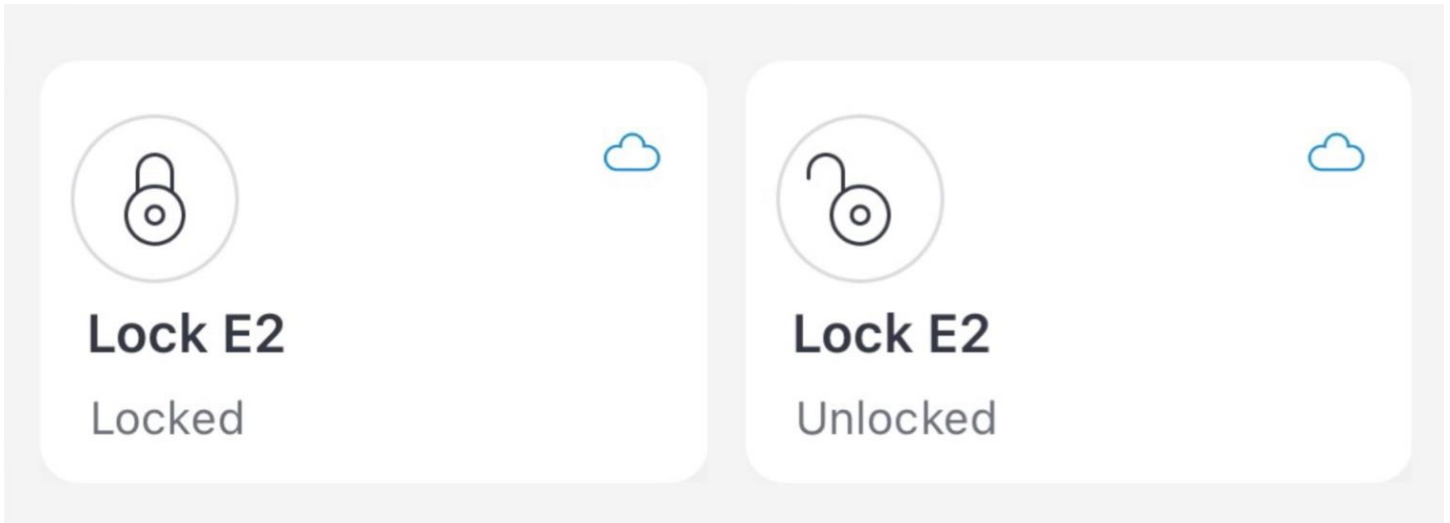

Tap on the name of the SwitchBot Lock to go to the control panel. Then we can tap on the Lock icon in the middle to operate.

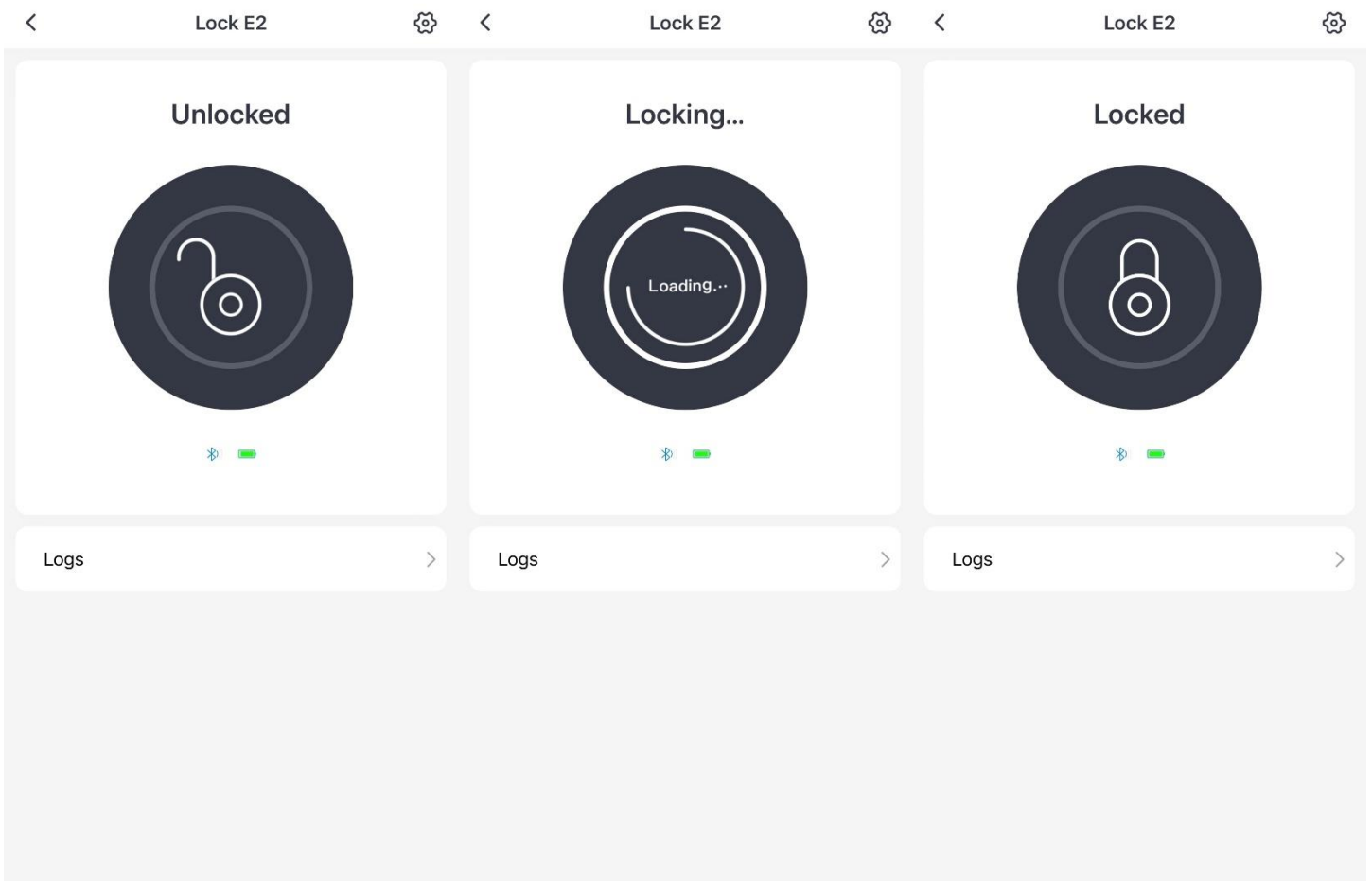

Note:

Please use our cellphone to operate within 5-10m of the SwitchBot Lock, ensuring that the Bluetooth signal is stable and the Lock would respond faster.

Calibrate and Recalibrate the SwitchBot Lock

When installing the Switchbot lock for the first time, we need to manually calibrate it according to the instructions on the app, ensuring that the Switchbot Lock has a record of the locking and unlocking position.

If we want to recalibrate, we can go to the settings page to proceed.

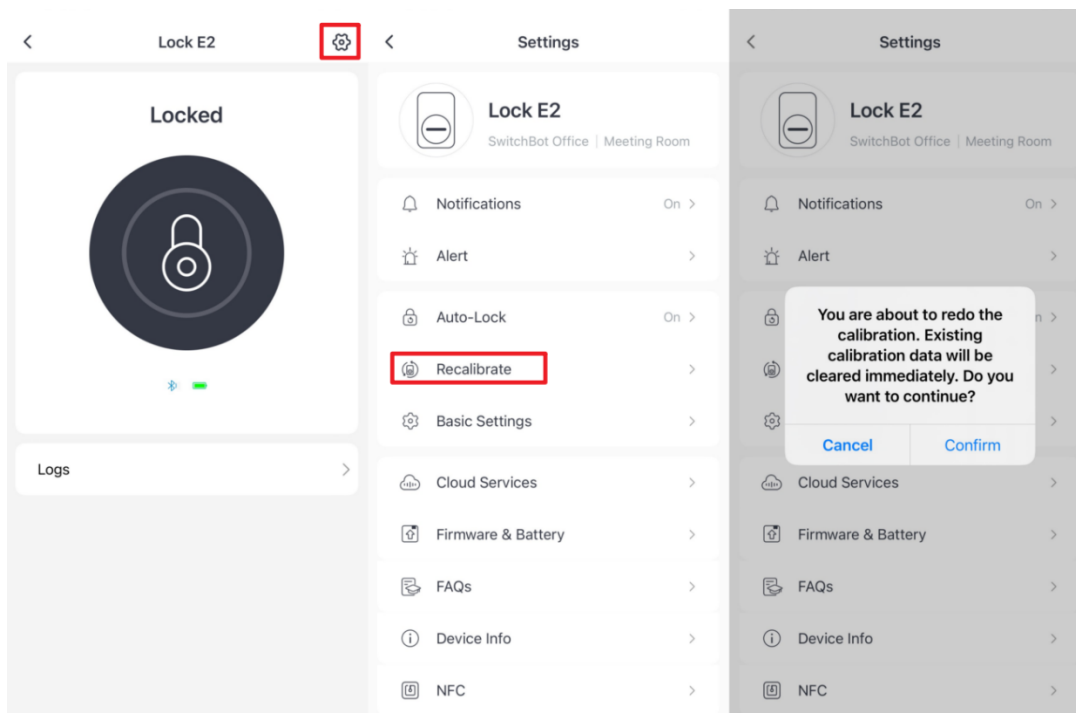

<https://youtu.be/Q7RvZgHcMo0>