

ESAB P-10 Welding Helmet

Passive Welding Helmet



ESAB P-10 Passive Shade 10 Welding Helmet

Welding Processes

- SMAW/MMA (Stick)
- GMAW (MIG/MAG)
- Flux Cored

The ESAB P-10 welding helmet emulates the simple, classic design of a traditional welding helmet with modern features and performance.

The oversized passive shade DIN 10 filter is not only replaceable, it provides a wide viewing area allowing the user to weld with ease. The P-10 also features a lightweight shell and adjustable ratcheting headgear that is easily customizable for all-day comfort.

There is no compromise when it comes to safety, and the ESAB P-10 welding helmet is perfect for those seeking versatile, fixed shade welding protection.

- Large viewing area: 133 x 114 mm (5.25 x 4.5 in.)
- Filter thickness: 3mm (0.12 in)
- Shade: DIN 10
- Easy-adjust ratcheting headgear
- Durable PP shell
- UV/IR protection: DIN 16

Visit esab.com for more information.



P-10 passive helmet front view

ESAB P-10 Welding Helmet

Specifications

Viewing Area	133 x 114 mm (5.25 x 4.5 in.)
Passive Lens Shade	DIN 10
Standards and Certifications	ANSI: Z87.1 CSA: Z94.3
Weight	1.08 lbs (490 grams)

Ordering Information

Description	Part Number
P-10 Passive Shade 10 Welding Helmet	0700102052

Delivery includes: Ready-to-use P-10 Welding Helmet, Safety Manual

Spare Parts

1	P-10 replacement Shade 10 filter lens	0700102051
---	---------------------------------------	------------

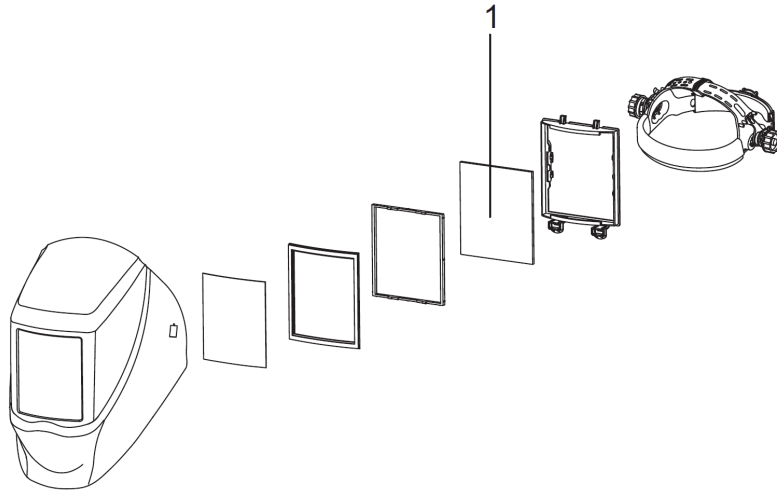

ESAB / esab.com

