

- ALL DIMENSIONS ARE IN INCHES UNLESS SHOWN OTHERWISE
- DIMENSIONS REFERENCING TUBING PLACEMENT IS TO BE USED AS REFERENCE, TUBING SHOULD BE ALIGNED WITH BUMPER BOLTED TO THE VEHICLE
- ALL OUTSIDE CORNER FILET WELDS ARE TO BE CONTINUOUS
- TUBING WELDS ARE TO BE ALL THE WAY AROUND THE TUBING
- IT IS RECOMMENDED TO PREHEAT SHACKLE TABS

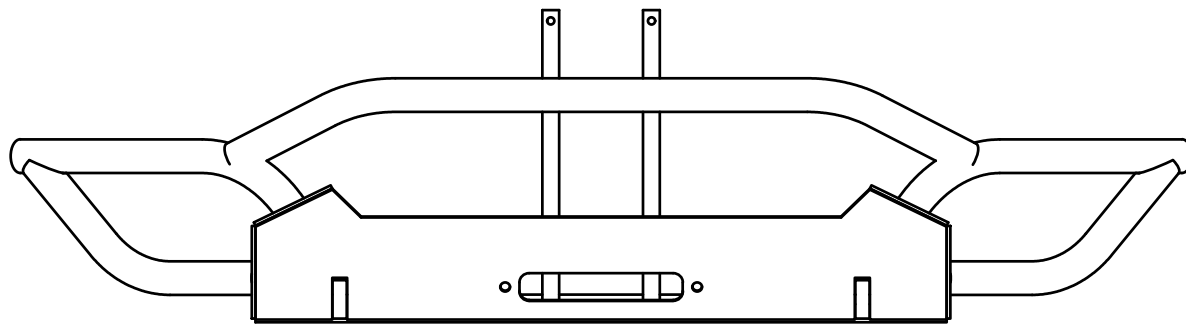
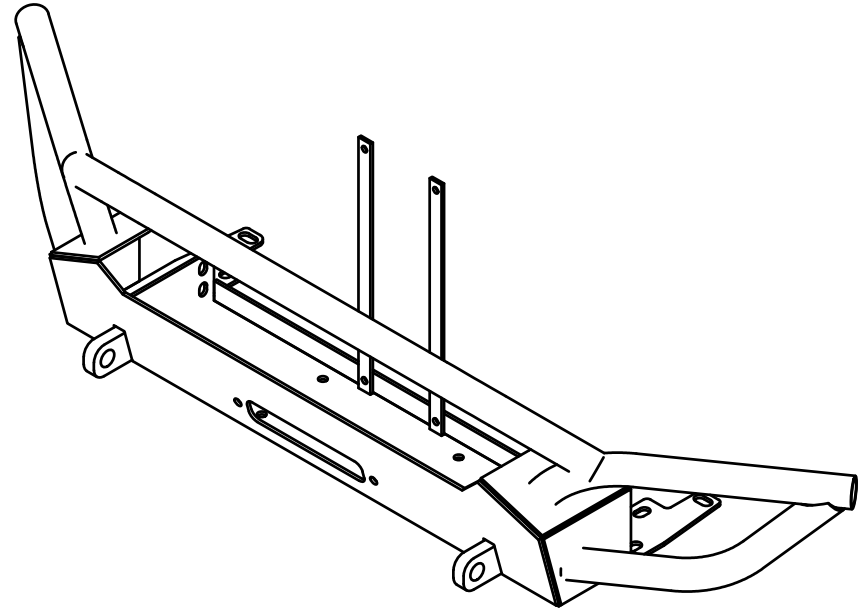

PROJECT

WJ front bumper

TITLE

FRONT BUMPER ASSEMBLY

PROPERTY OF: D.TILLFABWORKS LLC		SIZE A	CODE	DWG NO	REV -
DRAWN	DT	2023	SCALE 1:10	WEIGHT	SHEET 1/6

- TACK WELD ASSEMBLY TOGETHER BEFORE FULLY WELDING JOINTS
- ALL OUTSIDE CORNERS ARE INTENDED TO BE OPEN CORNER JOINTS
- INSTALL PLATES IN ORDER INDICATED BY NOTE NUMBER

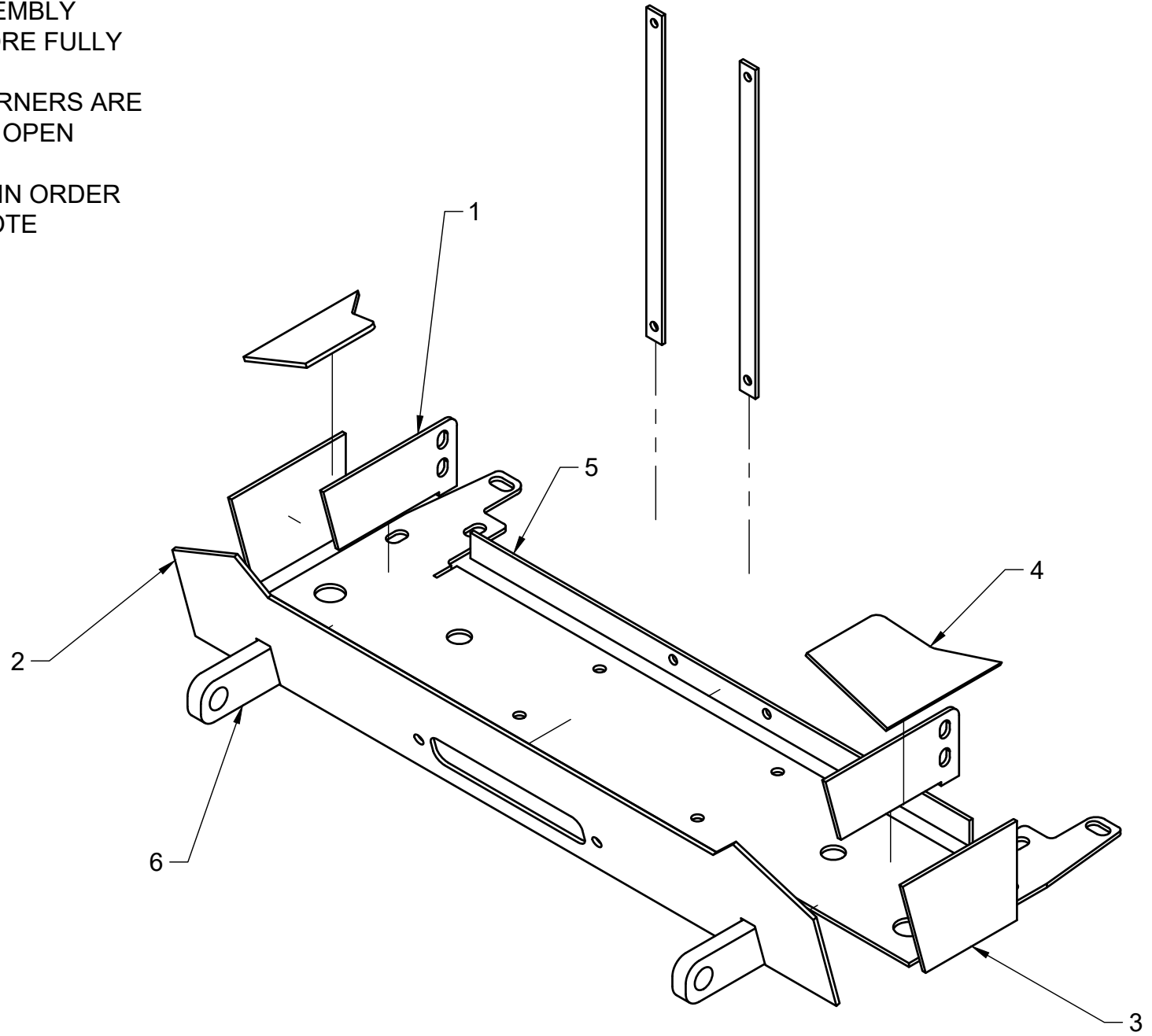



ALIGN TO PROVIDE OPEN
CORNER FOR
FILET WELD

3/8

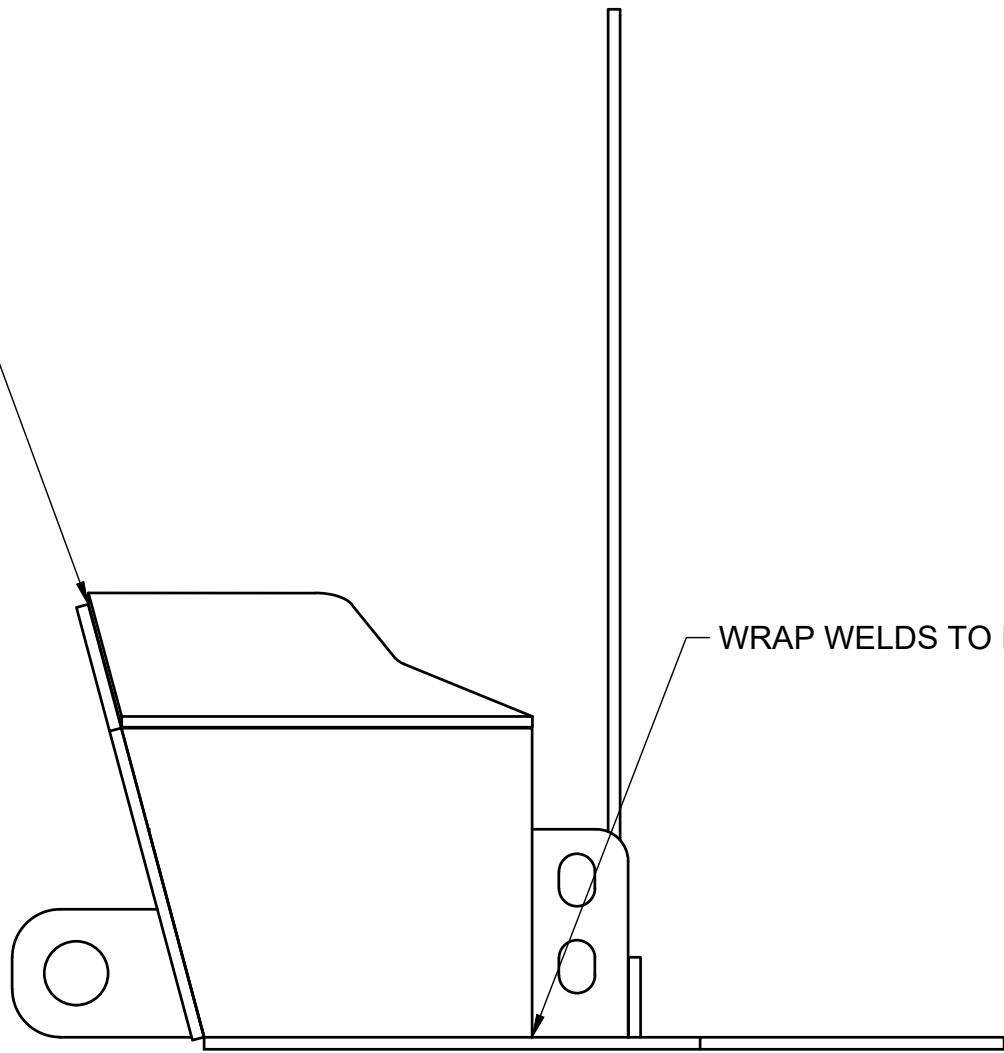

WRAP WELDS TO INSIDE CORNER



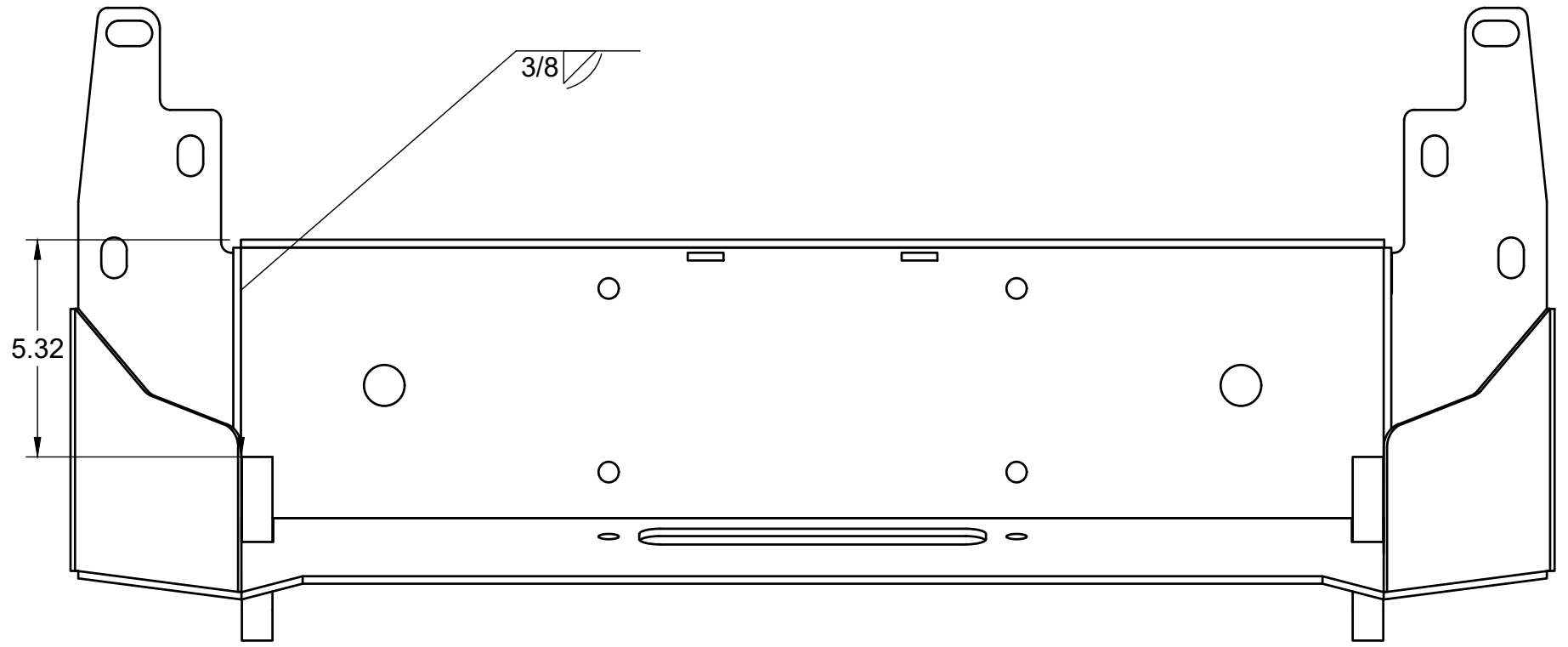

3/8

5.32

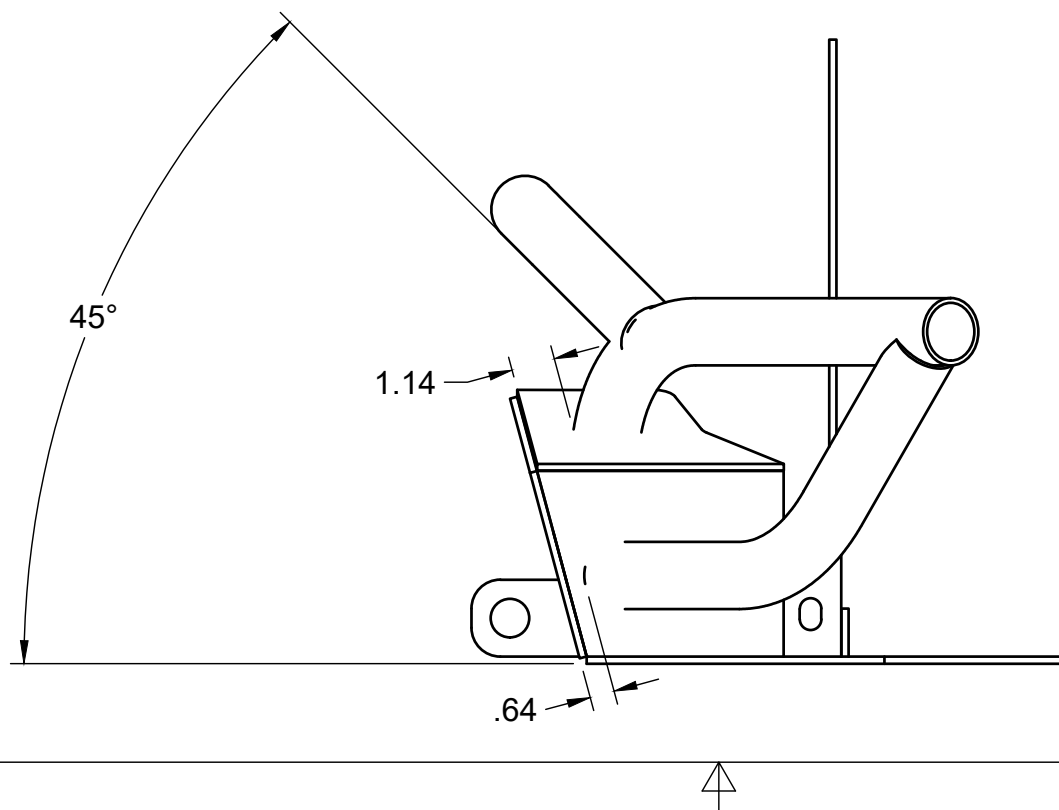
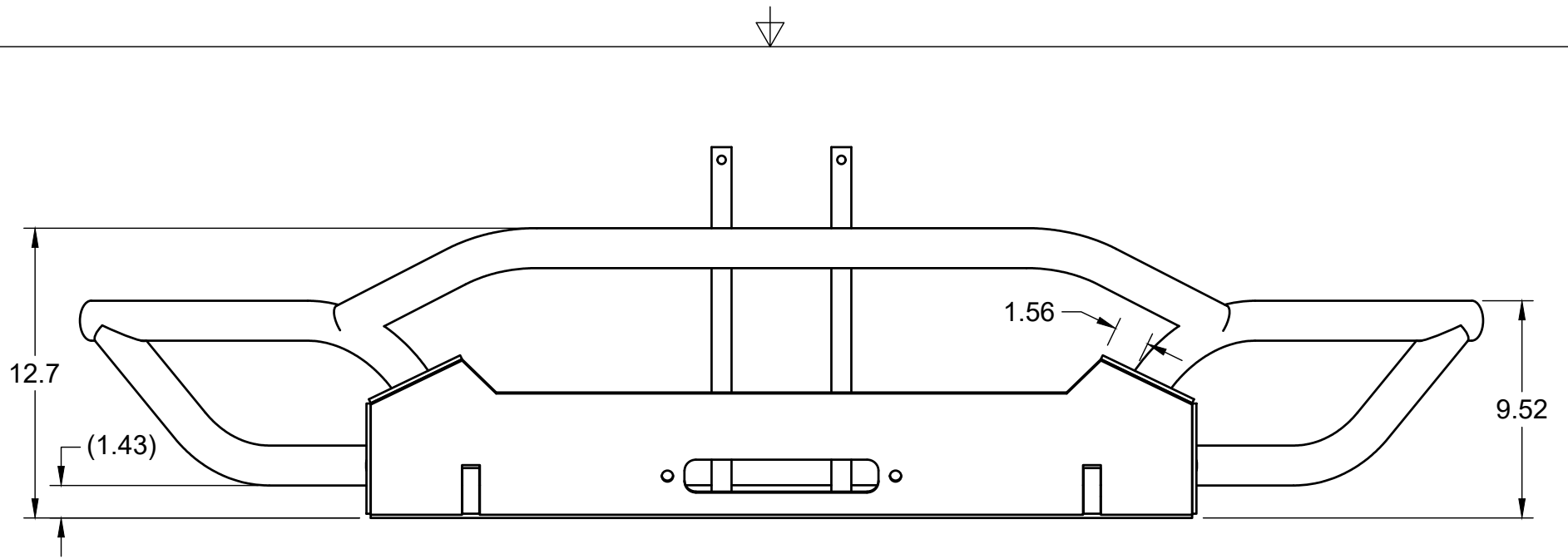

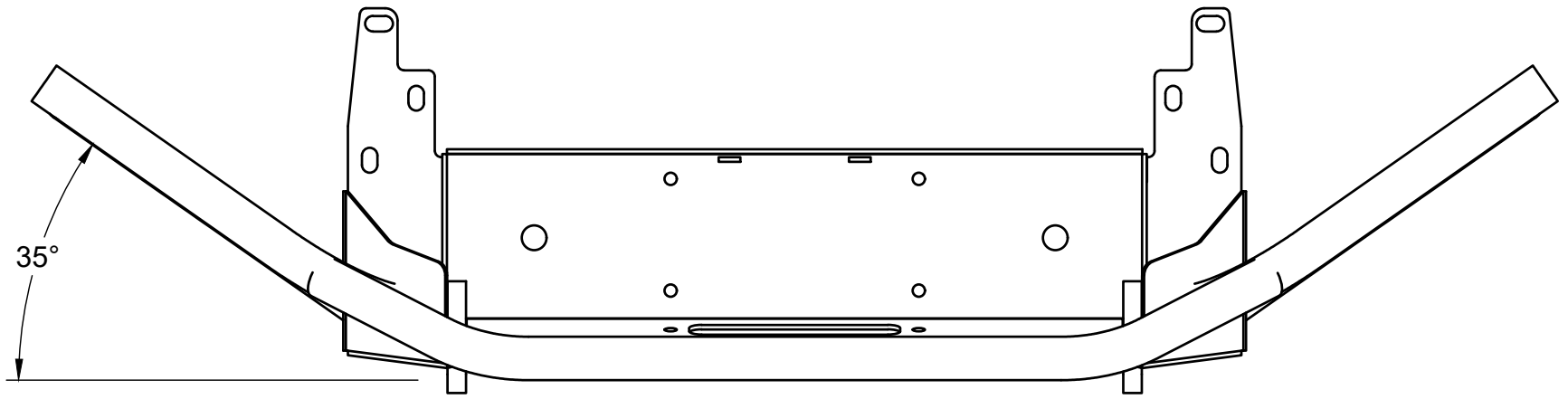

35°