

NPL200-12 (12V200Ah)

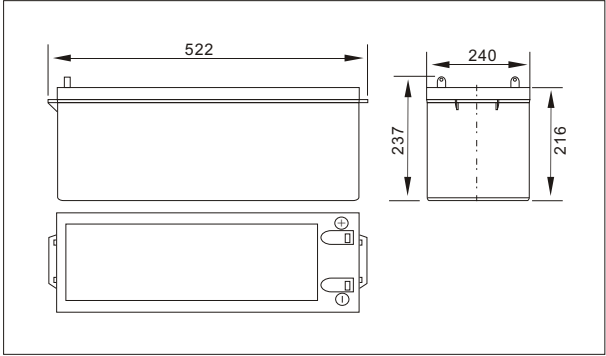

MCA Battery Manufacture Co., Ltd

Outer dimensions (mm)



Specifications

| | | |
|-------------------------------|---------------|---------------------|
| Nominal Voltage | 12V | |
| Rated capacity (10 hour rate) | 200Ah | |
| Dimensions | Total Height | 237mm (9.29 inches) |
| | Height | 216mm (8.50 inches) |
| | Length | 522mm (20.6 inches) |
| | Width | 240mm (9.45 inches) |
| Weight Approx | 59Kg (130lbs) | |

Terminal Type (mm)

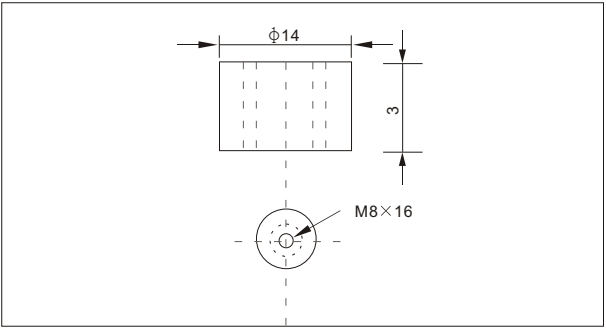

Characteristics

| | | |
|--|------------------------------------|--|
| Capacity 25°C(77°F) | 20 hour rate(10.5A) | 210AH |
| | 10 hour rate(20A) | 200AH |
| | 5 hour rate(34A) | 170AH |
| | 3 hour rate(50A) | 150AH |
| | 1 hour rate(110A) | 110AH |
| Internal Resistance | Full charged Battery at 25°C(77°F) | 1 mΩ |
| Capacity affected by Temperature (10hour rate) | 40°C(104°F) | 102% |
| | 25°C(77°F) | 100% |
| | 0°C(32°F) | 85% |
| | -15°C(5°F) | 65% |
| Self-Discharge at 25°C(77°F) | Capacity after 3 month storage | 91% |
| | Capacity after 6 month storage | 82% |
| | Capacity after 12 month storage | 64% |
| Terminal | T11, T19 | |
| Charge (constant Voltage) | Cycle | Initial Charging Current less than 60A Voltage 14.5-14.9V |
| | Float | Voltage 13.6-13.8V |

Discharge Curves 25°C(77°F)

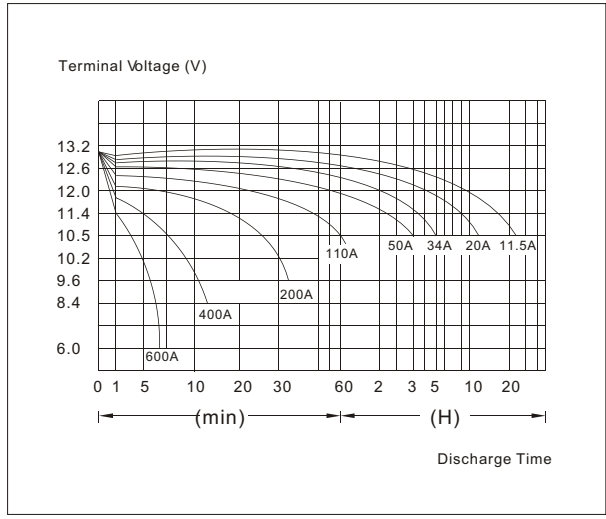

Constant Current (Amp) and Constant Power(Watt) Discharge Table at 25°C(77°F)

| Time | | 5min | 10min | 15min | 30min | 1h | 2h | 3h | 4h | 5h | 8h | 10h | 20h |
|-------|---|------|-------|-------|-------|-------|------|------|------|------|------|-------|-------|
| 9.6V | A | 740 | 540 | 380 | 230 | 120 | 70 | 51.4 | 40.0 | 33.0 | 23.3 | 21.0 | 11.34 |
| | W | 7858 | 5735 | 4036 | 2443 | 1390 | 811 | 595 | 463 | 382 | 269 | 243 | 131.3 |
| 10.2V | A | 652 | 492 | 340 | 218.0 | 112.8 | 66.8 | 50.0 | 39.0 | 32.4 | 22.8 | 20.5 | 11.06 |
| | W | 7237 | 5461 | 3774 | 2420 | 1306 | 774 | 579 | 452 | 375 | 264 | 237 | 128.1 |
| 10.5V | A | 628 | 468 | 320 | 212 | 109 | 65.2 | 48.8 | 38.4 | 32.0 | 22.6 | 20.0 | 10.92 |
| | W | 7122 | 5307 | 3628 | 2404 | 1265 | 755 | 565 | 445 | 371 | 262 | 234 | 126.5 |
| 10.8V | A | 604 | 444 | 300 | 206 | 106 | 63.6 | 47.6 | 37.8 | 31.2 | 22.0 | 19.5 | 10.80 |
| | W | 7031 | 5168 | 3492 | 2398 | 1229 | 740 | 554 | 435 | 363 | 256 | 233 | 125.7 |
| 11.1V | A | 580 | 420 | 280 | 200 | 102 | 62.0 | 46.0 | 36.7 | 30.4 | 21.4 | 19.00 | 10.26 |
| | W | 6902 | 4998 | 3332 | 2380 | 1214 | 738 | 547 | 433 | 362 | 255 | 226 | 122.1 |

The data is generally descriptive only for reference.

Long-life Design

Discharge Characteristics

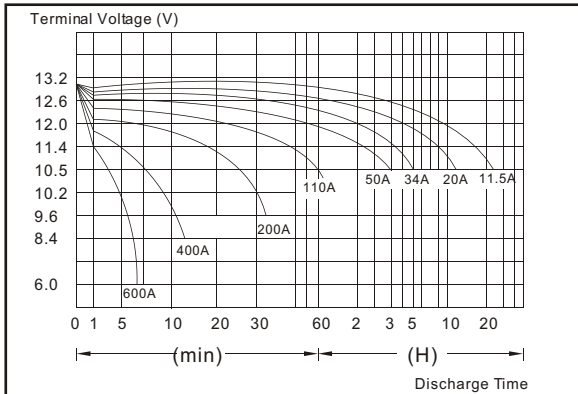

Constant Voltage Charging Characteristics (0.25CA 25 °C)

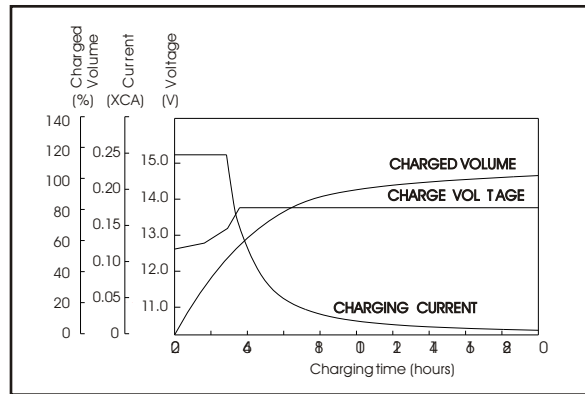

Relationship between Charging voltage and Temperature

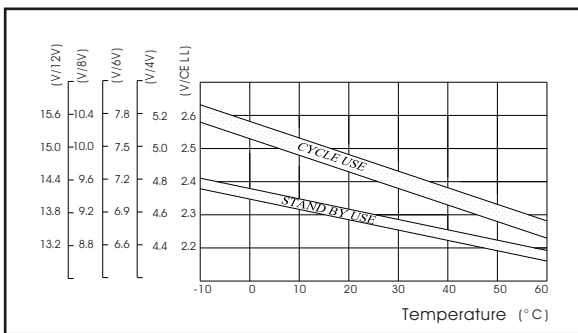

Self-discharge Characteristics

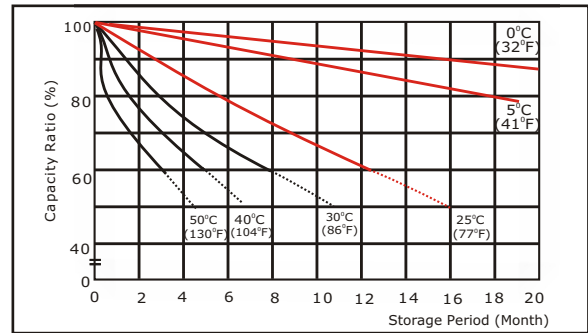

Float service life

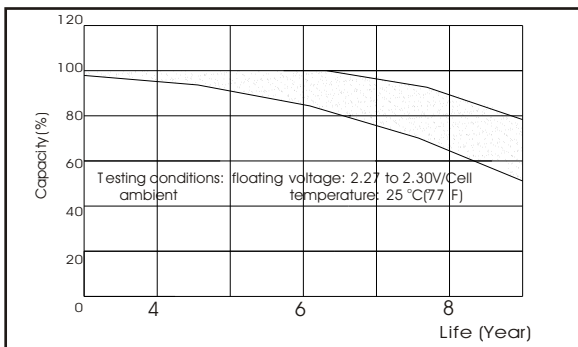

Cycle service life @ different DOD

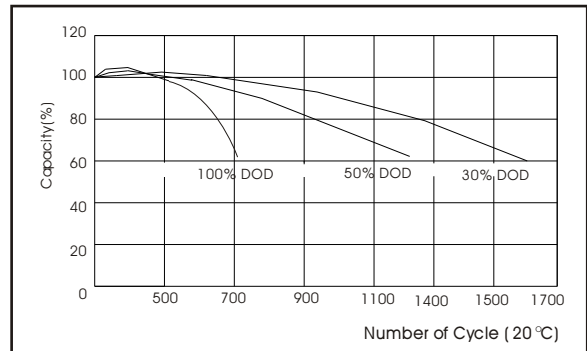

Temperature Effects on Float Life

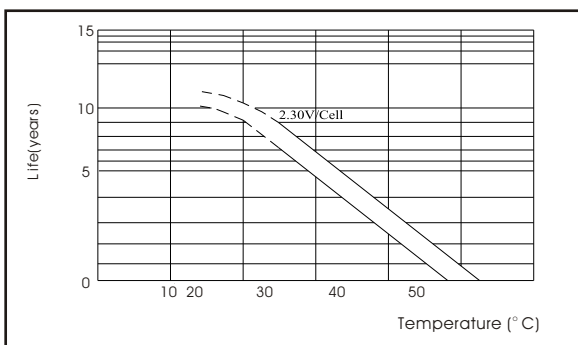

Temperature Effects on Capacity

