

US Air 737-400



The venerable 737-400 has been flying since 1988 and continues to serve U.S. Air mostly in the dense traffic corridors of the eastern United States.

The extra 10 feet added to the fuselage enabled the 737-400 to carry up to 170 passengers. The added carrying capacity along with the fuel efficient CFM-56 engines has enabled the 737-400 to continue flying revenue passenger service after most first generation 737 aircraft have been retired from service.

This new kit features the latest color scheme representing the current flying fleet of US Airways 737-400 aircraft

Minicraft Models, 1501 Commerce Drive, Elgin IL 60123 USA
www.minicraftmodels.com

Printed in China

14640

PARTS LAYOUT DIAGRAM

1

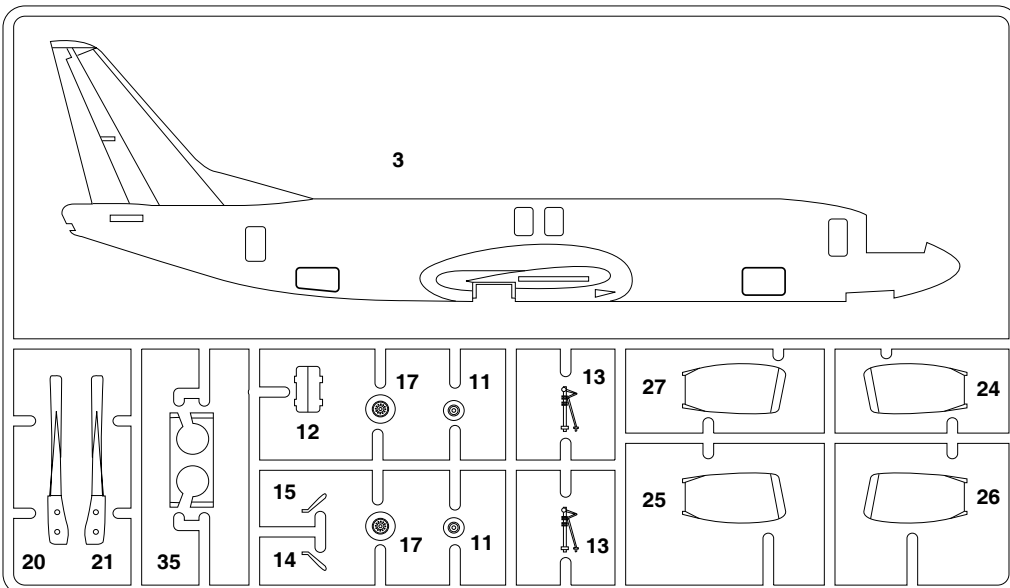
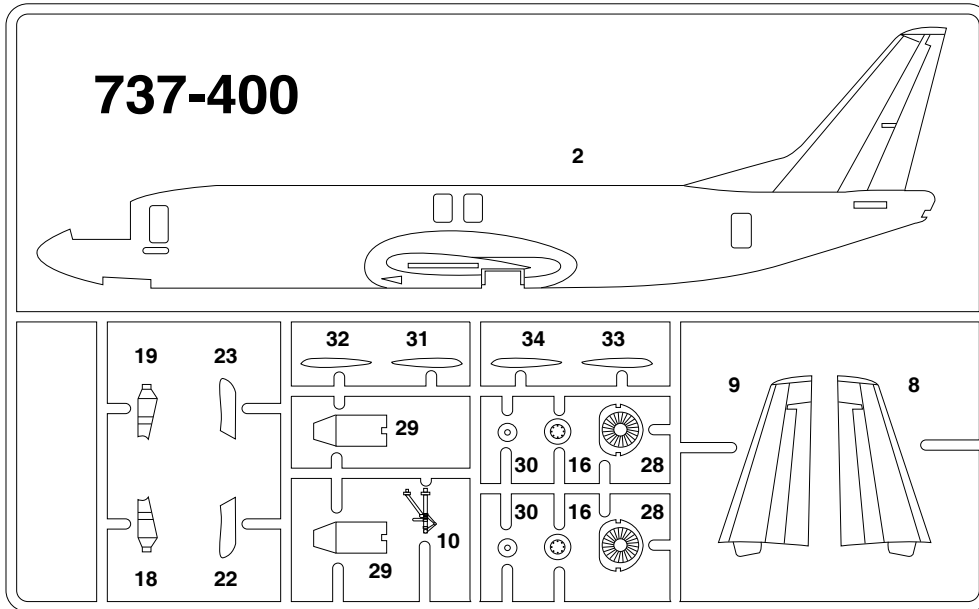
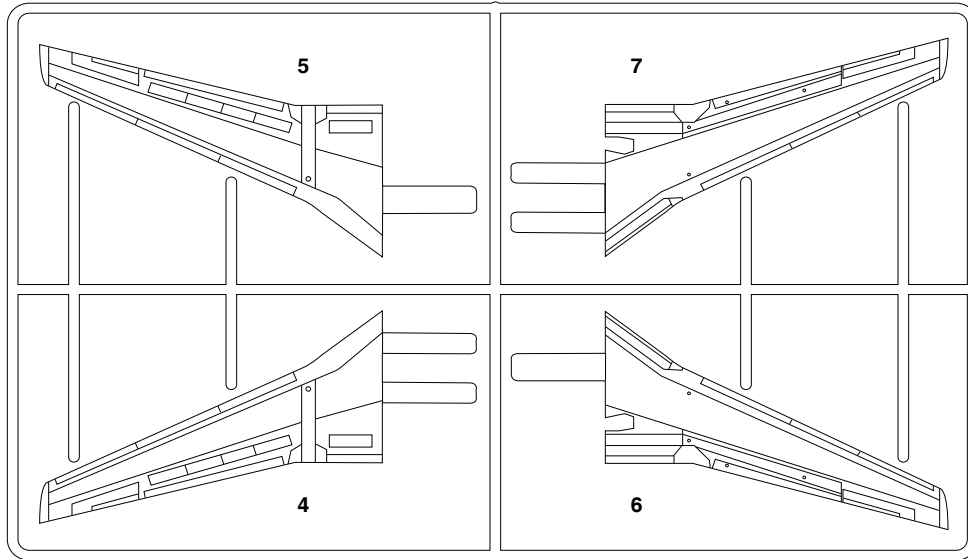
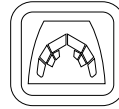

4 FLAP GUIDES

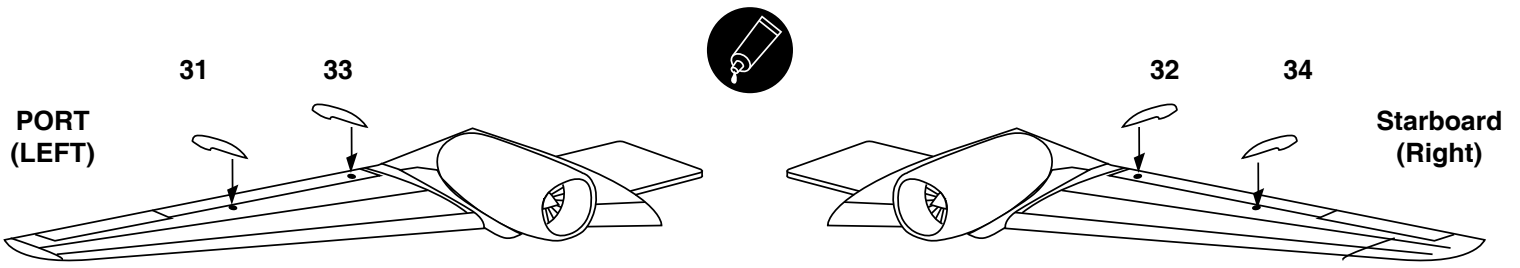

5 MAIN ASSEMBLY

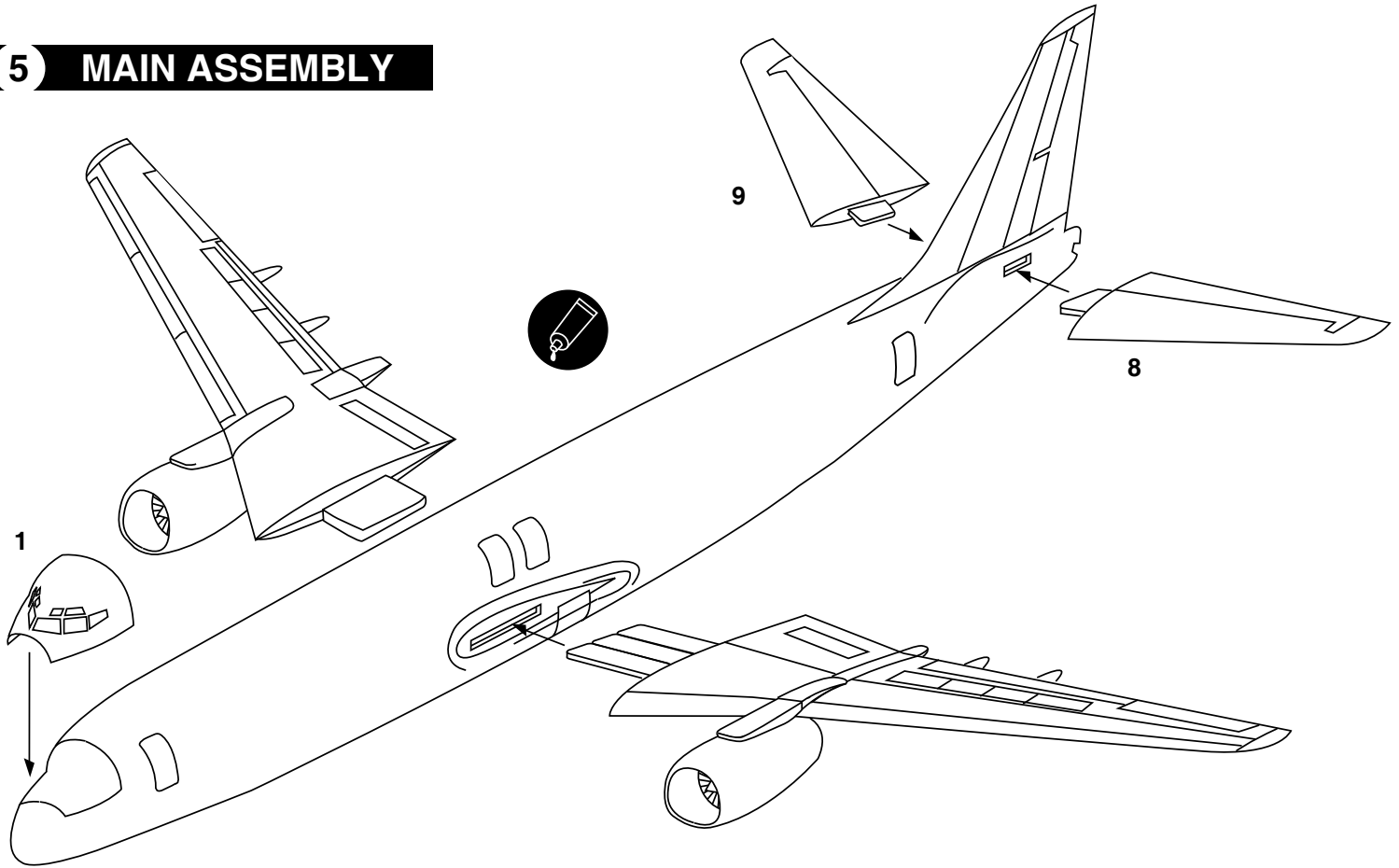

6 LANDING GEAR

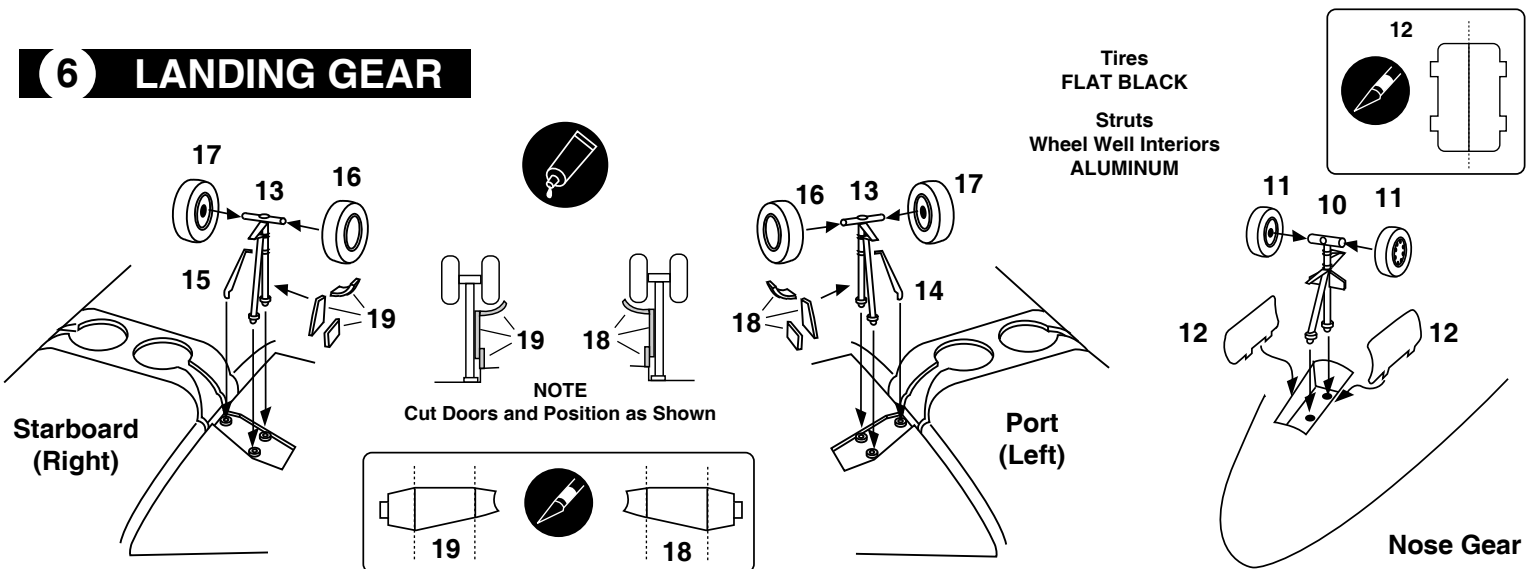



Cement
Coller
Kleben
Pegar
Incollare
Colar
Kleven



DO NOT Cement
Ne pas Coller
Nicht Kleben
No Pegar
Non Incollare
Nao Colar
Niet Kleven



Cut away
Couper
Scheiden
Cortar
Tagliere
Cortar
Snijden



Optional parts
Choix
Auswahlmoglichkeit
Eleccion
Scelta
Opaco
Keuze

1 FUSELAGE ASSEMBLY

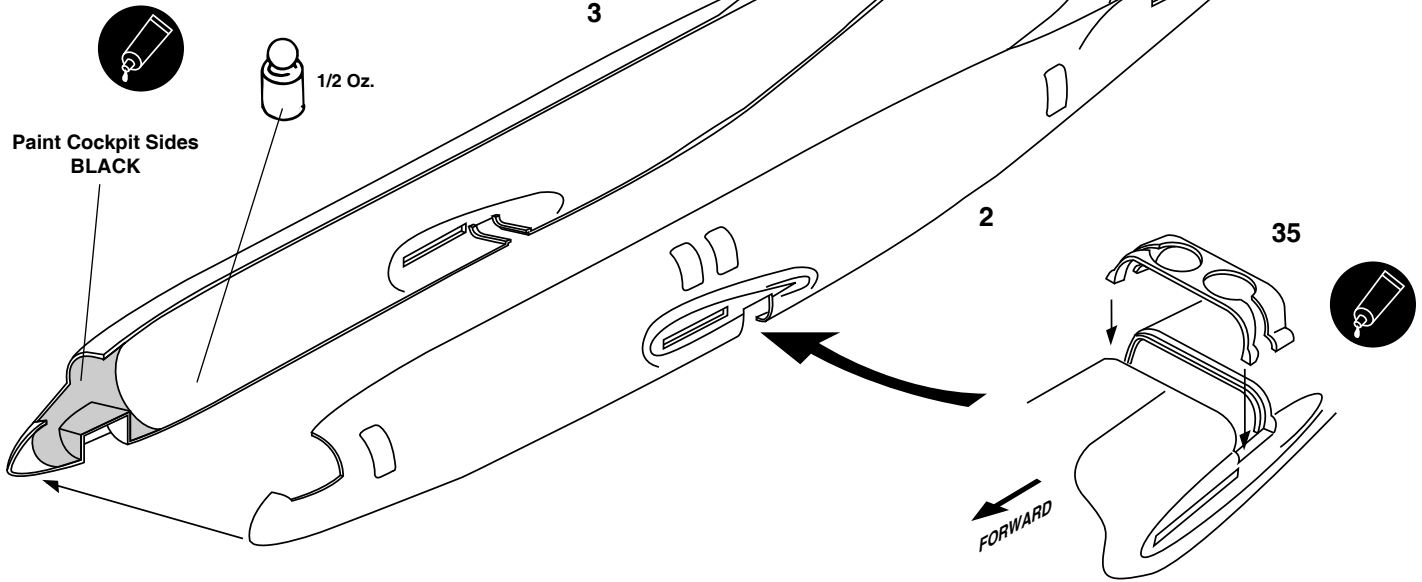

2 ENGINE/PYLON ASSEMBLY

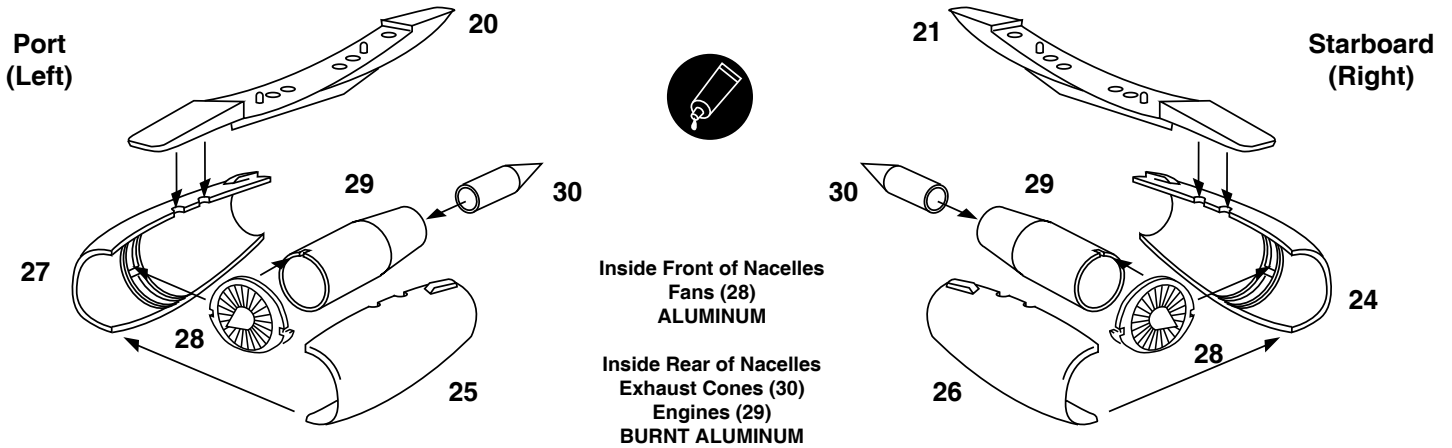

3 WING ASSEMBLY

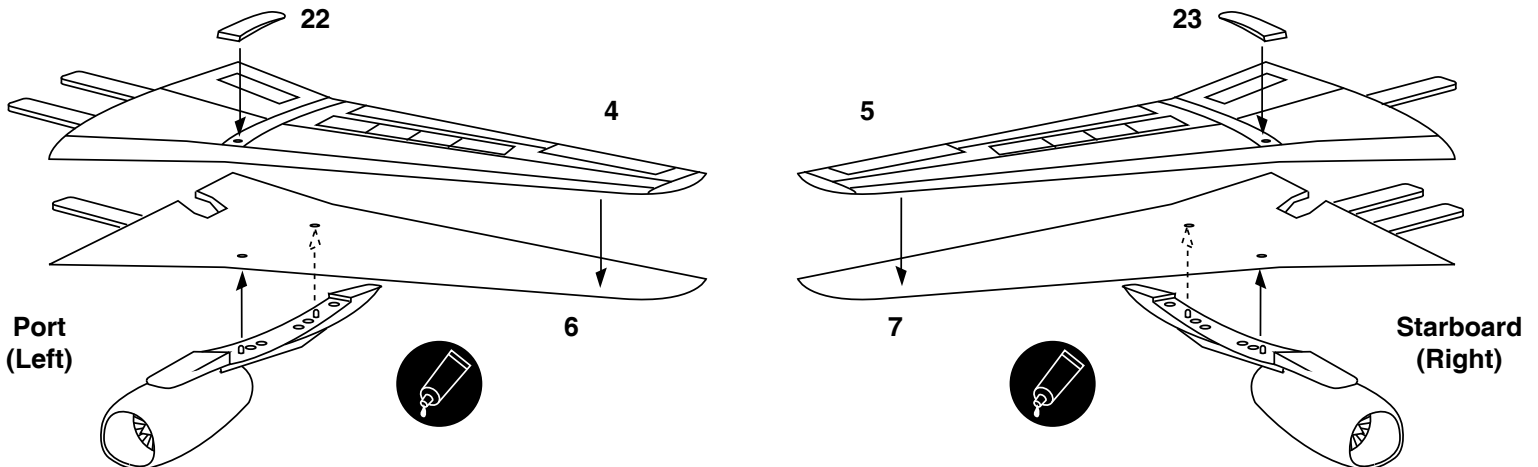

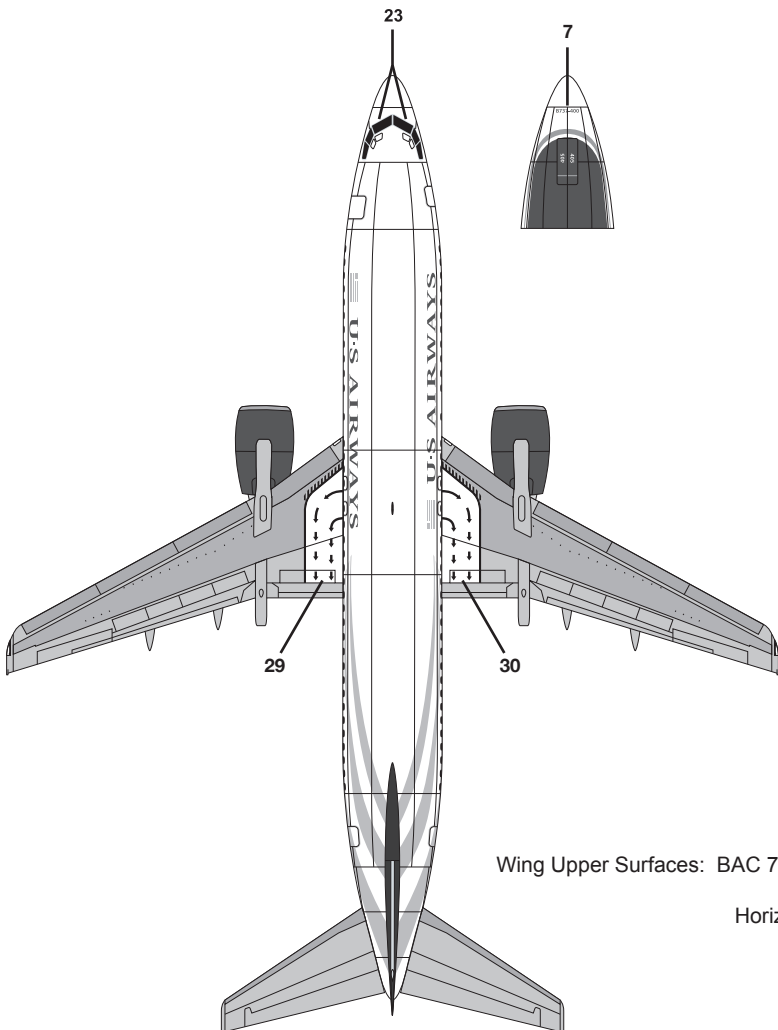
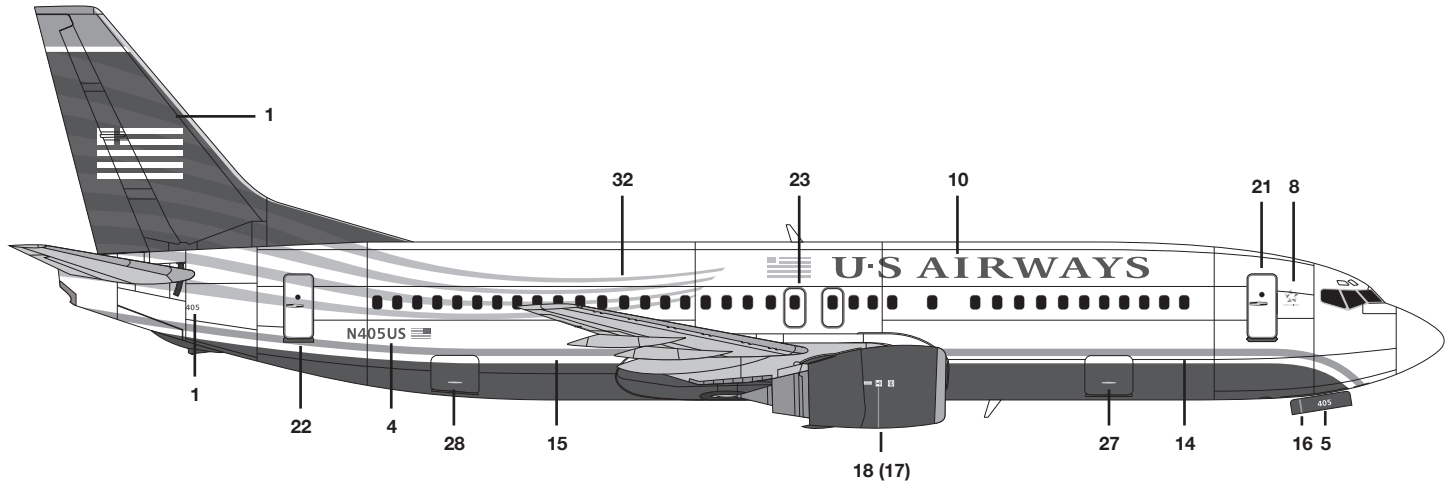
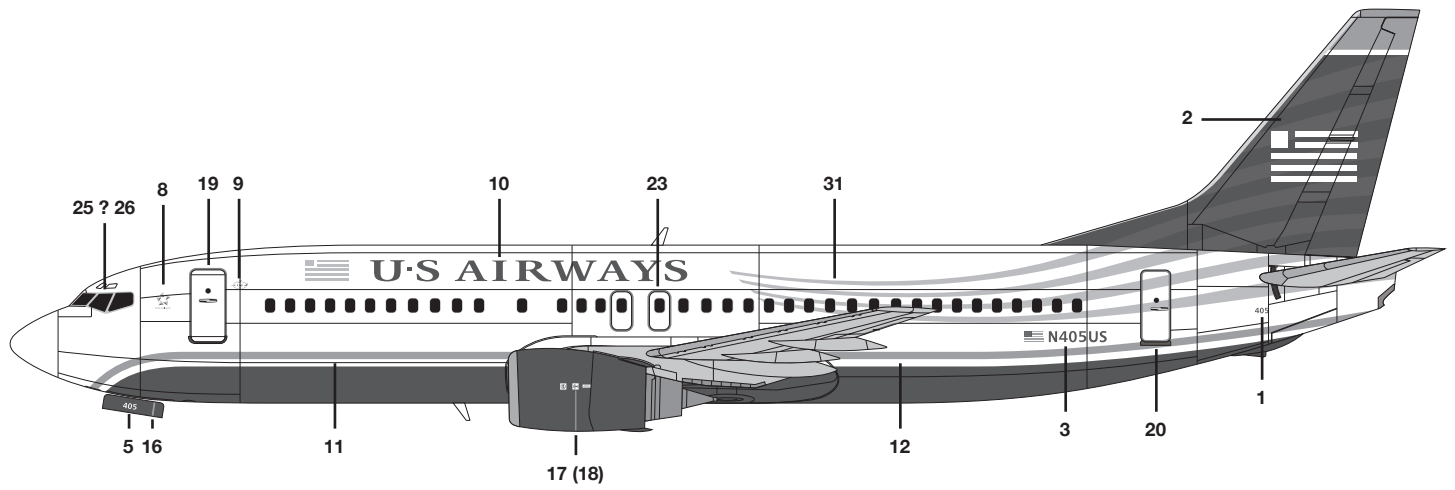

- Upper Fuselage: Gloss White
- Lower Fuselage & Engine Nacelles: Dark Blue (match to decal)
- Wing Upper Surfaces: BAC 707 Gray (FS 16515) with Coroguard inspar area, dull natural metal leading edges
- Wing Lower Surfaces: BAC 707 Gray (FS 16515)
- Horizontal Stabilizers: BAC 707 Gray (FS 16515) with dull natural metal leading edge
- Vertical Fin: Dull natural metal leading edge
- Engine Nacelles: Dull natural metal intake lip