

B-17 Bit o'Lace



A Bit o Lace was a Vega-Built B-17G operated by the 709th Bomb Squadron, 447th Bomb Group of the U.S. 8th Air Force in England. The nose art was based on a character created by the renowned illustrator and cartoonist, Milton Caniff of Dayton Ohio, better known for his syndicated comic strip “Terry and the Pirates”. Miss Lace was featured in the strip “Mail Call”, printed in the army newspapers.

During one of the missions of this Flying Fortress one wing was severely damaged and a replacement from another damaged B-17 was spliced to the left wing. As a result, the plane carries both natural metal finish and the camouflaged, though badly weathered, outer wing panel at this point in its service life.

Minicraft Models, 1501 Commerce Drive, Elgin IL 60123 USA
www.minicraftmodels.com

Your MINICRAFT B-17G may be assembled with various options, such as 'In-flight' features as retracted landing gear and 'spinning' propellers. Parts are also provided for a 'stationary' or 'ground' version with extended landing gear. Please review the assembly steps to become familiar with the parts before beginning assembly.

PARTS LAYOUT DIAGRAM

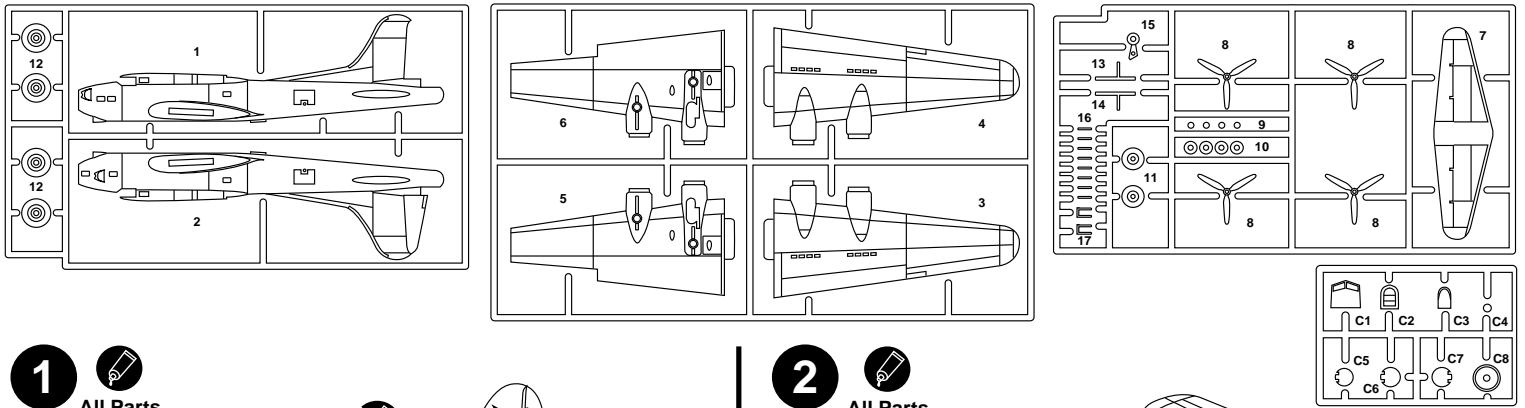

1

All Parts except as noted

Cockpit interior INTERIOR GREEN
 Tailwheel strut ALUMINUM
 Tire FLAT BLACK-GRAY

2

All Parts

3

All Parts

4 IN-FLIGHT VERSION

All Parts

NOTE
 Tailwheel in retracted position

4X 9 10 12

Struts ALUMINUM
 Tires FLAT BLACK-GRAY

5 STATIONARY VERSION

All Parts except as noted

NOTE
 Tailwheel in extended position

4X 8 10 12

Struts ALUMINUM
 Tires FLAT BLACK-GRAY
 Propellers FLAT BLACK with YELLOW tips

6

All Parts

Machine guns GUNMETAL

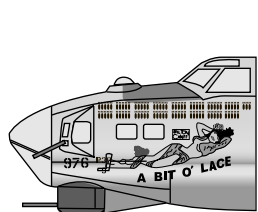
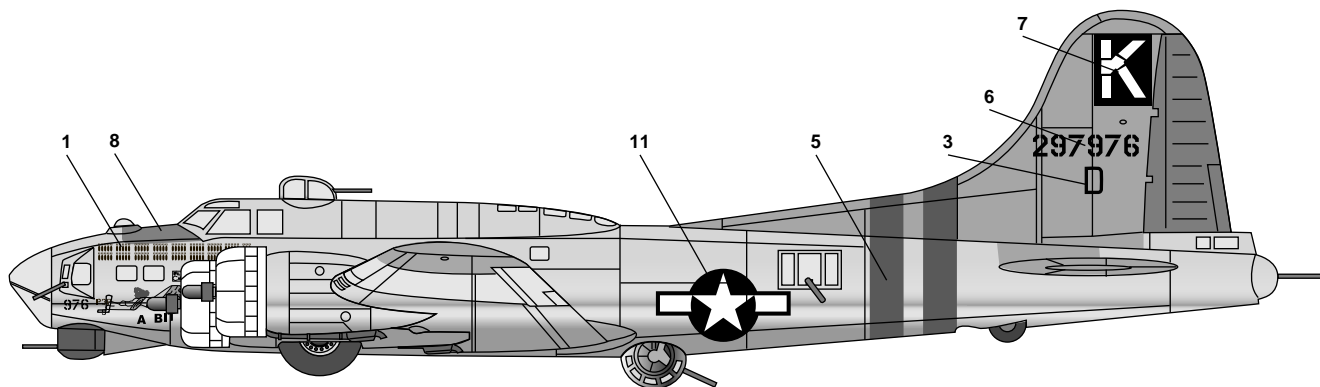

Nose detail

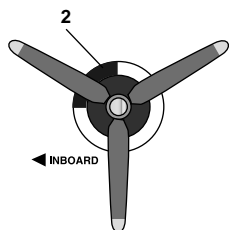

Typical engine front.
Propellers Flat Black
with Yellow tips

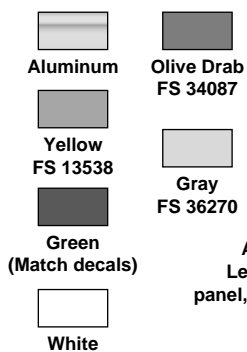

Aircraft is overall Aluminum finish.
Left wing outer panel is a replacement
panel, upper surface is weathered Olive Drab,
lower surface weathered Gray.

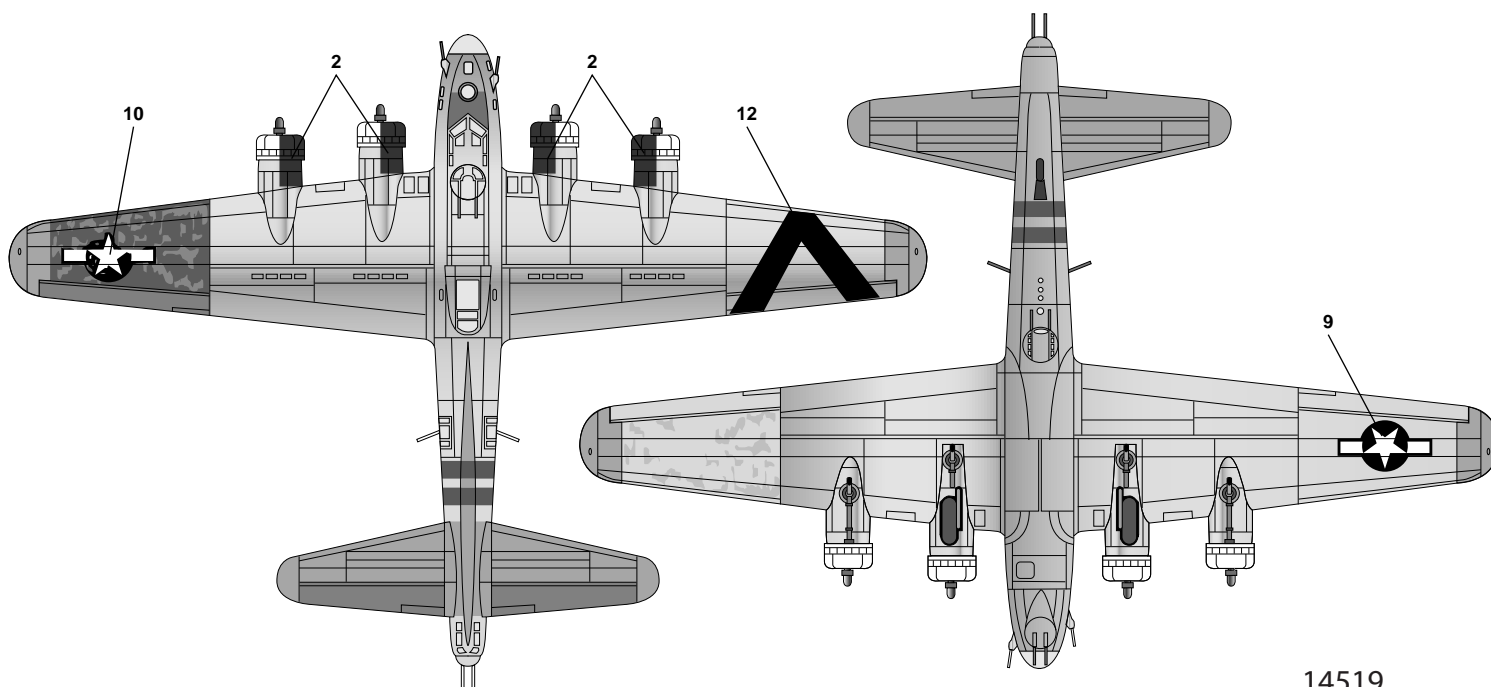
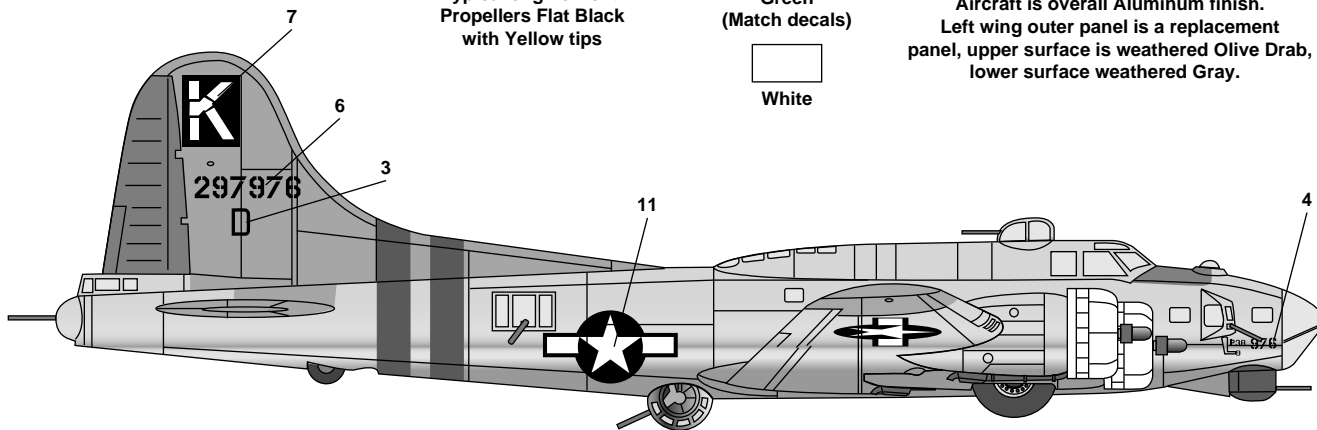

Your Minicraft model includes high-quality waterslide decals. These decals adhere best to a glossy surface; and it is recommended that you apply a clear gloss coat over your painted model.

Use a sharp scissors or knife to cut individual decals from the carrier sheet. Do not cut into the clear film surrounding the individual decals.

* It is recommended that you apply one decal at a time.

* Place the decal section in warm water, when first inserted in the water your decal will curl, after approximately ten seconds the decal will uncurl. Remove from water and lay on a paper towel. After approximately 10 - 20 seconds the decal will slide freely from the backing paper. Use a small brush to help slide the decal from the backing paper and into position on the model. Carefully blot excess water from the decal, using care not to move the decal or tear it.

* If you choose to use a setting solution, apply a thin coat over the decal following the manufacturer's instruction.

* Allow the decal to dry overnight. Wash any adhesive residue off the model with a small amount of clean water and dry thoroughly.

* Apply clear gloss, matte or flat coat to seal decals following the instructions from the manufacturer.



Legends in the making™

Visit our Website-
www.minicraftmodels.com

Minicraft Models
1501 Commerce Drive
Elgin, IL 60123

Phone: 847-429-9676