



The Ford Model A of 1928–1931 also called the “A-bone” among rodders and customizers, was the second huge success for the Ford Motor Company, after its predecessor, the Model T. During the 1940’s and early 50’s, the Model “A” was a reliable, inexpensive car that proved to be ideal for customizing. With creativity and ingenuity, the Model A’s were often customized with the addition of new engines and custom parts that added style and performance to suit their owner’s tastes. The new Minicraft Hot Rod Roadster captures the spirit of that era with custom wheels and tires, a flat-head V-8 engine and many custom chrome parts.

#### **Decal Application:**

Your Minicraft model includes high-quality waterslide decals. These decals adhere best to a glossy surface. Use a sharp scissors or knife to cut individual decals from the carrier sheet. Do not cut into the clear film surrounding the individual decals. It is recommended that you apply one decal at a time. Place the decal section in warm water, when first inserted in the water your decal will curl, after approximately ten seconds the decal will uncurl. Remove from water and lay on a paper towel. After approximately 10 - 20 seconds the decal will slide freely from the backing paper. Use a small brush to help slide the decal from the backing paper and into position on the model. Carefully blot excess water from the decal, using care not to move the decal or tear it. If you choose to use a setting solution, apply a thin coat over the decal following the manufacturer’s instruction. Allow the decal to dry overnight. Wash any adhesive residue off the model with a small wet towel.

**[www.minicraftmodels.com](http://www.minicraftmodels.com)**

***Minicraft Models (USA) LLC***  
***2136 12th Street Rockford, IL. 61104 847-429-9676***  
***Printed in China***





# BEFORE BEGINNING ASSEMBLY

Your MINICRAFT "Hot Rodney" model contains a wealth of highly detailed parts. Please take a moment to read the instruction sheet to become familiar with the parts before beginning assembly.

**Be sure to test the fit of all parts before gluing.**

**Remove the plating from the custom 'chromed' parts in the areas where glue will be applied.**

**Note and follow instruction icons shown below.**

|   |   |   |  |  |
|---|---|---|--|--|
| <br><b>Cement</b><br>Coller<br>Kleben<br>Pegar<br>Incollare<br>Colar<br>Kleven | <br><b>DO NOT Cement</b><br>Ne pas coller<br>Nicht Kleben<br>No pegar<br>Non collare<br>Nao colar<br>niet kleven | <br><b>Optional</b><br>Choix<br>Auswahlmöglichkeit<br>Eleccion<br>Scelta<br>Opcao<br>Keuze | <br><b>Cut away</b><br>Couper<br>Scheiden<br>Cortar<br>Tagliare<br>Cortar<br>Sniden | <br><b>Repeat operation</b><br>Répéter l'opération<br>Vorgang wiederholen<br>Repetir la operacion<br>Ripetere<br>Repetir a operacao<br>Herhalen |
|---|---|---|--|--|

**B 1 ~ 2 (Gray)**

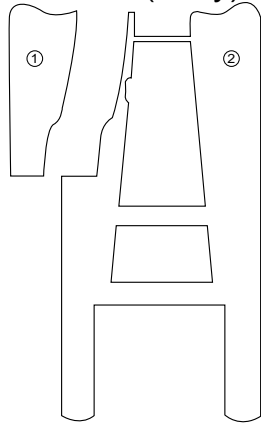

**C 1 ~ 9 (Gray)**

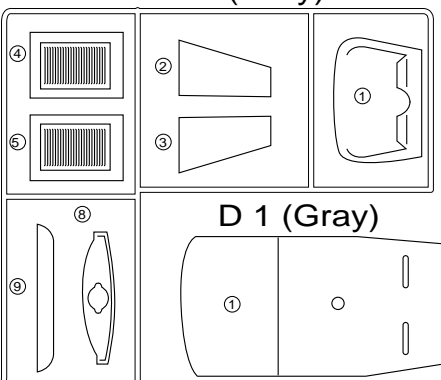

**E 1 ~ 26 (Black)**

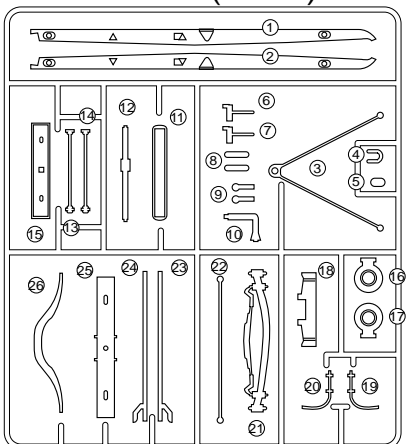

**D 1 (Gray)**

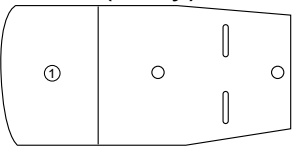

**I 1 ~ 5 (Clear)**

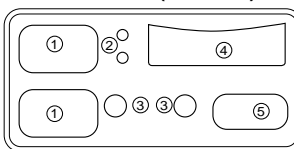

**G 18 ~ 21 (Black)**

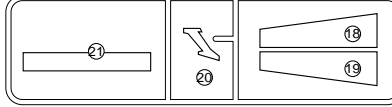

**L 1 ~ 16 (Gray)**

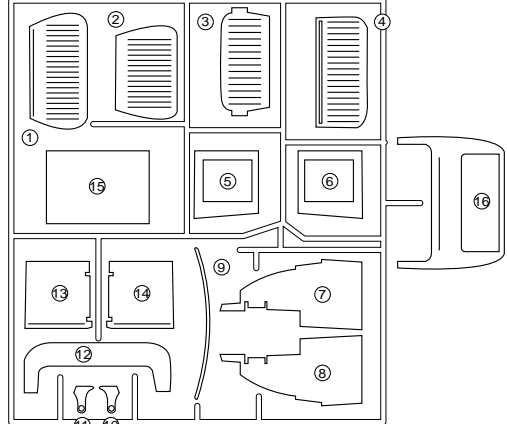

**M 1 ~ 3 (Clear)**

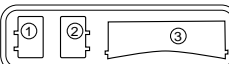

**J 1 ~ 35 (Plated)**

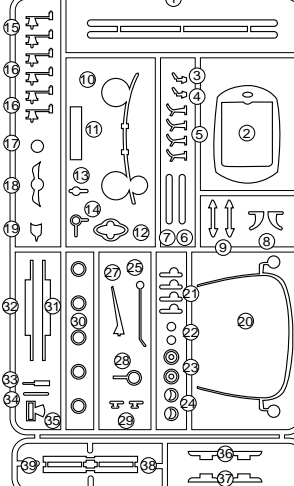

**P Sprue 1 (Plated)**

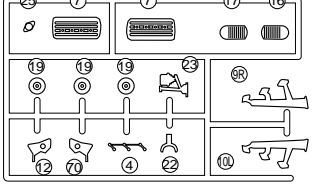

**F 1 ~ 29 (Black)**

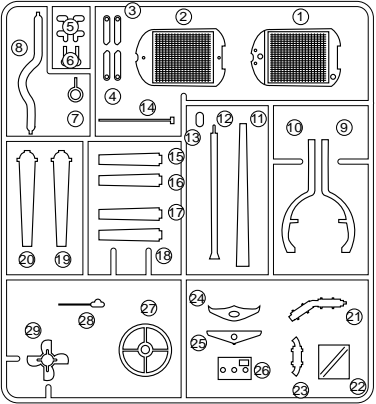

**Q Sprue 1 (Plated)**

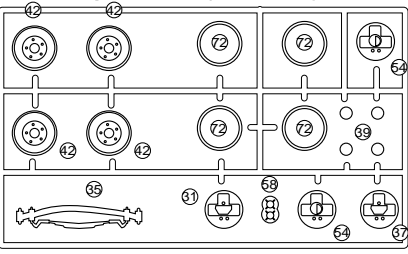

**P Sprue 2 (Black)**

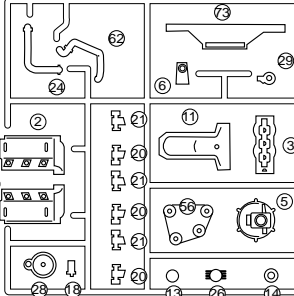

**Q Sprue 2 (Plated)**

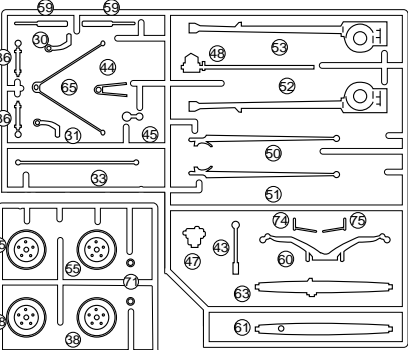

**M 4 ~ 16 (Plated)**

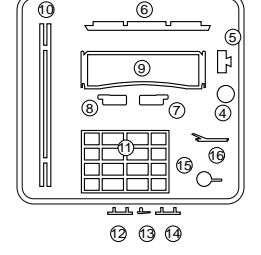

Tires

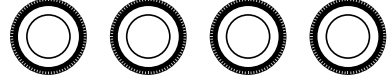

Hinge Pins      Axle

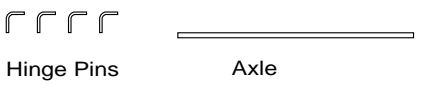

**NOTE**  
Some parts included will not be used for this model

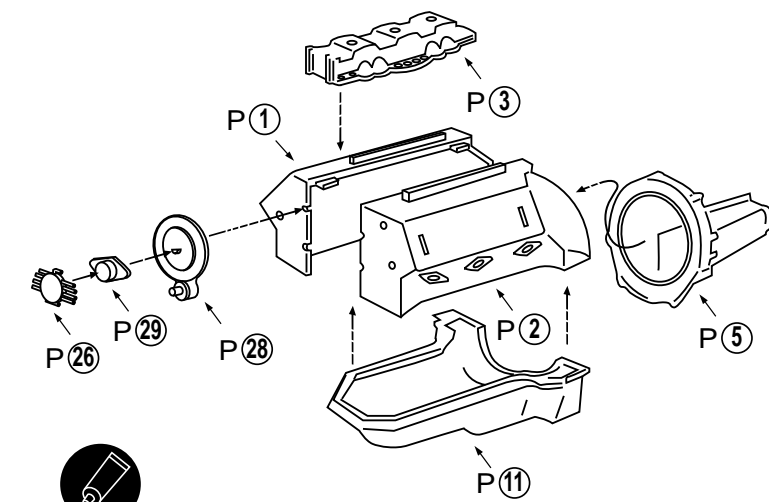

**1**

Assemble engine block halves (1/2), oil pan (11) and transmission housing (5). Attach intake manifold (3), distributor cap (26), distributor (29) and water pump (28).

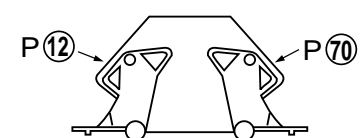

**NOTE**  
Engine mounts P12 and P70 must be glued in place aligned as shown.  
(Some parts not shown for clarity).

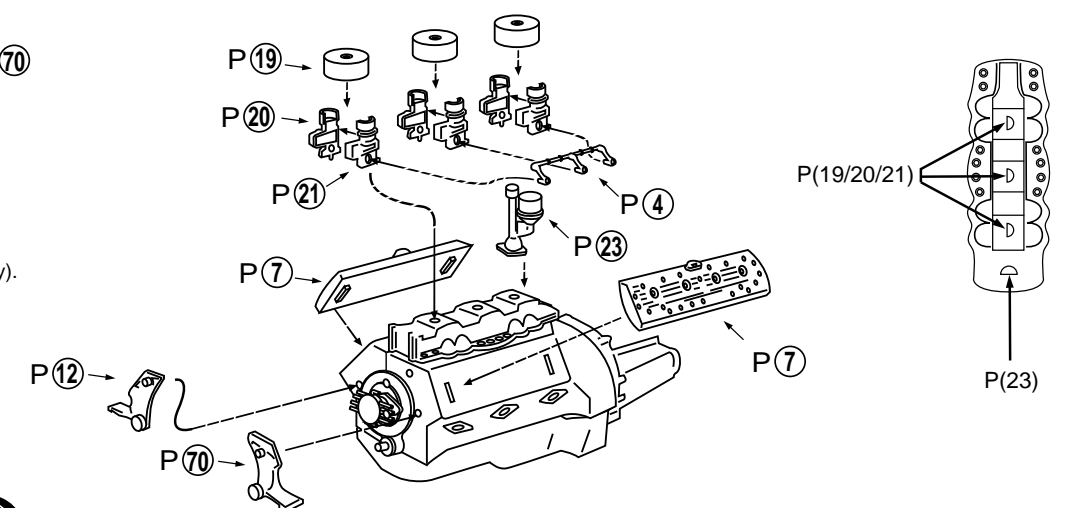

**2**

Assemble three carburetors (20/21) and air filters (19), then cement to intake manifold. Attach throttle linkage (4) as shown. Cement fuel pump (23) into hole on rear of intake manifold. Note diagram showing location. Cement heads (7) in place. Attach engine mounts (12/70) as shown.

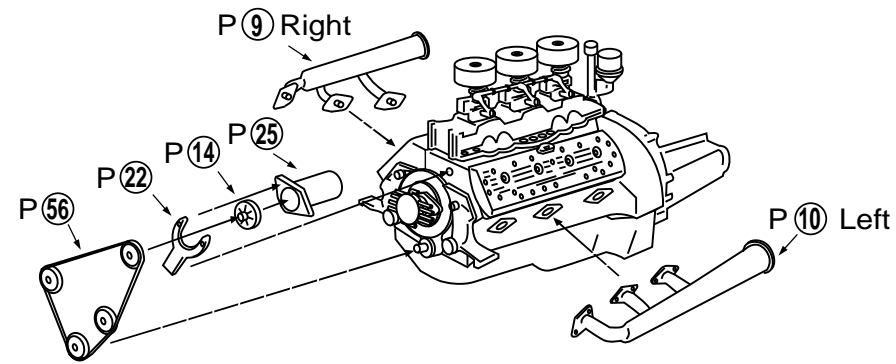

**3** Assemble generator and mount (22/14/25), then attach assembly to engine. Cement belt and pulleys (56) to positions shown. Press fit exhausts (9/10) (do not glue) to engine block. Exhausts should be glued in place after fitting the engine to chassis (Step 20). Note that exhausts will later be positioned pointing out of the sides of the engine compartment.

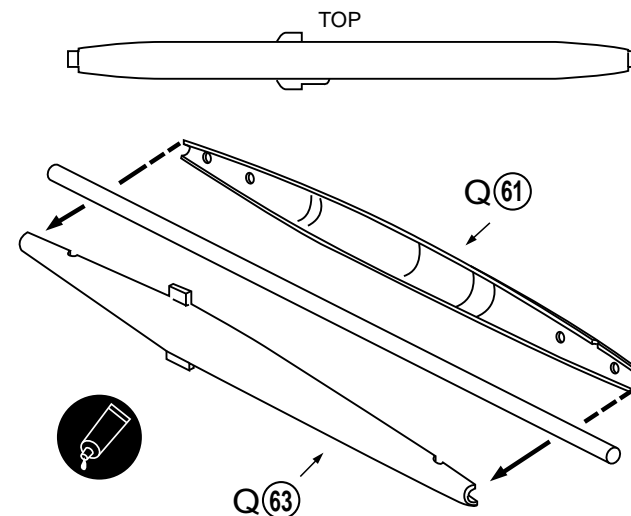

**7** Assemble rear axle halves (61/63), trapping metal axle between.

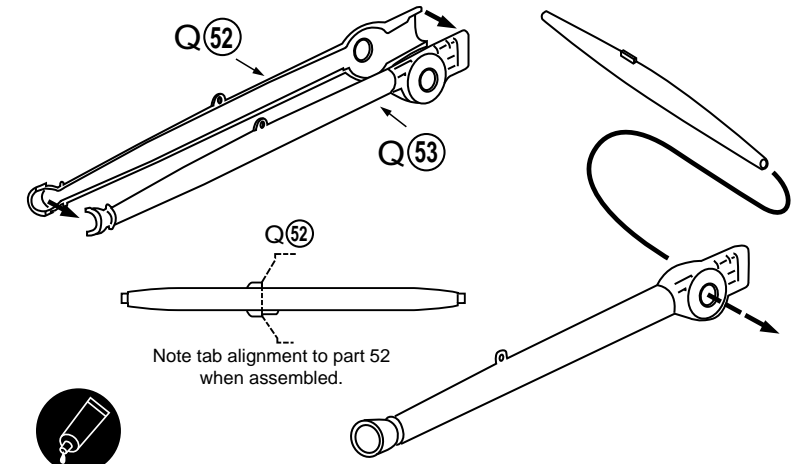

**8** Cement parts (52/53) together. Pass rear axle assembly through hole in differential/driveshaft housing (52/53), aligning the small tab with slot on part 52.

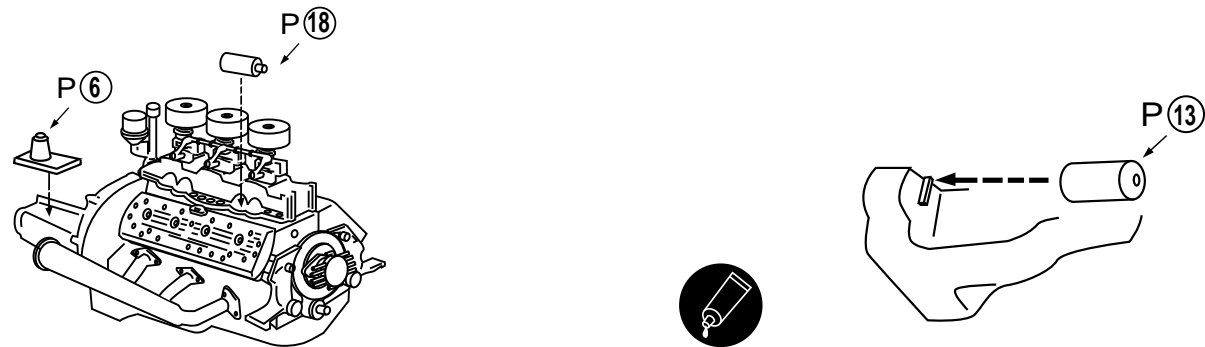

**4** Cement coil (18) and shifter base (6) in place as shown.

**5** NOTE: Underside of engine is shown. Cement starter motor (13) to oil pan.

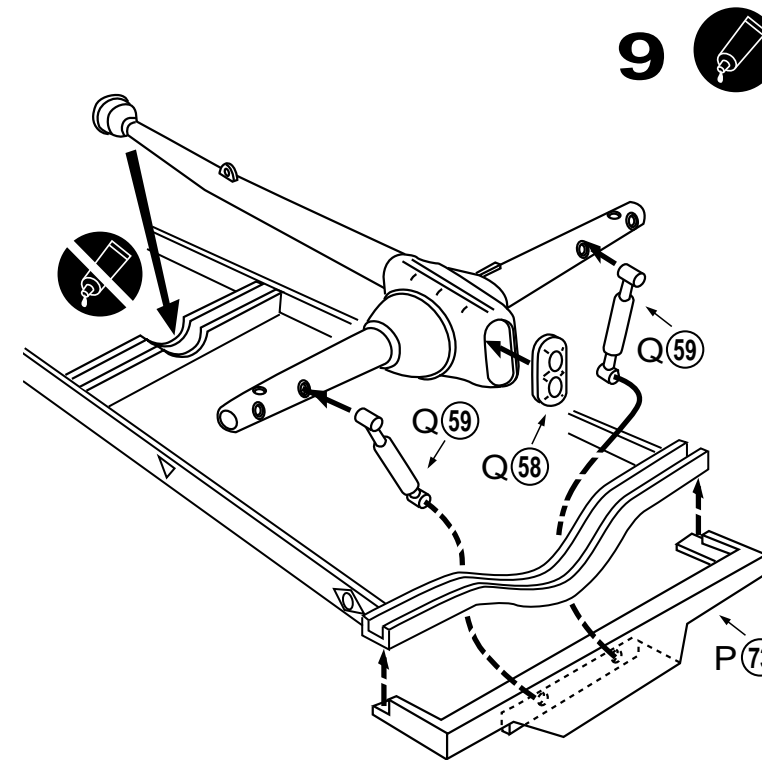

**9** NOTE: All parts are shown upside down. Dry fit all parts to become familiar with assembly procedure. Also refer to Step 10 below.

Attach rear suspension mount (73) to frame. Allow to dry thoroughly.

Cement differential cover (58) to rear axle assembly.

Place rear axle assembly in place, then glue shock absorbers (59) into position on axle and suspension mount. All parts should align as shown in diagram below. Note that forward end of driveshaft will lay in the cutouts of frame brace (E15). Do not apply glue to this area.

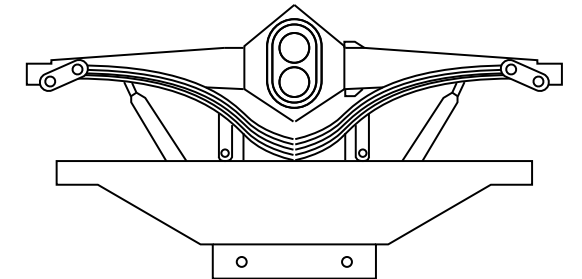

Assembly viewed from rear. Note alignment of parts.

**IMPORTANT NOTE**  
It is recommended to use a slow-setting glue such as tube cement or epoxy for assembling the shock absorbers (59) to the driveshaft/axle assembly and part 73, as these parts should be assembled simultaneously for proper alignment.

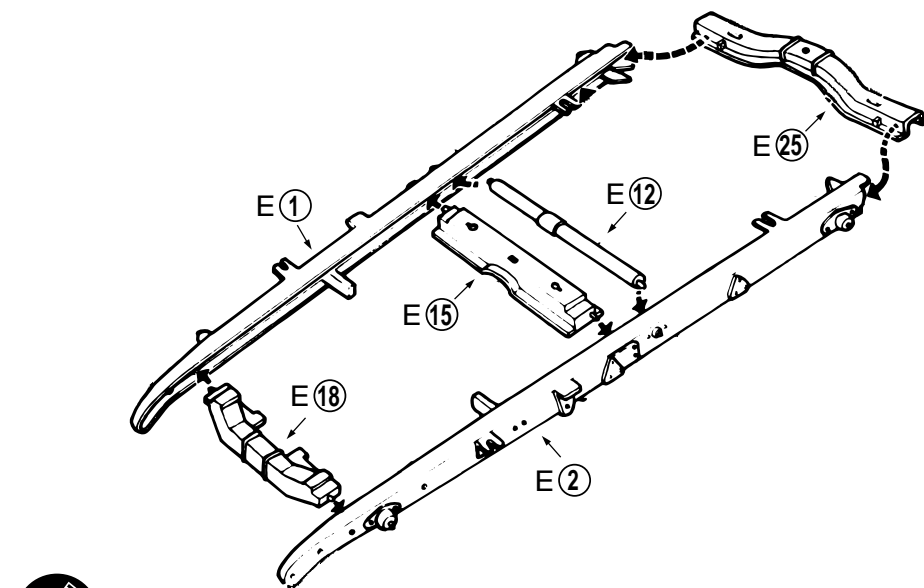
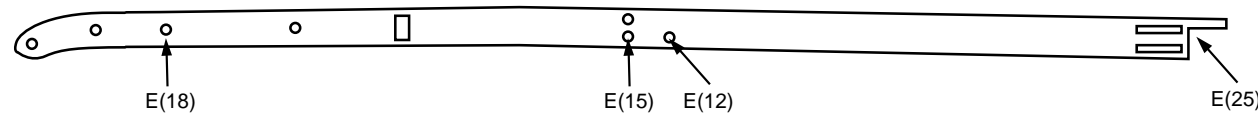

**6** Assemble the chassis by cementing all parts indicated to E(2), then cement E(1) to other parts. Note diagram showing appropriate locating holes on parts E(1/2).

Assembly viewed from side. Note alignment of parts.

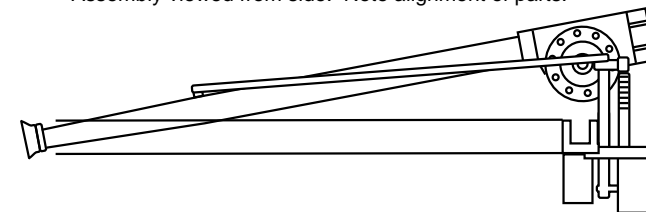

**10** NOTE: All parts are shown upside down. If not installed in Step 9, cement rear spring (60) to holes in axle, and to suspension mount (Part 73). Cement stabilizers (50/51) to rear axle and driveshaft housing.

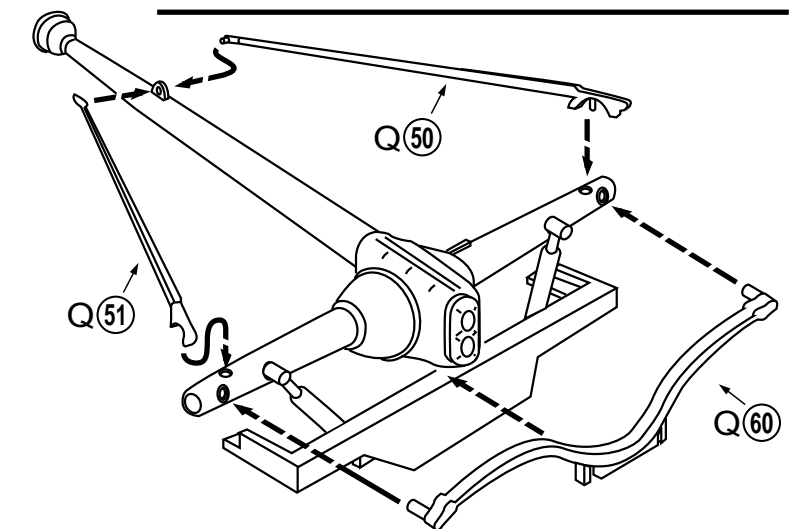

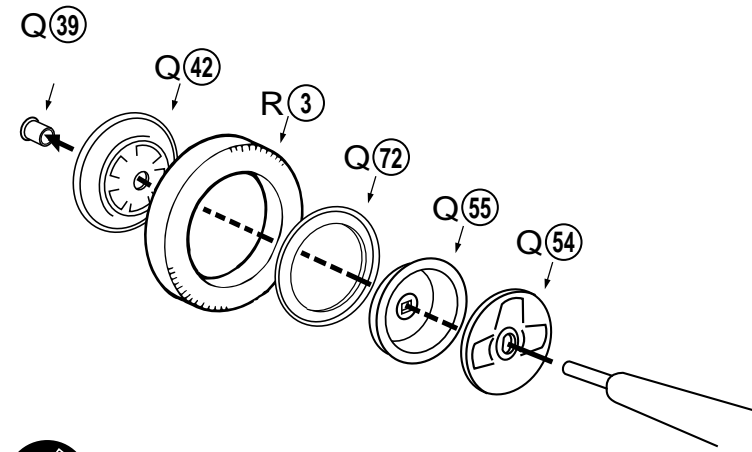

**11**

Trap thicker tire between outer rim (42) and inner rim (72), then glue brake drum (55) to inner rim. Pass metal rear axle through this assembly, then glue to hub (39). Pass other end of metal axle through rear axle assembly. Cement Q(54) to Q(61/63).

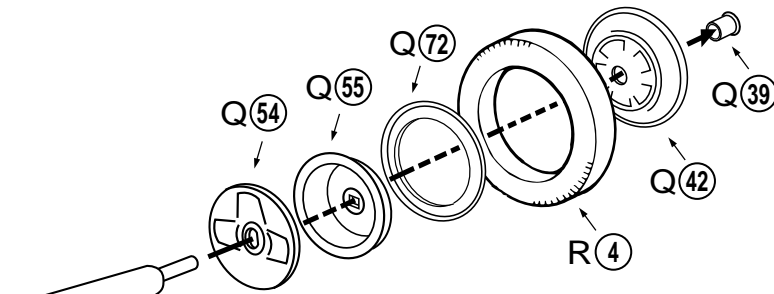

**12**

Trap thicker tire between outer rim (42) and inner rim (72), then glue brake drum (55) to inner rim. Pass metal rear axle through this assembly, then glue to hub (39). Pass other end of metal axle through rear axle assembly. Cement Q(54) to Q(61/63).

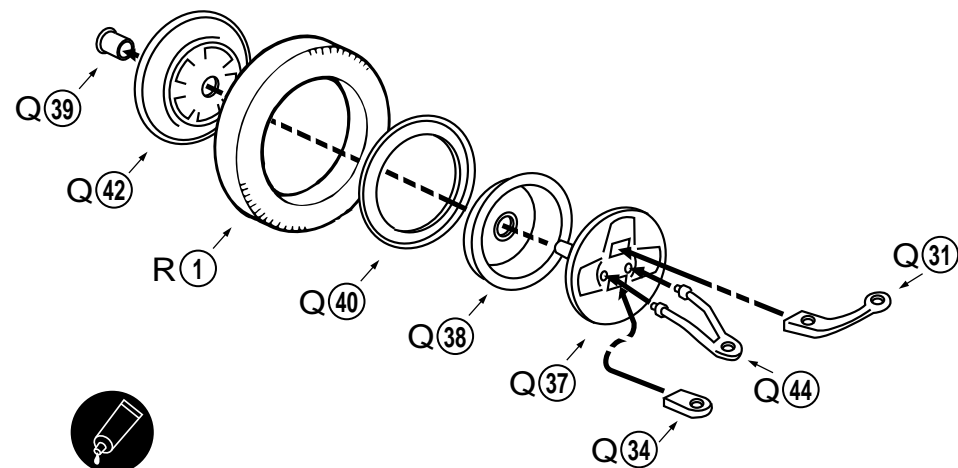

**13**

Trap thinner tire between outer rim (42) and inner rim (40), then glue brake drum (38) to inner rim. Pass stub axle of part 37 through this assembly, then glue to hub (39). Cement support arms (34/31) to part 37. Attach steering arm (44) to part 37.

Note alignment (viewed from front).

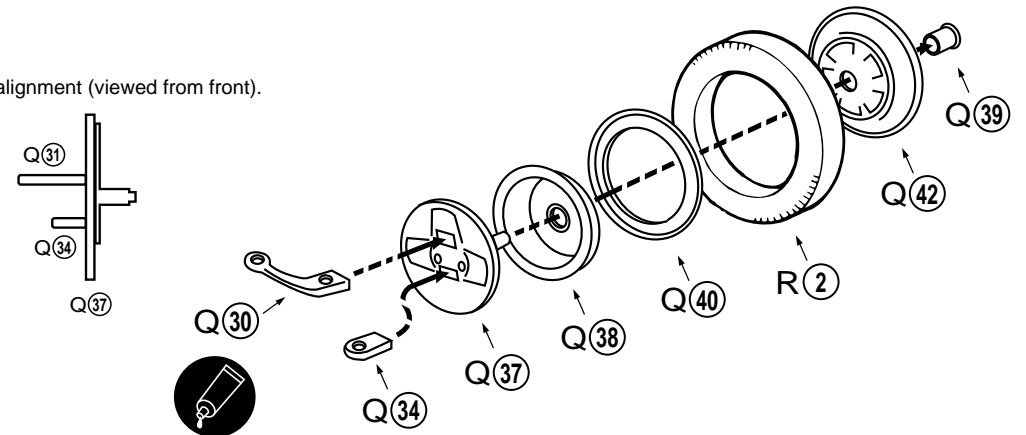

**14**

Trap thinner tire between outer rim (42) and inner rim (40), then glue brake drum (38) to inner rim. Pass stub axle of part 31 through this assembly, then glue to hub (39). Cement support arms (34/30) to part 37.

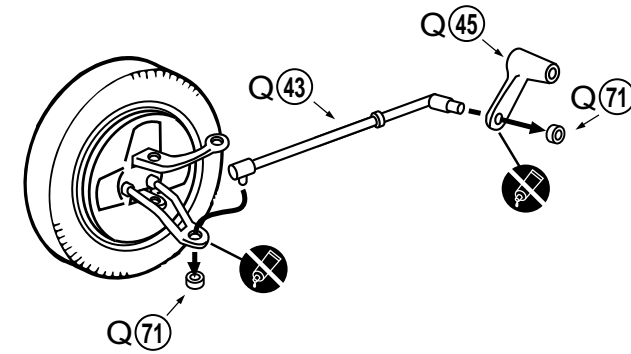

**15**

Pass stub on end of steering linkage (43) through hole in steering arm, then glue cap (71) on end. Pass other stub end through link (45), and glue cap (71) on end. Leave assembly loose until Step 23.

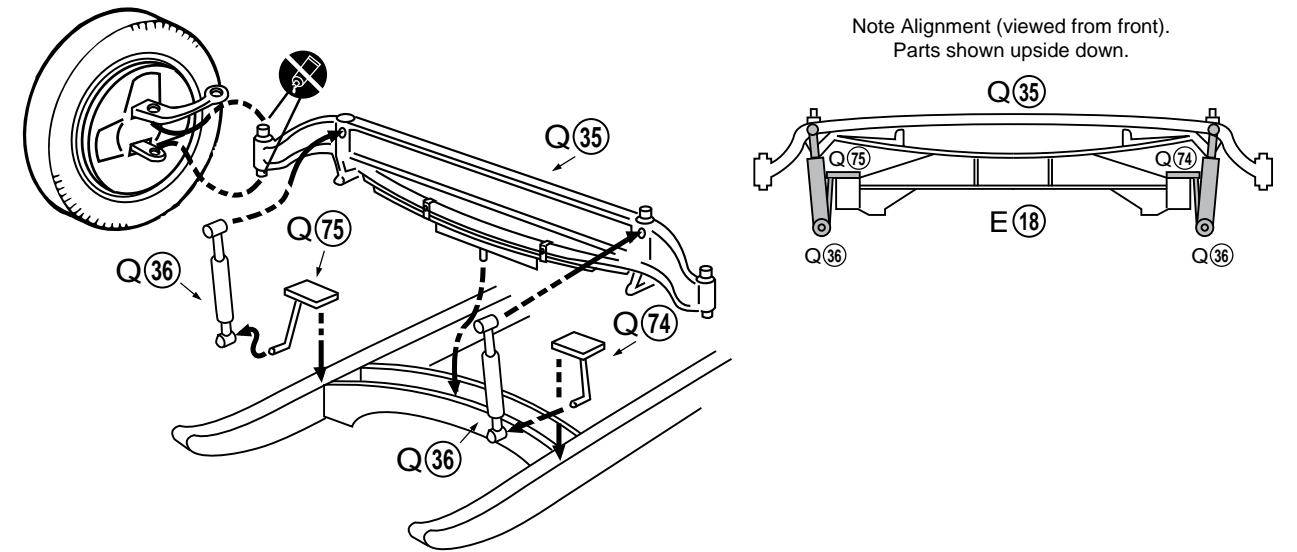

Note Alignment (viewed from front).  
Parts shown upside down.



**16**

**NOTE: All parts shown upside down.** Steering linkage is not shown for clarity. Cement forward spring (35) to frame crossbar. Glue shock mounts (74/75) to frame, aligning with crossbrace as shown. Glue shock absorbers (36) in place as shown. Snap wheel assembly onto stubs.



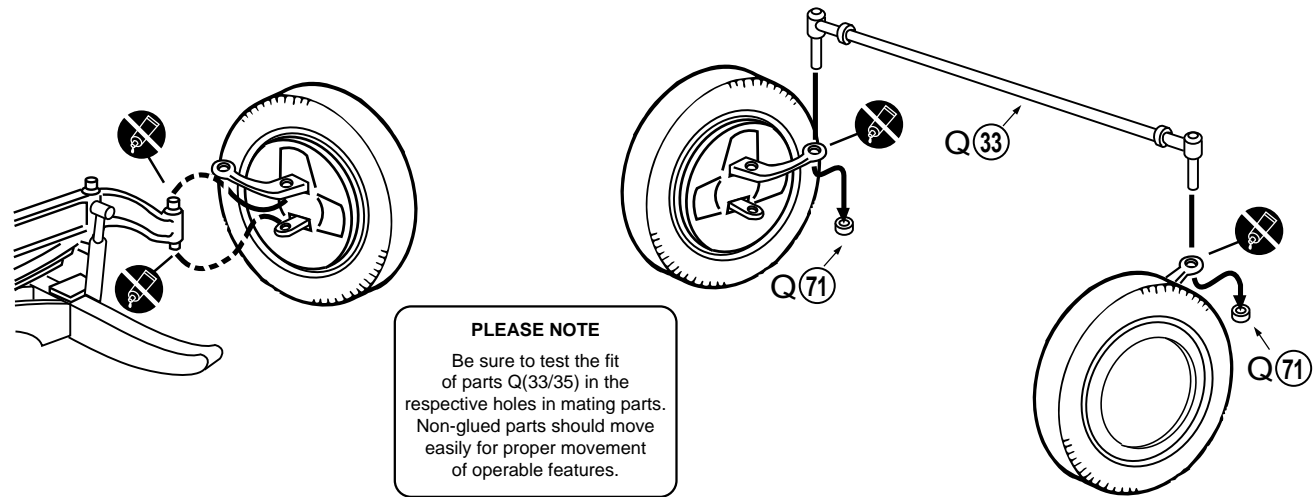

**PLEASE NOTE**  
Be sure to test the fit of parts Q(33/35) in the respective holes in mating parts. Non-glued parts should move easily for proper movement of operable features.

**17** NOTE: All parts shown upside down. Snap wheel assembly onto stubs.

**18** NOTE: All parts shown upside down. Front suspension parts not shown for clarity. Pass end stubs of tie rod (33) through holes in steering arms and glue caps (71) on ends.

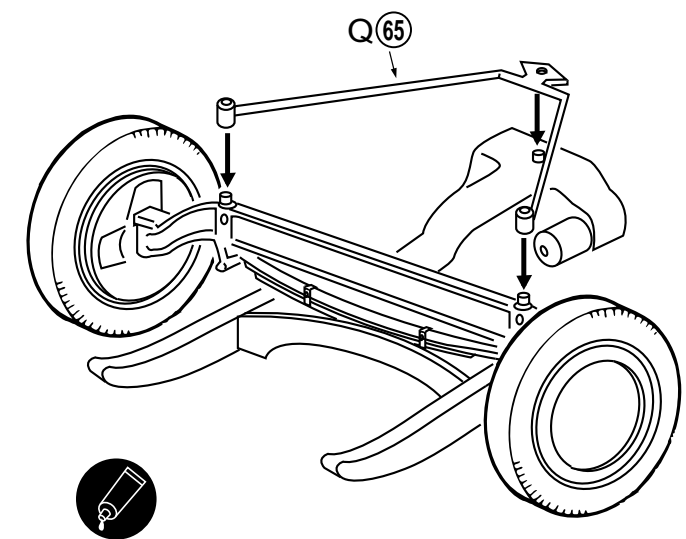

**22**

NOTE: All parts are shown upside down. Glue brace (65) in place, attaching to stubs on forward crossbeam and also to the stub on the oil pan.

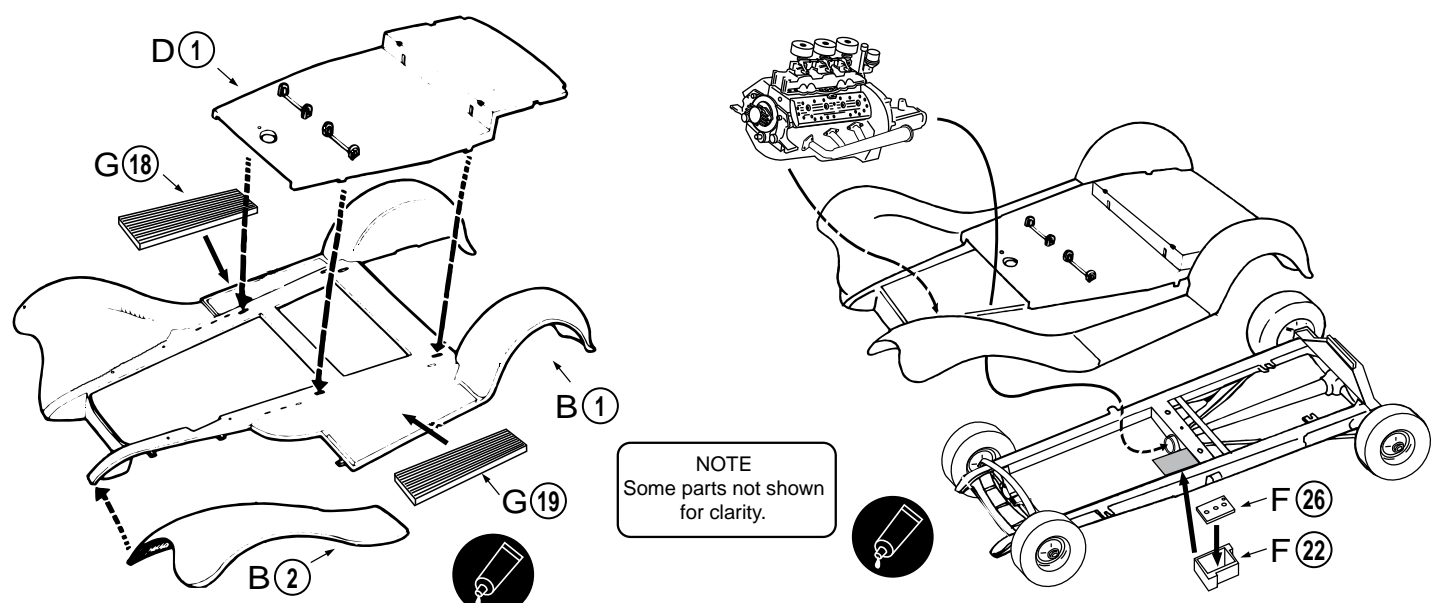

NOTE  
Some parts not shown for clarity.

**19** Cement floorboard D(1) to B(1). Cement fender B(3) in place.

**20** Cement battery parts F(22/26) together and glue to frame in position shown. Cement fenders and floorboard assembly to frame. Cement engine assembly in position, connecting to driveshaft. Glue exhausts into position.

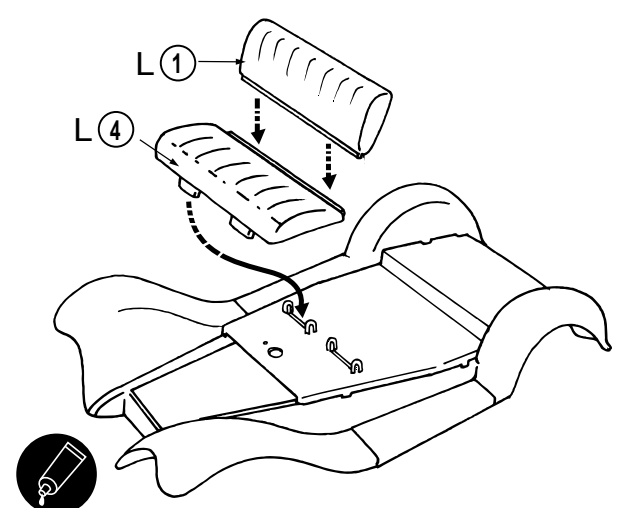

**23** Assemble seat back L(1) to seat L(4), aligning tabs with slots in floorboard.

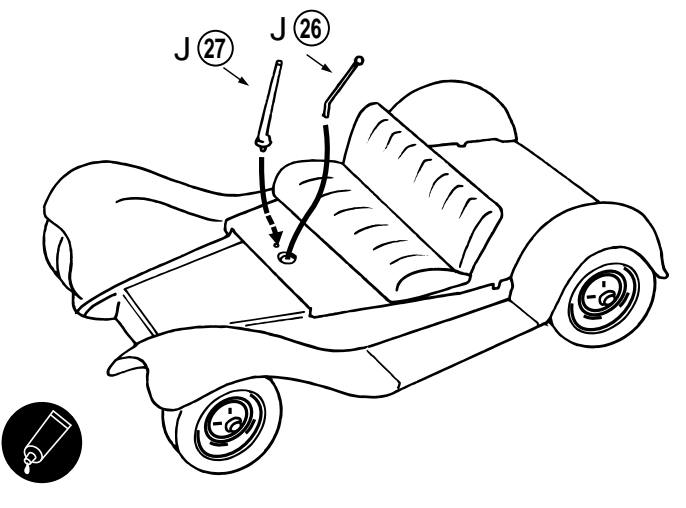

**24** Attach parts (26/27) as shown. Note shift knob J(26) inserts into hole on top of transmission housing.

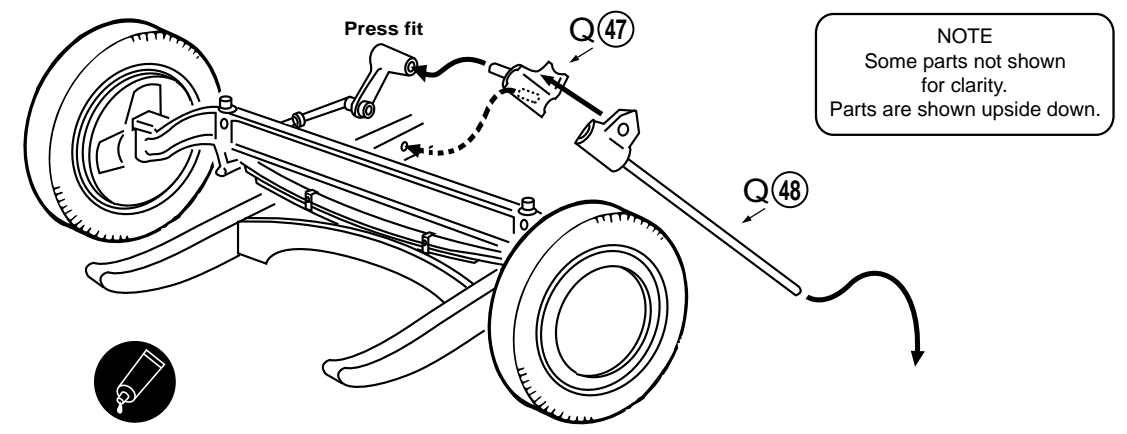

NOTE  
Some parts not shown for clarity. Parts are shown upside down.

**21** Turn model over. Glue together steering box parts (47/48). Carefully slide the shaft between the exhaust pipes, and glue steering box to frame. Press fit the steering link onto the shaft of part 47.

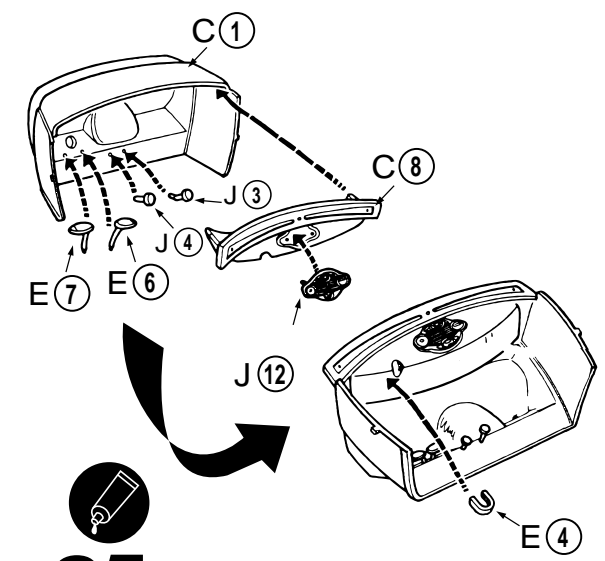

**25** Cement all controls in place as shown.

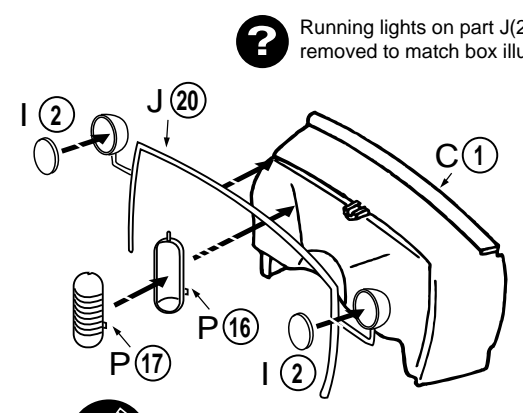

? Running lights on part J(20) may be removed to match box illustration.

**26** Cement oil filter (16/17) together, then to dash C(1). Attach trim J(20) to dash.

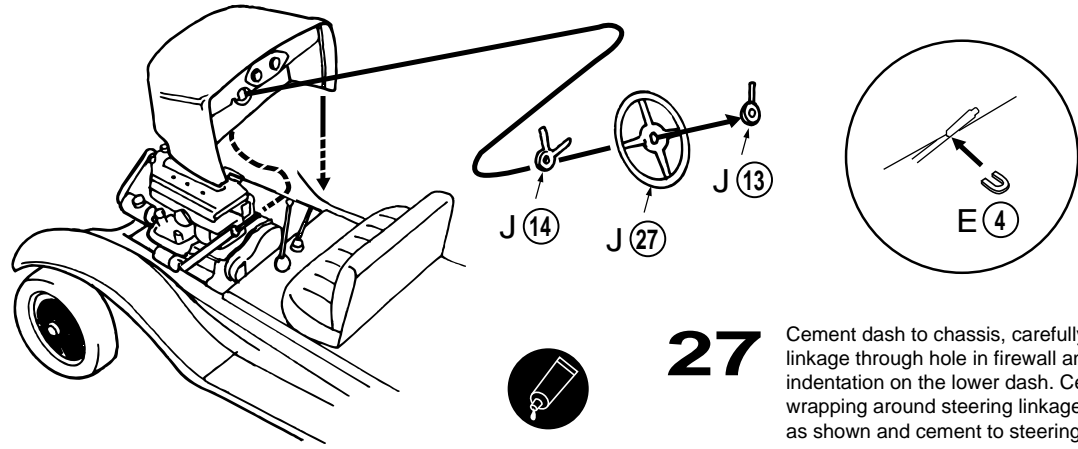

**27** Cement dash to chassis, carefully threading the steering linkage through hole in firewall and aligning it with the small indentation on the lower dash. Cement part E(4) to dash, wrapping around steering linkage. Cement steering wheel parts as shown and cement to steering linkage.

**28** Assemble radiator as shown. Cement water hoses (62/24) to the engine. Glue radiator in place on frame, the glue hoses to radiator. Cement tie rods (13/14) in place as shown.

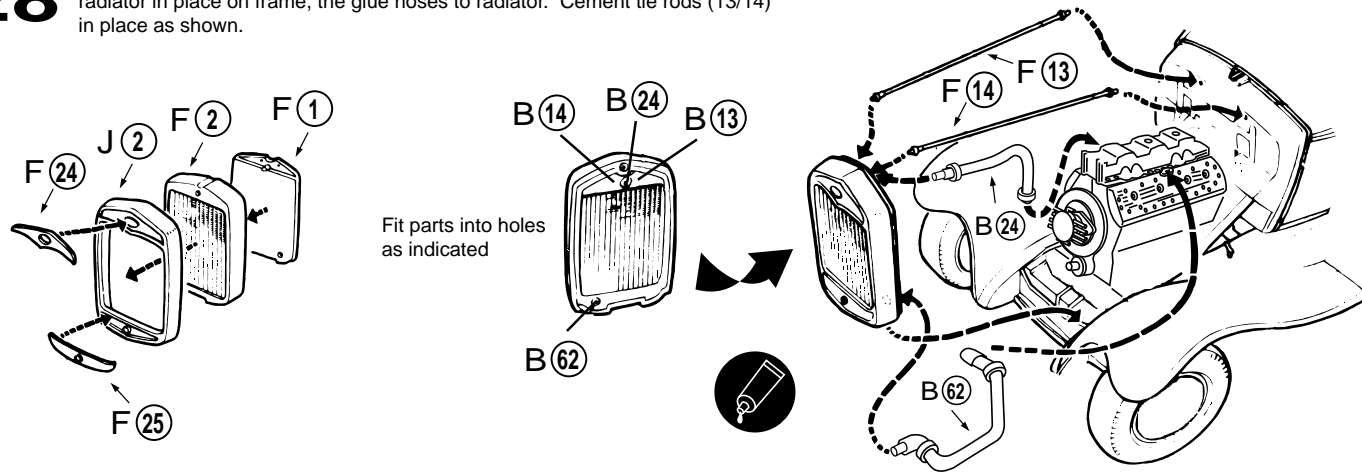

Fit parts into holes as indicated

**? OPTIONAL STEP**

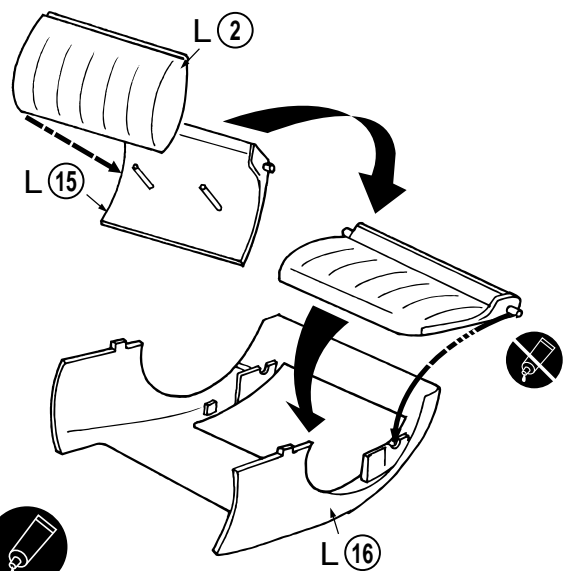

**29** Assemble seat L (15) and L (2), then insert into body shell L (16). Do not glue.

**? OPTIONAL STEP**

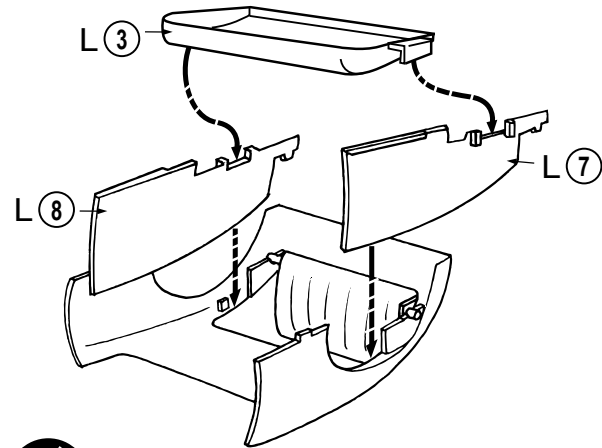

**30** Cement sides L (7) and L (8) to body shell. Do not apply glue to hinge points. Attach seat bottom L (3).

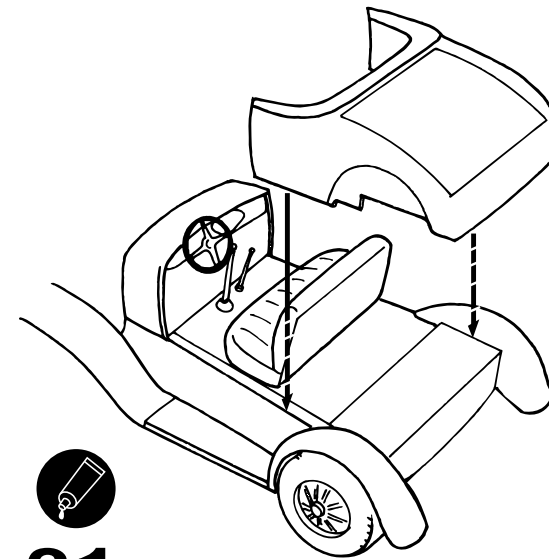

**31** Cement body shell to assembled chassis.

**2X** 1/16" (2mm) End view

**Steps 32/33** Shorten one end of hinge pins to dimensions shown. Glue into position as shown. (Part is shown upside down).

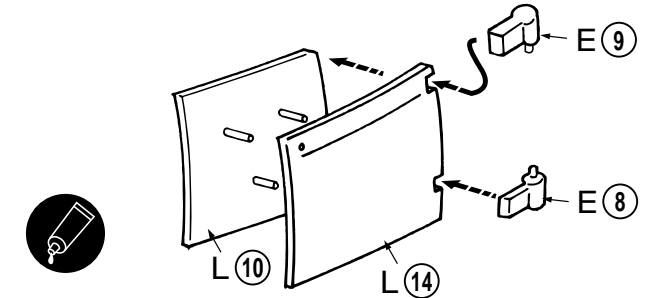

**32** Cement door halves L (10,14) together. Cement hinge pin to hinge E (9), then cement hinges E (8,9) to door.

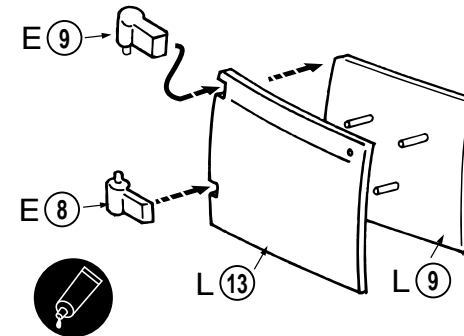

**33** Cement door halves L (9,13) together. Cement hinge pin to hinge E (9), then cement hinges E (8,9) to door.

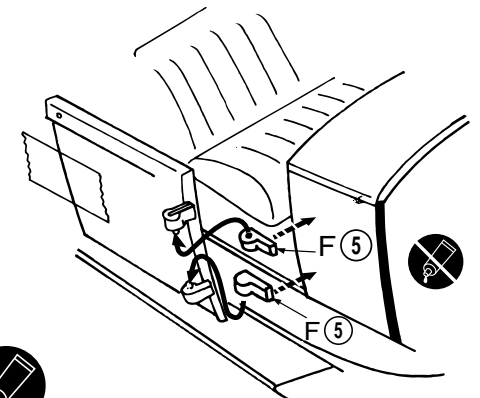

**34** Fit (do not cement) hinges F5 to door hinges. Hold door shut and in place with tape, then carefully cement hinges F (5) to body.

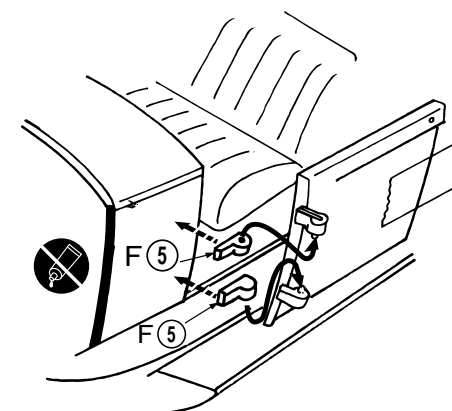

**35** Fit (do not cement) hinges F5 to door hinges. Hold door shut and in place with tape, then carefully cement hinges F (5) to body.

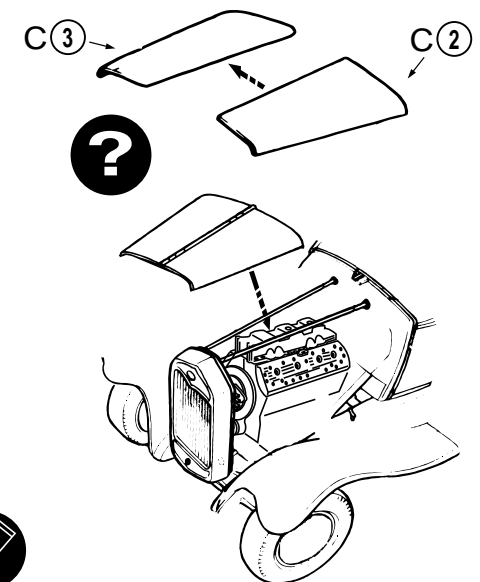

**36** Glue part C(2) and C(3) together using a slow-setting cement. Align assembly with radiator and firewall and glue in place.

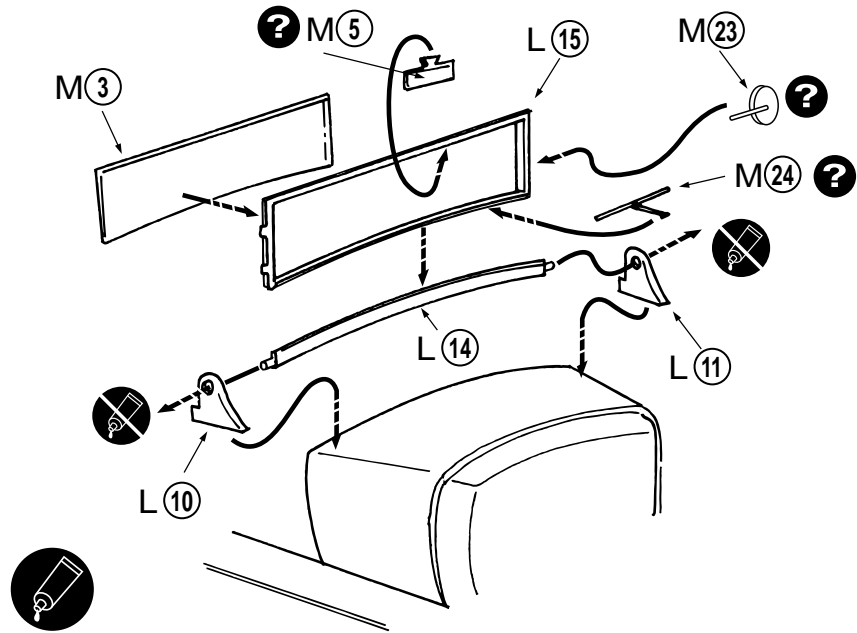

**37** Cement windshield M (3) to frame L (15), then to frame L (14). Slide L (10, 11) onto ends of L (14), then glue to body. Attach side screens M (2) and accessories.

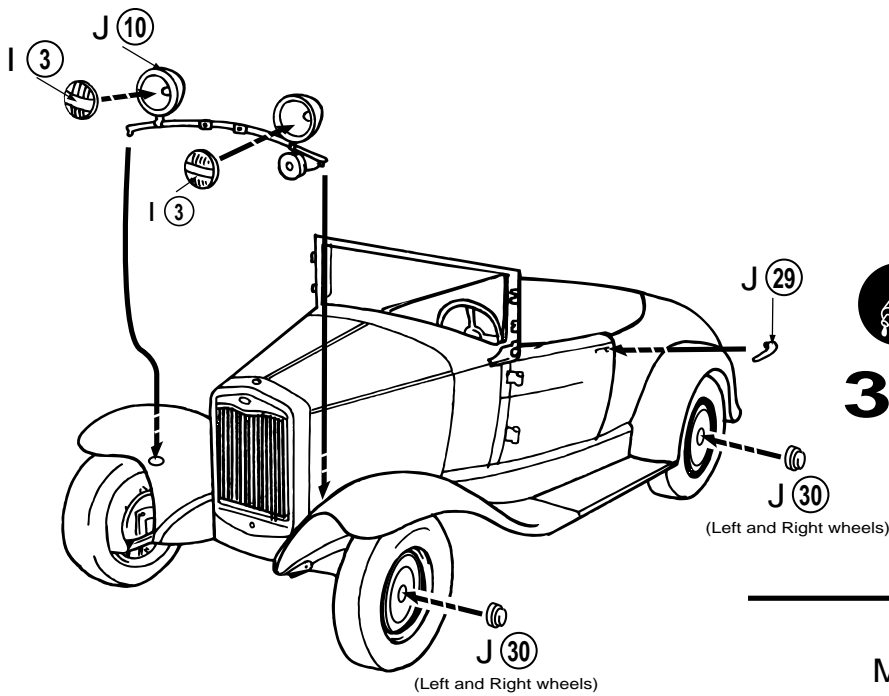

**38** Assemble lights and glue to fenders. Cement handles J (29) to body, left and right sides. Cement hubcaps J(30) to wheel hubs.



**39** Cement two taillights J(25) to body. Attach handles M(12,13,14).

