

## Technical Information Sheet

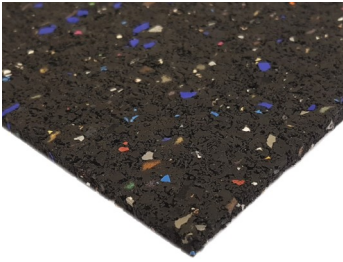

Regupol QUIETLAY is a recycled crumb product designed to isolate screeds from the main structure of the building on pre-cast floors, reducing impact energy generated by general footfall. With a dimpled surface on one side, which increases air movement and dissipates energy in channels, Regupol® QUIETLAY offers enhanced isolation performance and delivers impact sound insulation of 47dB, even under heavy loads.

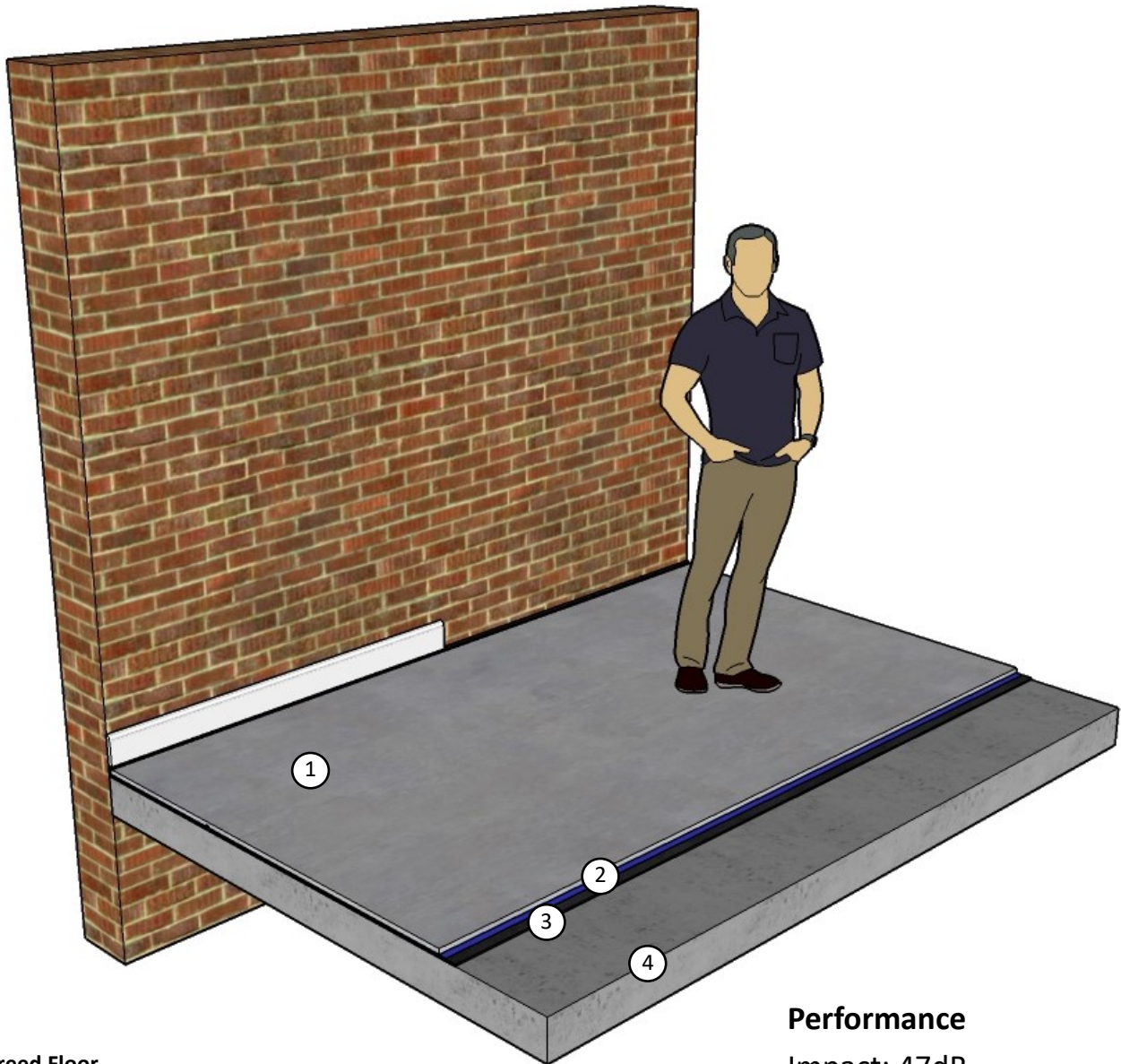

- 1: Screed Floor
- 2: Waterproof Membrane
- 3: Regupol Quietlay
- 4: Pre-Cast Concrete Sub Floor

### **Performance**

Impact: 47dB

- No perimeter strips required - resulting in 5-10% cost saving on labour
- No specialist trades required for installation
- Improved health and safety - material is supplied in easy to handle sheets (under 10kg per sheet)
- Extremely quick and easy to install
- Efficient Installation - A standard Utility Knife can be used to cut the material
- No polythene layer required where sand/cement screeds are used
- Suitable for both sand/cement and proprietary flowing screeds
- Minimal creep characteristics
- Manufactured from a recycled source
- High quality and exact thickness guaranteed
- Fully recyclable
- Suitable for use with Underfloor Heating Systems
- MF ceiling perimeter isolation is not required

## Installation

The use of this screed resilient layer system must incorporate the following: 1. Regupol® Quietlay (resilient layer to be laid over entire floor area) 2. Regupol® Quietlay to be laid with min 100mm upstand at wall (to allow for isolation under wall lining and skirting after screed is poured) 3. All joints taped .

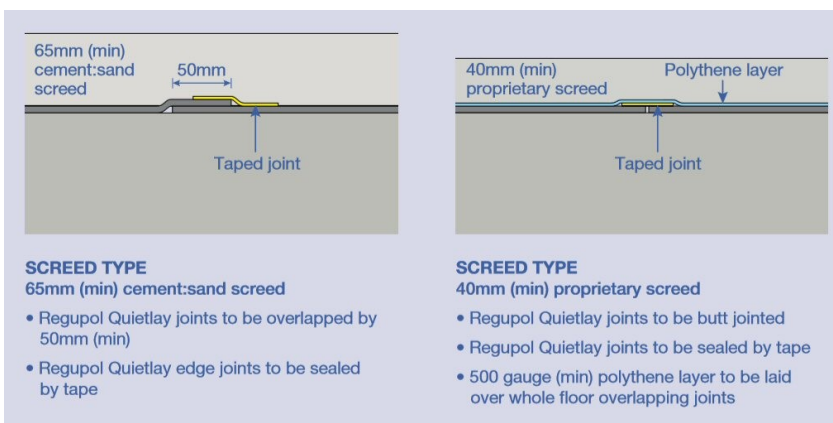
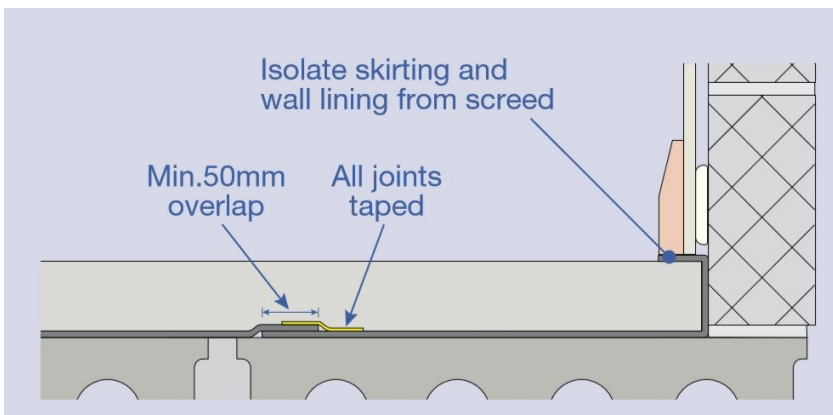

Regupol® Quietlay Technical Information	
Density	755kg/m <sup>3</sup>
Tensile strength (DIN 53571)	approx. 0.55N/mm <sup>2</sup>
Thermal conductivity	approx. 0.14W/mK
Elongation at break	approx. 78%
Temperature resistance	-40°C to +115°C

**Please note:** For installations and applications not listed, please contact The Soundproofing Store for guidance.

Recommended Adhesive – For bonding to the subfloor, D3 Floor Adhesive, which should be applied by brush or by roller.