

# SEAL BAND

Single-sided tape for indoor use

Hydrorepellant impregnated paper support, acrylic glue and separation layer

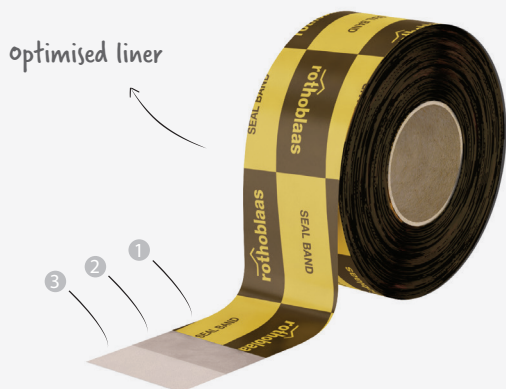

## PRACTICAL

For simple sealing of corners, edges and other special nodes, the double liner makes installation easier



## EFFECTIVE

Impregnated paper support, ideal for internal use; airtightness guaranteed over time



## TECHNICAL SPECIFICATIONS

property	standard	value
Total thickness	DIN EN 1942	approx. 0.30 mm
Tear strength	DIN EN 14410	> 70 N/cm
Expansion capacity	DIN EN 14410	> 5 %
Adhesiveness	DIN EN 1939	> 15 N/cm
Water vapour transmission (Sd)	EN 1931	6 m
Temperature resistance	-	-40 / +100 °C
Application temperature	-	> -10 °C
Storage temperature	-	+15 / +30 °C
Solvents	-	NO
VOC emissions	-	0 % (class A+)

NOTE: Store the product in a dry, covered location

## CODES AND DIMENSIONS

code	ex code	liner [mm]	B [mm]	L [m]	pcs/box
<b>SEAL60</b>	D52211	-	60	40	5
<b>SEAL1248</b>	D52212	12 / 48	60	40	5
<b>SEAL3030</b>	D52214	30 / 30	60	40	5

## COMPOSITION

- ① **support:** hydrorepellant impregnated paper
- ② **glue:** acrylate dispersion without solvents
- ③ **separation layer:** silicone paper

## SEAL BAND INSTALLATION INSTRUCTIONS - INTERNAL WINDOW DETAIL

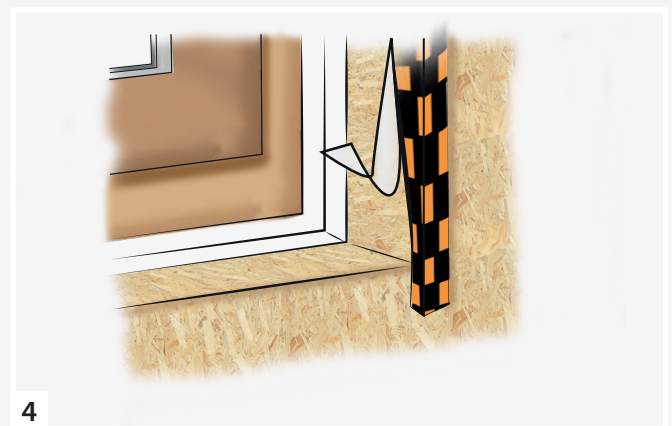
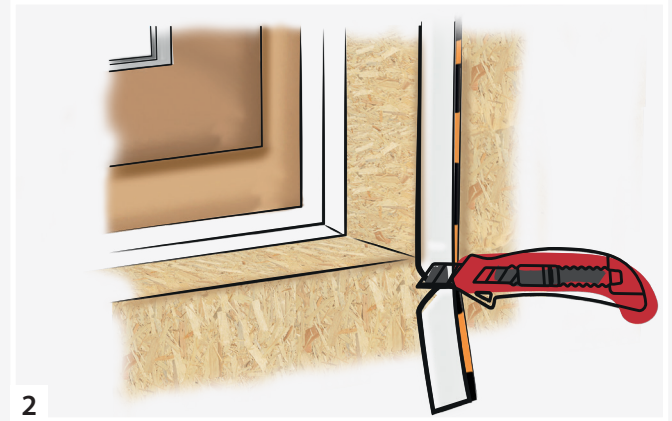
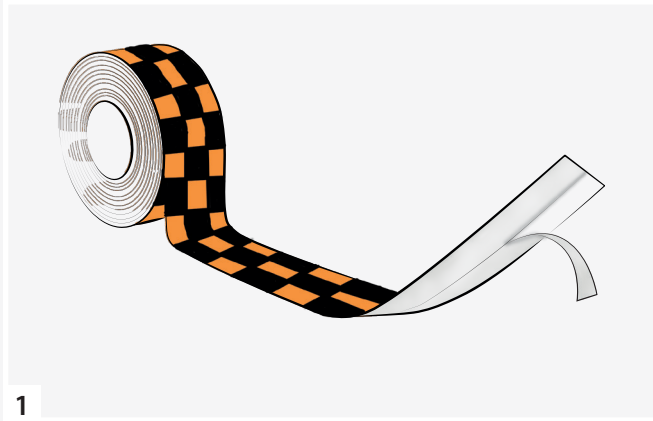

## SEAL BAND INSTALLATION INSTRUCTIONS - CORNER DETAIL

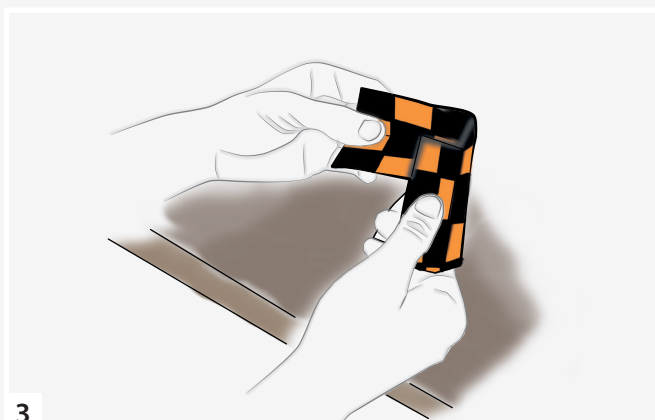
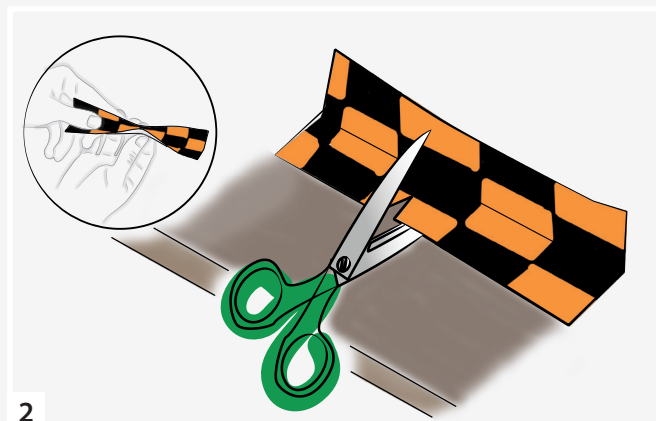
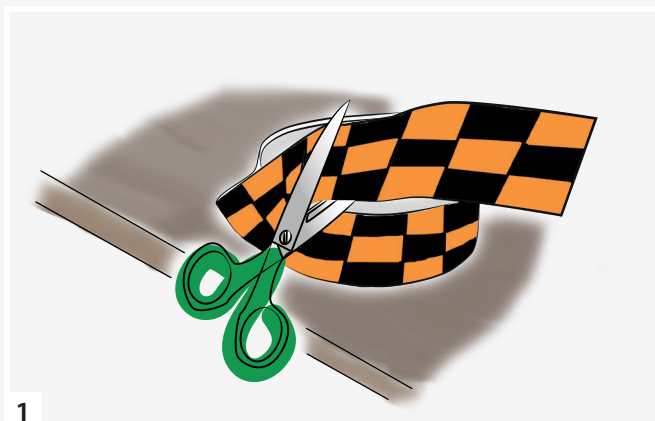

## SEAL BAND INSTALLATION INSTRUCTIONS - BEAM DETAIL

