

KARMA Acoustic JoistHood

Karma Acoustic JoistHood has been engineered as a low cost acoustic joist treatment which is easily installed and meets the requirements of Approved Document E of the Building Regulations for material change of use.

The product consists of a 12mm profiled low-density polyethylene resilient foam which has gas impregnated acoustic additives. Karma Acoustic JoistHood is specifically engineered in an omega shape to friction fit over the joists. In addition to this the profiled ridges on the surface of the product minimise surface contact between the foam and floor surface to ensure maximum acoustic isolation.

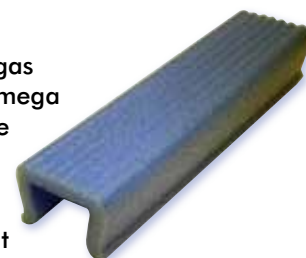

The product is simply placed over the existing joists, which can either be planed or rough cut prior to adding the mass of the floor.

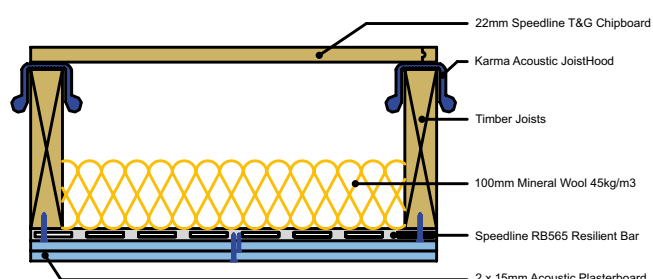

PRODUCT DESCRIPTION	IMPACT PERFORMANCE L'_{nw}	AIRBORNE PERFORMANCE $R_w (C_{tr})$
12mm Karma Acoustic JoistHood	55 dB	63 (-12) dB

Alternative Direct to Joist Solution

A technical installation guide and CAD drawings can be downloaded from www.karma-acoustics.co.uk

Dimensions: 12mm x 50mm x 2000mm **Density:** 30kg/m³

User benefits

- Laid straight onto the joists, no sub-deck required, which reduces floor height and saves on labour costs
- Very lightweight and easy to handle with a simple installation process
- Offers minimal height increase making it easy to marry up to existing stairs on refurbishment projects
- Exceeds Approved Document E requirements for material change of use projects
- Does not require specialist knowledge
- Chemically and physically stable material with no CFC's or HCFC's used in production
- Zero ODP
- 100% recyclable
- Moisture resistant and rot proof

Typical Applications

- Ideal on masonry timber joist refurbishment projects, if floor height is an issue or when existing floorboards are to be replaced
- 'Room in a Roof' applications to block airborne and impact sound

