

# TC BROS.® 116-0104

## HIGH PERFORMANCE REAR BRAKE CONVERSION FOR 2006-07 HARLEY DAVIDSON DYNA MODELS (1" AXLE) WITH 12.6" (320mm) BIG ROTOR AND RIGHT SIDE BREMBO P4 AXIAL CALIPER

PARTS LIST (BLACK FINISH)			
ITEM	QTY	PART NUMBER	DESCRIPTION
1	1	MB216UN-BK	AXIAL REAR 12.6 BRACKET
2	1	MB227UN	1" AXIAL SHIM
3	1	MB226UN	1" AXIAL BUSHING
4	2	119-0325	M10 FLAT WASHER
5	2	119-0333	M10-1.5 x 30mm SHCS
6	1	NOT INCLUDED	OEM HD RUBBER ISOLATOR

APPLY MEDIUM STRENGTH THREADLOCKER  
(BLUE LOCTITE® 243 OR EQUIVALENT)  
AND TORQUE ALL M10 FASTENERS 35 ft-lbs.

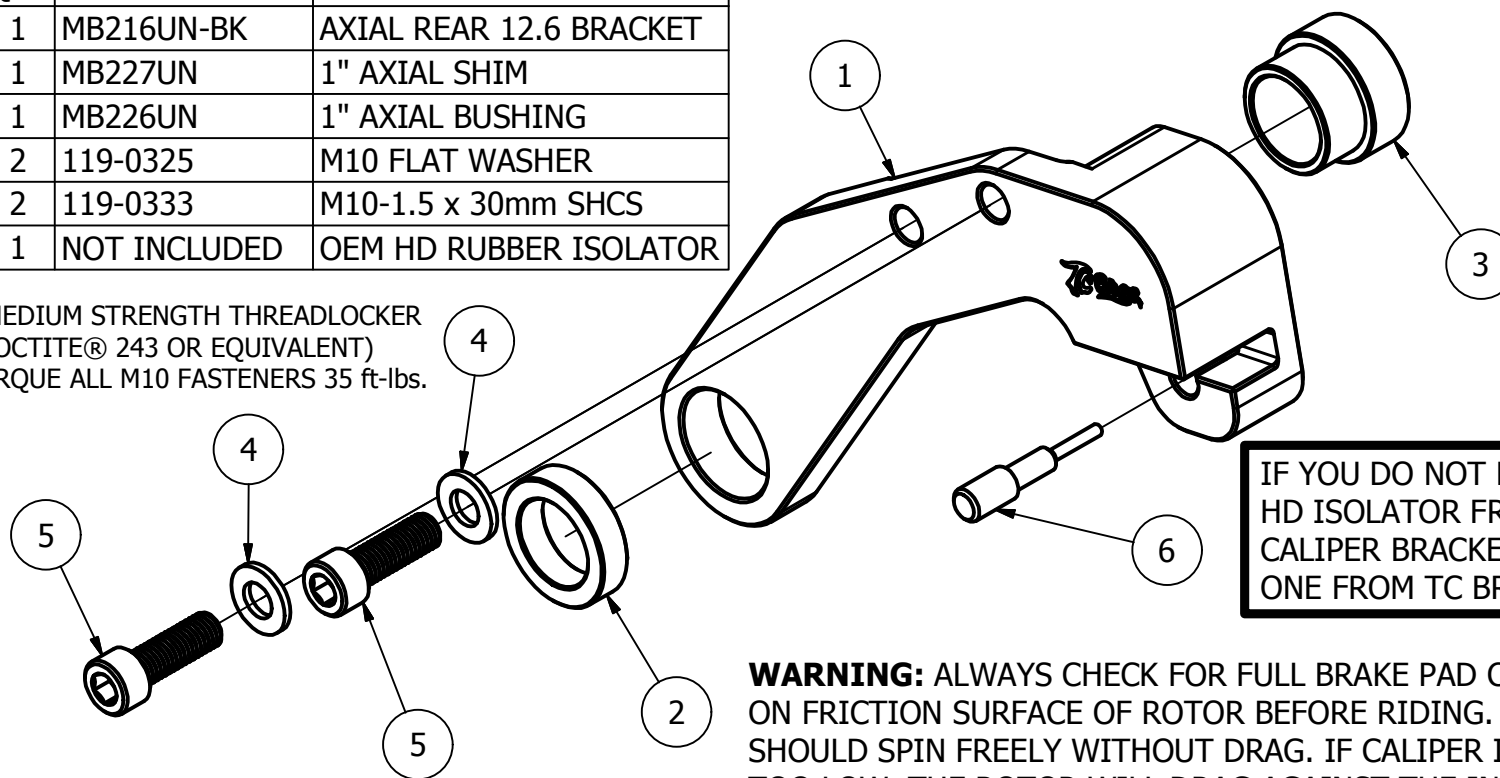

IF YOU DO NOT HAVE AN ORIGINAL  
HD ISOLATOR FROM YOUR STOCK  
CALIPER BRACKET, YOU CAN PURCHASE  
ONE FROM TC BROS (PART #116-0106).

**WARNING:** ALWAYS CHECK FOR FULL BRAKE PAD CONTACT ON FRICTION SURFACE OF ROTOR BEFORE RIDING. WHEEL SHOULD SPIN FREELY WITHOUT DRAG. IF CALIPER IS MOUNTED TOO LOW, THE ROTOR WILL DRAG AGAINST THE INSIDE OF THE CALIPER BODY. YOU MUST CORRECT THIS BEFORE RIDING OR DAMAGE WILL OCCUR. IF CALIPER IS MOUNTED TOO HIGH, THE TOP OF THE BRAKE PAD WILL OVERHANG THE EDGE OF THE ROTOR. YOU MUST CORRECT THIS OR YOU WILL HAVE DANGEROUSLY REDUCED BRAKING POWER. ALWAYS PERFORM PROPER BRAKE PAD BEDDING PROCEDURE AFTER INSTALLING NEW PADS OR ROTORS.