

TC BROS.® PART #103-0013  
 FRONT CRASH BAR  
 1991-2017 DYNA® MODELS

**FITMENT NOTES:**

1. MODEL YEAR 2006-2017 REQUIRE BRACKETS MB247BT AND MB257BT AND CORRESPONDING FASTENERS TO RELOCATE OEM VOLTAGE REGULATOR AND RETAIN OEM REGULATOR CADDY.
2. WHEN INSTALLING MB247BT, ONLY REMOVE TOP ENGINE MOUNT BOLT. LOWER HOLE IS FOR ALIGNMENT OVER WASHER. POSITION BRACKET SO REGULATOR IS CLOSER TO ENGINE. REFERENCE PAGE 2 FOR ORIENTATION.
3. WHEN RELOCATING VOLTAGE REGULATOR, WIRING MAY NOT HAVE ENOUGH SLACK AVAILABLE, CABLE TIES IN WIRING HARNESS CAN BE CUT TO PROVIDE NECESSARY REACH.

103-0013 PARTS LIST			
ITEM	QTY	PART NUMBER	DESCRIPTION
1	4	119-0026	3/8 SAE WASHER
2	1	119-0187	3/8-16 x1-1/4 SOCKET HEAD CAP SCREW
3	4	119-0293	3/8"-16x1.00" SOCKET HEAD CAP SCREW
4	2	119-0343	1/4-20 S.S. THIN NYLOCK HEX NUT
5	2	119-0358	1/2-13 x 1.50" SOCKET HEAD CAP SCREW, FULL THREAD
6	2	119-0437	1/4-20x.50" SOCKET HEAD CAP SCREW
7	2	HD 4740A	OEM #4740A VOLTAGE REGULATOR MOUNTING SCREW (NOT INCLUDED)
8	1	HD 6701	OEM #6701 3/8 SAE WASHER (NOT INCLUDED)
9	1	HD 7038	OEM #7038 3/8 LOCK WASHER (NOT INCLUDED)
10	1	MB247BT	REGULATOR BRACKET
11	2	MB248BT	CRASH BAR SLIDER
12	1	MB253BT	DYNA FRONT CRASH BAR
13	1	MB257BT	REGULATOR CADDY RETAINING STRAP

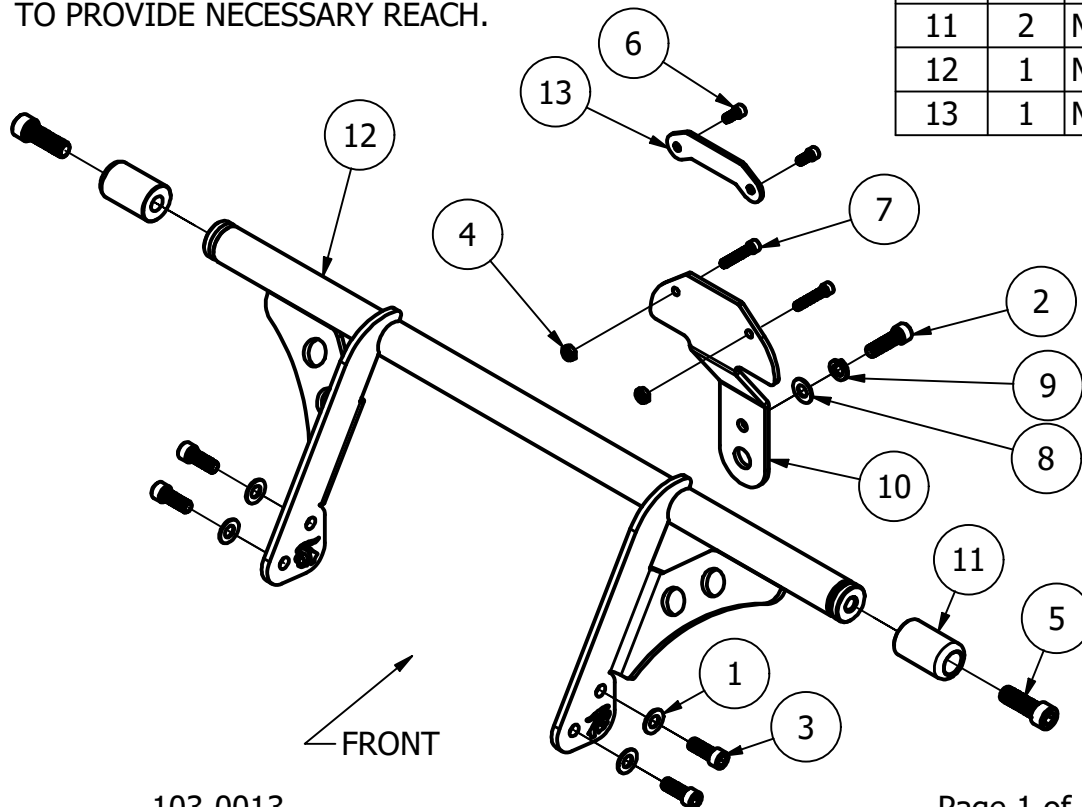

**WARNING:** APPLY MEDIUM STRENGTH THREADLOCKER (BLUE LOCTITE™ #243) TO ALL FASTENERS DURING FINAL ASSEMBLY.

TC BROS.  
 www.tcbros.com  
 419-265-9399

