

TC BROS.®

Pro Series MX Rider Mini Floorboards

2018-newer Harley Softail® M8 & Pan America®

102-0134 - RAW

102-0135 - BLACK

102-0136 - GOLD

PARTS LIST (EACH FOOT PEG)						
ITEM	QTY	102-0134 PART NUMBER	102-0135 PART NUMBER	102-0136 PART NUMBER	DESCRIPTION	TORQUE VALUE
1	1	119-0469	119-0469	119-0469	5/16-24 x 7/8" LG SOCKET HEAD CAP SCREW	19 FT-LB (26 N-m)
2	1	119-0483	119-0483	119-0483	5/16 ZINC PLATED SPLIT LOCK WASHER FOR SHCS	
3	19	FP118UN	FP118UN	FP118UN	CLEAT	19 IN-LB (2.1 N-m)
4	1	FP120UN	FP120UN	FP120UN	M8 ST RIDER CLEVIS	
5	1	FP124UN	FP124UN-BK	FP124UN-GD	MX MINI BOARD	

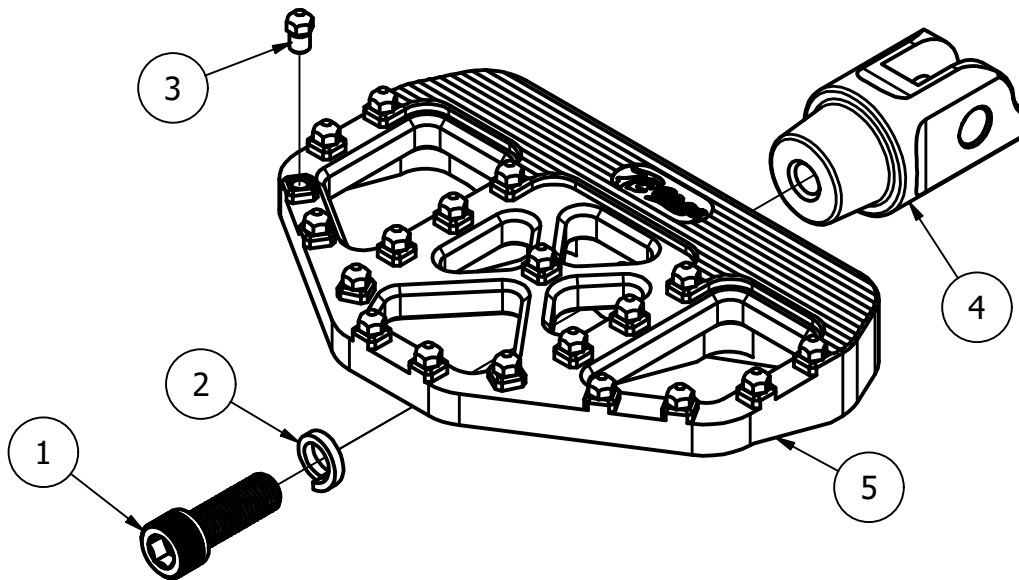

WARNING: APPLY MEDIUM STRENGTH
THREADLOCKER (BLUE LOCTITE™ #243)
TO ALL FASTENERS DURING FINAL ASSEMBLY.

TC BROS.
www.tcbros.com
419-265-9399

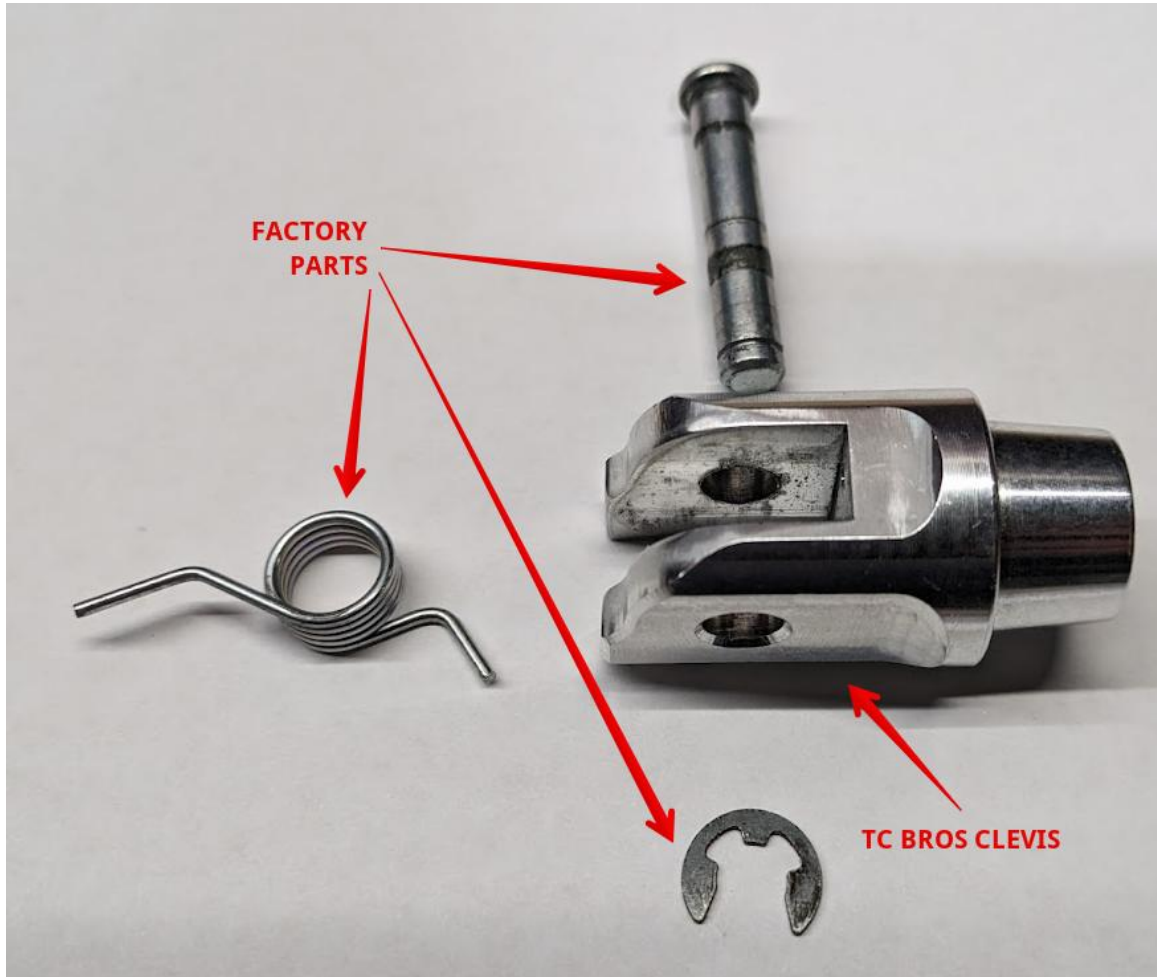

Factory hardware identified in picture. All factory pivot hardware will be reused.

Disassembly of factory foot peg:

- Remove E-clip. Cover pivot area with shop cloth and pull pin.
- Remove foot peg, be sure to keep assembly covered so spring is not lost during removal.

Reassemble with TC Bros clevis:

- Thread all cleats into mini floorboard.
- Insert short leg of spring into TC Bros clevis.
- With spring inserted into clevis, insert long leg of spring into factory clevis mount.
- Align pivot holes and insert pin. Attach e-clip.
- Attach mini floorboard to clevis, position and tighten screw to proper torque.

TC BROS.
www.tcbros.com
419-265-9399