

TC BROS.®

Pro Series MX Mini Floorboards for Harley Davidson® Models

102-0131 - RAW

102-0132 - BLACK

102-0133 - GOLD

PARTS LIST (EACH FOOT PEG)						
ITEM	QTY	102-0131 PART NUMBER	102-0132 PART NUMBER	102-0133 PART NUMBER	DESCRIPTION	TORQUE VALUE
1	1	119-0469	119-0469	119-0469	5/16-24 x 7/8" LG SOCKET HEAD CAP SCREW	19 FT-LB (26 N-m)
2	1	119-0483	119-0483	119-0483	5/16 ZINC PLATED SPLIT LOCK WASHER FOR SHCS	
3	19	FP118UN	FP118UN	FP118UN	CLEAT	19 IN-LB (2.1 N-m)
4	1	FP119UN	FP119UN	FP119UN	MALE HD CLEVIS	
5	1	FP124UN	FP124UN-BK	FP124UN-GD	MX MINI BOARD	

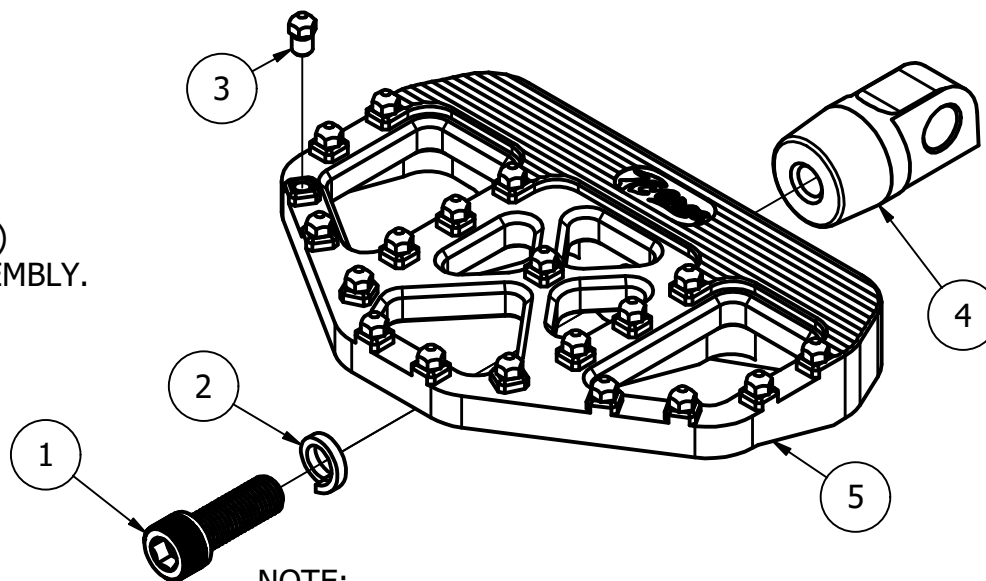

WARNING: APPLY MEDIUM STRENGTH
THREADLOCKER (BLUE LOCTITE™ #243)
TO ALL FASTENERS DURING FINAL ASSEMBLY.

TC BROS.
www.tcbros.com
419-265-9399

28FEB2024

NOTE:
ATTACH FOOT PEG ASSEMBLY TO MOTORCYCLE BY REUSING FACTORY
HARDWARE (BOLTS, NUTS, PINS, CLIPS, SPRINGS, ETC.). TORQUE TO
FACTORY SPECIFICATIONS WHERE APPLICABLE. CONSULT SERVICE MANUAL
AND/OR PROFESSIONAL MOTORCYCLE TECHNICIAN IF NECESSARY.