

TC BROS.®

Pro Series Digital Gauge Relocation Bezel for Harley Softail®

101-0344 RAW

101-0345 BLACK

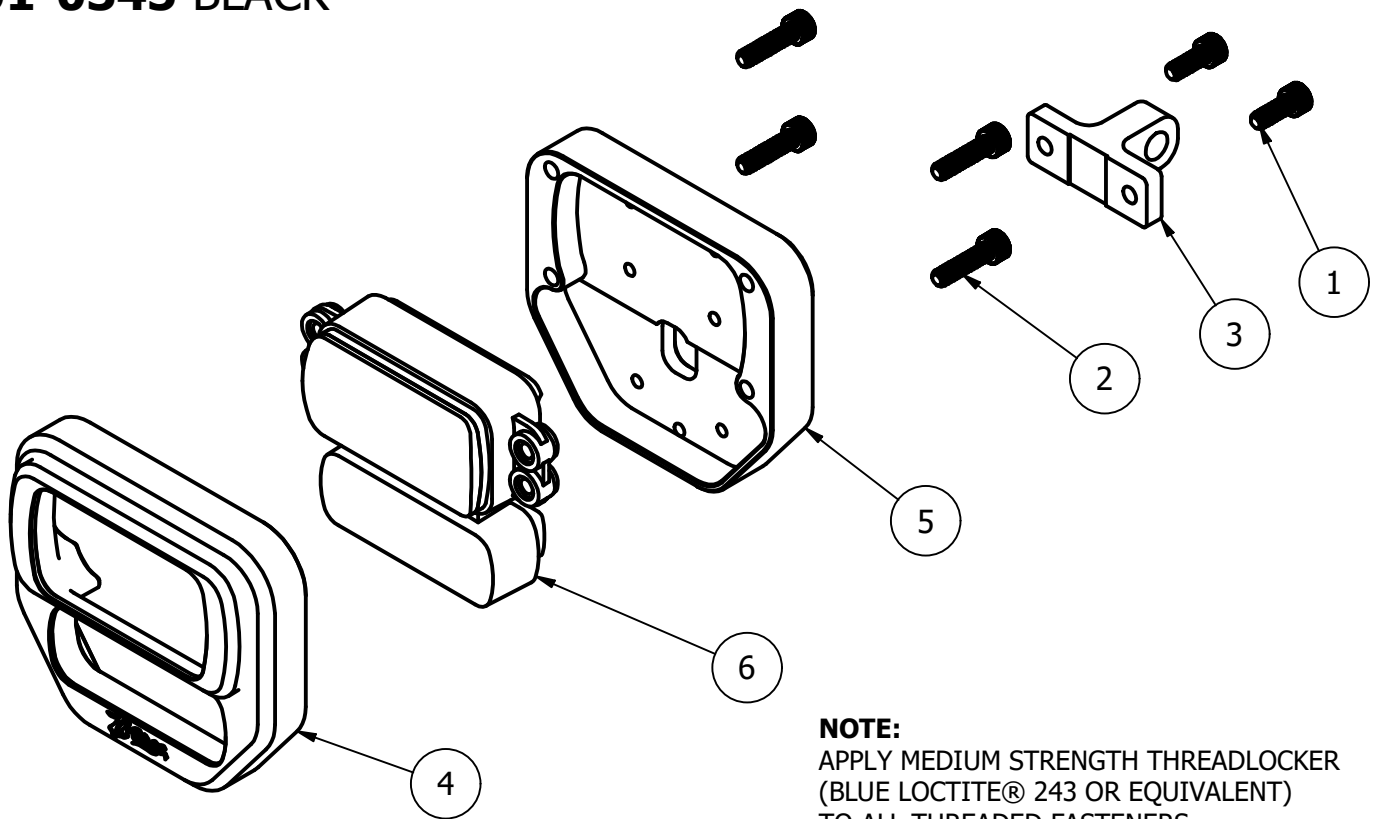

NOTE:
 APPLY MEDIUM STRENGTH THREADLOCKER
 (BLUE LOCTITE® 243 OR EQUIVALENT)
 TO ALL THREADED FASTENERS.

| PARTS LIST | | | | |
|------------|-----|----------------------|----------------------|--|
| ITEM | QTY | 101-0344 PART NUMBER | 101-0345 PART NUMBER | DESCRIPTION |
| 1 | 2 | 119-0474 | 119-0474 | 10-24 X 1/2" LG SS SOCKET HEAD CAP SCREW FULL THREAD |
| 2 | 4 | 119-0475 | 119-0475 | 10-24 X 3/4" LG SS SOCKET HEAD CAP SCREW FULL THREAD |
| 3 | 1 | HB354BT | HB354BT-BK | MOUNTING BLOCK |
| 4 | 1 | HB355BT | HB355BT-BK | M8 DIGITAL GAUGE TOP COVER |
| 5 | 1 | HB356BT | HB356BT-BK | M8 DIGITAL GAUGE BOTTOM COVER |
| 6 | 1 | HD OEM | HD OEM | HD OEM INSTRUMENT MODULE (NOT INCLUDED) |

TC BROS.
 www.tcbros.com
 419-265-9399

INSTALLATION INSTRUCTIONS

TC BROS.®

Pro Series Digital Gauge Relocation Bezel Harley Softail®

101-0344 - Raw

101-0345 - Black

Note: Please be aware that this procedure may exceed your technical abilities. Please read instructions completely and carefully before attempting installation. If you are unsure of your abilities, please consult a service professional.

WARNING: INSTALL & USE AT YOUR OWN RISK! Always wear and use all proper safety gear at all times when installing this product. We have made every attempt to ensure that these instructions are concise and easy to follow, but if any mistakes are found, or you require additional information, we can be reached M-F from 8:00am-5:00pm EST by calling 419-265-9399 or via email at sales@tcbroschoppers.com. TC Bros Choppers LLC assumes no liability for any personal injury or property damage caused by the installation and/or use or misuse of this or any other product.

Note: TC Bros recommends protecting the finish of your motorcycle tank and front fender using covers or shop towels to protect the finish.

Recommended Tools for Installation:

- Torque Wrench that measures in-lb or N-m and one that measures ft-lbs or N-m (torque values given are for dry fasteners)
- Ratchet and Socket set
- Standard Hex Key Wrenches (a.k.a. "Allen Wrenches")
- Torx Drive Tools for T-15 fasteners
- Loctite® #243 Medium Strength Threadlocker (Blue) or equivalent

Note:

Location of gauge may require extension of your wiring harness. Extension sold separately.

GAUGE RELOCATION BEZEL INSTALLATION

Disassembly:

- Start by covering the fuel tank. Using a 1/4 Allen wrench or socket to remove 4 screws, remove top clamp while holding onto bars. Remove bars from risers and carefully lay on top of tank. **Refer to figure 1.**
- Next unplug digital gauge and remove four T-15 Torx screws. Remove digital gauge from the upper clamp. **Refer to Figure 2.**
- Now bolt top clamp back in place on risers to give stability when remove riser bolts.
- Using a 3/4" socket, remove lower riser nut located under the upper tree from each riser post and remove risers from upper tree. **Refer to Figure 3.**
- Remove riser stud from existing riser, **refer to Figure 4**, this will be reused on new riser kit. If you do not want to remove riser studs, see TC Bros website for kit to replace studs and nuts with bolts.

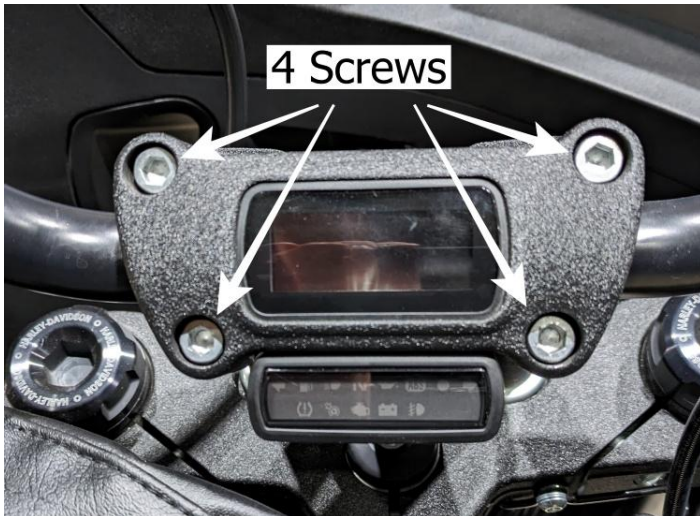

Figure 1



Figure 2

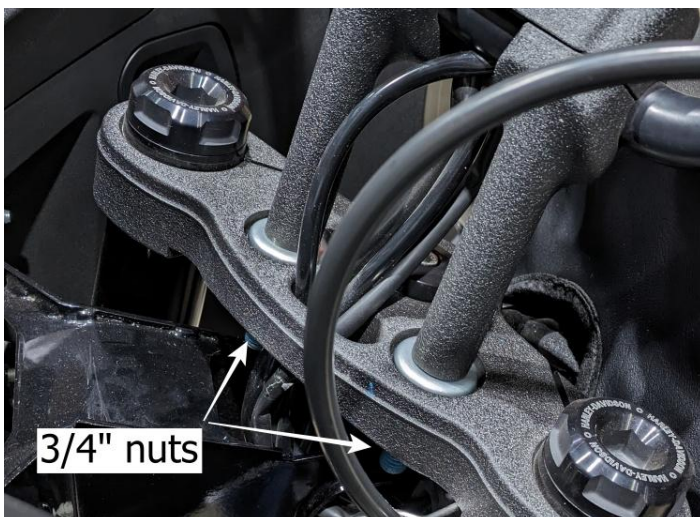

Figure 3



Figure 4

GAUGE RELOCATION BEZEL INSTALLATION

Reassembly:

- Start by assembling new riser to existing handle bar assembly. Do not apply thread locker to top clamp screws at this time. Use top clamp to align lower risers. If reusing studs, apply thread locker to clean threads and screw into risers. Screw stud till threads bottom out.
- Next bolt risers into upper tree. OEM rubber bushings can be reused if in good condition. TC Bros offers a solid bushing option available on the website. Torque nut or bolt to 30-40 ft-lb (41-54 N-m).
- Place digital gauge into M8 Digital Gauge Top Cover, HB355BT. Check from front side to make sure OEM rubber gasket is in place around the gauge in both openings and not pinched or pushed out of place. **Refer to Figure 5.**
- Turn over assembly and place M8 Digital Gauge Bottom Cover, HB356BT over back of gauge. Secure in place with four, 119-0475, screws and torque to 22 in-lb.
- Attached mounting block, HB354BT, to either the top, middle or bottom mounting holes with two, 119-0474, screws and torque to 22 in-lb. The alternate mounting points will allow clearance for mounting in front or behind the riser top clamp. **Refer to Figure 6.**



Figure 5

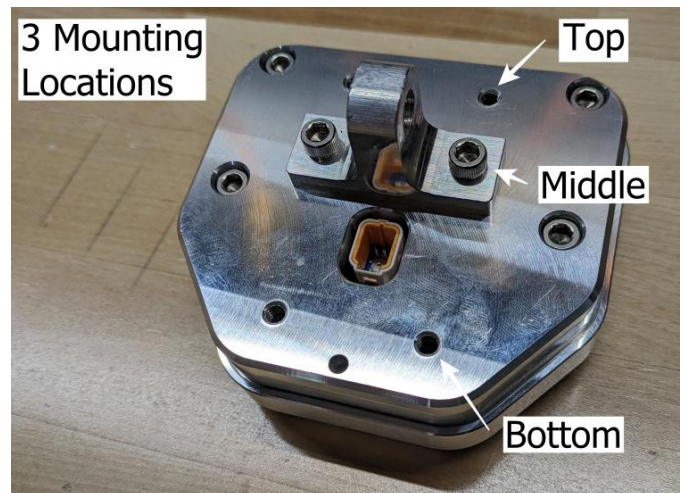

Figure 6

- Gauge relocation bezel can be attached to 3.5" center to center risers using 101-0338, raw, or 101-0339, black, Pro Series Gauge Relocation Bracket for 1-1/4 Risers and T-Bars. See **Figure 7 & 8.**



Figure 7



Figure 8

- Alternatively, gauge relocation bezel can be mounted by replacing the lower center clamp on your TC Bros Riser with 1" lower clamp kit: 101-0336, raw, or 101-0337, black. Or 1-1/8" lower clamp kit: 101-0342, raw, or 101-0343, black. See **Figure 9 & 10.**



Figure 9



Figure 10

- Plug in gauge module.
- Route control wiring making sure it is not pinched or being strained.
- Last step is to position bars in risers. Once controls and levers are adjusted properly, begin applying threadlocker to riser upper clamp fasteners and torque to recommended specifications provided in Riser kit.
- Now that all components have been installed and adjusted properly, take a moment **BEFORE RIDING YOUR MOTORCYCLE** to double check that all fasteners were tightened securely and threadlocker was applied during installation.