

TC BROS.®

Gauge Relocation Bracket for TC Bros. Pro Series 1" Modular Risers

101-0336 - RAW

101-0337 - BLACK

PARTS LIST				
ITEM	QTY	101-0336 PART NUMBER	101-0337 PART NUMBER	DESCRIPTION
1	1	119-0477	119-0477	5/16-18 X 1-1/8" LG SS SOCKET HEAD SCREW
2	1	HB363BT	HB363BT-BK	1" RISER CENTER CLAMP - CLEARANCE
3	1	HB364BT	HB364BT-BK	1" RISER CENTER CLAMP - TAP

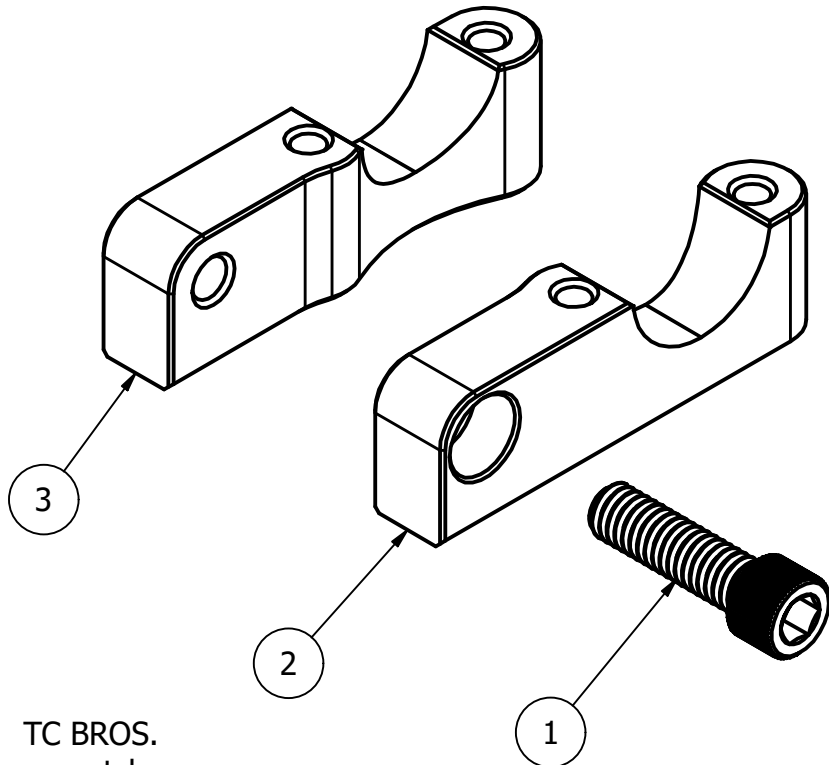

TC BROS.
www.tcbros.com
419-265-9399

TIGHTEN 119-0477 SO CLAMPS HOLDS POSITION OF LINKAGE. DO NOT EXCEED 100 IN-LB. AFTER 119-0477 IS TIGHTENED, TORQUE FOUR SOCKET HEAD CAP SCREWS INCLUDED IN RISER KIT TO PROPER TORQUE SPECIFICATION.

NOTE:
APPLY MEDIUM STRENGTH THREADLOCKER (BLUE LOCTITE® 243 OR EQUIVALENT) TO ALL THREADED FASTENERS.

Relocation Bracket is fully adjustable at installation to allow rider to position gauge at different angle and heights. Examples of mounting can be seen in pictures below. Digital Gauge Relocation Housing, TC Bros Part #101-0344, show for for reference, not included in this kit.



101-0336 Relocation Bracket, Top Mounting Option



101-0336 Relocation Bracket, Bottom Mounting Option



101-0336