

Best doors PR 240 Hinged Door Set -/240/60sm Installation

WALL TYPE: **MASONRY**

FRAME TYPE: **STEEL**

Frame materials available:

EGZ - 1.6mm

Cold rolled galvanized - 1.6mm

Stainless Steel - 1.5mm

Fasteners:

Jamb fixing at 600mm centres minimum

Expansion anchors eg. M10 countersunk

'Ramset' Dynabolts

M12 countersunk masonry screwbolts

Head Fixing (minimum):

Single door - none required

Paired door - single central fastener required

Wedging Gap:

10mm

Insulation rating:

To obtain an insulation rating, the steel frame must be packed with ;

Grout (60 minutes)

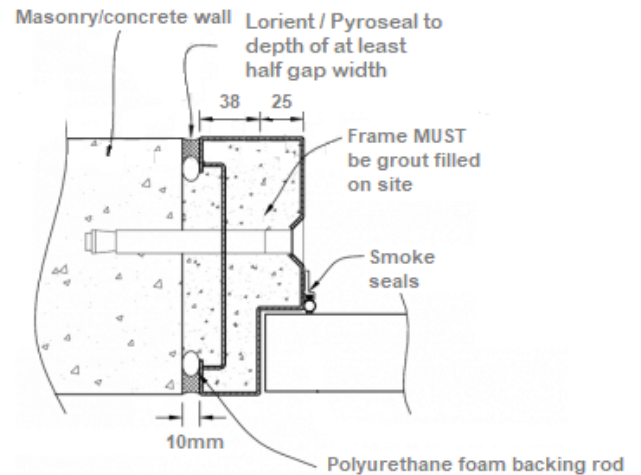

FRAME PROFILE G

Same method applies to profiles D & J:
wall thickness may determine frame profile