

Best doors PR 180 Hinged Door Set -/180/60sm

Installation

WALL TYPE: **TIMBER STUD**

FRAME TYPE: **STEEL**

Frame materials available:

EGZ - 1.6mm

Cold rolled galvanized - 1.6mm

Stainless Steel - 1.5mm

Fasteners:

10g x 75mm self tapping screws at 600mm centres.

Head Fixings:

Single door - none required

Paired door - central fastener required

Stud size:

ex100 x 50mm.

Wedging Gap:

N/A

Insulation rating:

To obtain an insulation rating, the steel frame must be packed with either;

Plasterboard (30 minutes)

Cornice plaster (30 minutes)

Grout (60 minutes)

Mineral Wool (30 minutes)

No frame packing equals no insulation rating (i.e. -/xx/-)

WALL TYPE: **MASONRY**

FRAME TYPE: **STEEL**

Frame materials available:

EGZ - 1.6mm

Cold rolled galvanized - 1.6mm

Stainless Steel - 1.5mm

Fasteners:

Jamb fixing at 600mm centres minimum

Expansion anchors eg. M10 countersunk 'Ramset'

Dynabolts

M12 countersunk masonry screw bolts

Head Fixing (minimum):

Single door - none required

Paired door - single central fastener required

Wedging Gap:

10mm

Insulation rating:

To obtain an insulation rating, the steel frame must be packed with either;

Plasterboard (30 minutes)

Cornice plaster (30 minutes)

Grout (60 minutes)

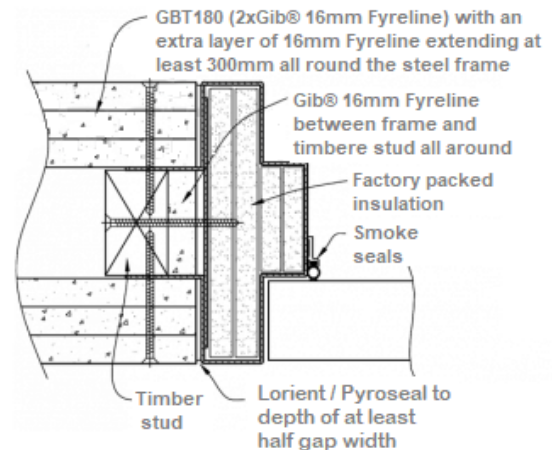

FRAME PROFILE D SHOWN (ONLY AVAILABLE FRAME PROFILE)

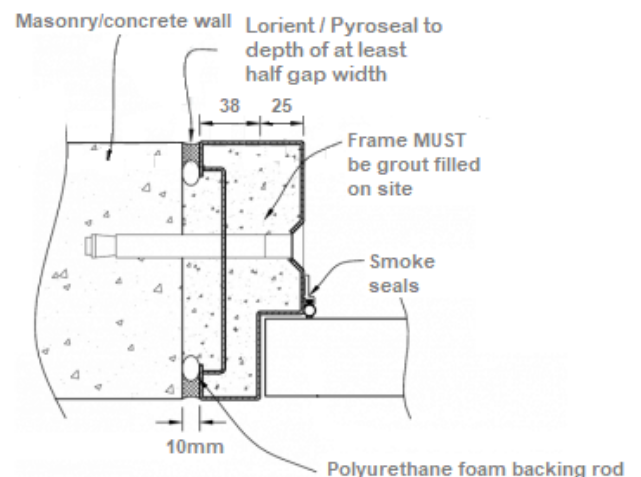

FRAME PROFILE G

Same method applies to profiles D & J:
wall thickness may determine frame profile

Mineral Wool (30 minutes)

No frame packing equals no insulation rating (i.e. -/xx/-)