

CHANGE			
EDITI	MODIFICATION	UPDATE DATE	SIGNATURE
A/0	ISSUE	2022.06.05	

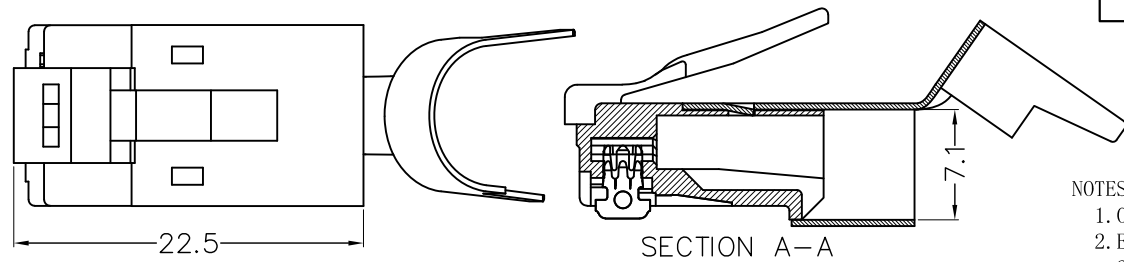

NOTES:

1. Operation Temperature: $-40^{\circ}\text{C} \sim +85^{\circ}\text{C}$.
2. Electrical Characteristics:
 - 2.1>Rated Current: 125V AC, 1.5A@25°C.
 - 2.2>Contact Resistance: 20mΩ Max.
 - 2.3>Insulation Resistance: 500MΩ Min, 100V DC/min.
 - 2.4>Voltage Proof: 1000V AC/1 minute no breakdown.
3. Mechanical Characteristics:
 - 3.1>Insertion Force & Withdrawal Force: 30N Max.
 - 3.2>Durability: 750 cycles Min.
4. Environmental compliance:
 - 4.1>the products are compliant with the RoHS, and REACH etc.
5. Suitable for CAT6 & CAT6A cables with insulation diameter $\leq 1.0\text{mm}$, outer jacket OD $\leq 6.5\text{mm}$

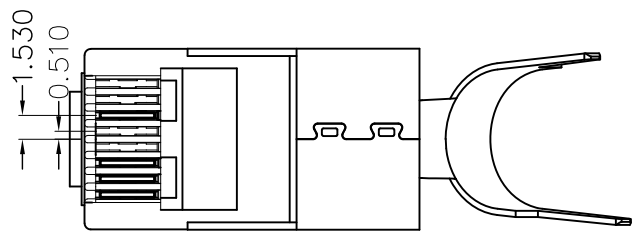
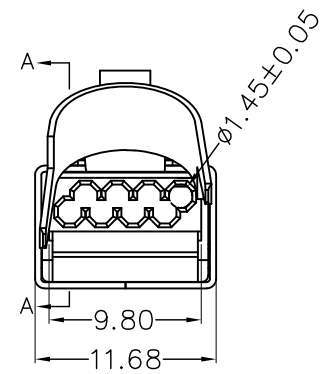
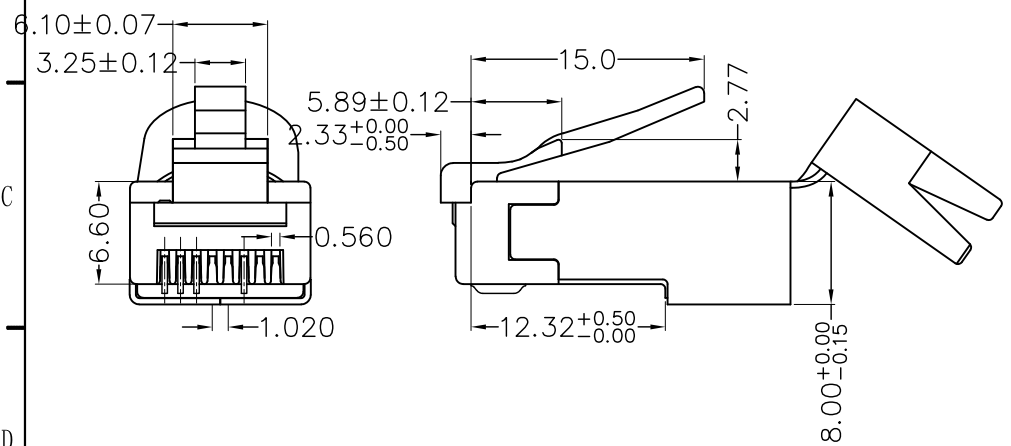

1	Modular Plug	Shell	1PCS	45*40**06	Square hole	Au: G/F <input type="checkbox"/> 1u" <input type="checkbox"/> 3u" <input type="checkbox"/> Ni: 80u" <input checked="" type="checkbox"/>	Brass <input checked="" type="checkbox"/> Spcc <input type="checkbox"/>
		Contacts	8PCS	/	<input type="checkbox"/> 2Prongs <input checked="" type="checkbox"/> 3Prongs	<input type="checkbox"/> G/F" <input type="checkbox"/> 1u" <input type="checkbox"/> 3u" <input type="checkbox"/> 6u" <input type="checkbox"/> <input type="checkbox"/> 15u" <input type="checkbox"/> 30u" <input type="checkbox"/> 50u" <input checked="" type="checkbox"/> OTHER <input type="checkbox"/>	<input type="checkbox"/> Brass <input checked="" type="checkbox"/> Phosphor copper
		Housing	1PCS	21*1271**	CAT7/FTP HOUSING/LONG TYPE/4U4D/HOLE 1.45mm		<input checked="" type="checkbox"/> 94V-2 <input type="checkbox"/> 94V-0
NO.	NAME	QTY	PART NO.	DESCRIPTION		MATERIAL	

iVOLTaa
Voltaa Global

PRODUCT NO	IVR45-SH7PRG-P1	DESCRIPTION	RJ45 Connectors Shielded Cat7 1.45mm 3Prongs 2Pcs Transparent		SHEET.	1/1			
MATERIAL	/	UNIT	mm	SCALE	1:1	DWG NO	MP32012	EDITI	A/0
DIMENSIONAL TOLERANCE		THIRD ANGLE PROJECTION		DRAWN	LIJING	DATE	2022.06.05		
X.X ±0.2 X.XX ±0.10 X.XXX ±0.05 ANGLE ±2°				CHECK	LAMPE	DATE	2022.06.05		
				APPRO.	LIAOGUOZHONG	DATE	2022.06.05		

30*0444**

SERIAL NUMBER
MATERIAL

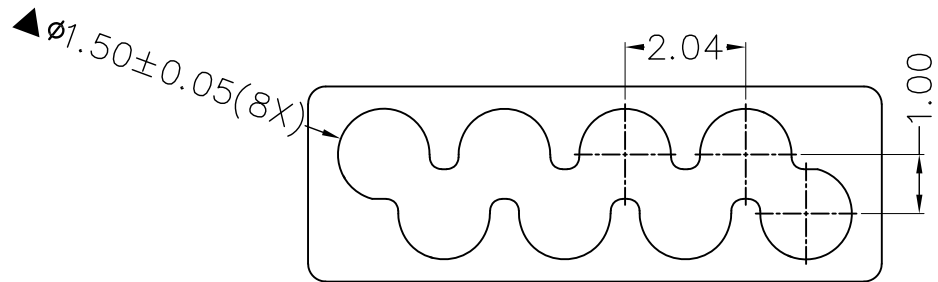
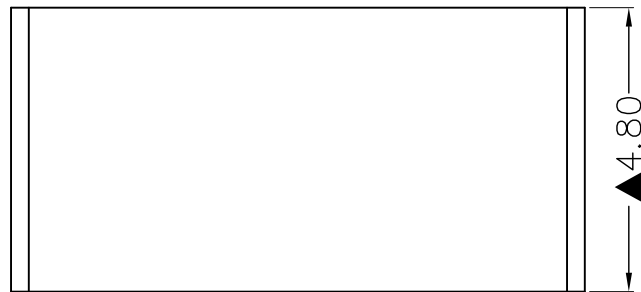
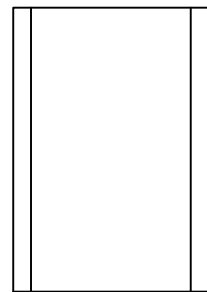
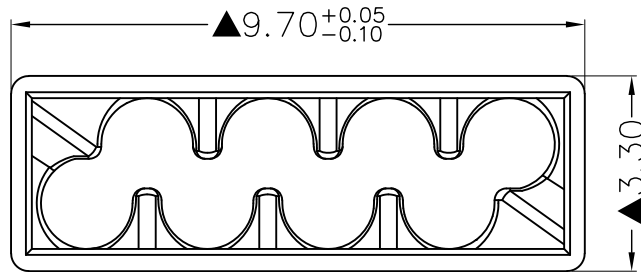

CHANGE			
EDITI	MODIFICATION	UPDATE DATE	SIGNATURE

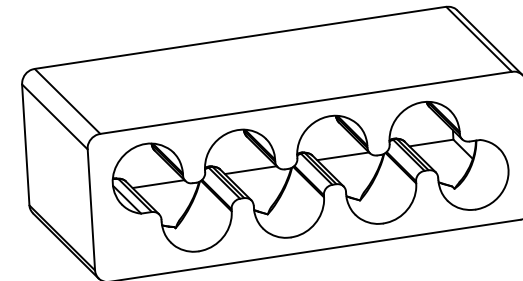
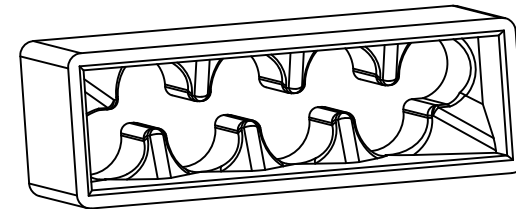

REMARK:
KEY CONTROL DIMENSIONS MARKED "▲"
IN THE DRAWING.

iVoltaa Voltaa Global									
PRODUCT NO	30*0444**		DESCRIPTION	4UP 4DOWN Load Bar $\phi 1.50$			SHEET	1/1	
MATERIAL	PC	UNIT	mm	SCALE	NULL	DWG NO	LB03004	EDITI	A/0
DIMENSIONAL TOLERANCE			THIRD ANGLE PROJECTION			DRAWN	LIJING	DATE	2017. 06. 05
X. X ± 0.2 X. XX ± 0.10 X. XXX ± 0.05 ANGLE $\pm 2^\circ$						CHECK	LAMPE	DATE	2017. 06. 05
						APPRO.	LIAOGUOZHONG	DATE	2017. 06. 05