

RE•ATHLETE

DEEP4s

Maintenance

The battery in this device is not designed to be removed or exchanged by the user. If any problems with the power supply occur, please contact us directly.

Do not try to open the device, repair it or fix it by taking the device apart yourself. Tampering with the devices mechanics in any way will result in automatic expiration of the product's warranty.

Warnings and Safety Cautions

Before connecting the device to the power supply, please ensure that the supply voltage stated on the rating plate is compatible with the unit.

The device should only be used with the certified REATHLETE charger (provided).

Please charge the batteries before initial use.

Do not submerge the device in water or any other liquid.

Do not use the device for more than 30 minutes at a time. Allow a minimum of 5 minutes between each 30-minute session.

Do not apply to your head or near your genitals.

Please consult your physician before use, if you are experiencing unexplained pain; if you're receiving medical treatment or using medical equipment.

DISCLAIMER

Please contact your physician before using the REATHLETE DEEP4s if you have any physical health conditions or suffer from any of the following conditions:

pregnancy, diabetes, epilepsy, migraines, herniated disks, spondylolisthesis, recent joint replacements or IUDs. Please also contact your physician before use if you have undergone recent surgery or have any metal pins or plates in your body.



Contact us:

www.reathlete.com
support@reathlete.com

155 Office Plaza Drive
Tallahassee, Florida USA 32301

RE•ATHLETE



User Manual

DEEP4s

Percussive Massager



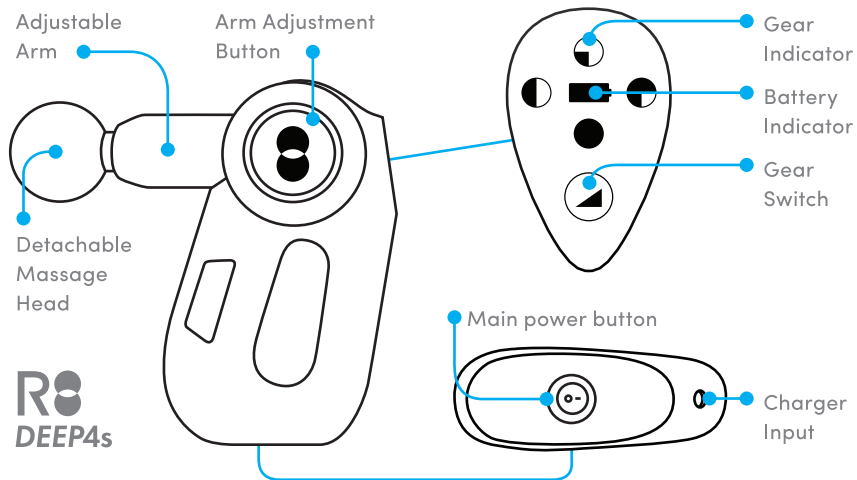

Turn the machine ON/OFF

Power on the machine by pressing the main power button on the bottom of the device. Once engaged, the control panel will light up. This indicates that the machine is ready for use. Press the main power button again to terminate all functions.

Changing percussion massage frequency

When the machine is on, touch the button to turn on the first gear. If you would like to advance to a higher setting, touch the button again. The back light indicates your current gear. To pause the massage press the button for 3 seconds. Press for 3 seconds again to resume.

The machine will automatically turn off if left on pause for more than 5 minutes. To resume after the device has turned itself off, switch the main power switch OFF and then back to ON.

1st gear: 20Hz 2nd gear: 30Hz 3d gear: 40Hz 4th gear: 54Hz

Connecting attachments:

1. With the moving arm of the gun fully extended, align the attachment to the space in the arm.
2. Now push gently with a twist until the head locks in position.



Disconnecting attachments:

1. Once the gun is turned off, gently pull with a twist the head out of the massager.
- Remember to always connect/disconnect your attachments gently. This will ensure your massager longevity.



Adjusting the angle of the massage arm

Turn off the machine. Press the arm adjustment button and start adjusting the angle of the massage arm to one of three positions available: 0°, 45°, 90°. Release the adjustment button. The arm will lock itself into selected position.

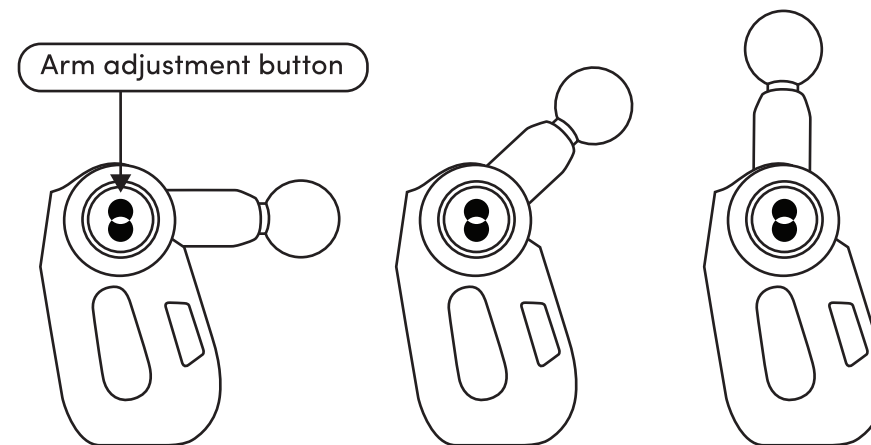

Battery display

The battery indicator is white when the battery is fully charged. When under 30%, the light turns yellow. When under 20%, the light turns red. Battery indicator will flash red repeatedly when at 10% or less. The motor will stop working under 10% battery.

Charging

The battery indicator flashes white when the device is charging. When charging is complete, the indicator will stop flashing and will appear white to indicate full battery.

Technical details:

Massager

No-load speed	1200 – 3200 r/min
Power	120W Max
Frequency	20Hz – 54Hz
Stroke length	12mm / 0.47"
Weight	1.21 kg / 2.66 lb
Dimensions	23x13x5cm / 9"x5.1"x2"

AC Charger

Rated input: 100–240V ~50/60Hz, 39W
Rated output: 26V / 1.5A

Battery

2000mAh Li-ion Battery
Rated Voltage: 24V DC
Operation time: up to 5 hours
Charging time: 90 minutes