



AHD 1080p Vari-focal Eyeball Camera

Features

- Sony 1/2.9" 2.2MP CMOS sensor
- Supporting multiple analog HD 1080p standards
- Up to 300m coax cable transmission
- Enhancements: WDR, 2D/3D NR, BLC, highlight suppression, defogging
- Motion detection
- Privacy masks
- Multi-lingual OSD menu



Dimensions

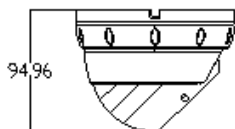
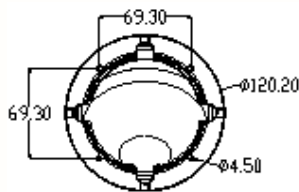

Specifications

Model	AS2-D34W
CAMERA	
Image Sensor	Sony 1/2.9" 2.2MP CMOS sensor
Effective Pixel	1920 (H) x 1080 (V)
Frame Rate	25/30fps
Video Output	Switchable among multiple analog HD standards and CVBS, 1.0Vp-p composite video, 75Ω
Min. Illumination	0.0 lux (IR on)
IR Range	30m
Sync System	Internal
Scan System	Progressive scan
Lens	2.8 - 12mm
Angle of View	Horizontal: 31° ~ 91° ; Vertical: 18° ~ 47°
Electronic Shutter	Auto / manual (1/30 - 1/50000) / FLK
S/N Rate	≥50db (AGC off)
CONTROL	
Video Adjustment	Brightness, sharpness
White Balance	ATW / AWC-SET / AWB / indoor / outdoor / manual
Noise Reduction	2D NR / 3D NR / off
Digital WDR	Auto / on / off
Video Compensation	BLC / HLC / off
Auto Gain Control	Auto / on / off
Day / Night Mode	Auto / B/W / color
Privacy Mask	4 zones
Motion Detection	4 zones
Orientation	Mirror / upside down / 180° rotation
Sens-Up	Up to 30X
MISCELLANEOUS	
Weather Protection	IP65
Operating Environment	-10 ~ 50°C / 90% relative humidity (no condensation)
Power Supply	DC12V, 8W
Dimensions (mm)	95 (H) x Φ120 (D)
Weight	675g
Accessories	CC-WL0D3, CC-DP0D3



WAMA Technology Limited

Unit 502, 5/F, Block B, Wing Kut Industrial Building,
608 Castle Peak Road, Kowloon, Hong Kong.

Tel : (852) 3703 9260

Fax : (852) 3705 0053

Email : info@wamatech.co

Website : www.wamatech.co